

PROPOSED BELLA VISTA DEVELOPMENT BY OTHERS  
APN 125-15-701-001

CONTRACTOR SHALL FIELD LOCATE AND PROTECT ALL SNWA/SNWS APPURTENANCES INCLUDING BUT NOT LIMITED TO AV/AR, ACCESS MAINWAYS AND CATHODIC PROTECTION SYSTEMS. ALL ABOVE GROUND STRUCTURES AND AT GRADE STRUCTURES MUST BE ADJUSTED TO NEW GRADE AT CONTRACTOR'S EXPENSE. CATHODIC PROTECTION TEST STATIONS, RECTIFIERS, AND AV/AR'S MUST BE RELOCATED TO SIDEWALK PER SNWA STANDARDS AND AT CONTRACTOR'S EXPENSE. CONTRACTOR TO NOTIFY SOUTHERN NEVADA WATER AUTHORITY DEVELOPMENT PLAN REVIEW AT (702) 862-3444 AT LEAST 48 HOURS PRIOR TO CONSTRUCTION ACTIVITY.

SOUTHERN NEVADA WATER AUTHORITY DATE \_\_\_\_\_  
SNWA APPROVAL IS VALID FOR ONE (1) YEAR FROM SIGNATURE DATE. IF CONSTRUCTION WITHIN THE EASEMENT OR RESTRICTED PIPE SAFETY ZONE IS NOT COMPLETE, PLANS MUST BE RESUBMITTED TO SNWA FOR APPROVAL.

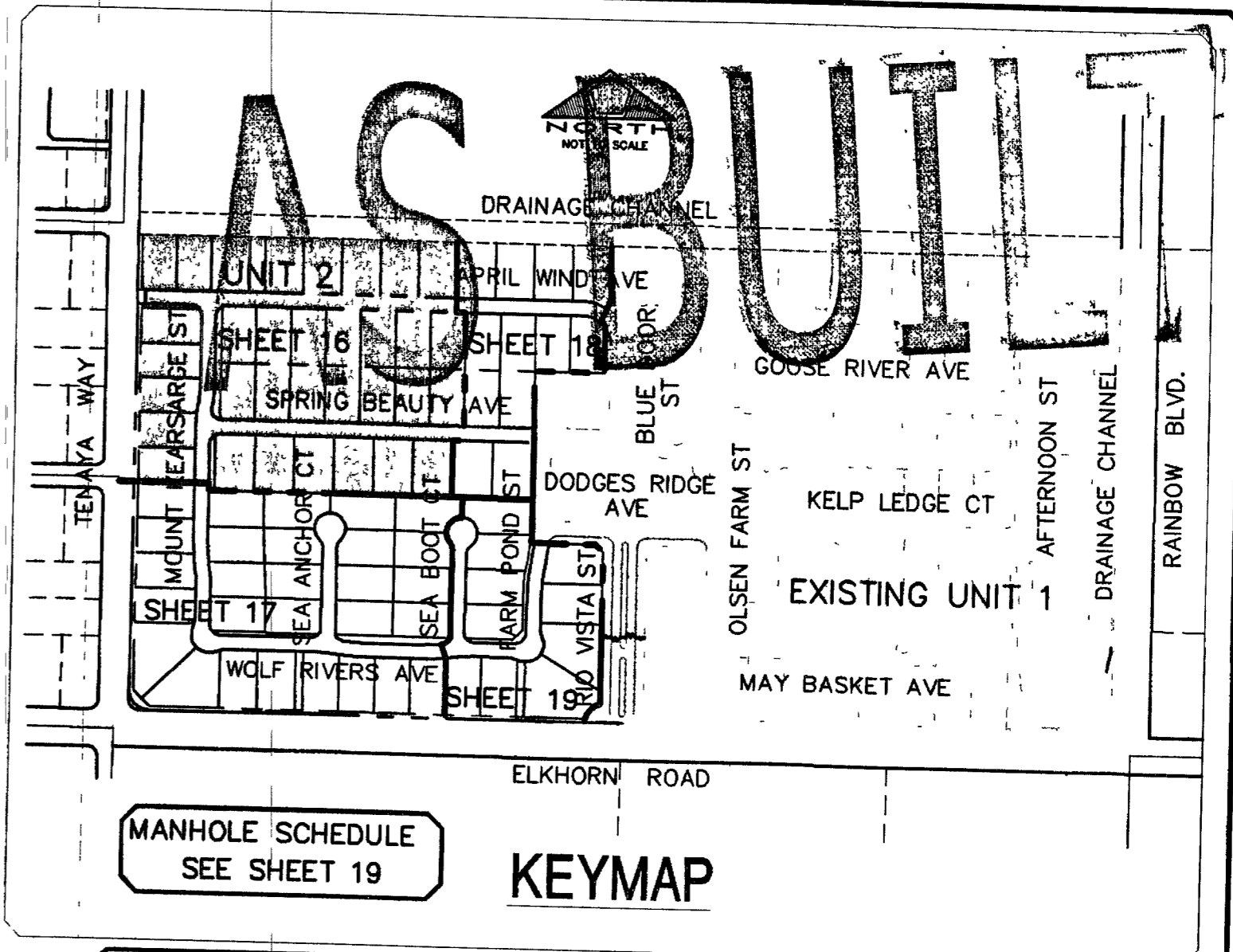

MANHOLE SCHEDULE  
SEE SHEET 19

KEYMAP

Southern Nevada Water Authority (SNWA) facilities are located in the area of this project and it is required that they be included in the coordination and approval process PRIOR to District signature. If you have not already done so, you may contact SNWA at:  
Southern Nevada Water Authority  
1900 E. Flamingo Road, Suite 170  
Las Vegas, NV 89199  
(702) 862-3444 Fax (702) 862-3485 ESNR.038

WATER FITTINGS LEGEND:

- 1 8" TEE
- 2 8" 45° BEND
- 3 8"x6" REDUCER
- 4 8" 90° BEND
- 5 8" GATE VALVE
- 6 FIRE HYDRANT ASSY. PER UDACS PLATE 7 INCLUDING 6" G.V.
- 7 2" BLOW-OFF ASSEMBLY W/CAP PER UDACS PLATE 4

BASIS OF BEARING

THE BASIS OF BEARING FOR THIS SURVEY IS THE WEST QUARTER (SE 1/4) OF QUARTER 15, TOWNSHIP 19 SOUTH, RANGE 60 EAST, M.D.M., CLARK COUNTY, NEVADA, AS SHOWN IN

FIRE FLOW CALCULATIONS  
FIRE FLOW REQUIREMENTS IS: 1,750 GALLONS PER MINUTE AT 20 PSI RESIDUAL PRESSURE.  
BASED ON:  
SQUARE FOOTAGE 4800 SF  
LARGEST AREA BETWEEN 4-HOUR AREA SEPARATION WALLS: N/A  
BUILDING HEIGHT 20' ±  
NUMBER OF STORIES ONE-STORY  
TYPE OF CONSTRUCTION TYPE 5 NR  
OCCUPANCY SINGLE-FAMILY  
FULL AUTOMATIC FIRE SPRINKLER SYSTEM NONE  
REVIEWED BY: *RWC* DATE: 6/10/03

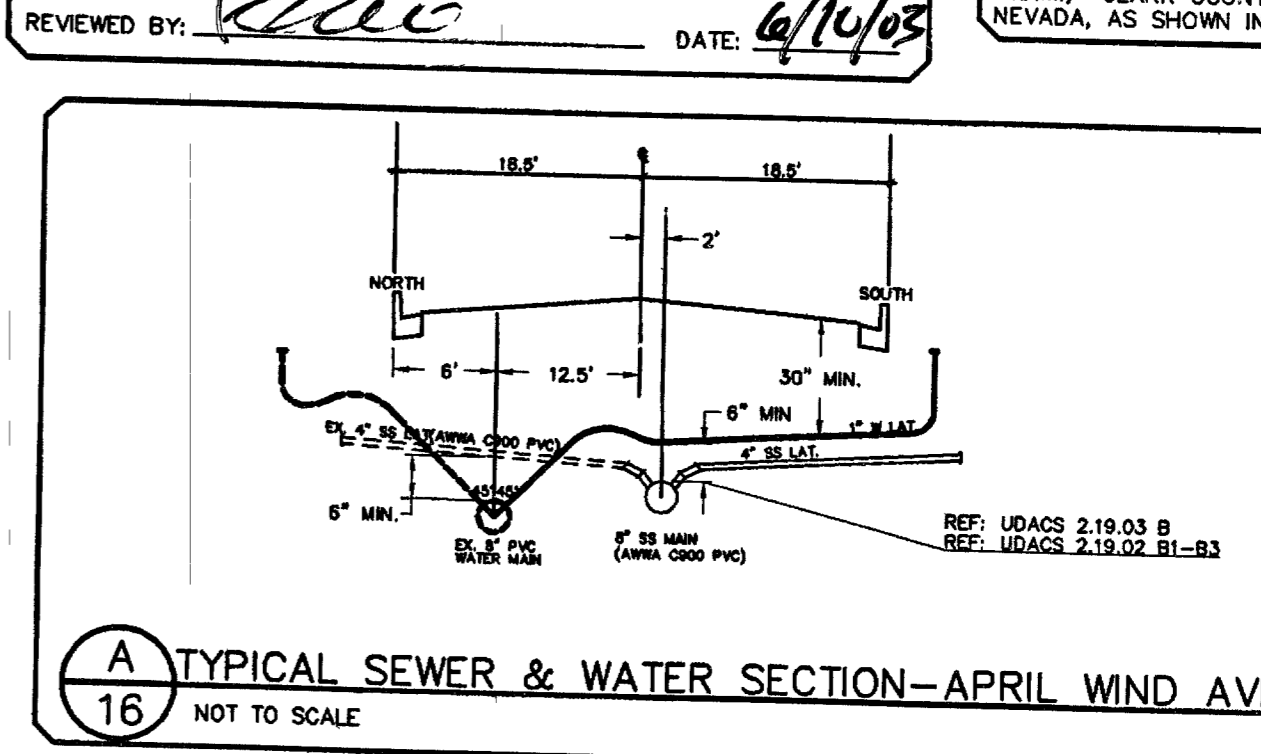

NOTE: INSTALL PIPELINE MARKER BALLS IN TRENCH ABOVE EACH HORIZONTAL ELBOW FITTING, PER MANUFACTURER INSTRUCTIONS.

UTILITY LEGEND

- EX 8" W EXISTING WATER LINE W/SIZE
- 8" W PROPOSED WATER LINE W/SIZE
- PROPOSED WATER LATERAL
- EX 8" S EXISTING SEWER LINE W/SIZE
- 8" S PROPOSED SEWER LINE W/SIZE
- PROPOSED SEWER LATERAL
- EXISTING SEWER MANHOLE
- PROPOSED SEWER MANHOLE
- 0" LIP DRIVEWAY
- GATE VALVE
- CONCRETE DRIVEWAY
- 12" W 8" W WATER REDUCER
- REQUIRES BACKWATER VALVE
- REQUIRES PRESSURE REDUCER VALVE

ESTIMATE OF WATER QUANTITIES

6" PVC WATER MAIN	433 L.F.
8" PVC WATER MAIN	3,265 L.F.
3/4" WATER METER (FROM LVVWD)	83 EA.
W/ 1" COPPER SERVICE (UDACS PLATE 1D)	
1" WATER METER (IRRIGATION)	1 EA.
W/ 1" COPPER SERVICE (UDACS PLATE 1D)	
1" R.P.P.A. (IRRIGATION)	1 EA.
(UDACS PLATE 11A)	
2" BLOW-OFF ASSEMBLY W/CAP	2 EA.
8" TEE	3 EA.
8" x 6" REDUCER	2 EA.
STD. FIRE HYDRANT ASSEMBLY W/ 6" LATERAL, 6" GATE VALVE	9 EA.
8" GATE VALVE	4 EA.
45° BEND	4 EA.

NOTE: QUANTITIES ARE APPROXIMATE ONLY- CONTRACTOR TO VERIFY.

VATE STREET NOTE

J. PRIVATE STREETS ARE PUBLIC JE EASEMENTS, CIVIL SEWER AND PUE LINTS TO BE PRIVATELY MAINTAINED HOME OWNERS ASSOCIATION.

MATCHLINE - SEE SHEET 17

Call before you do Overhead  
1-702-593-6111

Call before you Dig.  
1-800-227-2600

Service laterals for lots 24-31 and lots 140-146 will be tapped on existing main by Owner's contractor under direction of the LVVWD.  
ESN.030

BENCHMARK  
CITY OF LAS VEGAS BENCHMARK NO. 11LV90 11SWS. RIVET AND PLATE IN TOP OF CURB, SOUTHEAST CORNER OF RAINBOW BLVD AND FLANAGAN DRIVE.  
ELEVATION = 724.3103 METERS (NAVD '88 PUBLISHED)  
ELEVATION = 2376.34 U.S. SURVEY FEET (NAVD '88 CALCULATED)  
PROJECT ELEVATION = 2376.52 U.S. SURVEY FEET

TRAFFIC LEGEND  
9" O3 STREET NAME SIGN (PER STD DWG 250)  
30" STOP SIGN (R1-1) LOCATE AT BCR  
BLUE REFLECTIVE MARKER  
STREET SIGN AS NOTED PER PLAN

APPROVALS  
Richard Bull  
CITY FIRE MARSHAL  
Date: 6/10/03  
Dolly Vran  
LAS VEGAS VALLEY WATER DISTRICT  
Date: 7/10/03

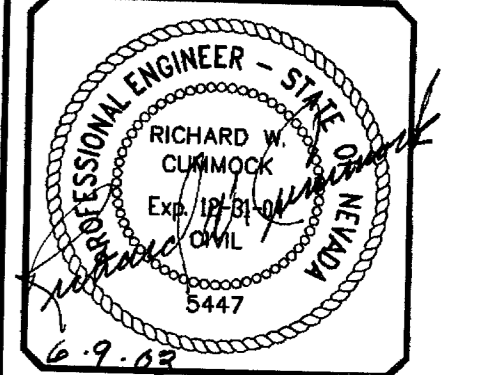

( IN FEET )  
1 inch = 40 ft.

PROJECT NAME: WYETH RANCH UNIT 2  
SHEET: 17 OF 13 (16 OF 20)  
DATE: 6/10/03  
NOT APPROVED FOR CONSTRUCTION  
at this time and this signature does not validate or imply a water commitment.  
LVVWD DATE: 6/10/03 ESN 052

SEWER AVERAGE DAILY FLOWS = 0.021 MGD  
PEAK FLOWS = 0.060 MGD

W:\Active\18147028\Drawings\Unit 2\plans\02-UTL.dwg Plotrow Mon, 09 Jun 2003 - 1:55pm