

**SPRING BEAUTY AVENUE (PRIVATE)
PLAN**

CURVE	RADIUS	DELTA	LENGTH	TANGENT
C32	25.00	89°53'27"	39.22	24.95
C45	25.00	97°07'56"	42.38	28.32
C47	418.50	9°30'50"	69.49	34.83
C48	381.50	9°30'50"	63.35	31.75
C49	418.50	9°24'17"	68.69	34.42
C50	400.00	9°30'50"	66.42	33.28
C51	400.00	9°24'17"	65.66	32.90

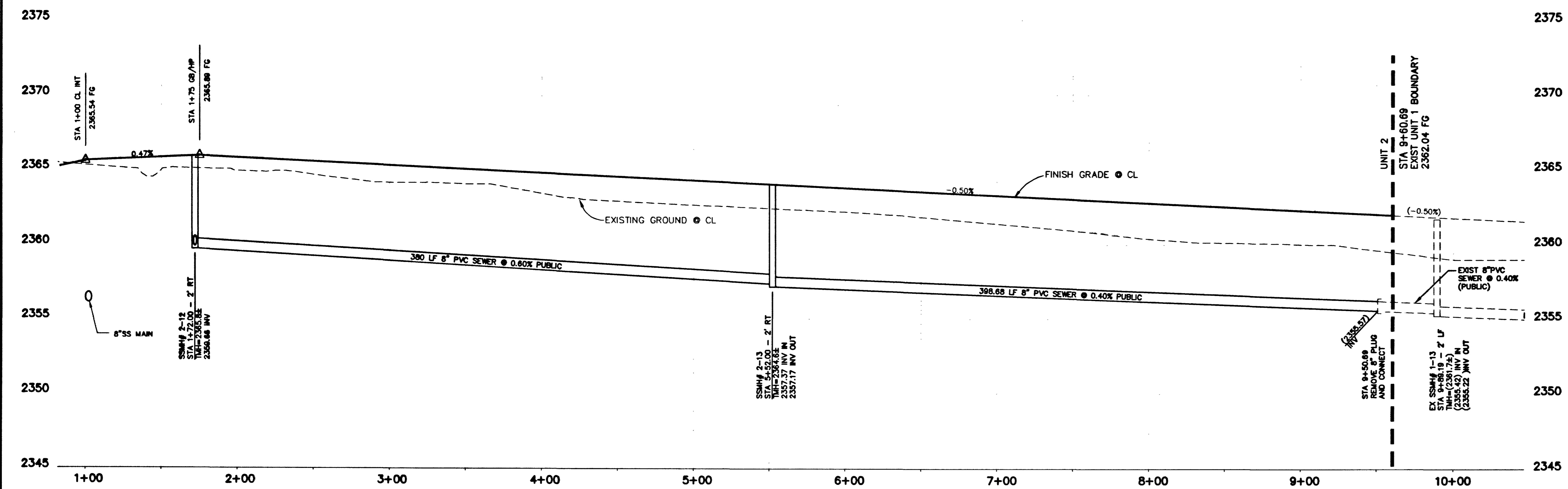
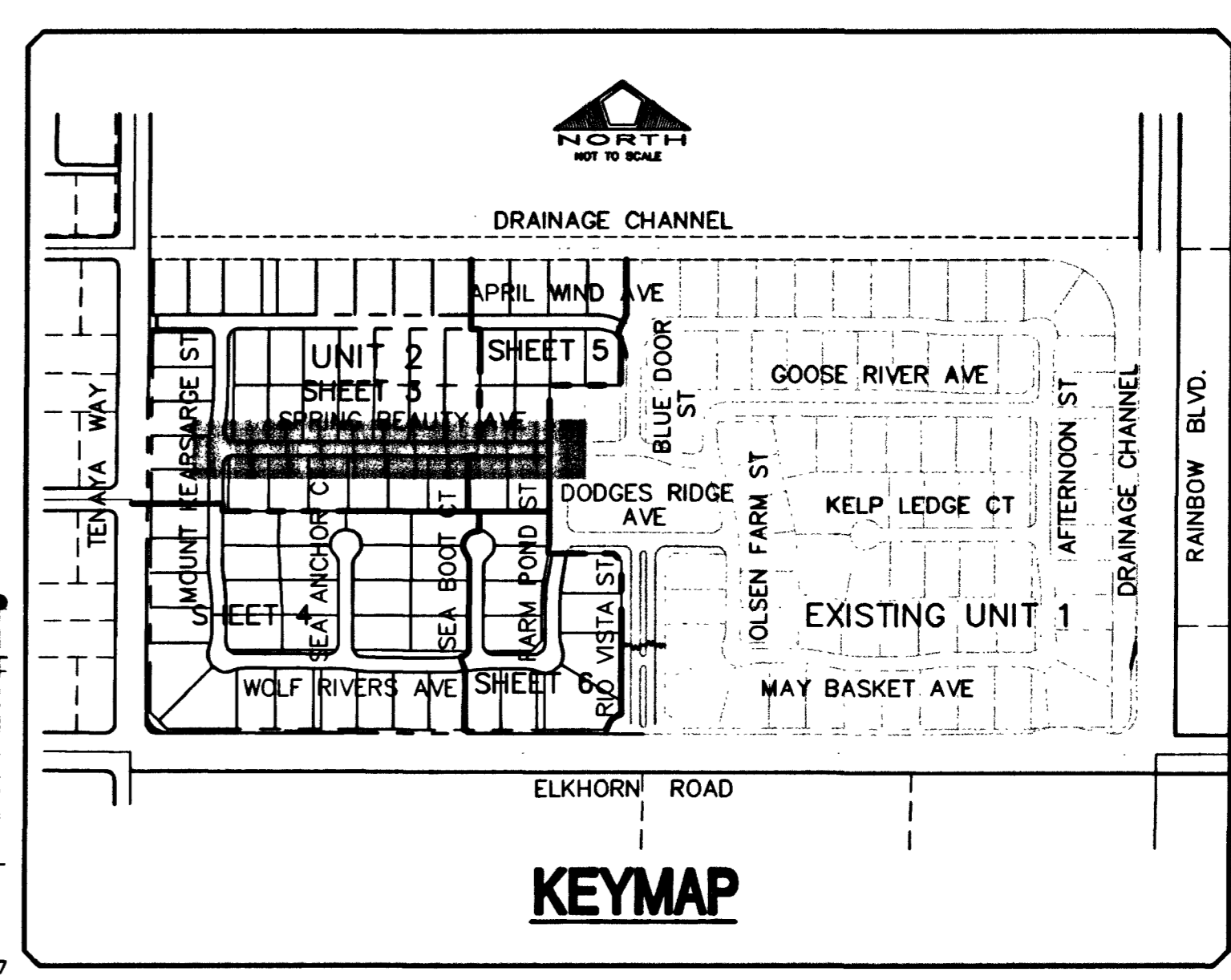

PROFILE

SCALE: HORIZ. 1" = 40'
VERT. 1" = 4'

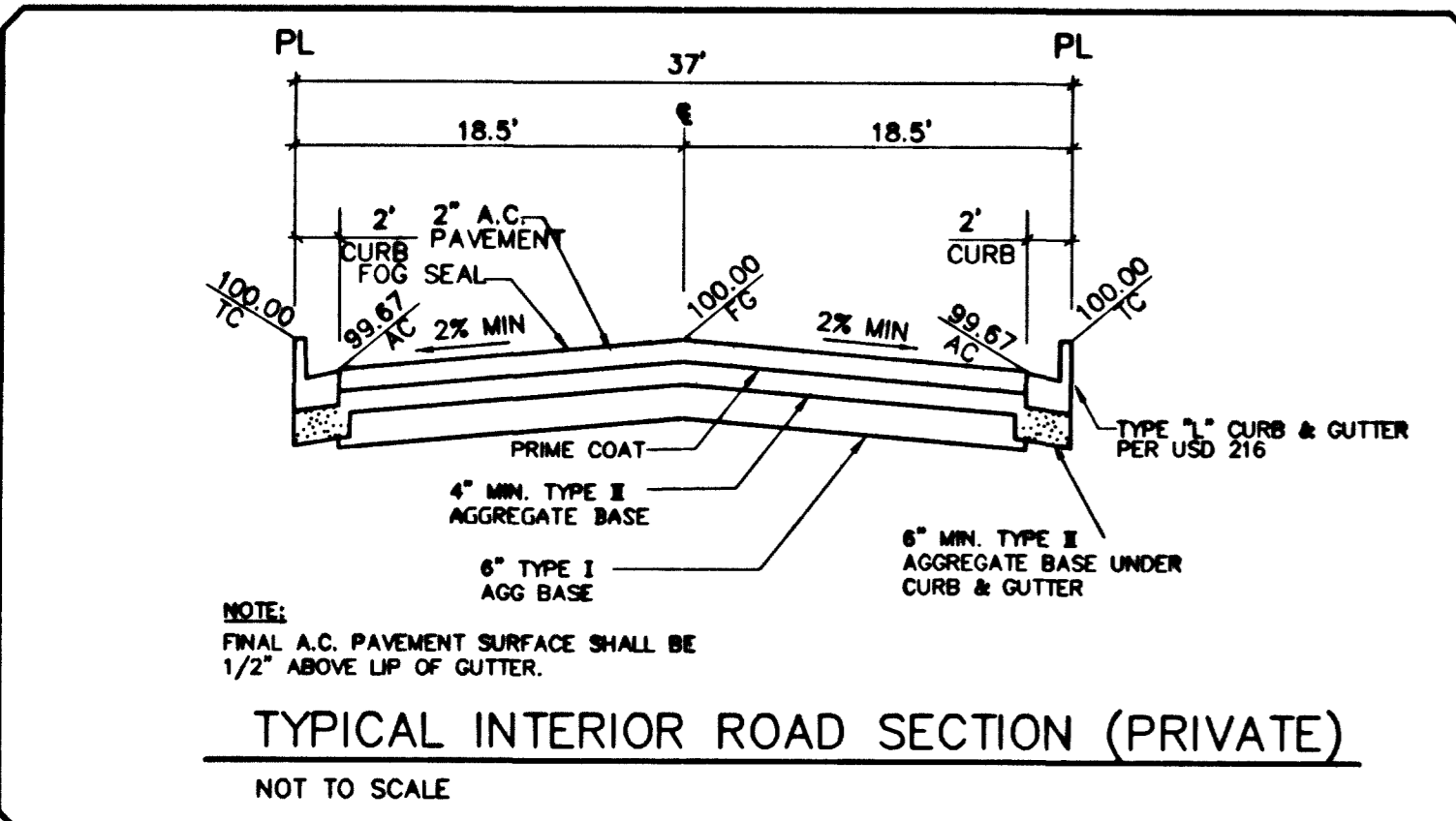
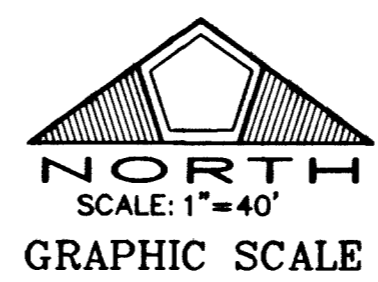

PRIVATE STREET NOTE
NOTE: ALL PRIVATE STREETS ARE PUBLIC DRAINAGE EASEMENTS, CLY SEWER AND PUE EASEMENTS TO BE PRIVATELY MAINTAINED BY THE HOME OWNERS ASSOCIATION.

Call before you Overhead
1-702-593-6111

Call before you Dig.
1-800-227-2800

BENCHMARK
CITY OF LAS VEGAS BENCHMARK NO. 11V90 11SW. RIVET AND PLATE IN TOP OF CURB, SOUTHEAST CORNER OF RAINBOW BLVD AND FLANAGAN DRIVE.
ELEVATION = 724.3103 METERS (NAVD '88 PUBLISHED)
ELEVATION = 2376.34 U.S. SURVEY FEET (NAVD '88 CALCULATED)
PROJECT ELEVATION = 2376.52 U.S. SURVEY FEET

BASIS OF BEARING
THE BASIS OF BEARING FOR THIS SURVEY IS THE WEST LINE OF THE SOUTHEAST QUARTER (SE 1/4) OF SECTION 15, TOWNSHIP 19 SOUTH, RANGE 60 EAST, M.D.M., CLARK COUNTY, NEVADA, AS SHOWN IN FILE 115, PAGE 13 OF OFFICIAL RECORDS, CLARK COUNTY, NEVADA, I.E. NORTH 00°11'55" EAST.

NO.	DESCRIPTION	DATE	APP'D

Stantec Consulting Inc.
7251 West Charleston Blvd
Las Vegas NV U.S.A.
89117
Tel. 702.256.0115
Fax. 702.256.4956
www.stantec.com

Pulte
1635 VILLAGE CENTER CIRCLE, SUITE 200
LAS VEGAS, NEVADA 89134
(702) 266-7900

PULTE HOMES
WETH RANCH UNIT 2
SPRING BEAUTY AVENUE
PLAN AND PROFILE

