

CONSTRUCTION NOTES

- 1 ABANDON MANHOLE
- 2 REMOVE MANHOLE
- 3 LOCATE & ABANDON MANHOLE
- 4 LOCATE & REMOVE MANHOLE
- 5 REMOVE PIPE OR GROUT FILL IN PLACE
- 6 ABANDON PIPE
- 7 REMOVE AREA DRAIN
- 8 REMOVE AND SALVAGE FIRE HYDRANT
- 9 REMOVE DROP INLET COMPLETELY
- 10 ABANDON EXISTING FMCT (PER NOTE ON SHT. 27)

Call before you Dig
1-800-227-2600
MUNICIPAL SERVICE (MS)



LEGEND

—	BOUNDARY/ROW LINE	BCR	BACK OF CURB RETURN
—	CENTERLINE	EX	EXISTING
—	EXISTING RETAINING WALL	F.F.	FINISH FLOOR
—	EXISTING FENCE	FG	FINISH GRADE
—	EX SS	FL	FLOW LINE
—	EXISTING SANITARY SEWER	INT.	INTERSECTION
—	EX SD	—	PROPERTY LINE
—	EXISTING STORM DRAIN	—	SIDWALK
—	EX WTR	—	BACK OF CURB TO BACK
—	EXISTING WATER	—	R/W
—	EXISTING GROUND CONTOUR	—	RIGHT-OF-WAY
—	EXISTING CAP	—	TOP OF CURB
—	EXISTING SPOT ELEVATION	—	TC
—	SPECIAL PIPE	—	CENTERLINE
—	PIPE LOCATION	—	BACK OF CURB
—	EXISTING MANHOLE	—	B/C
—	EXISTING VALVE	—	BACK OF CURB
—	EXISTING BUSH/SHRUB	—	TOP OF RETAINING WALL
—	EXISTING FIRE HYDRANT	—	FTG
—	EXISTING STREET LIGHT	—	TOP OF FOOTING
—		—	HDPE
—		—	HIGH DENSITY POLYETHYLENE
—		—	W.S.E.
—		—	WATER SURFACE ELEVATION
—		—	SD
—		—	STORM DRAIN
—		—	MH
—		—	MANHOLE
—		—	TEL
—		—	TELEPHONE
—		—	CATV
—		—	CABLE TV BOX

BASIS OF BEARING

THE BASIS OF BEARING FOR THIS PROJECT IS THE SOUTH LINE OF THE SOUTHEAST QUARTER OF SECTION 31, TOWNSHIP 20 SOUTH, RANGE 60 EAST, M.D.B.M. WHICH BEARS NORTH 89°40'03" EAST AS SHOWN ON FILE 91, PAGE 27 OF PARCEL MAPS RECORDED IN THE COUNTY RECORDERS OFFICE OF CLARK COUNTY, NEVADA.

BENCHMARK

CITY OF LAS VEGAS BENCHMARK #00LV00 32NWN6
RIVET & PLATE IN TOP OF CURB @ NW CORNER OF ALTA & WEST EXIT TO SUNCOAST RESORT PARKING LOT.
METERS = 844.0507
U.S. SURVEY FEET = 2769.19
NAVD 88, DATUM

OWNER/DEVELOPER

CRESTDALE ASSOCIATES, LTD
1063 LAS PALMAS ENTRADA AVE.
HENDERSON, NEVADA 89012

DEMOLITION NOTES

1. CONTRACTORS SHALL VERIFY ALL CONDITIONS AND DIMENSIONS AND SHALL REPORT ANY DISCREPANCIES TO THE ENGINEER PRIOR TO THE COMMENCEMENT OF WORK.
2. SOME ITEMS TO BE DEMOLISHED MAY BE BURIED. MOST ITEMS HAVE BEEN IDENTIFIED AS SUCH, BUT IT IS THE CONTRACTOR'S RESPONSIBILITY TO REVIEW THE SITE CONDITIONS PRIOR TO THE START OF WORK.
3. INFORMATION SHOWN ON THESE PLANS IS BASED UPON AS-BUILT INFORMATION PROVIDED TO VPPOINT BY PECOLE NEVADA WHICH WAS ANNOTATED BY THE CONTRACTOR THAT INSTALLED THE FACILITIES. VPPOINT ACCEPTS NO LIABILITY FOR THE FACILITIES SHOWN HEREON.
4. ALL EXISTING PIPE TO BE ABANDONED SHALL BE ACCOMPLISHED BY ONE OF THE FOLLOWING METHODS:
 - A. CRUSH IN PLACE
 - B. EXCAVATE AND REMOVE
 - C. PRESSURE GROUTING WITH SAND OR GROUT
5. ALL MANHOLES TO BE ABANDONED SHALL BE ACCOMPLISHED BY ONE OF THE FOLLOWING METHODS:
 - A. CRACK BASE, BACK FILL, CAP WITH 2'-FEET OF CONCRETE
 - B. REMOVE ALL COMPONENTS AND CRACK BASE
6. SEE SHEET 4 FOR DEMOLITION QUANTITY ESTIMATE.
7. CONTRACTOR MAY REMOVE INSTEAD OF ABANDON AT THEIR DISCRETION.

SCALE: 1"=30'

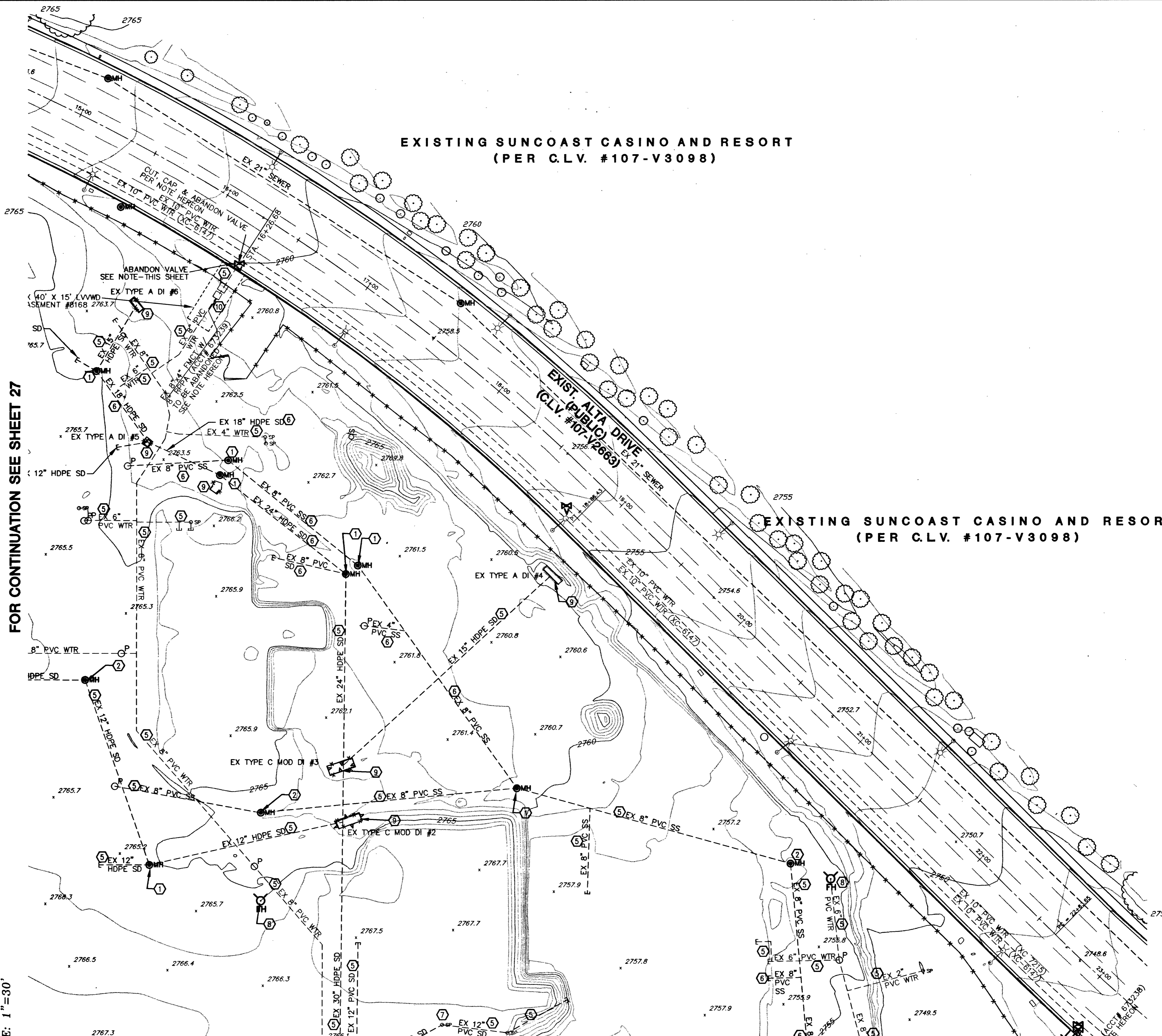
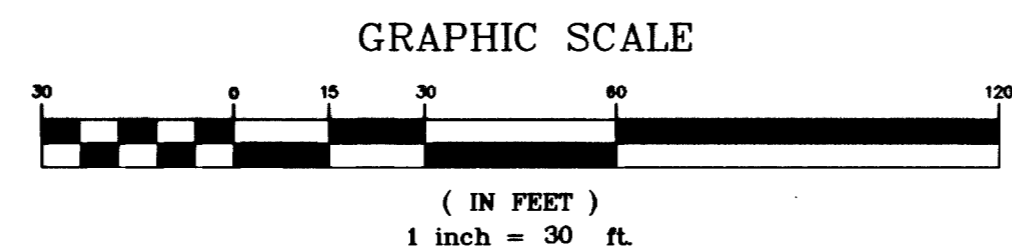

FOR CONTINUATION SEE SHEET 27

FOR CONTINUATION SEE SHEET 29

CRESTDALE ASSOCIATES, LTD 1063 LAS PALMAS ENTRADA AVE. HENDERSON, NEVADA 89012		VPPOINT DESIGNING FOR THE FUTURE PLANNERS • CONSULTING ENGINEERS • SURVEYORS 1008 WINTERS WALK DRIVE • HENDERSON, NEVADA 89044 • (702) 248-6445	
DEMOLITION PLAN (4)	WINDSOR AT QUEENSRIDGE	DRAWN BY: LAAS	CHECKED BY: TRUD
SHEET	TITLE	DESIGNED BY: LAAS	PROJECT NO.: 086-EG00
04/03	04/03	04/03	SCALE: 1"=30'
SHEET D4 30 OF 30 SHEETS DRAWING NO. 107197265			