

- NOTES:
- (1) NO VIEW OBSTRUCTION OVER 30 INCHES ABOVE TOP OF CURB ALLOWED IN SHARED SIGHT TRIANGLE AREA ON WITHIN 5 FEET OF BACK-OF-CURB.
 - (2) SIGHT DISTANCE "S" VALUES PER TABLE 1-1 OF A POLICY ON GEOMETRIC DESIGN OF HIGHWAYS AND STREETS, 1995, PUBLISHED BY THE AMERICAN ASSOCIATION OF STATE HIGHWAY AND TRANSPORTATION OFFICIALS (AASHTO).
 - (3) MINIMUM A TO A1-VIEW A TO A2 DISTANCE SHALL BE 25 FEET.
 - (4) STREETS EXPECTED TO CARRY MORE THAN 2500 VEHICLES PER DAY SHALL BE SUBJECT TO REQUIREMENTS OF DOW HO, DC-4 RATHER THAN THIS STANDARD.

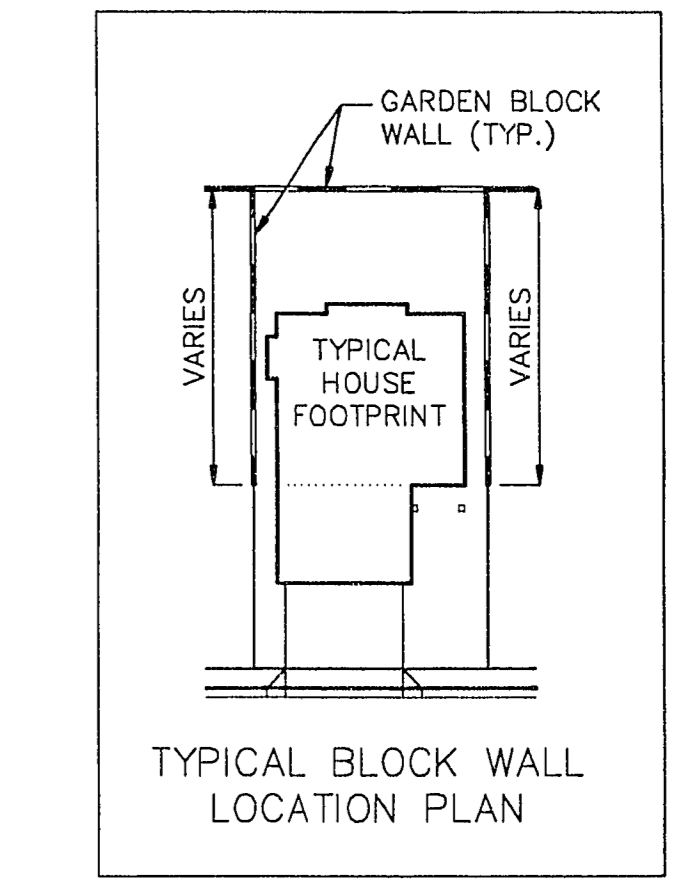

I CERTIFY THAT THIS GRADING PLAN COMPLIES WITH THE APPROVED DRAINAGE STUDY ON FILE WITH THE CITY OF LAS VEGAS.

DEAN W. RASMUSON DATE

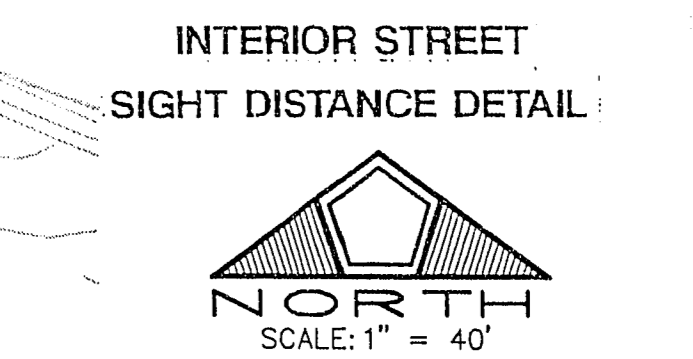
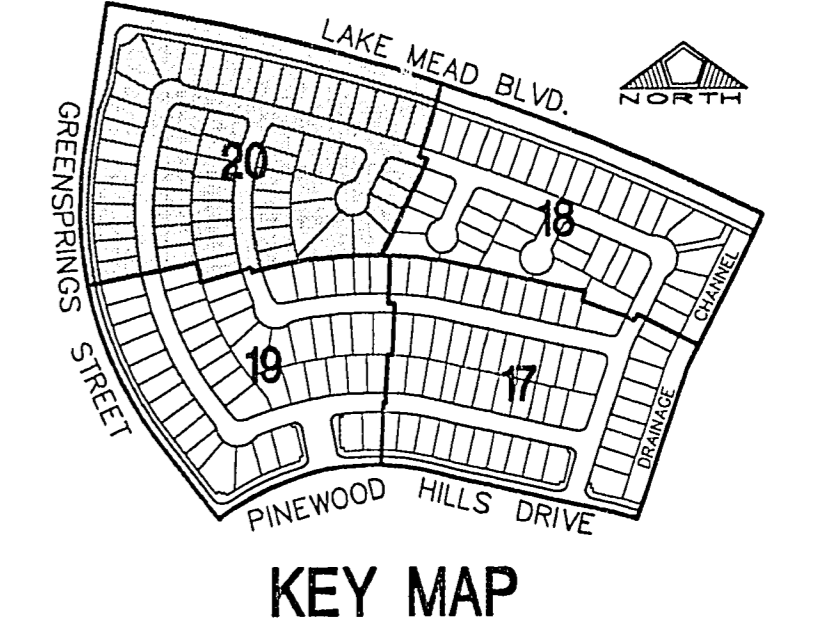

DESIGN & CONSTRUCTION OF LANDSCAPING & VILLAGE WALL BY SUMMERLIN

DISK # H-CR-4

NO.	DESCRIPTION	DATE
1	2588-0115-01	12/27/03
2	2588-0115-02	12/27/03
3	2588-0115-03	12/27/03
4	2588-0115-04	12/27/03
5	2588-0115-05	12/27/03
6	2588-0115-06	12/27/03
7	2588-0115-07	12/27/03
8	2588-0115-08	12/27/03
9	2588-0115-09	12/27/03
10	2588-0115-10	12/27/03
11	2588-0115-11	12/27/03
12	2588-0115-12	12/27/03
13	2588-0115-13	12/27/03
14	2588-0115-14	12/27/03
15	2588-0115-15	12/27/03
16	2588-0115-16	12/27/03
17	2588-0115-17	12/27/03
18	2588-0115-18	12/27/03
19	2588-0115-19	12/27/03
20	2588-0115-20	12/27/03
21	2588-0115-21	12/27/03
22	2588-0115-22	12/27/03
23	2588-0115-23	12/27/03
24	2588-0115-24	12/27/03
25	2588-0115-25	12/27/03
26	2588-0115-26	12/27/03
27	2588-0115-27	12/27/03
28	2588-0115-28	12/27/03
29	2588-0115-29	12/27/03
30	2588-0115-30	12/27/03
31	2588-0115-31	12/27/03
32	2588-0115-32	12/27/03
33	2588-0115-33	12/27/03
34	2588-0115-34	12/27/03
35	2588-0115-35	12/27/03
36	2588-0115-36	12/27/03
37	2588-0115-37	12/27/03
38	2588-0115-38	12/27/03
39	2588-0115-39	12/27/03
40	2588-0115-40	12/27/03
41	2588-0115-41	12/27/03
42	2588-0115-42	12/27/03
43	2588-0115-43	12/27/03
44	2588-0115-44	12/27/03
45	2588-0115-45	12/27/03
46	2588-0115-46	12/27/03
47	2588-0115-47	12/27/03
48	2588-0115-48	12/27/03
49	2588-0115-49	12/27/03
50	2588-0115-50	12/27/03
51	2588-0115-51	12/27/03
52	2588-0115-52	12/27/03
53	2588-0115-53	12/27/03
54	2588-0115-54	12/27/03
55	2588-0115-55	12/27/03
56	2588-0115-56	12/27/03
57	2588-0115-57	12/27/03
58	2588-0115-58	12/27/03
59	2588-0115-59	12/27/03
60	2588-0115-60	12/27/03
61	2588-0115-61	12/27/03
62	2588-0115-62	12/27/03
63	2588-0115-63	12/27/03
64	2588-0115-64	12/27/03
65	2588-0115-65	12/27/03
66	2588-0115-66	12/27/03
67	2588-0115-67	12/27/03
68	2588-0115-68	12/27/03
69	2588-0115-69	12/27/03
70	2588-0115-70	12/27/03
71	2588-0115-71	12/27/03
72	2588-0115-72	12/27/03
73	2588-0115-73	12/27/03
74	2588-0115-74	12/27/03
75	2588-0115-75	12/27/03
76	2588-0115-76	12/27/03
77	2588-0115-77	12/27/03
78	2588-0115-78	12/27/03
79	2588-0115-79	12/27/03
80	2588-0115-80	12/27/03
81	2588-0115-81	12/27/03
82	2588-0115-82	12/27/03
83	2588-0115-83	12/27/03
84	2588-0115-84	12/27/03
85	2588-0115-85	12/27/03
86	2588-0115-86	12/27/03
87	2588-0115-87	12/27/03
88	2588-0115-88	12/27/03
89	2588-0115-89	12/27/03
90	2588-0115-90	12/27/03
91	2588-0115-91	12/27/03
92	2588-0115-92	12/27/03
93	2588-0115-93	12/27/03
94	2588-0115-94	12/27/03
95	2588-0115-95	12/27/03
96	2588-0115-96	12/27/03
97	2588-0115-97	12/27/03
98	2588-0115-98	12/27/03
99	2588-0115-99	12/27/03
100	2588-0115-100	12/27/03
101	2588-0115-101	12/27/03
102	2588-0115-102	12/27/03
103	2588-0115-103	12/27/03
104	2588-0115-104	12/27/03
105	2588-0115-105	12/27/03
106	2588-0115-106	12/27/03
107	2588-0115-107	12/27/03
108	2588-0115-108	12/27/03
109	2588-0115-109	12/27/03
110	2588-0115-110	12/27/03
111	2588-0115-111	12/27/03
112	2588-0115-112	12/27/03
113	2588-0115-113	12/27/03
114	2588-0115-114	12/27/03
115	2588-0115-115	12/27/03
116	2588-0115-116	12/27/03
117	2588-0115-117	12/27/03
118	2588-0115-118	12/27/03
119	2588-0115-119	12/27/03
120	2588-0115-120	12/27/03
121	2588-0115-121	12/27/03
122	2588-0115-122	12/27/03
123	2588-0115-123	12/27/03
124	2588-0115-124	12/27/03
125	2588-0115-125	12/27/03
126	2588-0115-126	12/27/03
127	2588-0115-127	12/27/03
128	2588-0115-128	12/27/03
129	2588-0115-129	12/27/03
130	2588-0115-130	12/27/03
131	2588-0115-131	12/27/03
132	2588-0115-132	12/27/03
133	2588-0115-133	12/27/03
134	2588-0115-134	12/27/03
135	2588-0115-135	12/27/03
136	2588-0115-136	12/27/03
137	2588-0115-137	12/27/03
138	2588-0115-138	12/27/03
139	2588-0115-139	12/27/03
140	2588-0115-140	12/27/03
141	2588-0115-141	12/27/03
142	2588-0115-142	12/27/03
143	2588-0115-143	12/27/03
144	2588-0115-144	12/27/03
145	2588-0115-145	12/27/03
146	2588-0115-146	12/27/03
147	2588-0115-147	12/27/03
148	2588-0115-148	12/27/03
149	2588-0115-149	12/27/03
150	2588-0115-150	12/27/03
151	2588-0115-151	12/27/03
152	2588-0115-152	12/27/03
153	2588-0115-153	12/27/03
154	2588-0115-154	12/27/03
155	2588-0115-155	12/27/03
156	2588-0115-156	12/27/03
157	2588-0115-157	12/27/03
158	2588-0115-158	12/27/03
159	2588-0115-159	12/27/03
160	2588-0115-160	12/27/03
161	2588-0115-161	12/27/03
162	2588-0115-162	12/27/03
163	2588-0115-163	12/27/03
164	2588-0115-164	12/27/03
165	2588-0115-165	12/27/03
166	2588-0115-166	12/27/03
167	2588-0115-167	12/27/03
168	2588-0115-168	12/27/03
169	2588-0115-169	12/27/03
170	2588-0115-170	12/27/03
171	2588-0115-171	12/27/03
172	2588-0115-172	12/27/03
173	2588-0115-173	12/27/03
174	2588-0115-174	12/27/03
175	2588-0115-175	12/27/03
176	2588-0115-176	12/27/03
177	2588-0115-177	12/27/03
178	2588-0115-178	12/27/03
179	2588-0115-179	12/27/03
180	2588-0115-180	12/27/03
181	2588-0115-181	12/27/03
182	2588-0115-182	12/27/03
183	2588-0115-183	12/27/03
184	2588-0115-184	12/27/03
185	2588-0115-185	12/27/03
186	2588-0115-186	12/27/03
187	2588-0115-187	12/27/03
188	2588-0115-188	12/27/03
189	2588-0115-189	12/27/03
190	2588-0115-190	12/27/03
191	2588-0115-191	12/27/03
192	2588-0115-192	12/27/03
193	2588-0115-193	12/27/03
194	2588-0115-194	12/27/03
195	2588-0115-195	12/27/03
196	2588-0115-196	12/27/03
197	2588-0115-197	12/27/03
198	2588-0115-198	12/27/03
199	2588-0115-199	12/27/03
200	2588-0115-200	12/27/03

RECOMMENDED BY: [Signature]

DATE: 12/27/03

DESIGNED BY: CWC

CHECKED BY: DWR

JOB NO.: 00301020

SCALE: 1" = 40'

LEWIS HOMES OF NEVADA

WILLOW TREE

GRADING PLAN IV

PENTACORE

Engineering, Inc.

6763 West Charleston Boulevard
Las Vegas, Nevada 89102

(702) 258-0115

SHEET 20 OF 29

1074-4242