

**BASIS OF BEARING**  
NORTH 88°31'18" EAST, BEING THE BEARING OF THE SOUTH LINE OF THE NORTHWEST QUARTER (NW 1/4) OF THE SOUTHEAST QUARTER (SE 1/4) OF SECTION 28, TOWNSHIP 20 SOUTH, RANGE 60 EAST, M.D.M., AS SHOWN ON A MAP ON FILE IN THE CLARK COUNTY, NEVADA RECORDER'S OFFICE AS FILE 109, PAGE 2 OF PARCEL MAPS.

**WHEELCHAIR RAMP DATA**

No.	"A"	"B"
1	8.0'	8.0'

**SOILS REPORT**  
GEOTEK, INC. - NEVADA  
DATED FEBRUARY 3, 2011  
PROJECT No. 10251-LV8  
UPDATED: MARCH 12, 2012

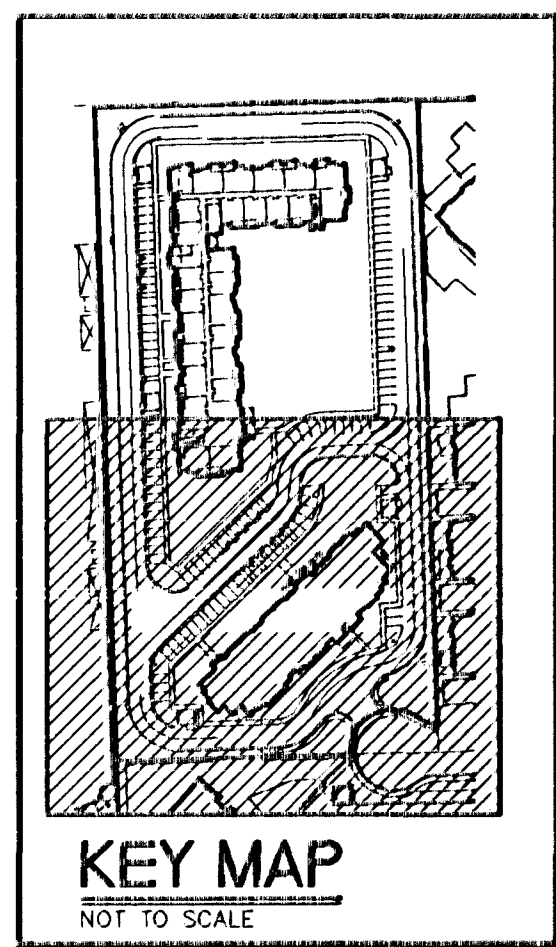

- CONSTRUCTION NOTES**
- CONSTRUCT 5" WIDE CONCRETE SIDEWALK PER U.S. DWG. 1234
  - CONSTRUCT 2" CURB TRANSITION PER DETAIL 3, SHEET D11
  - CONSTRUCT 3" VALLEY CUTTER PER DETAIL 8, SHEET D11
  - CONSTRUCT SIDEWALK UNDERDRAIN PER DETAIL 6, SHEET D11
  - MIN. 5' LANDINGS SHALL BE INSTALLED AT ALL DOORS PER ANSI/AIA 117.1 2009 404.2.3 (1/4-INCH MAX BELOW THRESHOLD) 2.0% MAX. SLOPE
  - CONSTRUCT COMMERCIAL DRIVEWAY PER USD. STD. DWG. No. 225
  - CONSTRUCT "A" TYPE CURB PER DETAIL 2, SHEET D11
  - CONSTRUCT CONCRETE FLUME PER DETAIL 7, SHEET D11
  - CONSTRUCT ASPHALT PER PAVEMENT DETAIL 4, SHEET D11
  - INSTALL CONCRETE BUMPERS PER DETAIL 3, SHEET D11
  - CONSTRUCT "L" TYPE CURB & OUTER PER USD DWG. #216 AND DETAIL 1 SHEET D11 WHERE LONGITUDINAL SLOPE IS LESS THAN 0.40%. THE FLOW LINE SHALL BE WATER TESTED.
  - CONSTRUCT STEPS AS NEEDED
  - INSTALL HANDICAP SIGNAGE PER I.B.C. 2009 1110 AND ICC A117-1-2009-501
  - CONSTRUCT 8" CONCRETE CROSS CUTTER PER STD. DWG. 223
  - CONCRETE ISLAND NOSE
  - CONSTRUCT DRAINAGE SWALE @ 1.0% MIN.
  - RAMP @ 1:12 MAX. (TYP.) 8.33%
  - CONSTRUCT DEPRESSED CURB PER DETAIL 5, SHEET D11
  - INSTALL ADA HAND RAILING PER ADA AND ICC STANDARDS
  - CONSTRUCT SIDEWALK RAMPS USING ARMOR TILE TRUNCATED DOMES OR EQUIVALENT PER OCCAUSD No. 235 (CASE I)
  - NOT USED
  - OFFSITE AC SHALL BE 3" ASPHALT OVER 4" TYPE II
  - STORM DRAIN INLET TO BE CONSTRUCTED AND MUST COMPLY WITH USDOCA DWG. No. #21 (STORM WATER QUALITY MANAGEMENT STAMP AND SIGN DETAIL) ALSO REFER TO DETAIL 13, 14 AND 15 ON SHEET D12
  - TRASH ENCLOSURE REFER TO ARCHITECTURAL PLANS FOR ADDITIONAL INFORMATION.
  - ROOF DRAINS, APPROXIMATE LOCATION (TYP.)

- NOTE:**
- ALL ABOVE GROUND UTILITY APPURTENANCES SHALL CONFORM TO THE REQUIREMENTS OF TITLE 19.08.010
  - FINAL SIDEWALK ELEVATION TO MATCH FINISH FLOOR ELEVATION AFTER FLOORING MATERIAL HAS BEEN PLACED.
  - ALL ONSITE STORM DRAINS AND ASSOCIATED FACILITIES ARE PRIVATELY OWNED AND TO BE PRIVATELY MAINTAINED.

**DISCLAIMER NOTE**

UTILITY LOCATIONS SHOWN HEREON ARE APPROXIMATE ONLY. IT SHALL BE THE CONTRACTOR'S RESPONSIBILITY TO DETERMINE THE EXACT HORIZONTAL AND VERTICAL LOCATION OF ALL EXISTING UNDERGROUND AND OVERHEAD UTILITIES PRIOR TO COMMENCING CONSTRUCTION. NO REPRESENTATION IS MADE THAT ALL EXISTING UTILITIES ARE SHOWN HEREON. THE ENGINEER ASSUMES NO RESPONSIBILITY FOR UTILITIES NOT SHOWN OR UTILITIES NOT SHOWN IN THEIR PROPER LOCATION.

Call before you Dig  
Avoid cutting underground utility lines. It's costly.

811  
1-800-227-2600  
CLARK COUNTY TRAFFIC OPERATIONS  
1-702-455-7544

Avoid overhead power line contact

CALL BEFORE YOU DO OVERHEAD  
1-702-227-2929  
NEVADA POWER ENVIRONMENT AND SAFETY SERVICES DEPARTMENT

CALL BEFORE YOU DO UNDERGROUND  
before you Call Underground  
1-702-455-7511  
CLARK COUNTY TRAFFIC OPERATIONS  
1-702-432-5300  
LAS VEGAS AREA COMPUTERIZED TRAFFIC SYSTEM

**FEMA FLOOD PLAIN INFORMATION**  
ACCORDING TO THE FEDERAL EMERGENCY MANAGEMENT AGENCY (FEMA) FLOOD INSURANCE RATE MAP (FIRM) COMMUNITY-PANE NUMBERS 32003C 2145E, DATE SEPTEMBER 27, 2002, THE SITE IS LOCATED WITHIN A ZONE "X". A ZONE "X" IS DESCRIBED BY FEMA AS AN AREA OUTSIDE OF THE 0.2% ANNUAL CHANCE FLOODPLAIN.

**BENCHMARK**  
FOUND RIVET AND PLATE IN THE TOP OF CURB AT THE NW CORNER OF WESTCLIFF AND CIMARRON  
#909 OLVOO 2854  
777.844 (m) 2591.98 (ft)

WE CERTIFY THAT THIS GRADING PLAN IS IN CONFORMANCE WITH THE APPROVED DRAINAGE STUDY ON FILE AT THE CITY OF LAS VEGAS FOR THIS PROJECT (DS 4550A).

*VRIC*  
VERNON R. HARKINS P.E. NO. 009898  
6/21/12 DATE

**DEVELOPER**  
NEVADA H.A.N.D.  
295 WARM SPRINGS ROAD SUITE 101  
LAS VEGAS, NEVADA 89119-4212  
TEL: (702) 410-2730  
CONTACT: ROBERT FEIBLEMAN

**OWNER**  
WESTCLIFF PINES 2, L.P.  
295 WARM SPRINGS ROAD SUITE 101  
LAS VEGAS, NEVADA 89119-4212  
TEL: (702) 410-2730  
CONTACT: ROBERT FEIBLEMAN

APPRO BY DATE APPRO

REV NO. REVISION DESCRIPTION

**NEVADA HAND.**  
295 EAST WARM SPRINGS ROAD SUITE 101  
LAS VEGAS, NEVADA 89119-4212  
TEL: (702) 739-3345 CONTACT: ROBERT FEIBLEMAN

**L.R. NELSON CONSULTING ENGINEERS, INC.**  
0705 West Russell Road  
Suite 200  
Las Vegas, NV 89115  
(702) 796-7979  
(702) 431-2566 FAX

**WESTCLIFF PINES 2**  
ROLAND WLEY ROAD AND SILVER SKY DRIVE  
CITY OF LAS VEGAS

GRADING PLAN 2

SHEET 12  
MGV 12  
MGV 12

DRAWN BY: TP  
DESIGNED BY: TP  
CHECKED BY: RT

PROJECT NO: 818-021-113  
SCALE: 1" = 20'

SEAL  
VERNON R. HARKINS  
EXP 8/30/10  
CIVIL  
NO. 009898

SHEET 5 OF 20 SHEETS  
CLV DRAWING NO. 10715222-2