

V:\101099 - West Service Center\CIVIL\C403GRD.dwg, 03/11/03 04:50:26 PM, B Floor

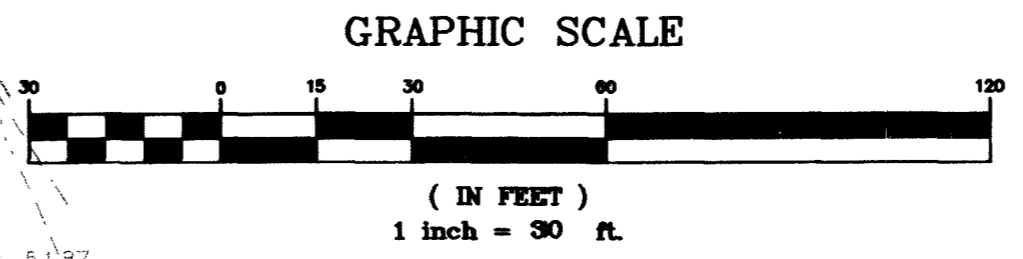
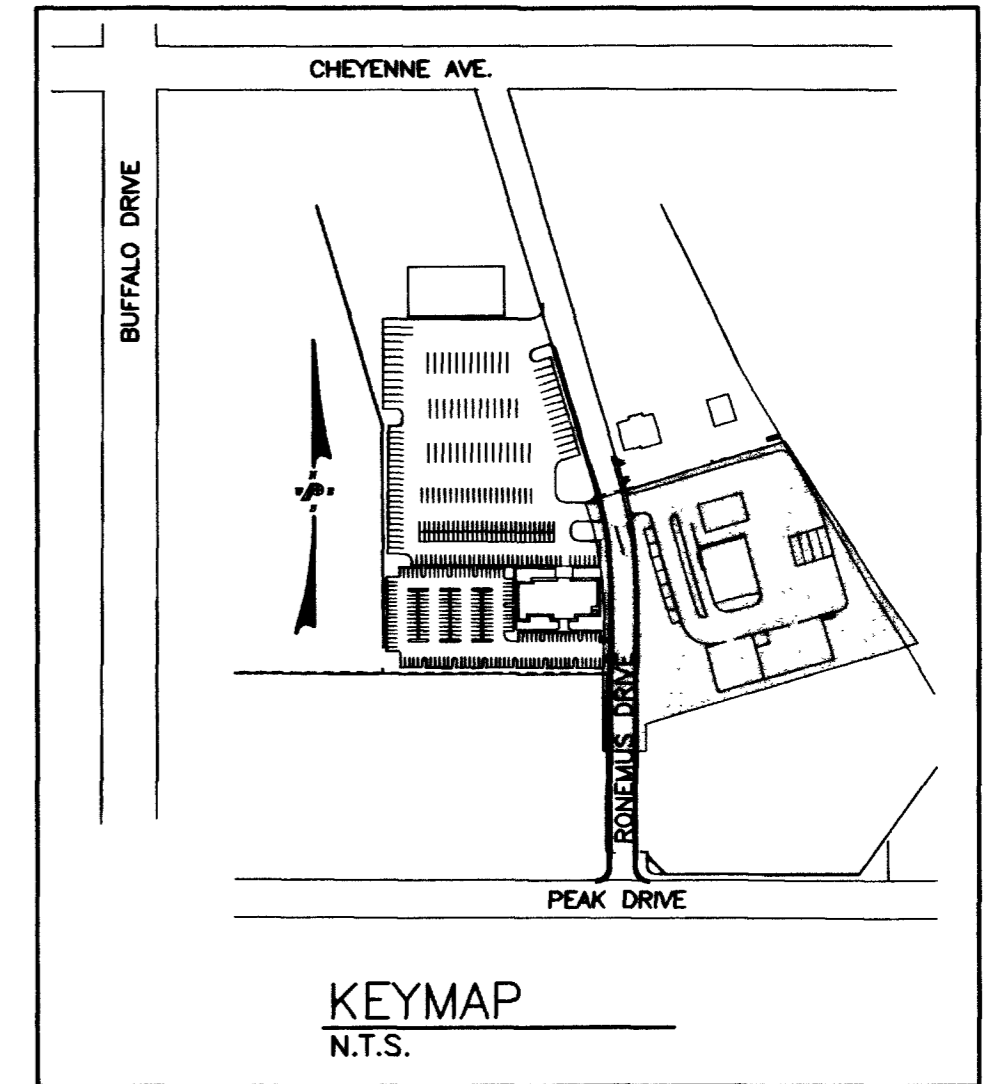
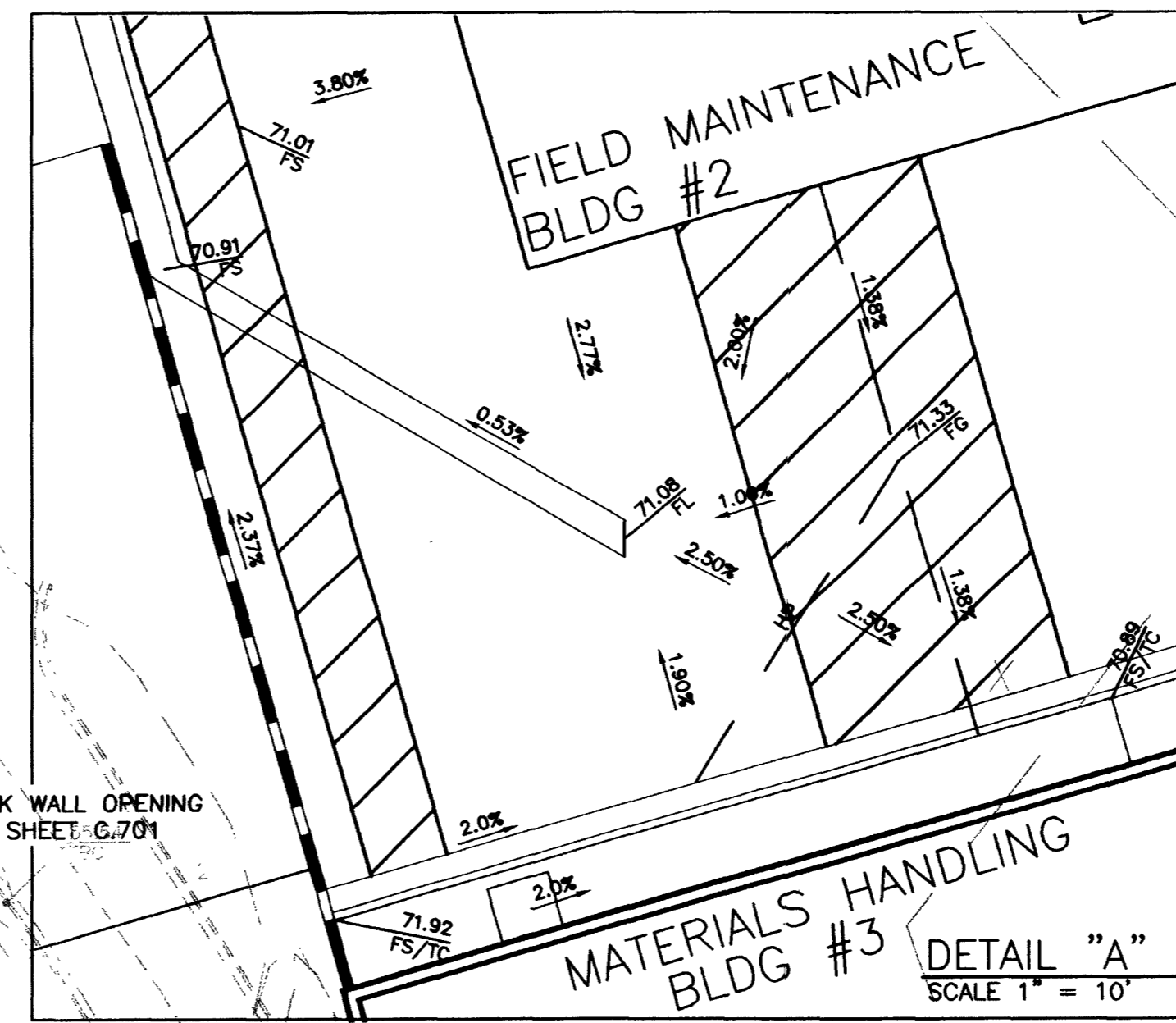
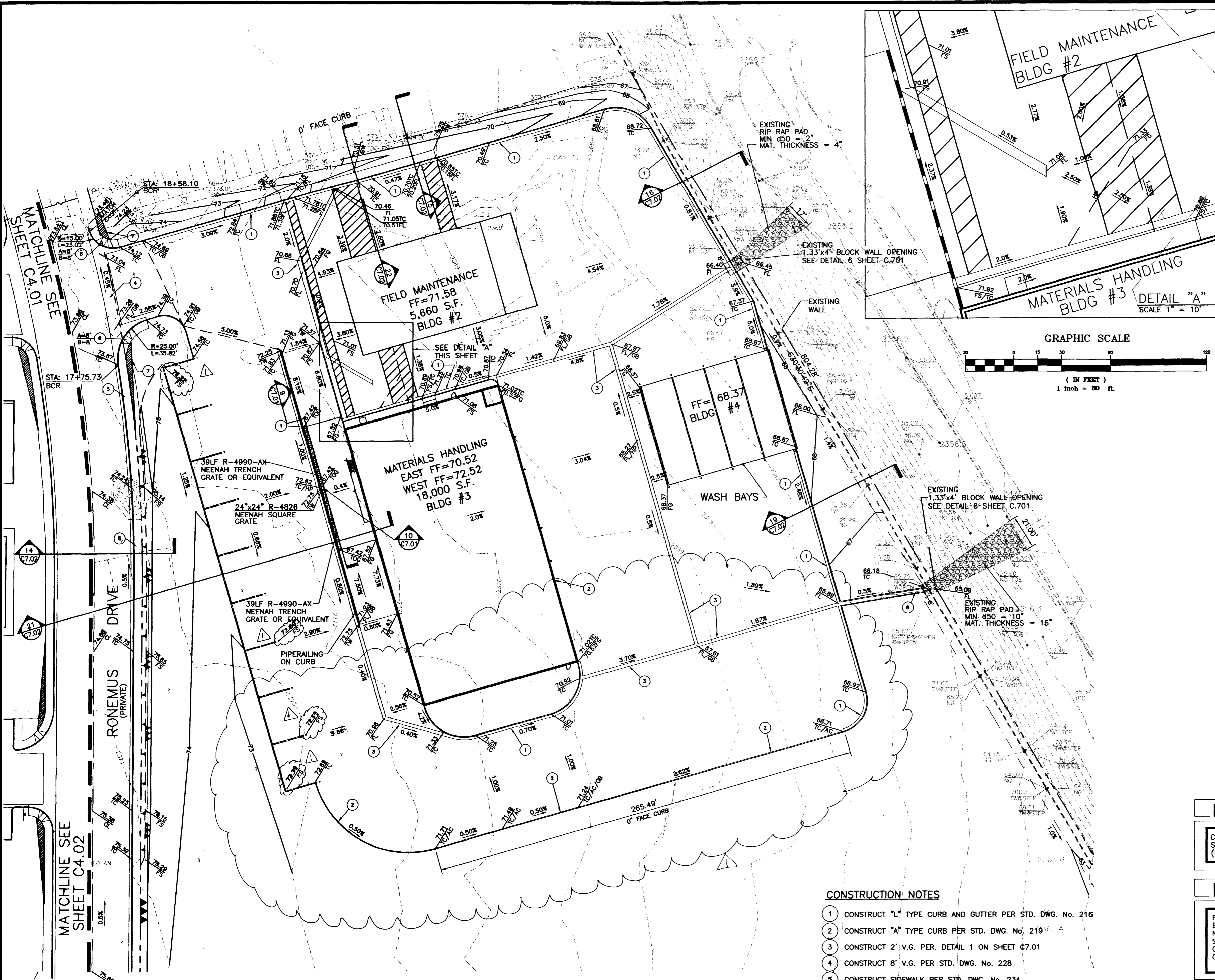

### LEGEND

	DETAIL/SECTION IDENTIFICATION LETTER OR NUMBER
	SHEET DETAIL IS SHOWN
	EXISTING MANHOLE
	EXISTING WATER VALVE
	EXISTING FIRE HYDRANT
	EXISTING SIGN
	EXISTING POWER POLE
	EXISTING WATER LINE
	EXISTING GAS LINE
	EXISTING ELECTRICAL LINE
	EXISTING SANITARY SEWER LINE
	EXISTING STORM DRAIN LINE
	EXISTING TELEPHONE LINE
	EXISTING CONTOUR
	EXISTING CHAIN-LINK FENCE
	EXISTING ELEVATION
	EXISTING EDGE OF PAVEMENT
	EXISTING STREET LIGHT
	PROPOSED MANHOLE
	PROPOSED FIRE HYDRANT
	PROPOSED SIGN
	PROPOSED STREET LIGHT
	PROPOSED WATER LINE
	PROPOSED SANITARY SEWER LINE
	PROPOSED STORM DRAIN LINE
	NEW ELEVATION
	RIGHT OF WAY LINE
	CENTERLINE
	PROPERTY LINE
	FLOW LINE
	PROPOSED STREET LIGHT CONDUIT
	PROPOSED WALL
	GRADE BREAK
	SIGHT VISIBILITY RESTRICTION ZONE NOTHING OVER 24" IN HEIGHT ALLOWED IN SVRZ EXCEPT TRAFFIC CONTROL

### BENCHMARK

CLV BM 0LV0015N4: RIVET AND PLATE IN TOP OF CURB SOUTH SIDE OF CHEYENNE & +/- 600 FT WEST OF TENAYA, ELEV. 2335.78' (NAVD88)

### BASIS OF BEARING

PORTION OF CENTERLINE OF BUFFALO DRIVE, BEARS N00°20'23"E, BEING THE WEST LINE THE NORTHEAST QUARTER (NW 1/4) OF THE NORTHWEST QUARTER (NW 1/4) OF SECTION 15, TOWNSHIP 20 SOUTH, RANGE 60 EAST, M.D.M., CLARK COUNTY, NEVADA, AS SHOWN ON THE PARCEL MAP RECORDED IN FILE 50 OF PARCELS, PAGE 41, CLARK COUNTY, NEVADA, RECORDERS.

### CONSTRUCTION NOTES

- CONSTRUCT "L" TYPE CURB AND GUTTER PER STD. DWG. No. 216
- CONSTRUCT "A" TYPE CURB PER STD. DWG. No. 219 & 214
- CONSTRUCT 2" V.G. PER DETAIL 1 ON SHEET C7.01
- CONSTRUCT 8" V.G. PER STD. DWG. No. 228
- CONSTRUCT SIDEWALK PER STD. DWG. No. 234
- CONSTRUCT HANDICAP RAMP PER STD. DWG. No. 235 CASE 1
- SIGHT VISIBILITY RESTRICTION ZONE NOTHING OVER 24" IN HEIGHT ALLOWED IN SVRZ EXCEPT TRAFFIC CONTROL
- CONSTRUCT 4" U-CHANNEL PER DETAIL 2 ON SHEET C7.01

I CERTIFY THAT THIS GRADING PLAN IS IN CONFORMANCE WITH THE APPROVED DRAINAGE STUDY ON FILE WITH THE CITY OF LAS VEGAS FOR THIS PROJECT.  
*Kristina L. Swallow*  
KRISTINA L. SWALLOW NO. 13714 DATE 3/12/03



Call before you Dig. 1-800-227-2600

DATE	3/11/03
BY	KL
REV	
DATE	
BY	
REV	
DATE	
BY	
REV	

TATE SNYDER KIMSEY ARCHITECTS  
709 VALLE VERDE COURT  
HENDERSON, NEVADA 89104  
TEL (702) 456-3000  
FAX (702) 898-6209

POGEMEYER DESIGN GROUP  
ENGINEERS PLANNERS SURVEYORS  
LANDSCAPE ARCHITECTS  
2601 NORTH TENAYA WAY LAS VEGAS, NEVADA 89128 (702) 256-9100

**GRADING PLAN III**

**CITY OF LAS VEGAS**

**WEST SERVICE CENTER**

DRAWN BY:	KL	12.12.02
DESIGNED BY:	KL	12.12.02
CHECKED BY:	KL	12.12.02
PROJECT NO.:	01099	
SCALE:	1" = 30' HOR. VERT.	

STATE OF NEVADA  
PLANNING & CONSTRUCTION  
DIVISION  
REGISTERED PROFESSIONAL ENGINEER  
No. 8-98-04  
Exp. 8-31-04  
CIVIL  
111853-0001  
1/131

SHEET  
**C4.03**  
11 OF 19 SHEETS  
DRAWING NO.  
**107-V3548**

Replot BID. No. 02.15341.09