

WASHINGTON AVENUE

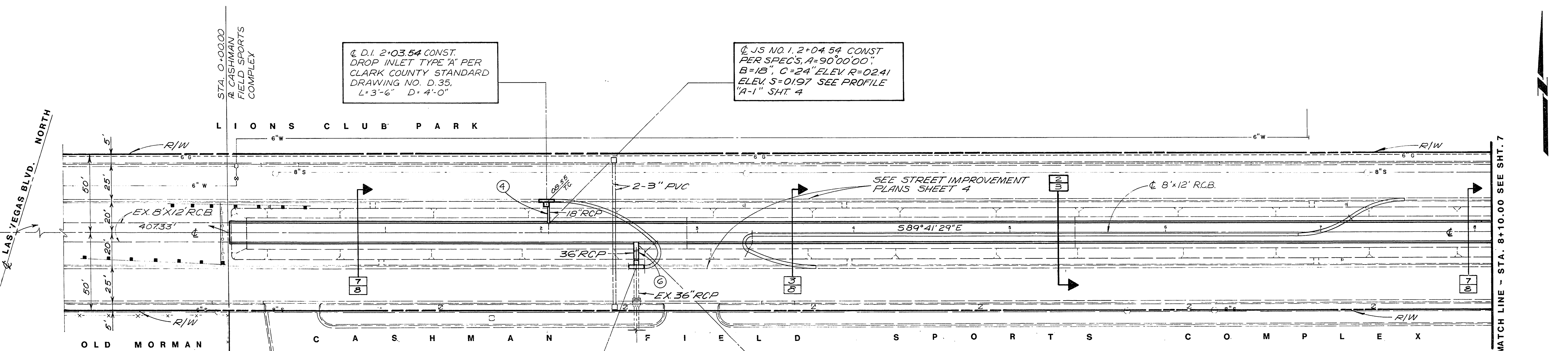

CL D.I. 2+03.54 CONST.
DROP INLET TYPE "A" PER
CLARK COUNTY STANDARD
DRAWING NO. D.35,
L=3'-6" D=4'-0"

CL JS NO. 1, 2+04.54 CONST
PER SPECS, A=90°00'00",
B=18", C=24" ELEV R=02.41
ELEV S=01.97 SEE PROFILE
"A-1" SHT. 4

CL D.I. 2+60.85 CONST.
DROP INLET TYPE "A" PER
CLARK COUNTY STANDARD
DRAWING NO. D.35,
L=3'-6"

CL JS NO. 1, 2+60.85 CONST
PER SPECS, A=90°00'00",
B=36", C=24" ELEV R=98.00
ELEV S=97.92 SEE PROFILE
"A-2" SHT. 4

CONSTRUCTION NOTES

- ④ 18" RCP (1000-D)
- ⑥ 36" RCP (1000-D)

RECORD DRAWING
This drawing is a record of the work shown on the preceding sheets. It is not to be used for construction purposes. The contractor is responsible for any errors or omissions which may be incorporated herein as a result.



AS BUILT DRAWING

SCALE: HORIZ. 1" = 30' VERT. 1" = 6'		DESIGNED: <u>G. LAKE</u> DRAWN: <u>Ropp-Theisen</u> CHECKED: <u>G. LAKE</u>	SUBMITTED: <u>Gary Lake</u> 5464 10-7-82 R.P.E. NO. DATE	RECOMMENDED: <u>Richard J. Island</u> 2315 10/7/82 R.P.E. NO. DATE	APPROVED: _____ DATE _____ APPROVED: _____ DATE _____	CITY OF LAS VEGAS WASHINGTON AVENUE CHANNEL R.C.B. PLAN & PROFILE STA. 0+00.00 TO STA. 8+10.00	SHEET 6 OF 9 SHEETS
--	--	---	--	--	--	---	----------------------------------

MONTGOMERY ENGINEERS OF NEVADA
1100 EAST SAHARA AVENUE, LAS VEGAS, NEVADA 89104

JOB NO. 5502.0070