

8+86.06 45' LT. CONST. DROP INLET
TYPE I
8+86.06 45' LT. TO 9+49.0 14' LT. INSTALL
70.14 L.F. OF 18" S.S.P.

8+91.58 45' LT. TO 9+42.59 45' LT
CONST. ALLEY GUTTER

WASHINGTON AVENUE

D-LOAD CHART	
LEG	D-LOAD/ULT.
	1049
	1049

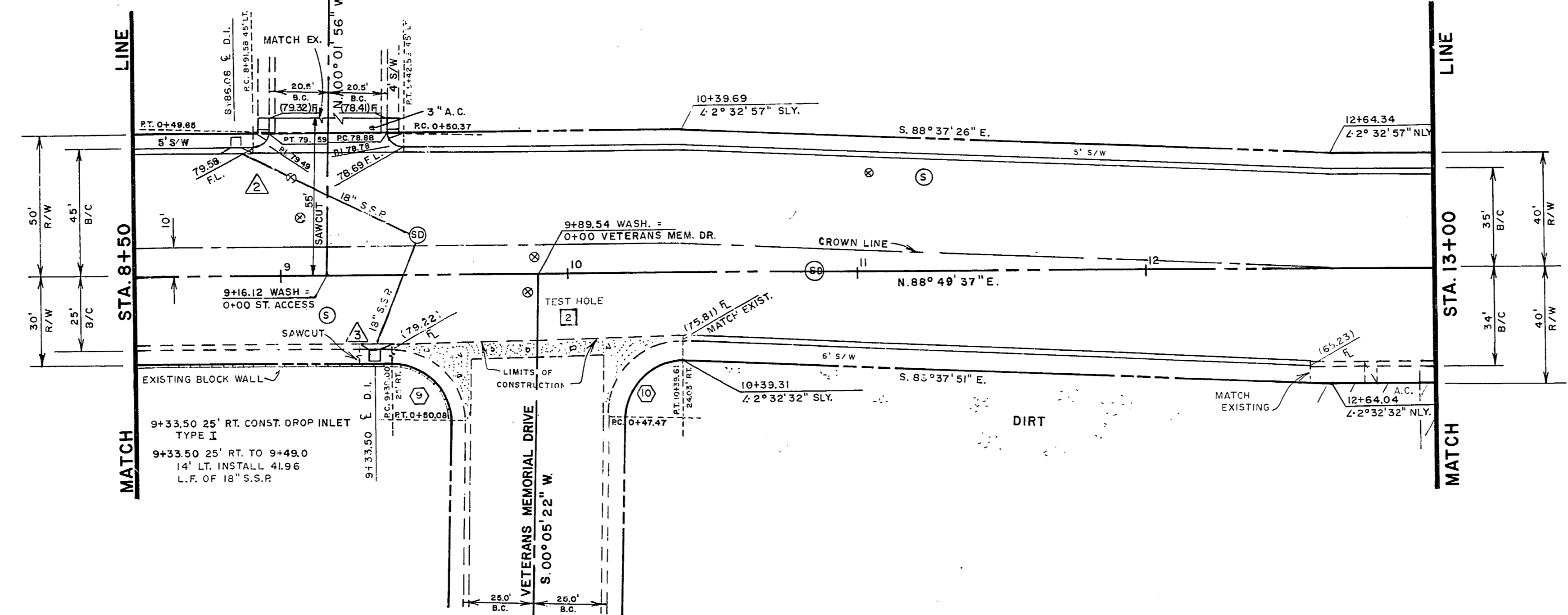

CURVE DATA AT B.C.				
No.	RADIUS	DELTA	TANGENT	LENGTH
⑨	25.00'	91° 15' 45"	25.56'	39.82'
⑩	25.00'	91° 16' 47"	25.56'	39.82'
⑪	5.00'	88° 51' 33"	4.90'	7.75'
⑫	5.00'	91° 08' 27"	5.10'	7.95'

NOTE: FOR ALL DROP INLET DETAILS
SEE SHEETS 8 & 9

FOR SIDE STREET CONSTRUCTION
SEE SHEET No. 3

FOR WHEELCHAIR RAMP DETAILS
SEE SHEET No. 10

B. M. No. 06.27-A5 N.W. Cor. WASHINGTON AVE. & VETAPAN'S MEMORIAL DRIVE, ELEV. 1980.82

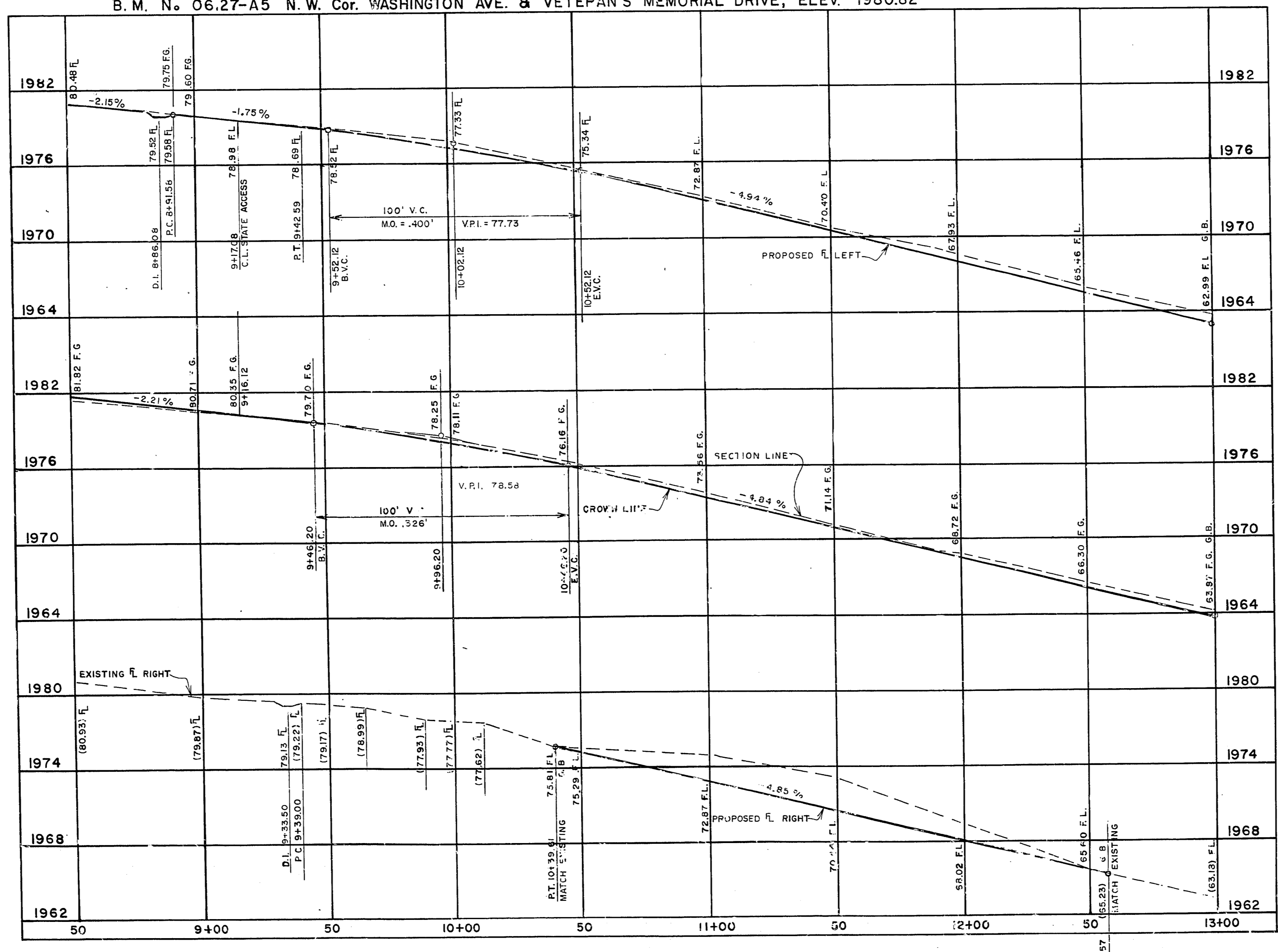

Revisions	
No.	Date

Scale (h) 1" = 30'
Scale (v) 1" = 6'

Fid. bk. no. 72-6X
Date

Design by C. KREHNOVI
Drawn by ANTONIO SMITH
Date

Approved by the Director of Public Services
William P. ...
Date 2/1/80

W. A. no. 0318

W. P. ...
2/1/80

Department of Public Services
Engineering Design Division

PLAN AND PROFILE

WASHINGTON AVENUE
MAIN ST. TO LAS VEGAS BLVD.

CLAYTON COUNTY
ENGINEERING DIVISION

Drawing no. 107-V882 5/22

EXISTING UTILITIES ARE LOCATED ON THE PLANS
FOR THE CONVENIENCE OF THE CONTRACTOR ONLY.
THE CONTRACTOR SHALL BE FULLY RESPONSIBLE
FOR PROTECTING ALL UTILITIES AND THE CITY
BEAR NO RESPONSIBILITY FOR UTILITIES NOT
SHOWN ON THE PLANS OR NOT IN THE LOCATION
SHOWN ON THE PLANS.

CONTRACT
DRAWING
APR 25 1980

20-1-81