

APPROXIMATE QUANTITIES — THIS SHEET

CONSTR. NO.	ITEM NO.	DESCRIPTION	C.L.V. S.I.D.	C.L.V. R.S.H.	CO. S.I.D.	UNIT	TOTAL
	201.100	EXCAVATION		20		CY.	20
15	340.026	6\" CONC. MED. CURB-TACK ON		617		L.F.	617
19	334.503	1/2\" A.C. PAV'T. (MEDIAN)		38		TON	38
19	334.910	GREEN COLOR COATING	433			S.Y.	433
20	340.146	6\" MON. CONC. MEDIAN		554		S.F.	554
19	302.200	TYPE II GRAVEL BASE		54		C.Y.	54
20	333.500	1/2\" OPEN GRADED PLANT-MIX		2493		S.Y.	2493
23	334.112	6\" A.C. PAV'T.		932		TON	932
20	302.210	6\" GRAVEL SHOULDER		119		C.Y.	119
38		1\" WATER CONNECTION		1		EA	1

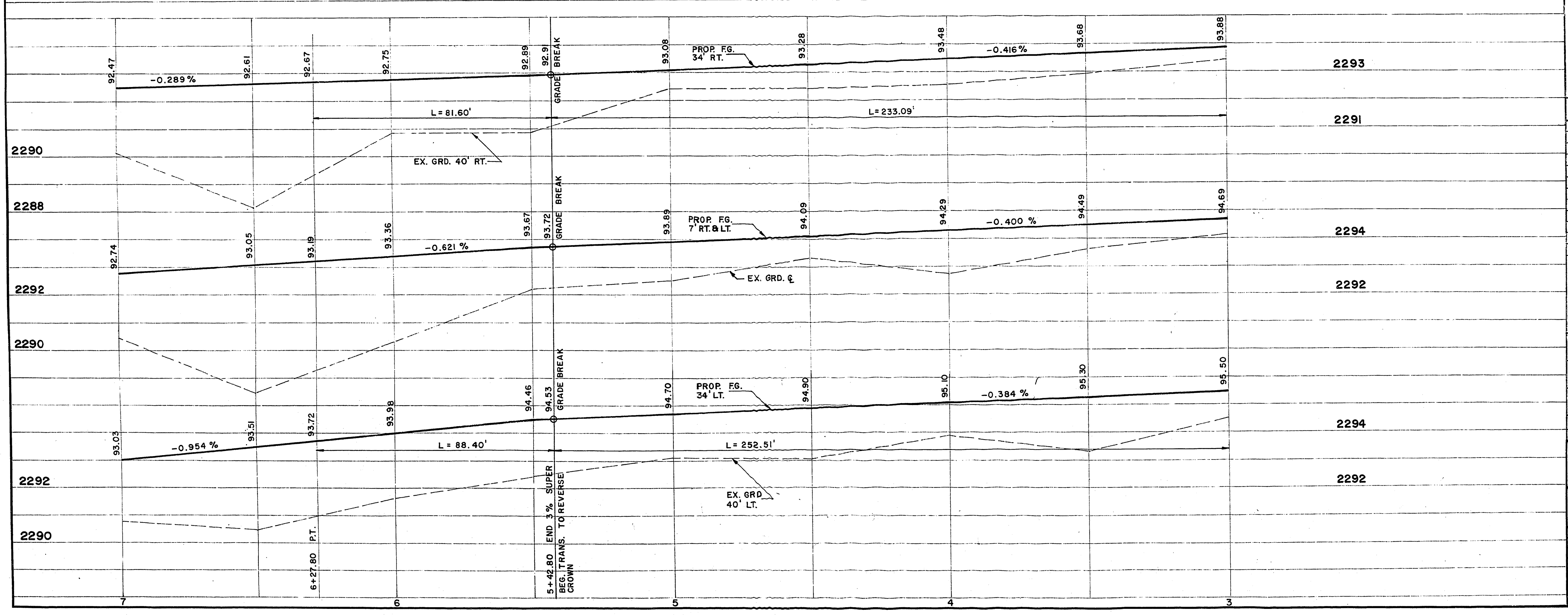

**CONTRACT DRAWING**  
JUN 28 1974

CURVE DATA  
NOTE—DATA REFLECTS TOTAL CURVES—SEE ADJOINING SHEETS.

NO.	LOC.	RADIUS	DELTA	TANGENT	LENGTH
10	€	850.00'	42° 19' 05"	328.99'	627.80'
11	F.C.	848.00'	6° 44' 39"	49.97'	99.81'
12	F.C.	150.00'	11° 47' 44"	15.50'	30.88'
13	F.C.	150.00'	16° 46' 16"	22.11'	43.91'
14	B.C.	856.50'	15° 46' 07"	118.61'	235.72'
15	F.C.	843.00'	08° 48' 24"	64.91'	129.57'
16	B.C.	843.50'	18° 21' 03"	136.25'	270.16'
17	E.P.	884.00'	42° 19' 05"	342.15'	652.91'
18	E.P.	816.00'	42° 19' 05"	315.83'	602.69'
19	F.C.	150.00'	14° 04' 58"	18.53'	36.87'
20	F.C.	150.00'	13° 45' 08"	18.09'	36.00'

NO.	DESCRIPTION	DATE	BY	APPROVED
REVISIONS				

**CITY OF LAS VEGAS NEVADA**  
DEPARTMENT OF PUBLIC WORKS  
SERVICES DIVISION

**JONES BLVD. RE-ALIGNMENT**  
STA. 3+00 TO STA. 7+00

W.O. NO. 7681	F.BK. NO. 72-3X	DATE	DRAWING NO.
SC. (H) 1" = 20'	SC. (V) 1" = 2'	3-20-74	
DES. W.L. Joubert		FILE NO.	
DR. Hayes		107 V 853	
APPROVED BY DIRECTOR OF PUBLIC WORKS		SHEET 35 OF 58	

164-44