

PLAN  
 DATE: BY: S.C.  
 NOTE BOOK: GRADE/VERTICAL ALIGNMENT/STREETS  
 NO. STRUCTURE NOTATION/THICK

PROFILE  
 DATE: BY: S.C.  
 NOTE BOOK: GRADE/VERTICAL ALIGNMENT/STREETS  
 NO. STRUCTURE NOTATION/THICK

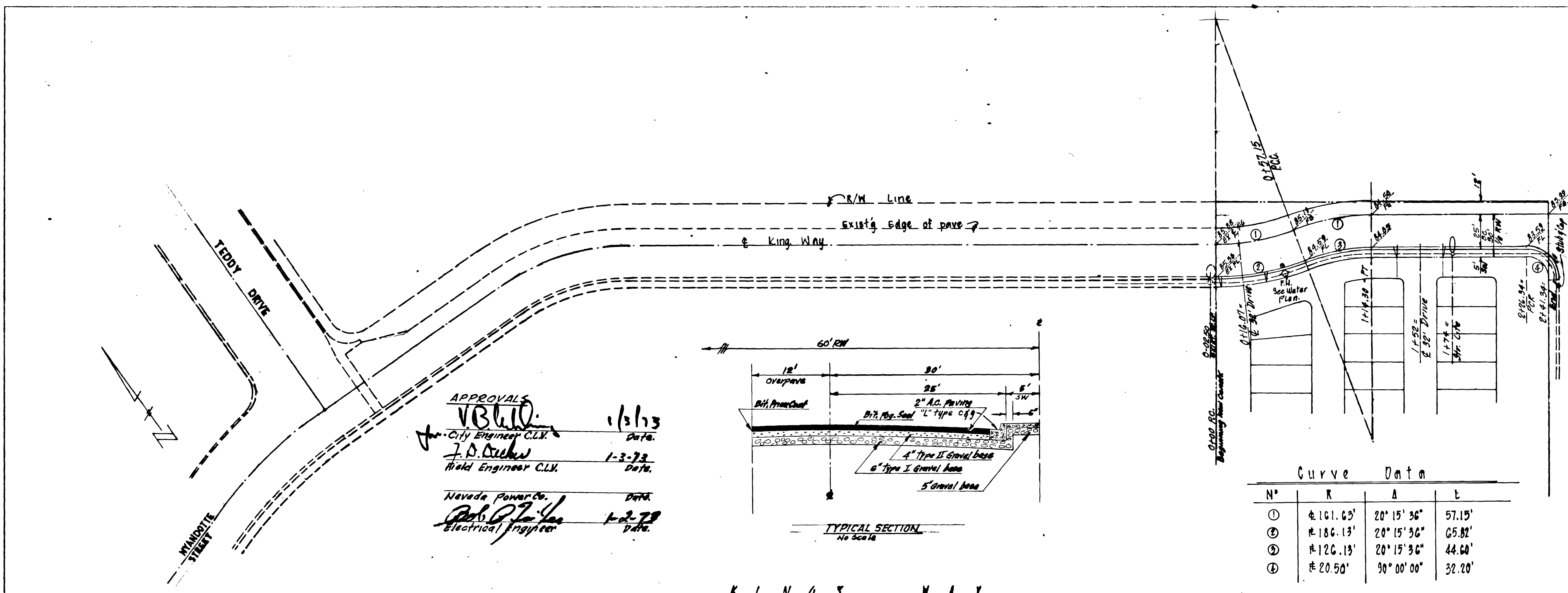

**APPROVALS**  
 V.B.L.D. 1/3/73 Date  
 City Engineer C.L.X.  
 J.D. Decker 1-3-73 Date  
 Field Engineer C.L.X.  
 Nevada Power Co. DATA  
 Robert J. Lee 1-2-73 Date  
 Electrical Engineer

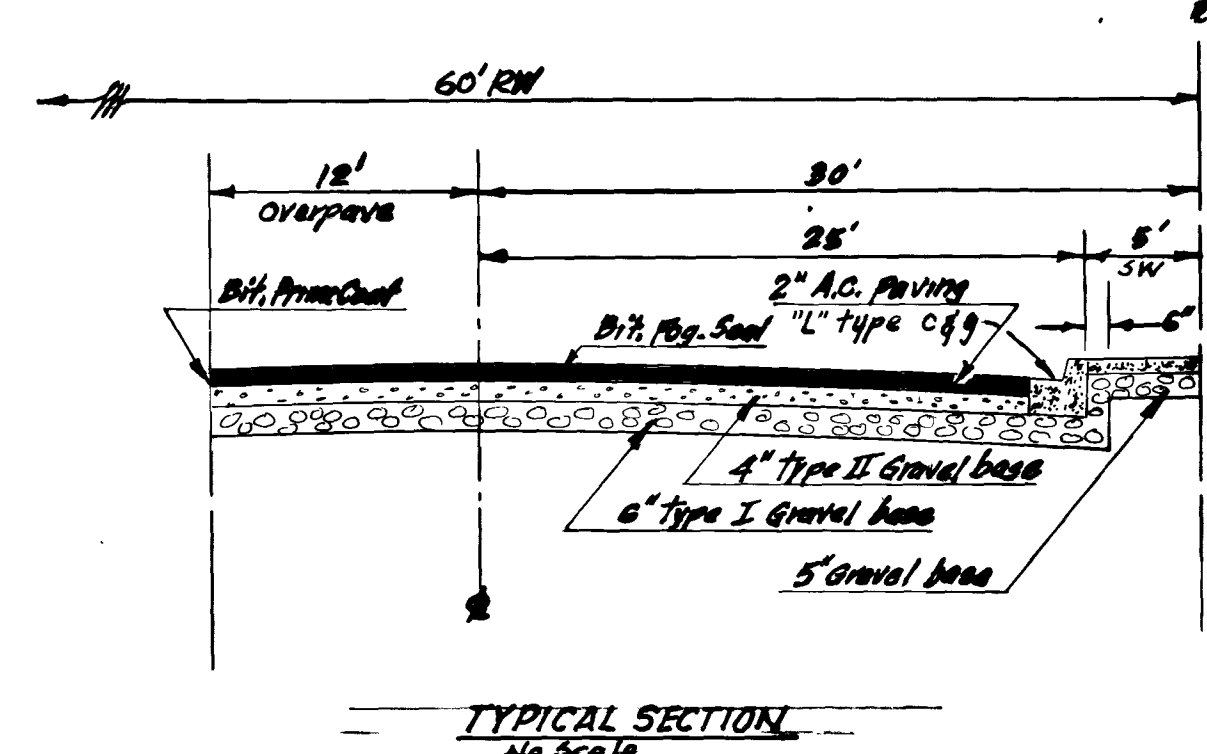

Curve Data

N°	R	A	L
①	R=101.03'	20° 15' 36"	57.15'
②	R=180.13'	20° 15' 36"	65.82'
③	R=120.13'	20° 15' 36"	44.60'
④	R=20.50'	90° 00' 00"	32.20'

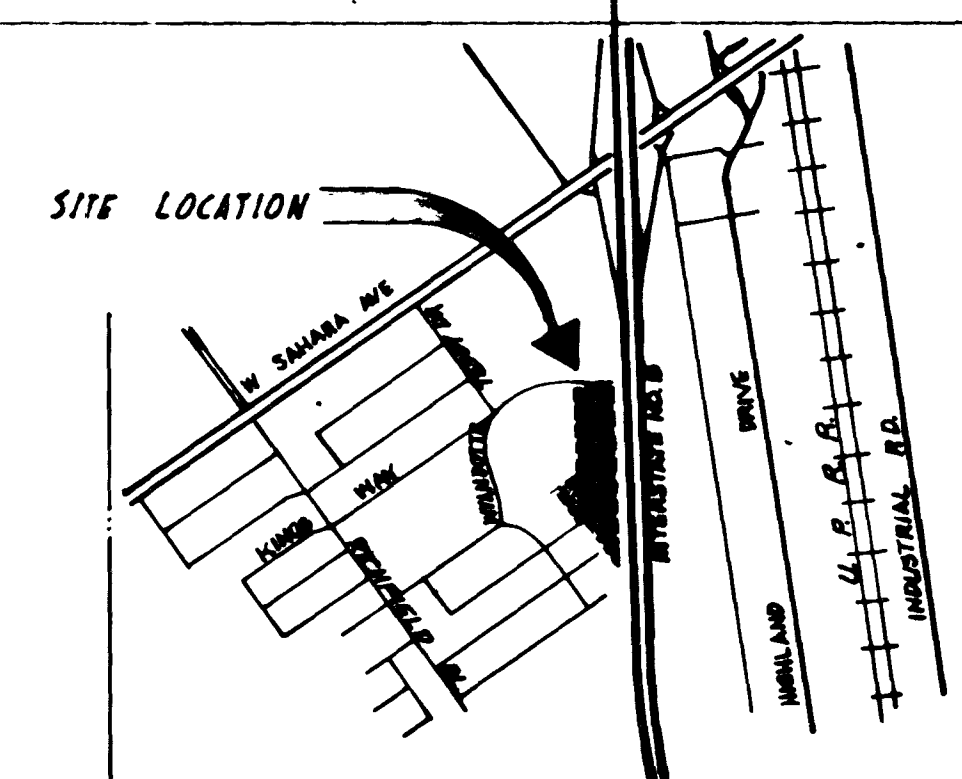

**ESTIMATE OF QUANTITIES**  
 Curb & gutter 24" x 2" type 244 L.F.  
 Sidewalk 4" PCC 1272 sq. ft. (incl. driveway)  
 2" A.C. Pavement 950 sq. ft.  
 11 gpo. Poles @ 175w. MAX. Luminaire 1.00  
 Underground Conductor 1 1/2" 244 L.F.  
 Bench Mark - C.L.X. Plate #18 AS in T.O. at S.W. cor. Teddy Dr. & Mandy St. Elev. = 8091.818

**GENERAL NOTES:**  
 1. All work shall be done in strict accordance with standard plans & specs. of City of Las Vegas.

