

CLV	DESC.	NAVD 88 DATUM	NAVD 88 DATUM
D368 3	U.S.C. & G.S. BRASS DISC SET IN ROCK ON THE EAST SIDE OF CHARLESTON BOULEVARD AND SOUTH OF THE RED ROCK DETENTION BASIN.	3246.71 (FEET)	989.599 (METERS)

BASIS OF BEARINGS
 NORTH 89°45'05" EAST BEING THE SOUTH LINE OF THE SOUTHWEST QUARTER (SW 1/4) OF SECTION 35, TOWNSHIP 20 SOUTH, RANGE 59 EAST, M.D.M., AS SHOWN BY MAP ON FILE IN FILE 91, PAGE 28 OF PARCEL MAPS IN THE CLARK COUNTY RECORDER'S OFFICE, CLARK COUNTY, NEVADA

REFER TO SHEET 2 FOR CONSTRUCTION NOTES
CHARLESTON BOULEVARD (PUBLIC)
 SCALE: HORIZ. 1" = 20'
 VERT. 1" = 5'

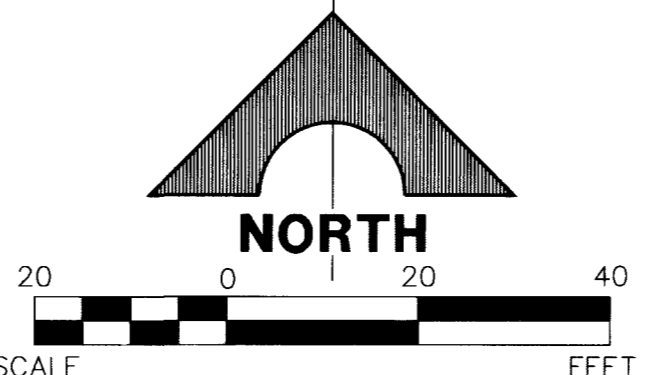

Call before you Dig.
 1-800-227-2600
UNDERGROUND SERVICE ALERT (USA)



NOTE
 1. THIS SET OF DRAWINGS IS BASED UPON NAVD 88 DATUM. PREVIOUS DRAWINGS MAY BE BASED ON OTHER DATUM. CARE SHOULD BE OBSERVED WHEN UTILIZING THIS SET OF DRAWINGS.
 2. CONTRACTOR TO PROTECT IN PLACE ALL EXISTING UTILITIES AND VERIFY LOCATION PRIOR TO ANY CONSTRUCTION.

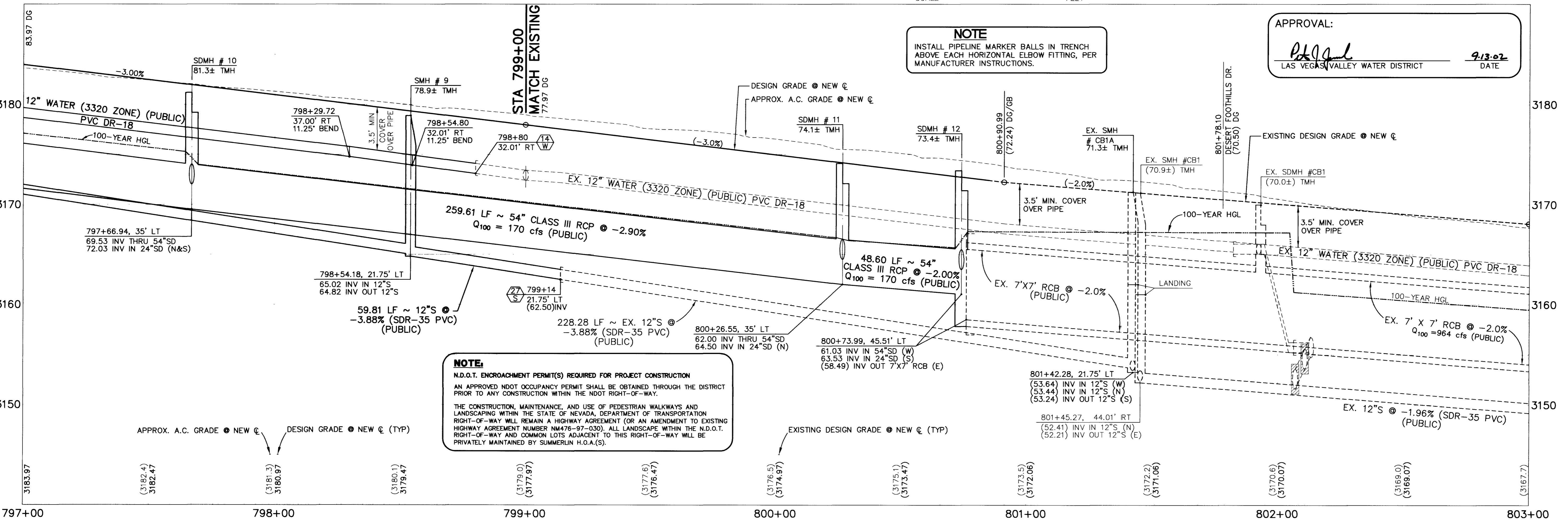

NOTE
 INSTALL PIPELINE MARKER BALLS IN TRENCH ABOVE EACH HORIZONTAL ELBOW FITTING, PER MANUFACTURER INSTRUCTIONS.

APPROVAL:
[Signature]
 LAS VEGAS VALLEY WATER DISTRICT
 DATE: 9.13.02

NOTE:
 N.D.O.T. ENCROACHMENT PERMIT(S) REQUIRED FOR PROJECT CONSTRUCTION
 AN APPROVED NDOT OCCUPANCY PERMIT SHALL BE OBTAINED THROUGH THE DISTRICT PRIOR TO ANY CONSTRUCTION WITHIN THE NDOT RIGHT-OF-WAY.
 THE CONSTRUCTION, MAINTENANCE, AND USE OF PEDESTRIAN WALKWAYS AND LANDSCAPING WITHIN THE STATE OF NEVADA, DEPARTMENT OF TRANSPORTATION RIGHT-OF-WAY WILL REMAIN A HIGHWAY AGREEMENT (OR AN AMENDMENT TO EXISTING HIGHWAY AGREEMENT NUMBER NM476-97-030). ALL LANDSCAPE WITHIN THE N.D.O.T. RIGHT-OF-WAY AND COMMON LOTS ADJACENT TO THIS RIGHT-OF-WAY WILL BE PRIVATELY MAINTAINED BY SUMMERLIN H.O.A.(S).

DESIGN: DFF
 DRAWN: GBW
 CHECK: GBW
 ISSUE DATE:
 PLOT DATE: 09-11-02
 PLOT TIME: 15:08:11
 DATE: 9/11/02
 DESCRIPTION: VILLAGE 19/20 CHARLESTON BLVD. IMPROVEMENTS
 JOB # 62052.230, CLV # 327-V264
 FOR EXISTING 3320 WATER, SEE: CONTRACT NO. 878 3320 ZONE PIPELINE PHASE I by G. C. WALLACE, INC.
 G. C. WALLACE, INC.
 Engineers/Planners/Surveyors
 1555 SOUTH RANGOW BLVD./LAS VEGAS, NEVADA 89146
 OFFICE: (702) 804-2000, FAX: (702) 804-2299
 SUMMERLIN OFFICE 10000 CHARLESTON BLVD., STE. 130
 OFFICE: (702) 804-2160, FAX: (702) 804-2995
 F:\23\Charleston\Drawings\23-05B-11.dwg
 SHEET 11
 VILLAGE 19/23A CHARLESTON BOULEVARD IMPROVEMENTS
 CHARLESTON BOULEVARD
 PLAN AND PROFILE STA. 797+00 TO 803+00
 JOB NO. 62023.240