

**NOTE**  
APPROVAL OF THESE PLANS FOR THE WATER STUBOUT INSTALLATION WILL NOT BE CONSTRUED AS A COMMITMENT FOR WATER SERVICE TO THIS PROPERTY.

REFER TO SHEET 2 FOR CONSTRUCTION NOTES

# CHARLESTON BOULEVARD (PUBLIC)

SCALE: HORIZ. 1" = 20'  
VERT. 1" = 5'

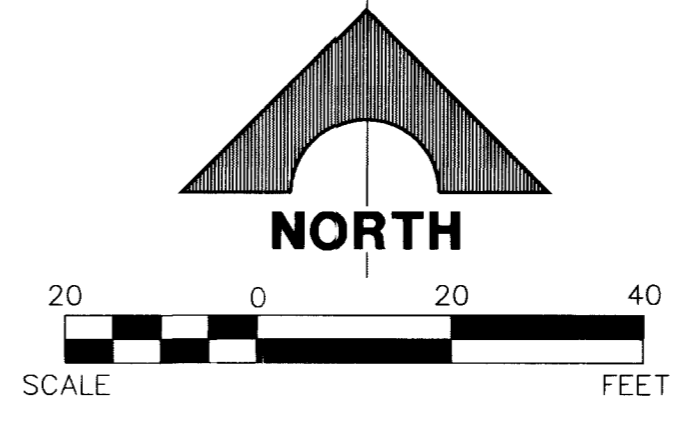

**NOTE**  
THIS SET OF DRAWINGS IS BASED UPON NAVD 88 DATUM. PREVIOUS DRAWINGS MAY BE BASED ON OTHER DATUM. CARE SHOULD BE OBSERVED WHEN UTILIZING THIS SET OF DRAWINGS.

**Call before you Dig.**  
1-800-227-2600  
UNDERGROUND SERVICE ALERT (USA)



BENCHMARK			
CLV	BM NO.	DESC.	DATE
D368	3	U.S.C. & G.S. BRASS DISC SET IN ROCK ON THE EAST SIDE OF CHARLESTON BOULEVARD AND SOUTH OF THE RED ROCK DETENTION BASIN.	989-599

**BASIS OF BEARINGS**  
NORTH 89°45'05" EAST BEING THE SOUTH LINE OF THE SOUTHWEST QUARTER (SW 1/4) OF SECTION 35, TOWNSHIP 20 SOUTH, RANGE 59 EAST, M.D.M., AS SHOWN BY MAP ON FILE IN FILE 91, PAGE 28 OF PARCEL MAPS IN THE CLARK COUNTY RECORDER'S OFFICE, CLARK COUNTY, NEVADA

**NOTE**  
INSTALL PIPELINE MARKER BALLS IN TRENCH ABOVE EACH HORIZONTAL ELBOW FITTING, PER MANUFACTURER INSTRUCTIONS.

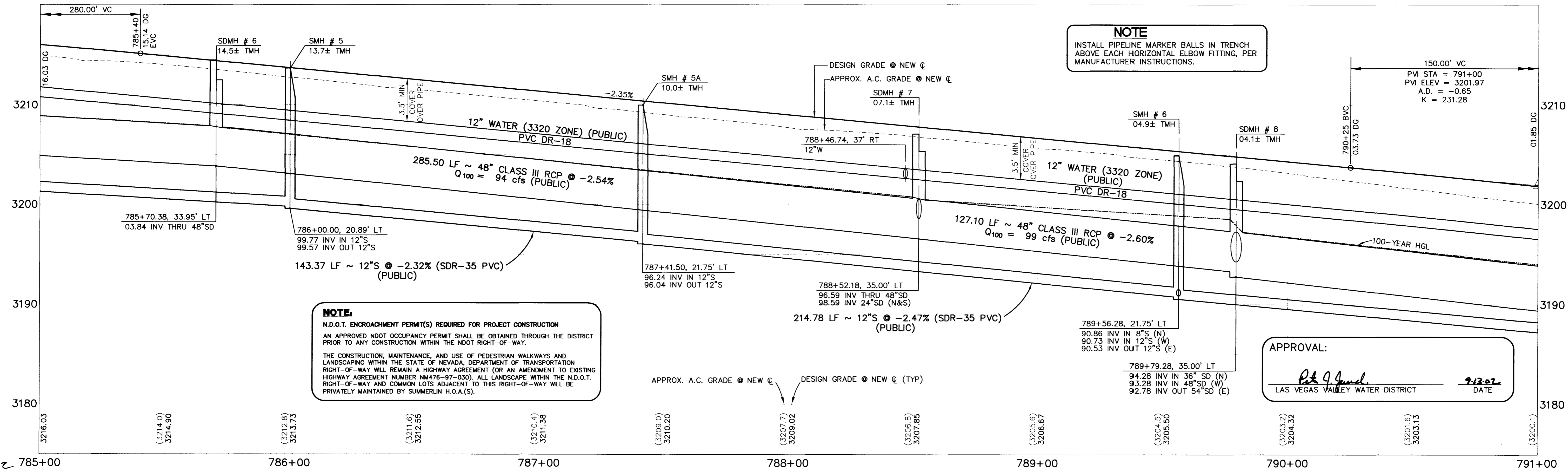

**NOTE:**  
N.D.O.T. ENCROACHMENT PERMIT(S) REQUIRED FOR PROJECT CONSTRUCTION  
AN APPROVED NDOT OCCUPANCY PERMIT SHALL BE OBTAINED THROUGH THE DISTRICT PRIOR TO ANY CONSTRUCTION WITHIN THE NDOT RIGHT-OF-WAY.  
THE CONSTRUCTION, MAINTENANCE, AND USE OF PEDESTRIAN WALKWAYS AND LANDSCAPING WITHIN THE STATE OF NEVADA, DEPARTMENT OF TRANSPORTATION RIGHT-OF-WAY WILL REMAIN A HIGHWAY AGREEMENT (OR AN AMENDMENT TO EXISTING HIGHWAY AGREEMENT NUMBER NM476-97-030). ALL LANDSCAPE WITHIN THE N.D.O.T. RIGHT-OF-WAY AND COMMON LOTS ADJACENT TO THIS RIGHT-OF-WAY WILL BE PRIVATELY MAINTAINED BY SUMMERLIN H.O.A.(S).

**APPROVAL:**  
*P. J. James*  
LAS VEGAS VALLEY WATER DISTRICT  
DATE: 9/13/02

NO.	REV.	DATE	DESCRIPTION

**G.C. WALLACE, INC.**  
Engineers/Planners/Surveyors  
1555 SOUTH RAINBOW BLVD./LAS VEGAS, NEVADA 89146  
OFFICE: (702) 804-2000, FAX: (702) 804-2299  
SUMMERLIN OFFICE: 10000 CHARLESTON BLVD., STE. 130  
OFFICE: (702) 804-2160, FAX: (702) 804-2295  
F:\V23\Charleston\Drawings\2325029.dwg

**SUMMERLIN**  
VILLAGE 19/23A CHARLESTON BOULEVARD IMPROVEMENTS  
CHARLESTON BOULEVARD  
PLAN AND PROFILE STA. 785+00 TO 791+00  
SHEET 9 OF 21 SUB  
OB NO. 62023.240