

BENCHMARK

CLV	DESC.	NAVD 88 DATUM	NAVD 88 DATUM
0368 3	U.S.C. & G.S. BRASS DISC SET IN ROCK ON THE EAST SIDE OF CHARLESTON BOULEVARD AND SOUTH OF THE RED ROCK DETENTION BASIN.	3246.71 (FEET)	989.599 (METERS)

BASIS OF BEARINGS
 NORTH 89°45'05" EAST BEING THE SOUTHWEST QUARTER (SW 1/4) OF SECTION 35, TOWNSHIP 20 SOUTH, RANGE 59 EAST, M.D.M., AS SHOWN BY MAP ON FILE IN FILE 91, PAGE 28 OF PARCEL MAPS IN THE CLARK COUNTY RECORDER'S OFFICE, CLARK COUNTY, NEVADA

REFER TO SHEET 2 FOR CONSTRUCTION NOTES
CHARLESTON BOULEVARD (PUBLIC)
 SCALE: HORIZ. 1" = 20'
 VERT. 1" = 5'

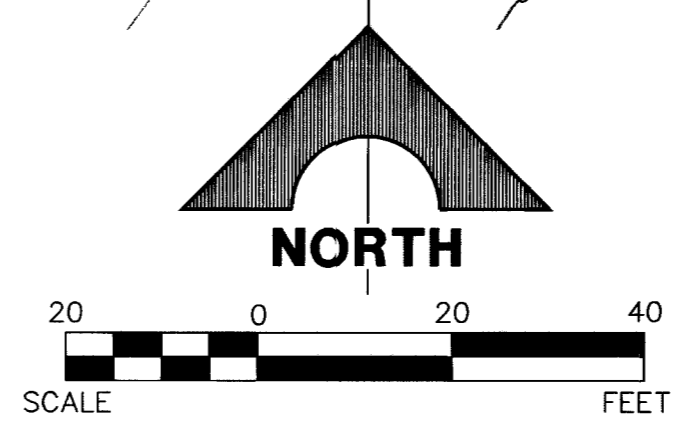

NOTE
 THIS SET OF DRAWINGS IS BASED UPON NAVD 88 DATUM, PREVIOUS DRAWINGS MAY BE BASED ON OTHER DATUM. CARE SHOULD BE OBSERVED WHEN UTILIZING THIS SET OF DRAWINGS.

Call before you Dig.
 1-800-227-2600
 UNDERGROUND SERVICE ALERT (USA)

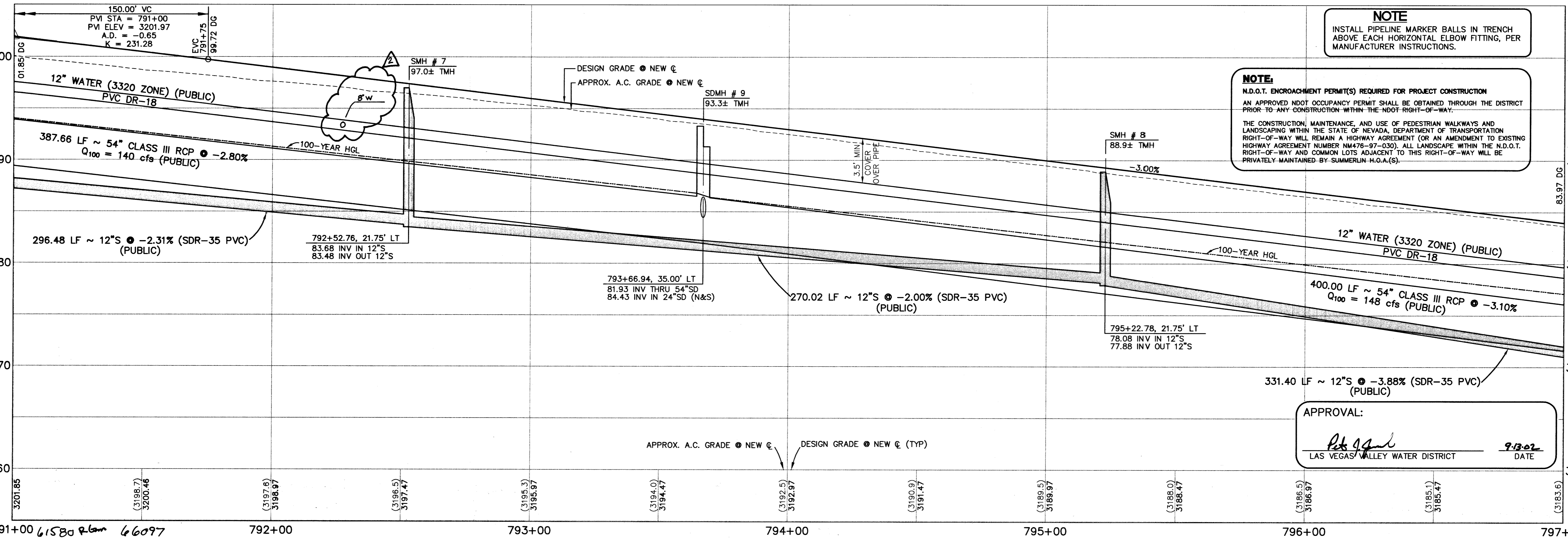

NOTE
 INSTALL PIPELINE MARKER BALLS IN TRENCH ABOVE EACH HORIZONTAL ELBOW FITTING, PER MANUFACTURER INSTRUCTIONS.

NOTE:
 N.D.O.T. ENCROACHMENT PERMIT(S) REQUIRED FOR PROJECT CONSTRUCTION
 AN APPROVED NDOT OCCUPANCY PERMIT SHALL BE OBTAINED THROUGH THE DISTRICT PRIOR TO ANY CONSTRUCTION WITHIN THE NDOT RIGHT-OF-WAY.
 THE CONSTRUCTION, MAINTENANCE, AND USE OF PEDESTRIAN WALKWAYS AND LANDSCAPING WITHIN THE STATE OF NEVADA, DEPARTMENT OF TRANSPORTATION RIGHT-OF-WAY WILL REMAIN A HIGHWAY AGREEMENT (OR AN AMENDMENT TO EXISTING HIGHWAY AGREEMENT NUMBER NM476-97-030). ALL LANDSCAPE WITHIN THE N.D.O.T. RIGHT-OF-WAY AND COMMON LOTS ADJACENT TO THIS RIGHT-OF-WAY WILL BE PRIVATELY MAINTAINED BY SUMMERLIN H.O.A.(S).

APPROVAL:
P. G. G...
 LAS VEGAS VALLEY WATER DISTRICT
 DATE: 9-13-02

Rblm
 46743 791+00 61580 Rblm 66097

DESIGN: DFF
 DRAWN: GSW
 CHECK: GSW
 ISSUE DATE:
 PLOT DATE: 09-11-02
 PLOT TIME: 15:07:56

DATE: 9/11/02

DESCRIPTION: VILLAGE 19/23A CHARLESTON BOULEVARD IMPROVEMENTS

G.C. WALLACE, INC.
 Engineers/Planners/Surveyors
 1555 SOUTH RAINBOW BLVD./LAS VEGAS, NEVADA 89146
 OFFICE: (702) 804-2000, FAX: (702) 804-2899
 SUMMERLIN OFFICE: 10000 CHARLESTON BLVD., STE. 130
 OFFICE: (702) 804-2160, FAX: (702) 804-2295
 E: NV23@charlestonvalleywater.com

SUMMERLIN
 VILLAGE 19/23A CHARLESTON BOULEVARD IMPROVEMENTS
 CHARLESTON BOULEVARD
 PLAN AND PROFILE STA. 791+00 TO 797+00

SHEET
10

OB NO. 62023.240