

CURVE	RADIUS	LENGTH	TANGENT	DELTA	RADIUS POINT
C1	209.96'	67.43'	34.01'	1824.00'	16
C2	5.00'	10.14'	8.03'	11871.17'	23
C3	1.50'	4.65'	74.66'	17741.53'	30
C4	171.59'	42.91'	21.51'	1419.43'	8
C5	196.03'	82.33'	41.79'	2441.13'	7
C6	148.00'	57.06'	28.89'	2205.27'	10
C7	148.00'	15.93'	7.97'	0609.56'	46
C8	5.00'	9.85'	7.54'	11253.02'	19
C9	5.00'	9.81'	7.16'	11070.11'	43
C10	5.00'	9.35'	6.77'	10705.13'	70
C11	5.00'	10.31'	8.35'	11809.29'	55
C12	176.67'	67.37'	34.10'	2150.56'	33
C13	12.63'	9.02'	4.71'	4055.29'	56
C14	5.00'	5.04'	2.78'	5744.14'	58
C15	121.91'	22.86'	11.46'	1044.40'	69
C16	174.33'	37.92'	19.04'	1227.52'	62
C17	5.00'	9.33'	6.74'	10652.28'	68
C18	78.34'	20.34'	10.23'	1452.59'	81
C19	57.17'	104.00'	73.47'	10431.15'	81
C20	95.24'	154.46'	100.23'	9258.31'	69
C21	861.00'	14.74'	7.57'	00758.59'	83
C24	791.00'	154.43'	77.46'	11711.00'	83
C25	817.67'	159.84'	80.07'	11111.00'	83
C26	834.33'	102.86'	51.50'	07030.50'	83
C27	2758.33'	284.41'	142.33'	0554.28'	1
C28	141.31'	42.79'	21.56'	1721.01'	11
C29	2741.67'	308.34'	153.33'	06240.77'	1
C30	2715.00'	243.18'	121.67'	05071.55'	1
C31	150.00'	91.00'	46.95'	3445.34'	16
C32	150.00'	79.15'	40.52'	3014.06'	15
C33	2785.00'	287.18'	143.71'	0554.28'	1
C34	291.67'	82.75'	41.66'	1615.21'	6
C35	5.00'	9.92'	7.66'	11342.51'	37
C36	817.67'	75.91'	37.93'	0816.44'	83
C37	791.00'	73.94'	36.70'	0516.44'	83
C38	834.33'	142.29'	71.4'	00158.52'	83
C39	861.00'	89.86'	45.02'	0559.12'	83
C40	179.33'	279.53'	177.35'	8927.37'	7
C41	106.00'	23.53'	11.81'	1242.59'	48
C42	106.00'	12.90'	6.46'	0658.28'	48
C43	106.00'	19.91'	9.98'	1045.34'	48
C44	106.00'	23.73'	11.92'	1248.39'	48
C45	2779.50'	62.57'	31.28'	0117.25'	1
C46	2758.33'	62.03'	31.05'	0117.25'	1
C47	2741.66'	44.71'	22.35'	00156.04'	1
C48	2720.50'	44.37'	22.18'	00156.04'	1

ALL DATA ARE FOR BCR UNLESS OTHERWISE NOTED.
DATA DOES NOT REFLECT PEDESTRIAN MEDIAN OPENINGS.

LINE	DIRECTION	DISTANCE
L1	N 19°36'19" W	103.22'

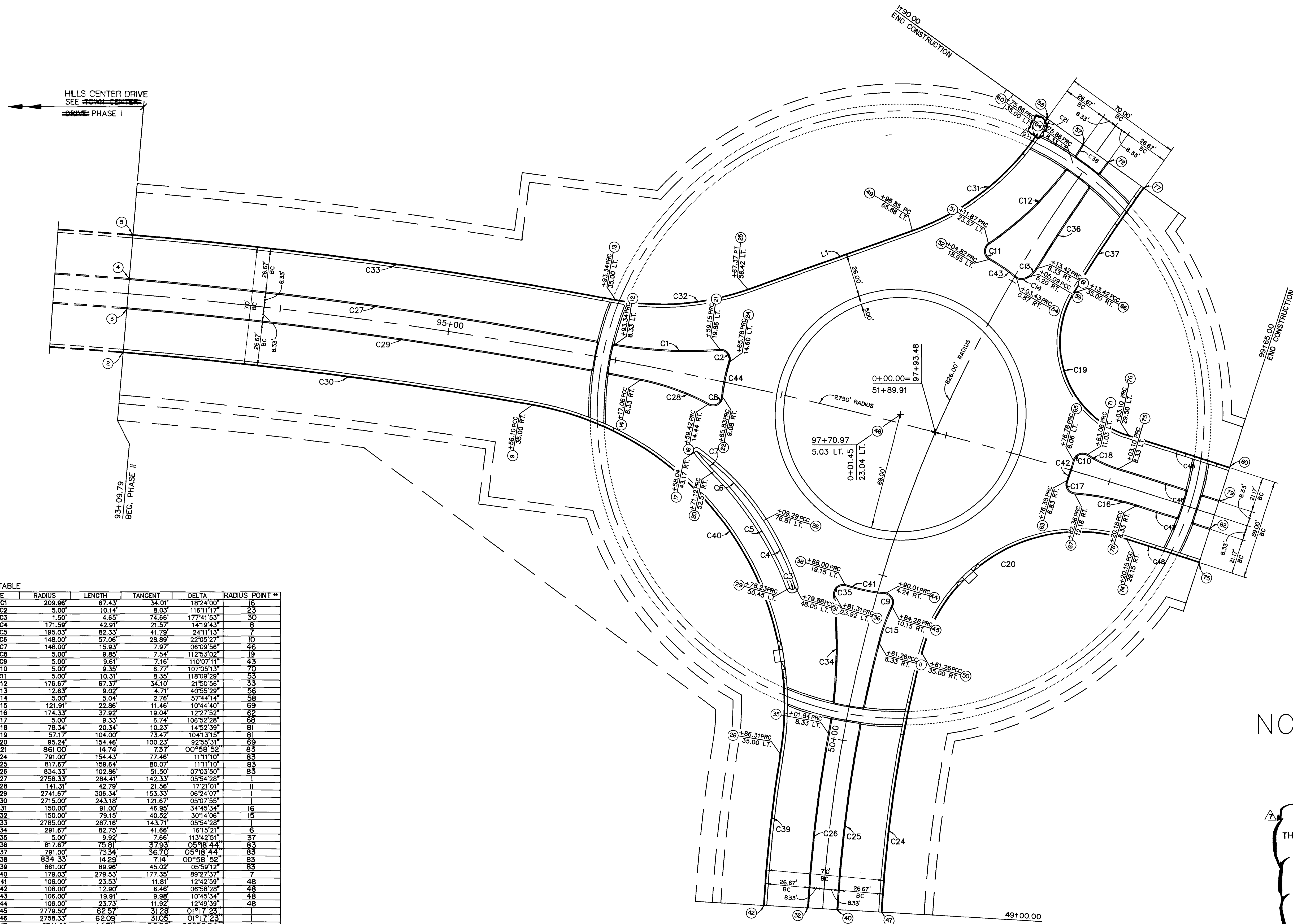

NORTH ROUNDABOUT

1"=30'
FOR POINT DATA, SEE SHEET T-12

RECORD DRAWINGS
THESE PLANS SHOW RECORD INFORMATION RECEIVED FROM:
CONTRACTOR: **WELLS CARGO INC.**
DATE: **6/19/90**
THIS DATA MAY OR MAY NOT REFLECT THE ACTUAL FIELD LOCATIONS. ALL DATA SHOULD BE CONFIRMED PRIOR TO USE ON DEVELOPMENT OR ENGINEERING PLANS.

NOTE: THESE PLANS ARE FOR THE PURPOSE OF ROADWAY IMPROVEMENT AND UTILITIES (PAVEMENT WITH BASE, CURB AND GUTTER, STORM DRAIN, WATER, SEWER, ETC.). ALL ROADWAY AND LANDSCAPE AREAS HAVE BEEN PREVIOUSLY ROUGH GRADED. ANY LIMITS OF ROUGH GRADING SHOWN ARE FOR REFERENCE ONLY. FOR SCOPE AND LIMITS OF ROUGH GRADING, SEE "TOWN CENTER DRIVE - ROUGH GRADING" PACKAGE. FOR FINISH GRADING OF LANDSCAPE AREAS, SEE LANDSCAPE PACKAGE BY SWA GROUP.

REV	DATE	DESCRIPTION
1	12/12/89	ISSUED FOR BID
2	12/12/89	ISSUED FOR CONSTRUCTION
3	12/12/89	RECORD DRAWINGS

RECORD NO. 11102
SHEET NO. 1041E
G.C. WALLACE, INC.
Engineering/Architecture
1555 SOUTH RAINBOW BLVD., LAS VEGAS, NEVADA 89102

VILLAGE CENTER CIRCLE &
HOWARD HUGHES PROPERTIES
TOWN CENTER DRIVE PHASE II
GEOMETRICS
NORTH ROUNDABOUT

JOB NO. 620288

024 DISTENFELD 02/12/89

11350 107-V1639-2

