

RECORD DRAWINGS
 THESE PLANS SHOW RECORD INFORMATION RECEIVED FROM:
 CONTRACTOR: WELLS CARGO INC.
 DATE: 6/19/92
 THIS DATA MAY OR MAY NOT REFLECT THE ACTUAL FIELD LOCATIONS. ALL DATA SHOULD BE CONFIRMED PRIOR TO USE ON DEVELOPMENT OR ENGINEERING PLANS.

SOUTH ROUNDABOUT

1"=40'

FOR GEOMETRICS, SEE SHEET I-7
 FOR PROFILES, SEE SHEET I-9

NOTE: THESE PLANS ARE FOR THE PURPOSE OF ROADWAY IMPROVEMENT AND UTILITIES (PAVEMENT WITH BASE, CURB AND GUTTER, STORM DRAIN, WATER, SEWER, ETC.). ALL ROADWAY AND LANDSCAPE AREAS HAVE BEEN PREVIOUSLY ROUGH GRADED. ANY LIMITS OF ROUGH GRADING SHOWN ARE FOR REFERENCE ONLY. FOR SCOPE AND LIMITS OF ROUGH GRADING, SEE "TOWN CENTER DRIVE - ROUGH GRADING" PACKAGE. FOR FINISH GRADING OF LANDSCAPE AREAS, SEE LANDSCAPE PACKAGE BY SWA GROUP.

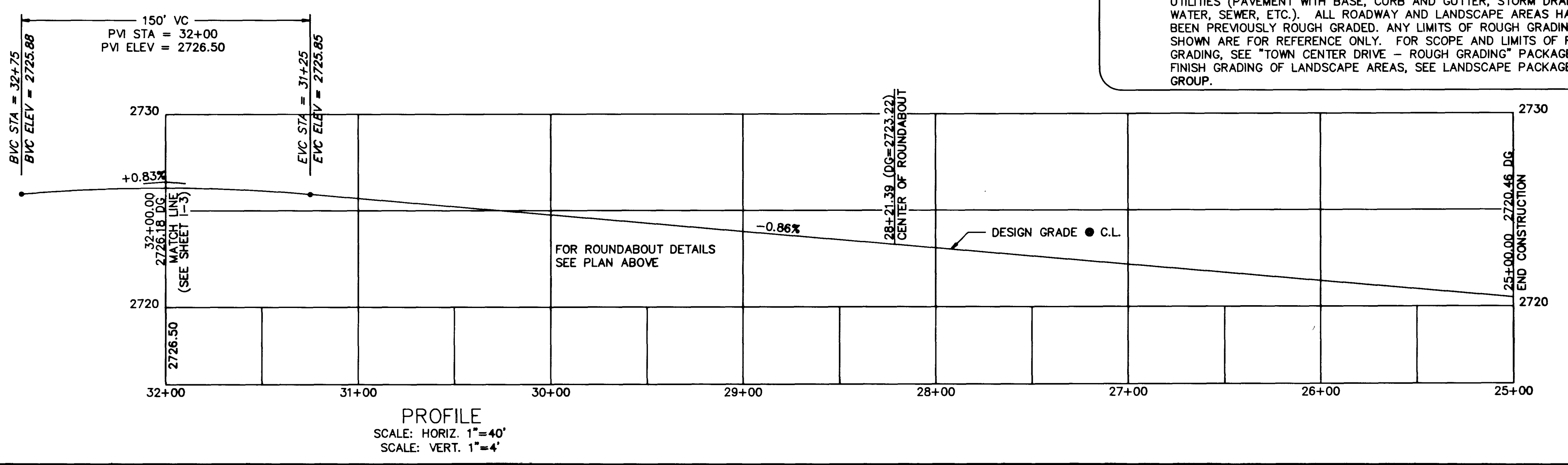
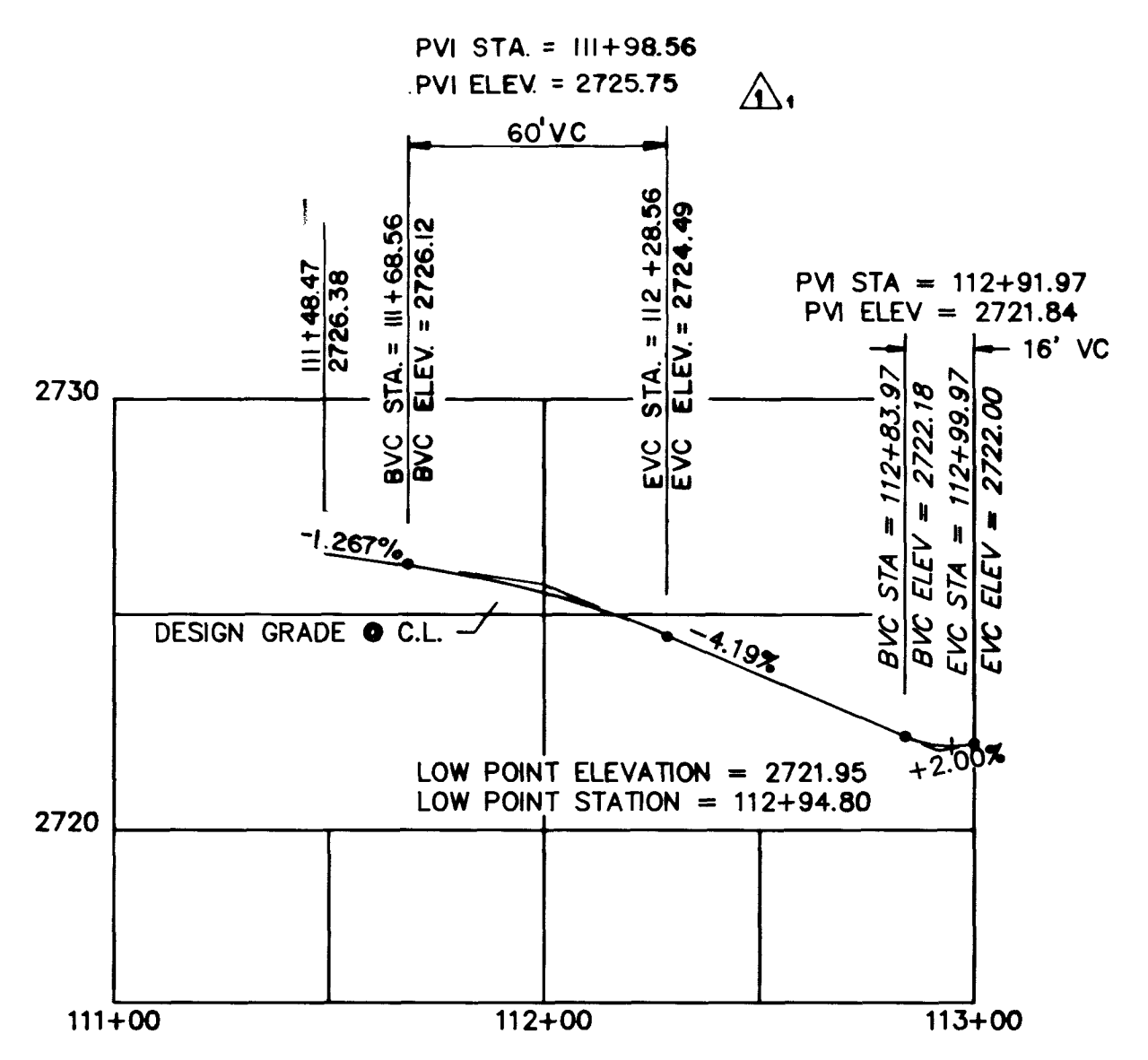

PROFILE
 SCALE: HORIZ. 1"=40'
 SCALE: VERT. 1"=4'

REVISIONS

NO.	DATE	DESCRIPTION
1	6/19/92	ISSUED FOR BID
2	6/19/92	ISSUED FOR CONSTRUCTION
3	6/19/92	ISSUED PER GCU LETTER
4	6/19/92	ISSUED PER GCU LETTER
5	6/19/92	ISSUED PER GCU LETTER

COMPILED BY: [Signature]

DESIGNED BY: [Signature]

CHECKED BY: [Signature]

DATE: 6/19/92

PROJECT: VILLAGE CENTER DRIVE & TOWN CENTER DRIVE PHASE 2 SOUTH ROUNDABOUT

SCALE: 1"=40'

SHEET 7 OF 37 SHEETS

G.C. WALLACE, INC.
 Engineering/Architecture
 1555 SOUTH RAINBOW BLVD., LAS VEGAS, NEVADA 89102

JOB NO. 11-3-50

1973

11-3-50 107-V163A-2

