

CURVE	RADIUS	LENGTH	TANGENT	DELTA
C1	961.00'	886.02'	486.74'	58°57'38"
C2	834.33'	835.58'	471.68'	58°57'38"
C3	828.00'	850.00'	466.95'	58°57'38"
C4	817.67'	841.42'	462.24'	58°57'38"
C5	791.00'	813.98'	447.17'	58°57'38"

VILLAGE CENTER CIRCLE
TOWN CENTER DRIVE

1"=40'

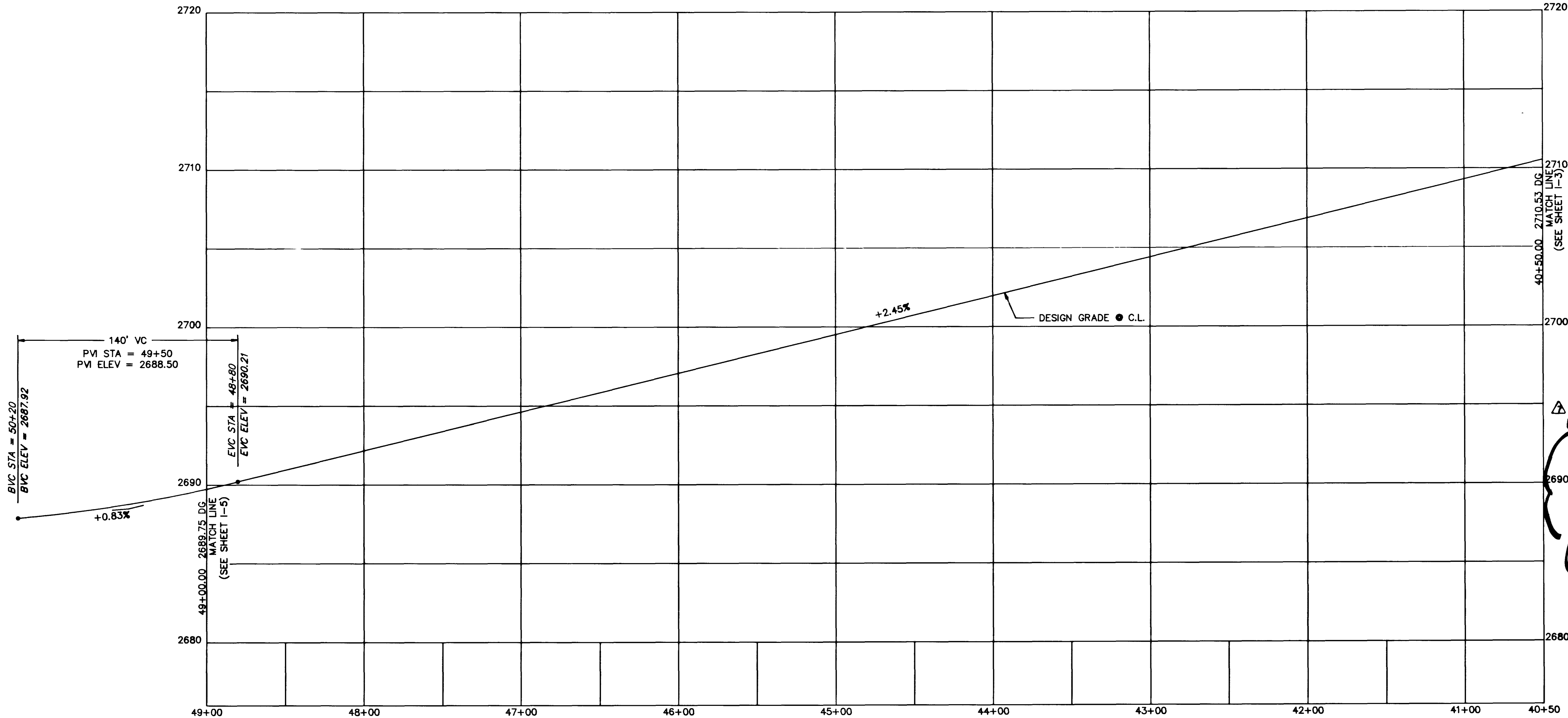

PROFILE
SCALE: HORIZ. 1"=40'
SCALE: VERT. 1"=4'

RECORD DRAWINGS

THESE PLANS SHOW RECORD INFORMATION RECEIVED FROM:

CONTRACTOR: WELLS CARGO INC.

DATE: 07/16/88

THIS DATA MAY OR MAY NOT REFLECT THE ACTUAL FIELD LOCATIONS. ALL DATA SHOULD BE CONFIRMED PRIOR TO USE ON DEVELOPMENT OR ENGINEERING PLANS.

REV	DATE	DESCRIPTION
1	02/12/89	ISSUED FOR BID
2	07/16/88	ISSUED FOR CONSTRUCTION
3	07/16/88	ISSUED FOR RECORD DRAWINGS

RECORD

1555 SOUTH RAINBOW BLVD / LAS VEGAS, NEVADA 89102

G.C. WALLACE, INC.
Engineering/Architecture

VILLAGE CENTER CIRCLE
HOWARD HUGHES PROPERTIES
TOWN CENTER DRIVE PHASE II
PLAN & PROFILE
STA-48+00 TO 40+50

SHEETS
I-2
OF 37 SHEETS

2/12/89

JOB NO. 10-100-1000

8/4 DIETRICH-POST 65328

1975

11-3-46

107-V11892

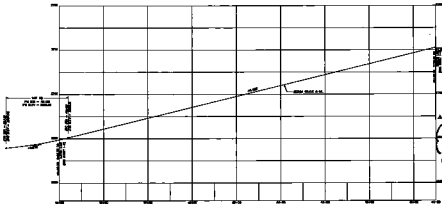
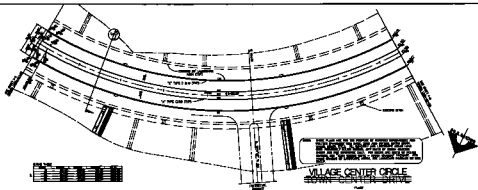

NOTES:
 1. SEE PLAN FOR ALL DIMENSIONS AND NOTES.
 2. SEE PLAN FOR ALL DIMENSIONS AND NOTES.
 3. SEE PLAN FOR ALL DIMENSIONS AND NOTES.
 4. SEE PLAN FOR ALL DIMENSIONS AND NOTES.

PROJECT NO. 11-3-14
 DATE 11-3-14
 DRAWN BY [Name]
 CHECKED BY [Name]
 APPROVED BY [Name]
 TITLE [Title]
 SCALE 1" = 40'