

ENGINEERS & SURVEYORS INC.
 7018 A
 SUBMITTED BY: PAUL E. VALENTINE
 DATE: 3/9/89

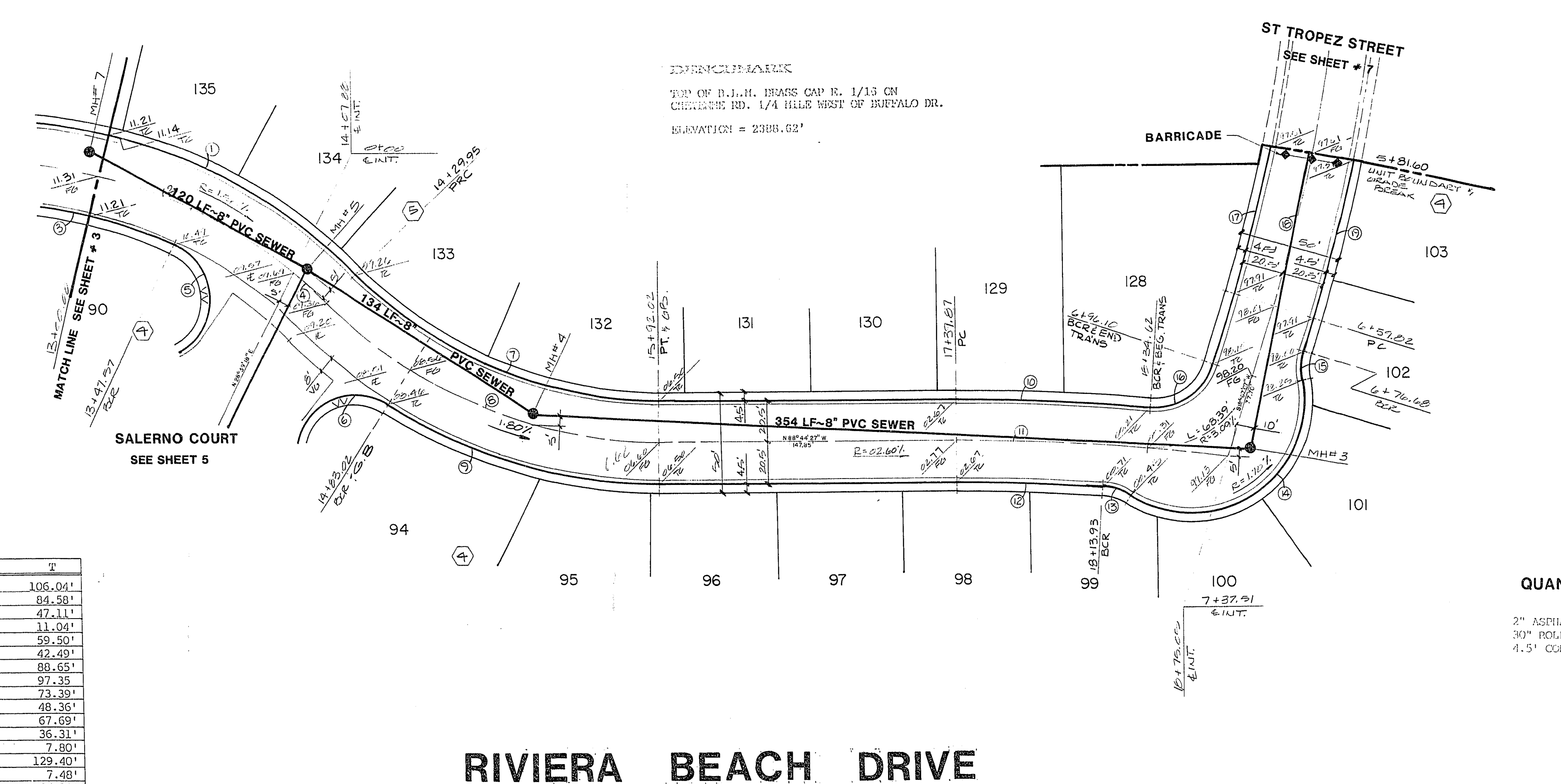

CURVE DATA

STATION	R	DELTA	L	"
1	218.96	45° 58' 39"	200.58'	106.04'
2	229.46	40° 28' 01"	162.07'	84.58'
3	208.96	25° 24' 33"	92.67'	47.11'
4	229.46	05° 30' 37"	22.07'	11.04'
5	30.00	126° 29' 15"	66.23'	59.50'
6	30.00	109° 33' 27"	57.36'	42.49'
7	208.96	45° 58' 39"	167.69'	88.62'
8	229.46	45° 58' 39"	184.14'	97.35'
9	249.96	32° 43' 33"	142.77'	73.39'
10	1047.50	05° 17' 10"	96.64'	48.36'
11	1027.00	07° 32' 31"	135.18'	67.69'
12	1006.50	04° 07' 55"	72.58'	36.31'
13	30.00	29° 08' 38"	15.26'	7.80'
14	55.50	133° 34' 18"	129.39'	129.40'
15	30.00	27° 59' 19"	14.65'	7.48'
16	30.00	77° 35' 36"	40.63'	24.12'
17	798.50	05° 29' 04"	76.43'	38.25'
18	819.00	05° 29' 04"	78.40'	39.23'
19	839.50	05° 29' 04"	80.36'	40.21'

QUANTITY ESTIMATE

2" ASPHALT CONCRETE PAVING 3,412 S.Y.
 30" ROLL TOP CURB & GUTTER 1,342 L.F.
 4.5" CONCRETE SIDEWALK 6,039 S.F.

Call before you Dig.
 1-800-227-2600
 UNDERGROUND SERVICE USA

STREET & SEWER PLAN & PROFILE
 (RIVIERA BEACH DRIVE)

VILLA FINESTRA UNIT NO. 1

TITLE: STREET & SEWER PLAN & PROFILE (RIVIERA BEACH DRIVE)
 PROJECT: VILLA FINESTRA UNIT NO. 1

WO NO. 5271
 BY TB/PB
 DATE 3/9/89
 SCALE VERT. 1"=4'
 HORIZ. 1"=40'

SHEET **4**
 OF 15 SHEETS

114

107Y-4050-1