

Alt. II A not constructed
CLARK COUNTY

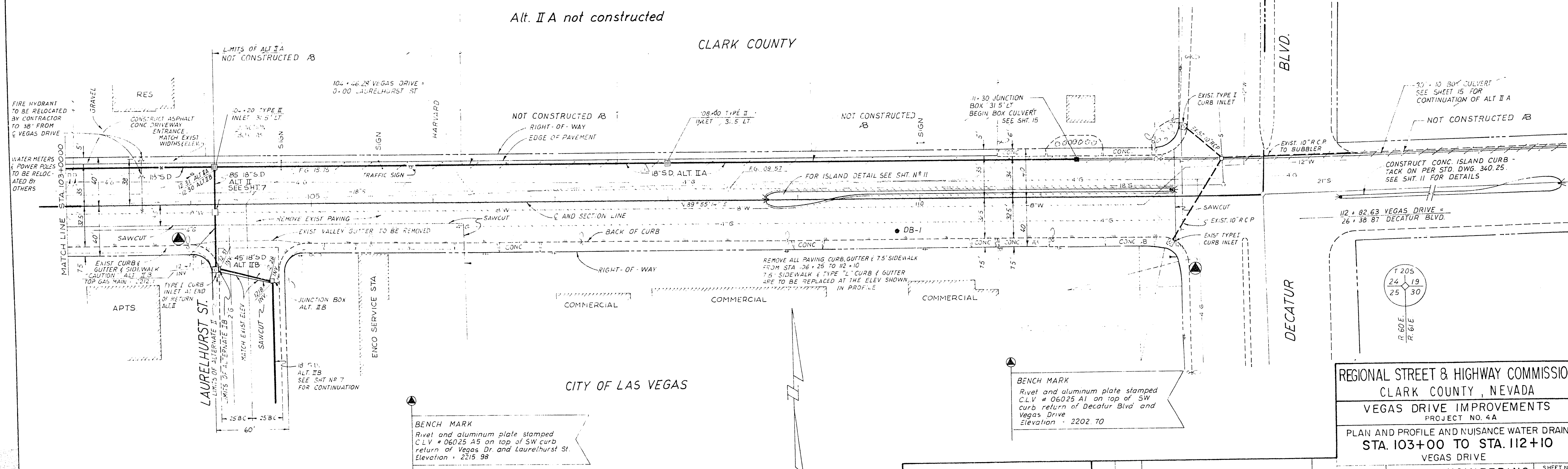

"AS CONSTRUCTED"
6-1-73

SCALE: HORIZ. 1" = 40'
VERT. 1" = 4'

DESIGN R.L.G.		BOYLE ENGINEERING		SHEET NO.	
DRAWN G.M.R.A.H.		1209 COMMERCE ST., LAS VEGAS, NEVADA		6	
CHECKED S.C.B.		DATE 3-29-71		C.A.N.	
REV		DATE		DESCRIPTION	
1		3-29-71		CHANGED 6" x 12" x 4" O-D TO 18" S.D. (TYP)	

REGIONAL STREET & HIGHWAY COMMISSION
CLARK COUNTY, NEVADA
VEGAS DRIVE IMPROVEMENTS
PROJECT NO. 4A
PLAN AND PROFILE AND NUISANCE WATER DRAIN
STA. 103+00 TO STA. 112+10
VEGAS DRIVE

107-V912