

**NOTE :** FOR SEWER LATERAL ADJUSTMENT SEE C.O. # 2

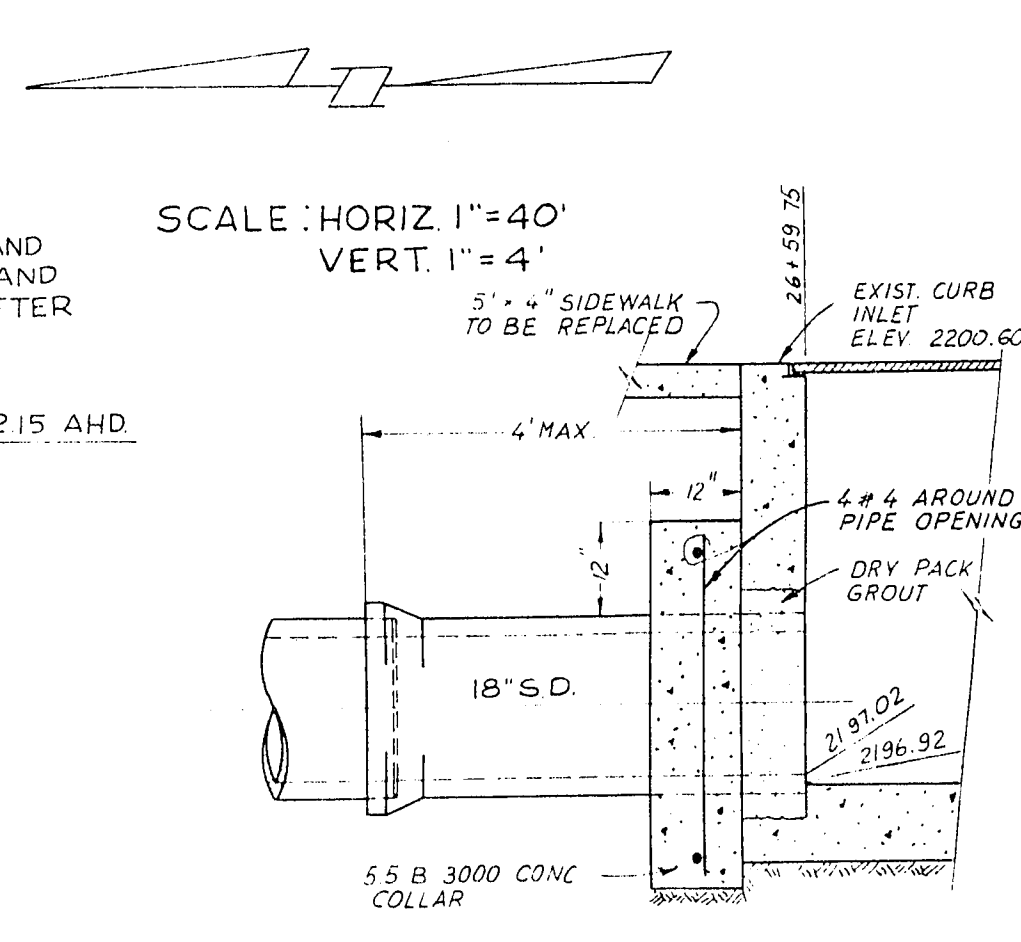
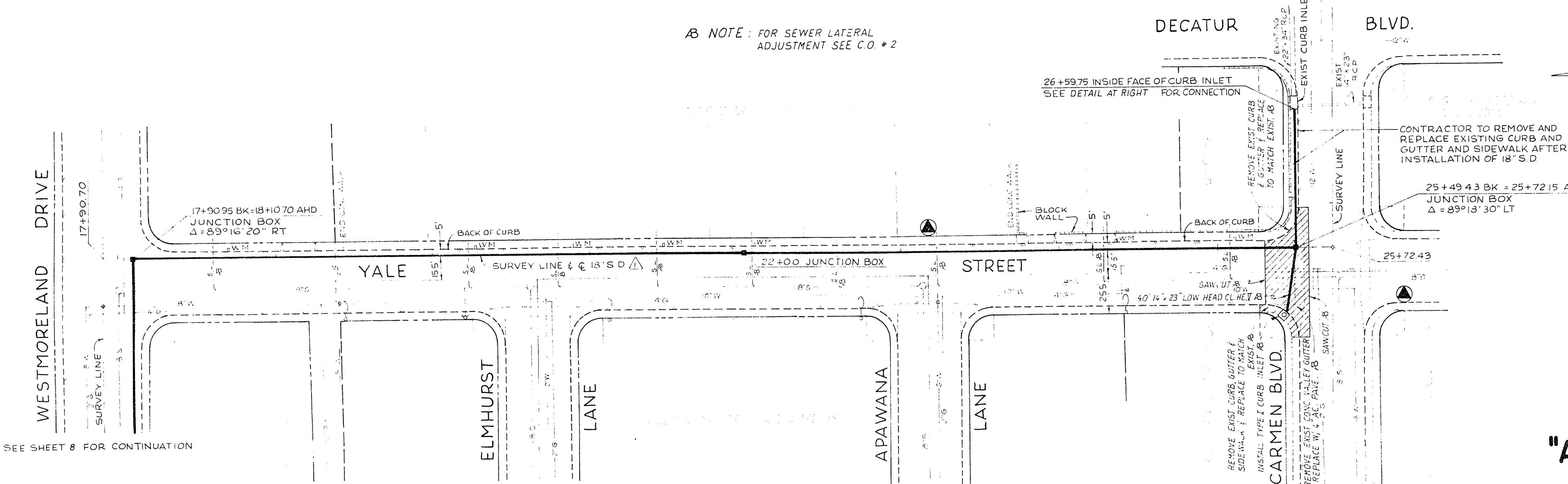

Connection Detail  
Scale: 1/2" = 1'-0"  
**"AS CONSTRUCTED"**  
6-1-73

**BENCH MARK**  
Rivet and aluminum plate stamped  
C.L.V. # 06025 A 20 on top of curb  
on Yale St. east of Apawana Lane  
Elevation = 2201.80

**BENCH MARK**  
Rivet and aluminum plate stamped  
C.L.V. # 06025 A17 on top of SE curb  
return of Yale St. and Carmen Blvd.  
Elevation = 2200.99

REGIONAL STREET & HIGHWAY COMMISSION CLARK COUNTY, NEVADA		SHEET NO
VEGAS DRIVE IMPROVEMENTS PROJECT NO. 4A		9
NUISANCE WATER DRAIN ALT. I.B. STA. 17+90.95 TO STA. 26+59.75 YALE STREET		
DESIGN R.L.G.	BOYLE ENGINEERING	1209 COMMERCE ST. LAS VEGAS, NEVADA
DRAWN G.M.B.A.H.	DATE 3-29-71	C.A.N.
CHECKED S.C.D.	APP.	07-0947-00-00 OF 15 SHEETS

DATE	2-21-72	DESCRIPTION	CHANGED 18" R.C.P. 4000-D TO 18" S.D. (TYP)	APP.	S.C.D.
REV					

107-V912