

APPROXIMATE QUANTITIES - THIS SHEET

ITEM	DESCRIPTION	UNIT	QUANTITY
201.1	ROADWAY EXCAVATION	C.Y.	---
302.1A	TYPE I GRAVEL EMBANKMENT	C.Y.	896
302.1B	TYPE I GRAVEL BASE	C.Y.	416
302.2	TYPE II GRAVEL BASE	C.Y.	185
334.5	2 1/2" ASPHALT CONC. PAVEMENT	S.Y.	1666
333.1	BITUMINOUS FOG SEAL COAT	S.Y.	1666
410.1	INSTALL 6' CHAINLINK FENCE	L.F.	315
334.5	ASPHALT CONCRETE CURB	L.F.	228
122.230	INSTALL 30" C.M.P.	L.F.	192
122.224	INSTALL 24" C.M.P.	L.F.	32
410.1	REMOVE FENCE	L.F.	135

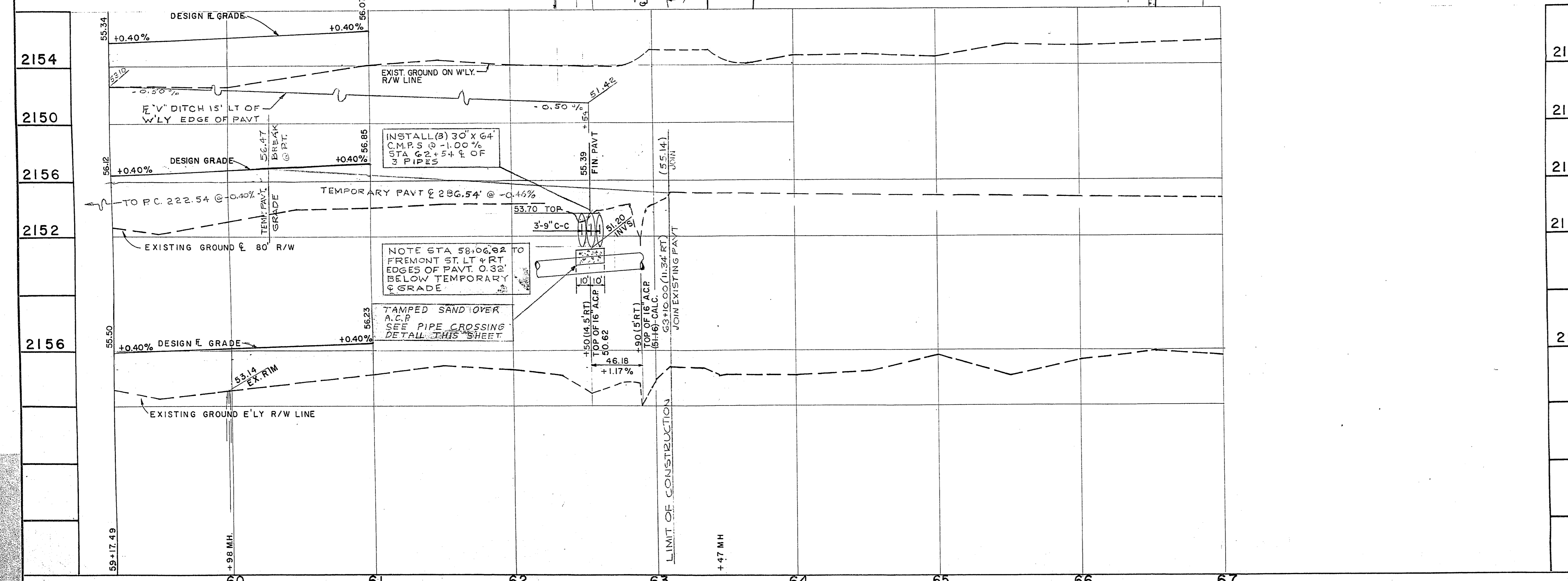

2154	APPROVED DATE: 2/10/69
2150	REVISION 1: PLAN 1/22/69
2156	REVISION 2: PLAN 1/17/69
2152	REVISION 3: PLAN 1/7/69
2156	REVISION 1: BASE THICKNESS CHANGED

REVISIONS

**CITY OF LAS VEGAS NEVADA**  
DEPARTMENT OF PUBLIC WORKS  
SERVICES DIVISION

**ALGIERS ROAD**  
**CHARLESTON BLVD - WEST FREMONT ST.**

W.O. NO. 7070 F.B.K. NO. 66-7X-59-3X DATE: 2/10/69 DRAWING NO. 107V-604B  
SC. (H) 1" = 40' SC. (V) 1" = 4'  
DES. LOUVIERE DR. LANGE JWC APPROVED BY DIRECTOR OF PUBLIC WORKS  
SHEET 8 OF 9