

SOUTHWEST GAS CORPORATION

F-CLV-VALLEY VIEW BLVD IMPROVEMENTS VALLEY VIEW BLVD N/O SAHARA AVE

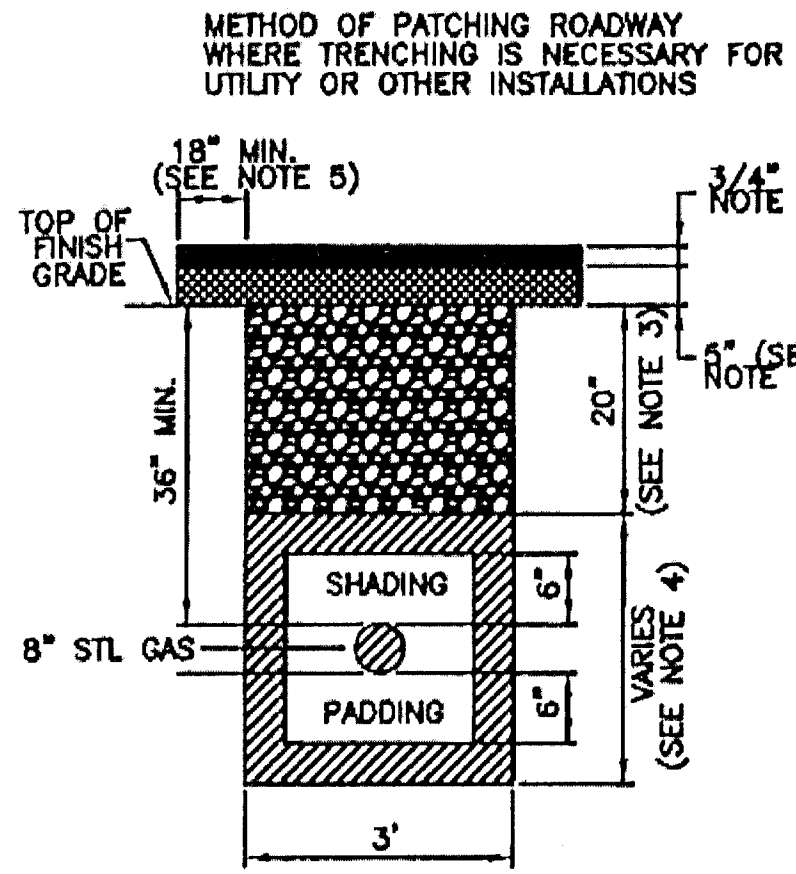
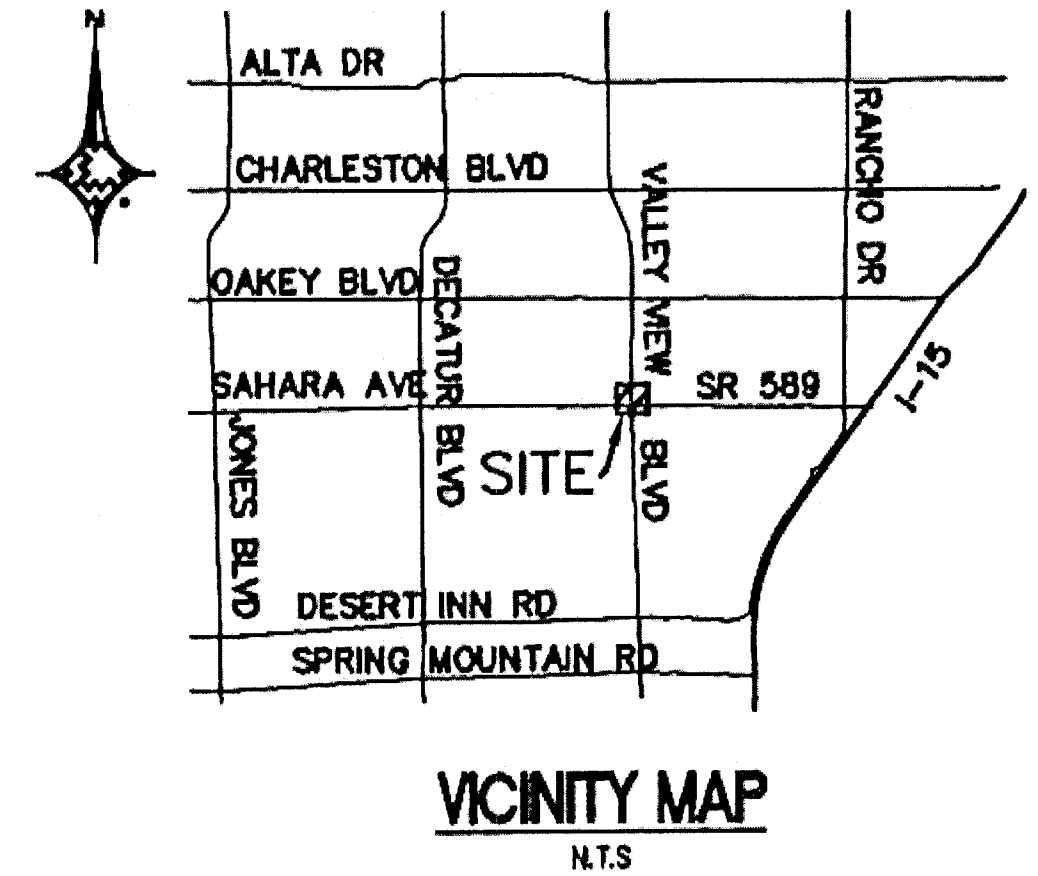

NDOT PIPE FOOTAGE	
INSTALL	11'
ABANDONED	11'
TOTAL FOOTAGE LOCATED IN NDOT Public R/W 11'	

CITY OF LAS VEGAS
 WR# 1297822 - REG STA REPLACEMENT
 (ABANDON #21DRI0002412, INSTALL #21DS10026561)
 WR# 1301660 - REG STA 2" STL INLET RELOCATION
 WR# 1325901 - DISTRIBUTION ABANDONMENT

CONSTRUCTION NOTES:

- Gas Mains shall be purged per operations manual.
- All pipeline construction shall conform to applicable jurisdiction specifications.
- Do not scale this drawing.
- Backfill and pavement restoration to comply with RTC Std 503B.
- Suggested gas locations are to clear substructures. Locate in field.
- Request for surveying and/or staking will be submitted to engineering 72 hours in advance, minimum.
- SWG work ahead of City of Las Vegas' Valley View Blvd Corridor Improvements. Anticipated CLV NTP July 1, 2011.
- SWG permanent paving requirements:
Hot patch, trench width, full depth.
- Any changes in the main location must be authorized by SWG Inspector and/or Engineer.
- All shoring requirements shall conform to applicable portions of the Operations Manual.
- All streets are public.
- Back of sidewalk not necessarily R/W, as-built from street centerline for primary dimension as provided from survey.
- No SWG work across SNWA pipeline.
- The following essential valves shall be abandoned on WR 1297822:
#1104604, 2" STL inlet, INSP #1312537
#1104605, 2" PE outlet, INSP #1314236
#1104606, 4" PE outlet/isolation, INSP #1314237
- The following essential valves shall be abandoned on WR 1297822:
#1103258, 2" CVT inlet
#1101112, 2" PE outlet
- The following essential valves shall be abandoned on WR 1325901:
#1103008, 2" PE isolation
- WR 1297822 will install regulator station #21DS10026561 with INSP #1332768

- NOTE:
- 3/4 INCH OPEN GRADE.
 - 5 INCHES MINIMUM DENSE GRADE OR MATCH EXISTING, WHICHEVER IS GREATER. TYPE II BASE AGGREGATE (AS PER NDOT SPECIFICATIONS).
 - SECTION 704) A MINIMUM OF 20 INCHES TO BE LAID IN MAXIMUM 8 INCHES LOOSE LIFTS. 95% COMPACTION REQUIRED.
 - BACKFILL WITH SELECT MATERIAL TO BOTTOM OF BASE AGGREGATE (AS PER NDOT SPECIFICATIONS; SECTION 207), 90% COMPACTION REQUIRED.
 - LIMITS OF PAVING TO BE DETERMINED BY THE NDOT INSPECTOR.

LEGEND FOR SWG FACILITIES IN NDOT R/W FOR NDOT R/W PERMIT ONLY

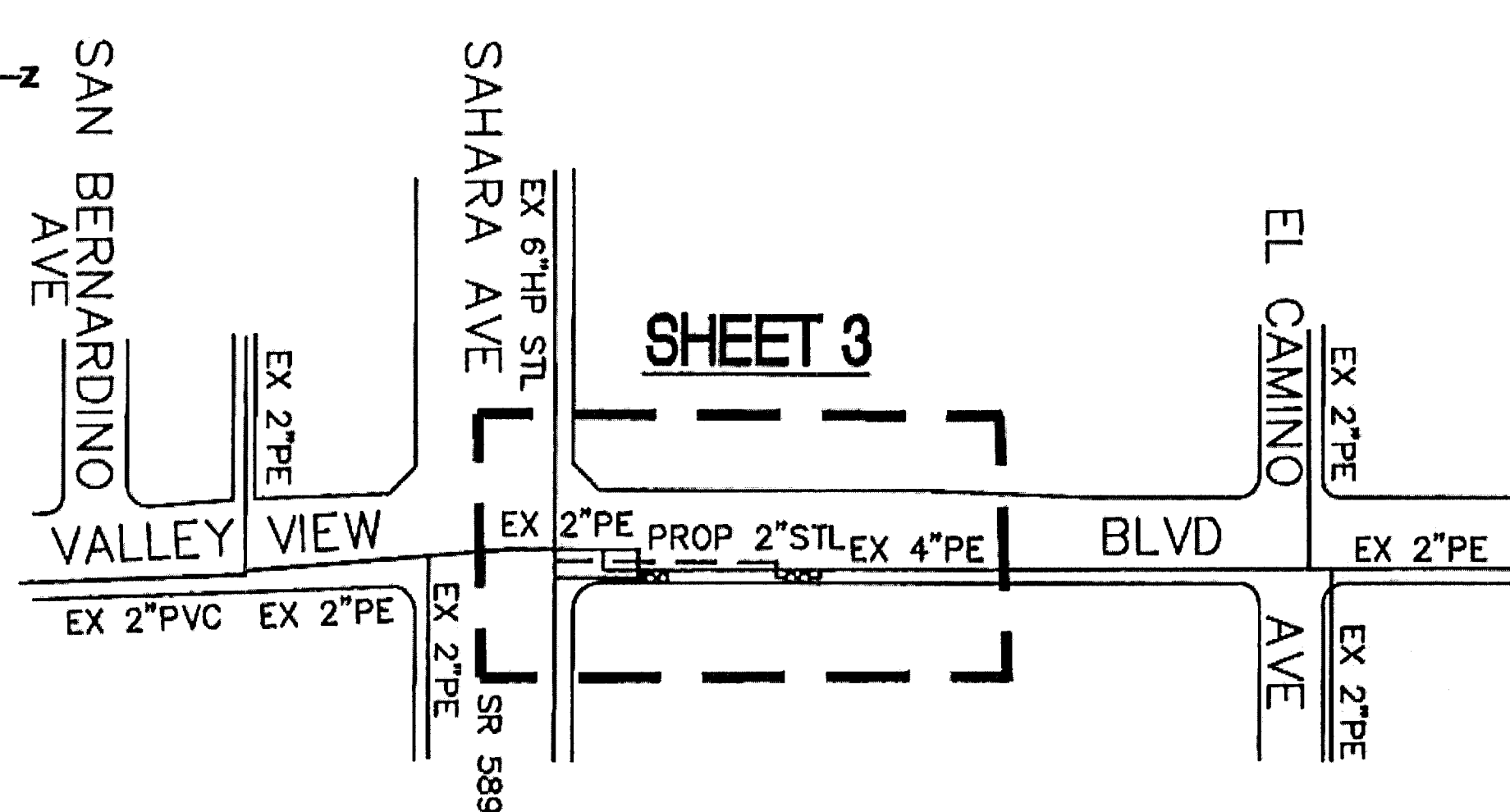
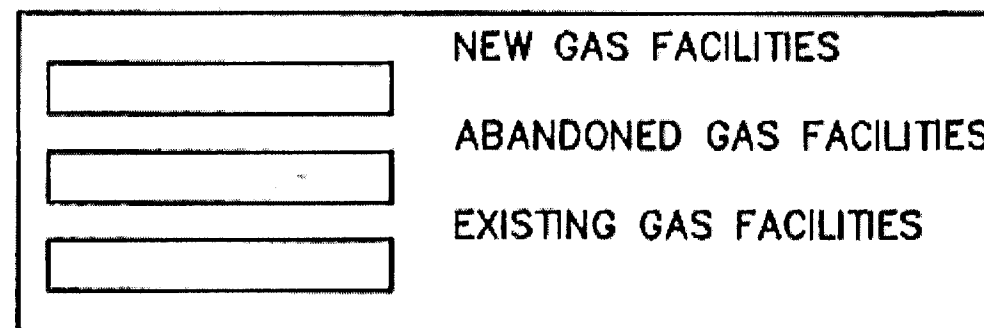

LOCATION MAP

N.T.S.

- REPLACEMENT
- NEW INSTALL

EXISTING PIPELINE	TRANSMISSION OR DISTRIBUTION
EXISTING PIPELINE SMYS AT M.O.P.	19.95%
PROPOSED PIPELINE	TRANSMISSION OR DISTRIBUTION
PROPOSED PIPELINE SMYS AT M.O.P.	19.95%

THIS PROJECT ADDRESSES THE THREAT OF INTERNAL CORROSION THROUGH THE EXISTENCE OF AN UPSTREAM FILTER/SEPARATOR AT THE POINT OF SUPPLY: PECOS, CENTENNIAL, LONE MOUNTAIN, BLUE DIAMOND, AND GVPLS (TAP SITES)

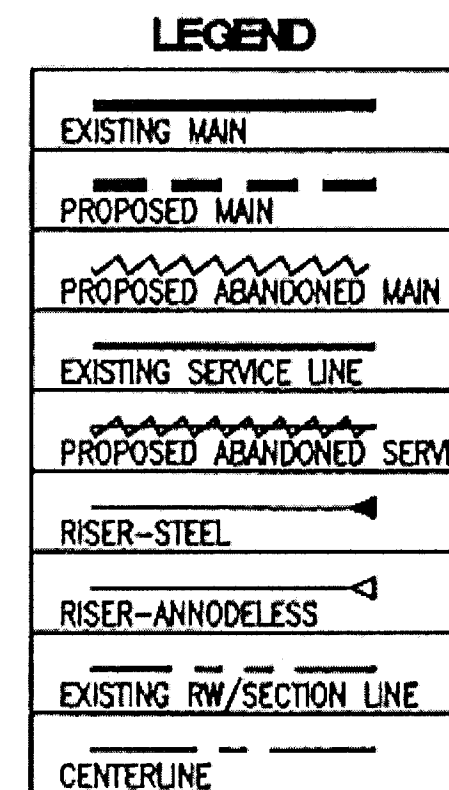

CATHODIC PROTECTION NOTES

- INSTALL CP TEST STATION, SEE SHEET 2 FOR DETAILS AND SHEETS 3 AND 4 FOR LOCATIONS.
- FOR ALL CP RELATED WORK CALL TECHNICAL SERVICES AT 365-2388 A MINIMUM OF 48 HOURS IN ADVANCE TO SCHEDULE CP ASSISTANCE/ INSPECTION.
- C.P. AREA R 15/18 2-B, WMIS #21TCP0079644

APPROVED FOR CONSTRUCTION
 THIS APPROVAL IS FOR WORK IN CLV R/W OR CLV EASEMENTS ONLY. OBTAINING PERMISSIONS OR EASEMENTS FOR WORK SHOWN ON PRIVATE PROPERTY IS THE RESPONSIBILITY OF THE UTILITY.
 APPROVAL: [Signature] DATE: 5/19/11

Hansen # 38800 Dwg # 107V5621-SWG-2

SNWA CONSTRUCTION NOTE:

NOTE:
 Contractor shall field locate and protect all SNWA/SNWS access appurtenances, including but not limited to AV/AR, access manways and cathodic protection systems. All above ground structures and at grade structures must be adjusted to new grade at contractors expense. Cathodic protection test stations, rectifiers, and AV/AR's must be relocated to the sidewalk per SNWA standards and at the contractors expense. Contractor to NOTIFY SOUTHERN NEVADA WATER AUTHORITY, DEVELOPMENT PLAN REVIEW, at (702) 862-3444 at least 48 hrs prior to construction activity.

PURGE PLAN WAS COMPLETED IN ACCORDANCE WITH THE OPERATIONS MANUAL GUIDELINES BY:

PRINT: _____ DATE: _____
 SIGNATURE: _____

SYSTEM	D_VALLEY_VIEW
DR. NO.	21DR10002412
SEGMENT M.A.O.P.	N/A
SYSTEM M.A.O.P.	43 PSIG
SYSTEM M.O.P.	43 PSIG

SYSTEM	EDNA_120_PSIG
DR. NO.	
SEGMENT M.A.O.P.	720 PSIG
SYSTEM M.A.O.P.	120 PSIG
SYSTEM M.O.P.	120 PSIG

APPROVALS:

SOUTHERN NEVADA WATER AUTHORITY DATE _____
 SNWA approval is valid for one (1) year from the signature date, If construction within the easement or restricted pipe safety zone is not complete, plans must be resubmitted to SNWA for approval.

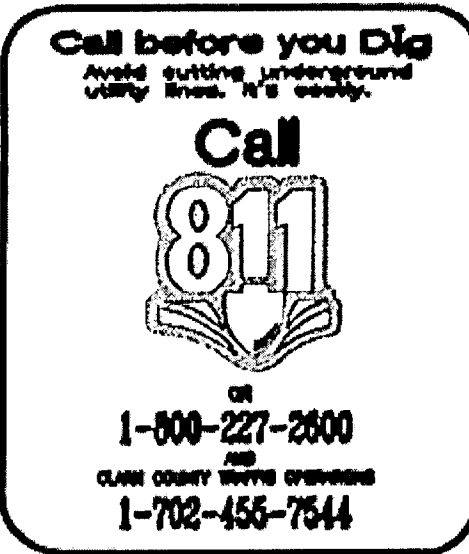

WR 1297822				
3780005	VAULT	2	2	
3780010	REG	2	2	
3780012	FILTER	2	2	

WR 1301660				
3760202	2" STL	132'	-	
3760204	4" STL	5'	-	

WR 1325901				
3760102	2" PE	-	36'	
3760104	4" PE	-	24'	
UNIT NO.	UNIT TYPE	INSTL. PROPOSED	RET. COMPLETED	

AS-BUILT DRAWING-PRESSURE TEST DATA			
PIPE DIA.	TEST MEDIUM	TEST METHOD	
PIPE LENGTH	<input type="checkbox"/> AIR	<input type="checkbox"/> GAUGE	
PIPE TYPE	<input type="checkbox"/> NITROGEN	<input type="checkbox"/> CHART	
MIN. DURATION	<input type="checkbox"/> WATER	<input type="checkbox"/> GAUGE/ CHART	
	<input type="checkbox"/> SOAP	<input type="checkbox"/> PRESS REC SN#	
TEST PRES. (PSIG)	START	END	
TIME			
DATE			
PERFORMED BY			

VISUAL INSPECTION CERTIFICATION	
I HAVE VISUALLY INSPECTED ALL HEATED FUSIONS, SOLVENT, MECHANICAL JOINTS, AND WELDS THAT I HAVE PERFORMED	
NAME	DATE
AS-BUILTS ACCEPTED BY	DATE
POSTED BY	DATE
POSTING QCD BY	DATE

CONSTRUCTION	
INSPECTOR	
FOREMAN	
REVIEWED BY	
PERMIT INFORMATION	
CITY OF LAS VEGAS	NDOT
TAX CODE	02-0200

ISOLATION AREA	
DIST-95	
DIST-185	
HP 120-14	
LOCATION	T 21 S R 61 E SEC 5
ATLAS #/TILE #	x615y506 x615y508

ENGINEER/TECHNICIAN: BOB MIDDAG	PHONE 365-2071
ACCOUNT REP:	PHONE
PROJECT CONTACT:	PHONE
SHEET NO. 1 OF 5	SCALE 1" = 10'
DWN. BY: ZONE	CHKD. BY
APPVD. BY	
TITLE	
F-CLV-VALLEY VIEW BLVD IMPROVEMENTS VALLEY VIEW BLVD N/O SAHARA AVE REGULATOR STATION REPLACEMENT	



4/887