

SEC. #	DATE	DESIGNED	APR.

CITY OF LAS VEGAS
CLARK COUNTY
HENDERSON
NORTH LAS VEGAS

MATCHLINE 'A' SEE SHEET 1 OF 2

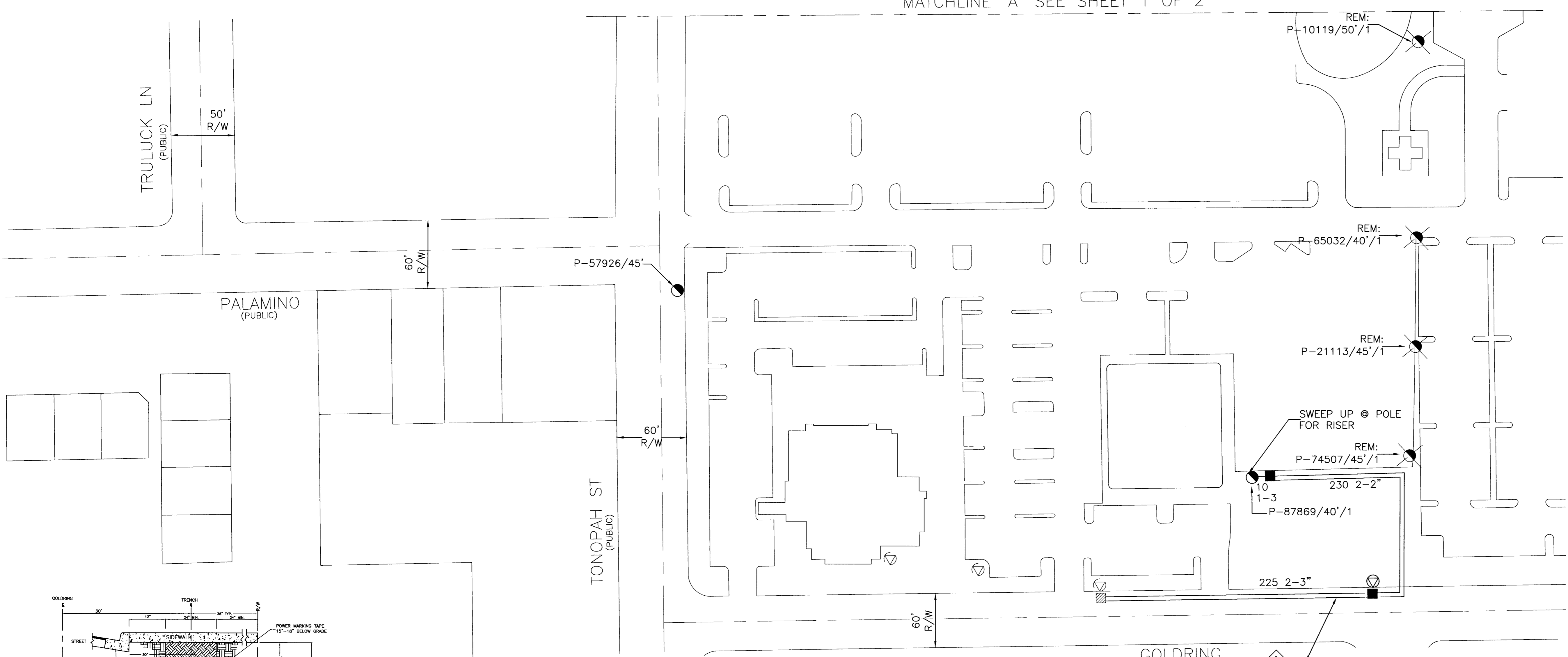

LEGEND

- PROPOSED VAULT 22 1/4" X 35 1/4" X 12" MARKED "CABLE TV" (B-36)
- PROPOSED VAULT 21 3/4" X 23 1/4" X 12" MARKED "CABLE TV" (B-24)
- PROPOSED VAULT 15 3/4" X 25 1/4" X 12" MARKED "CABLE TV" (N-16)
- PROPOSED MEDIUM LOCKBOX
- PROPOSED LARGE LOCKBOX
- PROPOSED ONE INCH (1") PVC CONDUIT
- PROPOSED TWO INCH (2") PVC CONDUIT UNLESS NOTED OTHERWISE
- 900 PROPOSED PREWIRE BOX BN-900 TV
- 1020 PROPOSED PREWIRE BOX BN-1020 TV
- + STUB AND CAP BEYOND IMPROVEMENT LIMITS
- ▣ EXISTING VAULT 22 1/4" X 35 1/4" X 12" MARKED "CABLE TV" (B-36)
- ▣ EXISTING VAULT 21 3/4" X 23 1/4" X 12" MARKED "CABLE TV" (B-24)
- ▣ EXISTING VAULT 15 3/4" X 25 1/4" X 12" MARKED "CABLE TV" (N-16)
- EXISTING TWO INCH (2") PVC CONDUIT
- ⊠ EXISTING TELCO MANHOLE
- ⊠ EXISTING 3' X 5' X 4' TELCO PULL BOX
- ⊠ EXISTING 2'-6" X 4' X 3' TELCO PULL BOX
- ⊠ EXISTING 17" X 30" X 29 1/2" TELCO UTILITY BOX
- ⊠ EXISTING 9 5/8" X 16" X 24" TELCO SERVICE BOX
- EXISTING TELCO POLE
- × EXISTING POWER COMPANY POLE
- ⊗ EXISTING JOINT POLE
- ⊗ EXISTING JOINT POLE WITH A POWER TRANSFORMER
- ⊗ EXISTING OR PROPOSED CATV PEDESTAL 1730
- ⊗ EXISTING OR PROPOSED CATV PEDESTAL 1230
- ⊗ RISER POLE/QUADRANT DETAIL
- ⊗ RISER OWNERSHIP NOTED (C) CATV (T) TELCO
- ⊗ INSTALL EIGHT FOOT (8') GROUND ROD

CATV CONTACT: TERRY SOVEY
PHONE: (702) 384-8084 EXT.8334

QA NUMBER: 928
QA NAME: JOHN THOMAS
CELL #: 210-3415

NOTE:
WORK PERFORMED SHALL COMPLY WITH THE FOLLOWING (AS APPLICABLE):

- THE REGULATIONS AND CRITERIA AS SET FORTH BY THE UNIFORM STANDARD SPECIFICATIONS FOR PUBLIC WORKS CONSTRUCTION, OFF-SITE IMPROVEMENTS, AND THE UNIFORM STANDARD DRAWINGS FOR PUBLIC WORKS CONSTRUCTION.
- ALL APPLICABLE LOCAL (CITIES AND/OR COUNTY), STATE BUILDING CODES AND ORDINANCES.

1590 LINEAR FOOTAGE
4 NO. OF VAULTS

Approved for Construction
THIS APPROVAL IS FOR WORK IN CITY OF LAS VEGAS RIGHT OF WAY OR EASEMENTS ONLY. OBTAINING PERMISSION, EASEMENTS, OR RIGHTS OF ENTRY FOR WORK ON PRIVATE PROPERTY IS THE RESPONSIBILITY OF THE UTILITY.

CLV DESIGNEE APPROVAL _____ DATE _____

NOTE: All trench common w/ SPRINT Telephone &/or Nevada Power Co. Unless noted: "TV only trench"

- Ⓡ REFERENCES DETAIL LETTER SEE CORELATED DETAILS
- Ⓐ FUTURE PEDESTAL LOCATION
- Ⓑ TIE TO 2" STUBS & EXTEND
- Ⓒ IN FUTURE SIDEWALK

City of Las Vegas
PERMIT REQUIRED

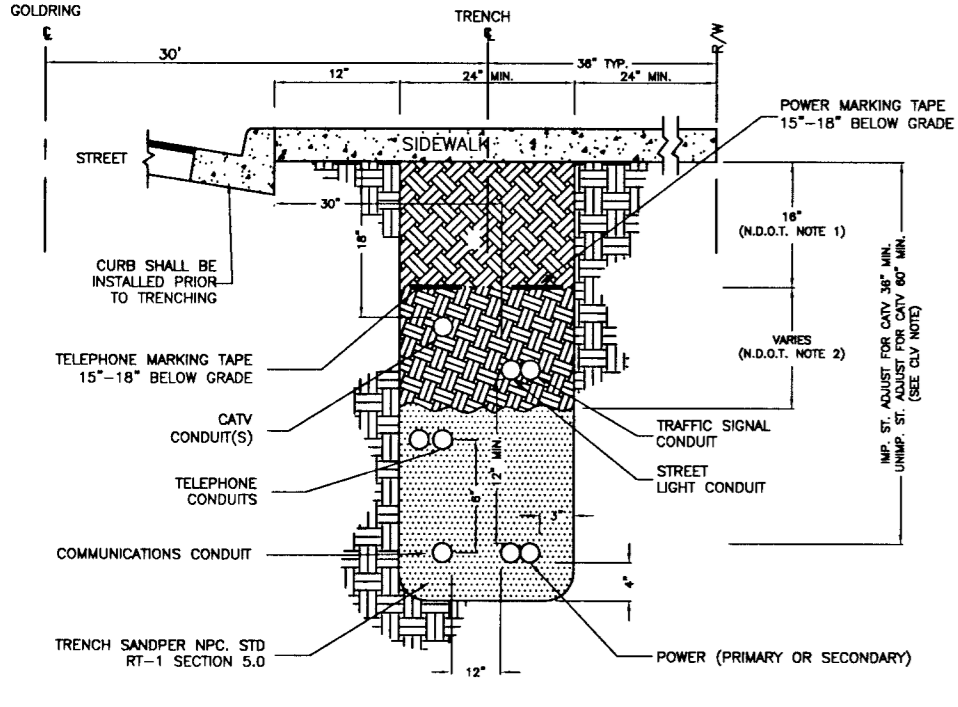

SIDWALK TRENCH DETAIL
PUBLIC (NOT TO SCALE)

NOT REQUIREMENTS (APPLICABLE WITHIN NOTED RIGHT-OF-WAY ONLY):

- BASE AGGREGATE (AS PER NOTED SPECIFICATIONS SECTION 704). A MINIMUM OF 18 INCHES TO BE Laid IN MAXIMUM 8 INCH LOOSE LITS. SOIL COMPACTION REQUIRED.
- BACKFILL WITH SELECT MATERIAL TO BOTTOM OF BASE AGGREGATE (AS PER NOTED SPECIFICATIONS SECTION 207). SOIL COMPACTION REQUIRED.

CLV REQUIREMENTS (APPLICABLE WITHIN CITY OF LAS VEGAS LIMITS ONLY):

IMPROVED AREA (IMP. ST.) (LOCATION OF TRENCH)
AREA WILL BE CONSIDERED IMPROVED IF IT MEETS ONE OR MORE OF THE FOLLOWING CRITERIA:
-EXISTING PERMANENT PAVEMENT WITH CURB & GUTTER AND/OR ADJACENT PERMANENT SIDEWALK
-WITHIN AN IMPROVED TRAIL AREA
-LIMITS OF CONSTRUCTION NOTAL CONCURRENT WITH A PRIVATE OR PUBLIC PROJECT

UNIMPROVED AREA (UNIMP. ST.) (LOCATION OF TRENCH)
ANY OTHER DESIGNATED THAT FAILS TO MEET THE IMPROVED AREA CRITERIA) WILL BE CONSIDERED AN UNIMPROVED AREA.

SPRINT REQUIREMENTS:
FOR ALL OTHER JURISDICTIONS REFER TO SPRINT STANDARDS.
SCHEDULE REQUIREMENTS NPC STD. #1-1.
TRENCH DEPTH REQUIREMENTS NPC STD. #1-2.

108499

COX COMMUNICATIONS

WYSAN VALLEY SURGERY ADDITION

SCALE: 1" = 50' UNITS

PRINT # 5447 SHEET 2 OF 2 GIS # P535343 PREFOLDER: 928

CLV Permit # _____ NPC Proj. ID: 178445 SPRINT Proj. ID: _____

DATE	BY	APPROVED	REVIS
07-31-06	CM		
08-29-06	DB		

10704770-cox