

## SANDY TURTLE AVENUE (PRIVATE)

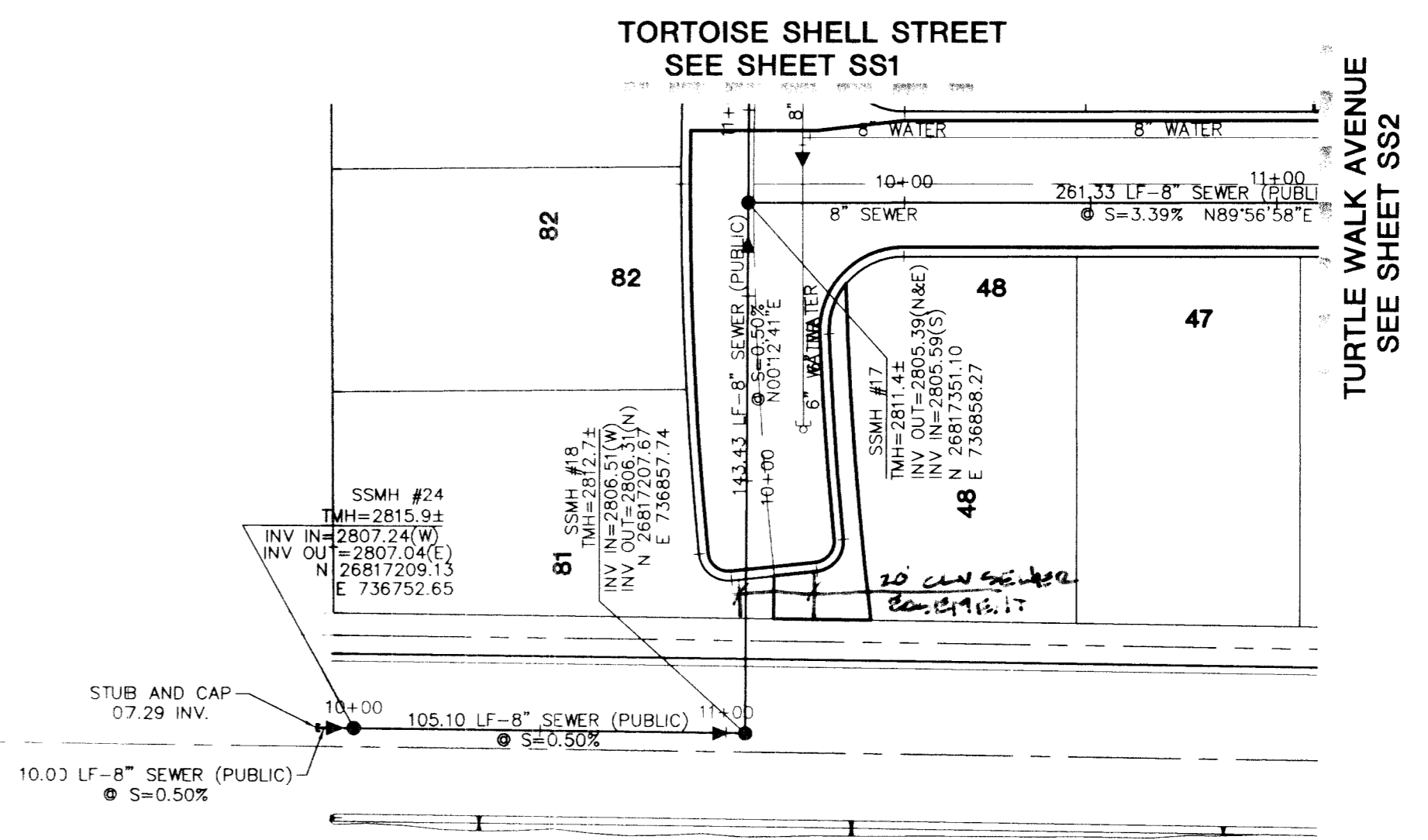

## DONALD NELSON AVENUE (PUBLIC)

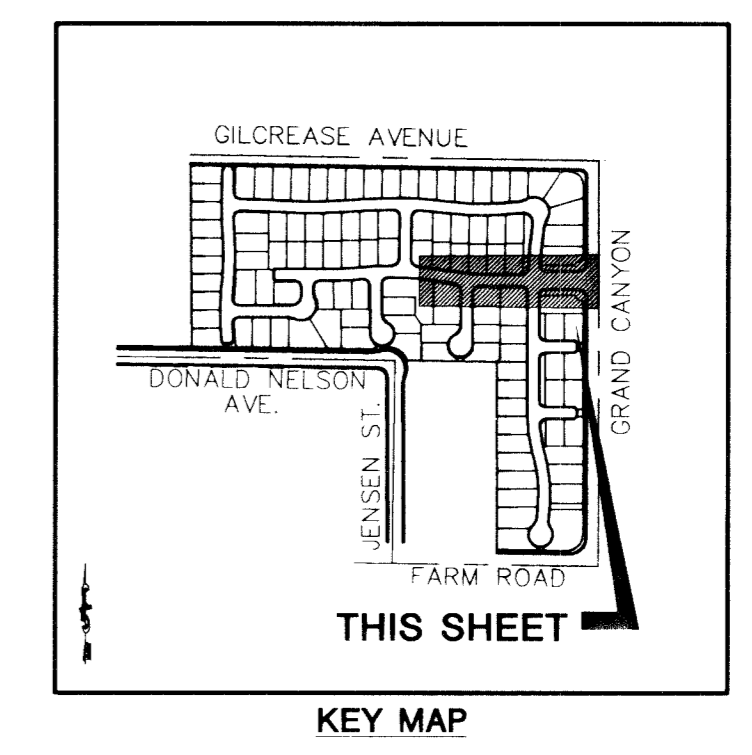
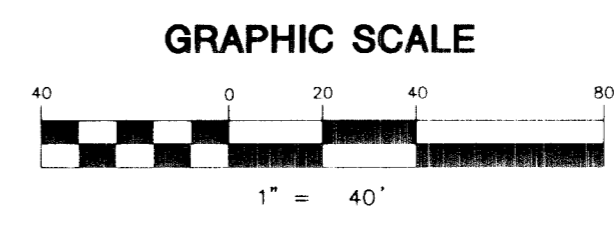
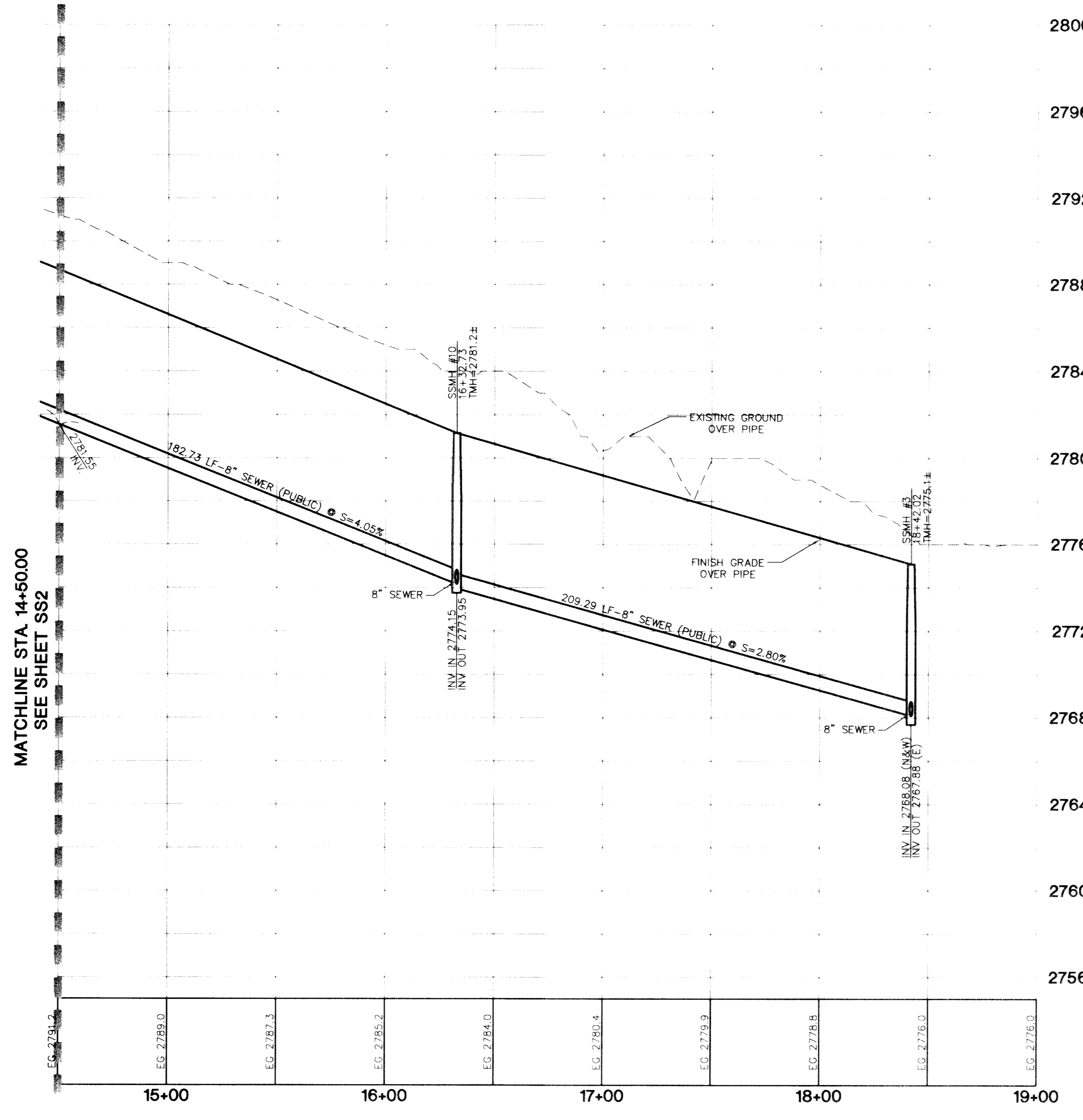
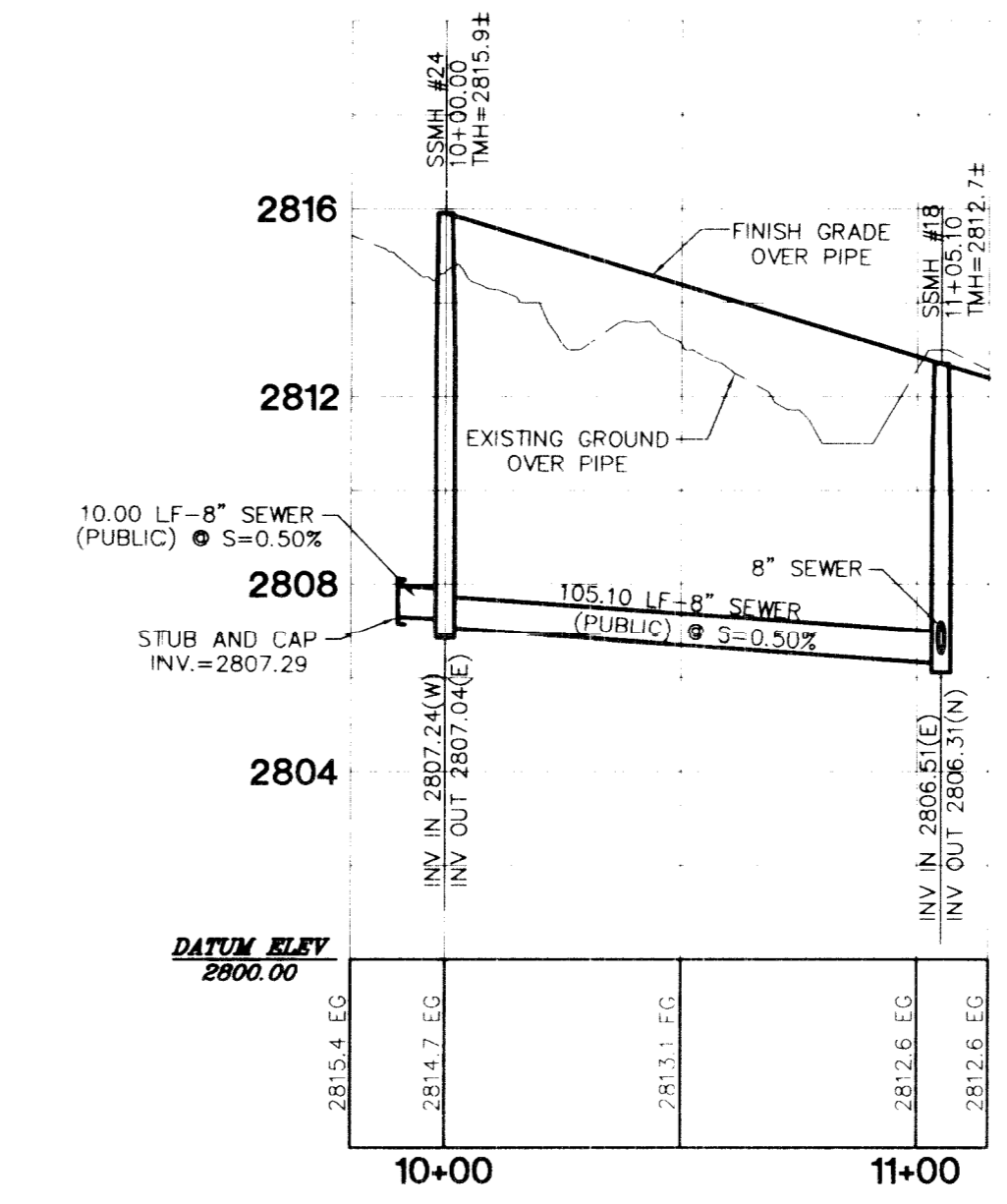

**NOTE:**  
ALL PRIVATE STREETS ARE P.U.E., PUBLIC SEWER EASEMENTS, AND PUBLIC DRAINAGE EASEMENTS TO BE PRIVATELY MAINTAINED BY HOA.

**Call before you Overhead**  
1-702-227-2929

**Call before you Dig**  
1-800-227-2600

**Call before you Underground**  
1-702-465-7911

**BENCHMARK**  
PROJECT DATUM: NAVD88  
CITY OF LAS VEGAS BENCHMARK: BLV9913NEE6  
NAVD88 ELEVATION: 873.310 METERS (2866.89 FEET)  
RIVET AND PLATE IN CONCRETE CYLINDER  
AT THE SOUTHWEST CORNER OF HAULAPAI  
AND GILCREASE

**BASIS OF BEARING**  
THE BASIS OF BEARINGS FOR THIS PROJECT IS SOUTH 89°11'31" EAST BEING THE NORTH LINE OF THE NORTHWEST QUARTER (NW 1/4) OF THE NORTHWEST QUARTER (NW 1/4), SECTION 18, TOWNSHIP 19 SOUTH, RANGE 60 EAST, M.D.M., CLARK COUNTY, NEVADA, AS SHOWN ON A RECORD OF SURVEY ON FILE IN THE CLARK COUNTY, NEVADA RECORDER'S OFFICE IN FILE 123 AT PAGE 32.

7	6	5	4	3	2	1	REV	DATE	BY	REVISION
<p><b>PERMA-BILT HOMES</b> CITY OF LAS VEGAS, NEVADA 2727 SOUTH RAINBOW BOULEVARD LAS VEGAS, NEVADA 89146-5148 7150 POLLOCK DRIVE, SUITE 104 LAS VEGAS, NEVADA 89119 PH: (702) 933-7550 FAX: (702) 962-2597</p> <p><b>SEWER PLANS AND PROFILE</b> SANDY TURTLE AVENUE STA. 14+50.00 TO STA. 18+42.02</p> <p><b>VALLEY CREST II EAST</b></p>										
<p>DRAWN BY: 6/18/03 DESIGNED BY: B.F. CHECKED BY: K.C. PROJECT NO: 6157</p> <p>SCALE: 1"=40' HORIZ. 1"=4' VERT.</p>										
<p>PROFESSIONAL ENGINEER - STATE OF NEVADA DARRIN J. PAPPA No. 15815 CIVIL</p>										
<p>SHEET <b>SS3</b> 19 OF 40 SHEETS DRAWING NO: 1074903</p>										