

SEWER INTERCONNECT

SCALE: HORIZ. 1" = 20'
VERT. 1" = 5'
SEE SHEET 4 FOR CONSTRUCTION NOTES

MATCHLINE 12+45 SEE SHEET C-16

MATCHLINE 13+00 SEE SHEET C-16

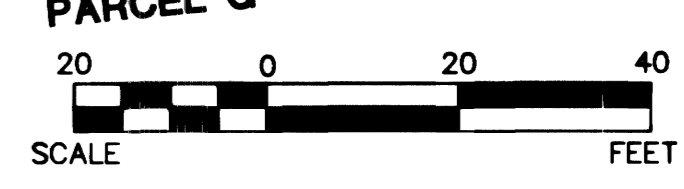
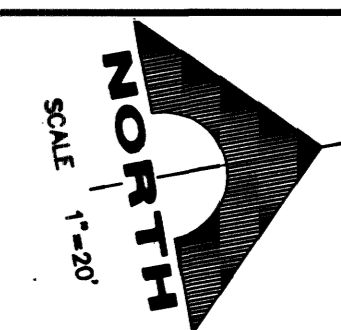
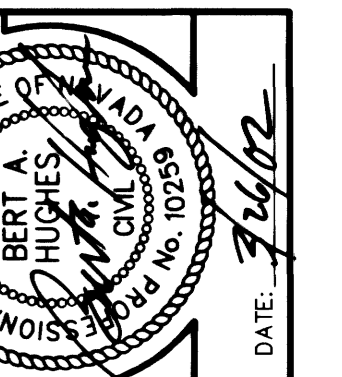

NO.	DATE	DESCRIPTION
1	10/16/01	ISSUE FOR AGENCY APPROVAL
2	11/16/01	REVISE SEWER NOTES
3	03-25-02	ISSUE DATE
4	14-31-27	ISSUE DATE

DESIGN: _____
DRAWN: _____
CHECK: _____
ISSUE DATE: _____
PLOT DATE: 03-25-02
PLOT TIME: 14:31:27

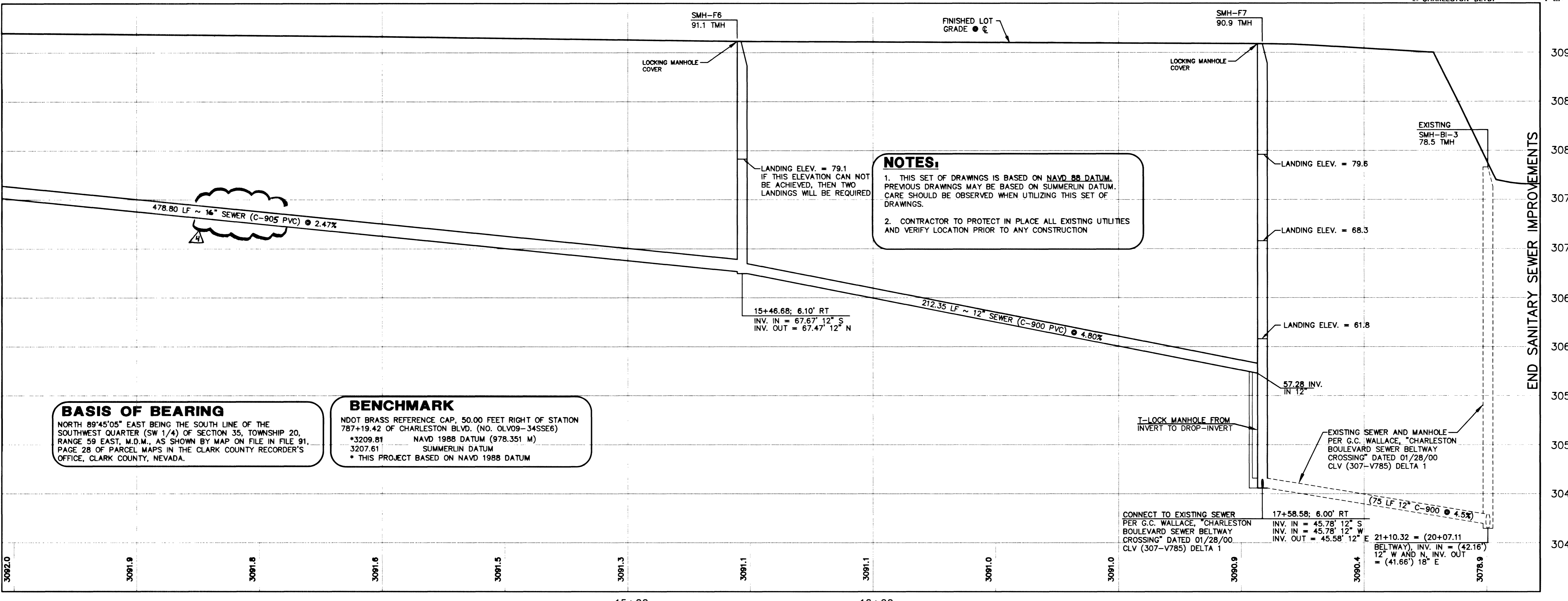
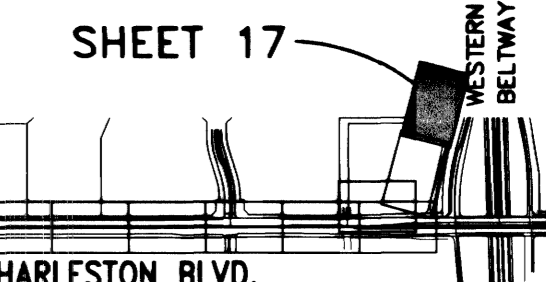

NOTES:

- THIS SET OF DRAWINGS IS BASED ON NAVD 88 DATUM. PREVIOUS DRAWINGS MAY BE BASED ON SUMMERLIN DATUM. CARE SHOULD BE OBSERVED WHEN UTILIZING THIS SET OF DRAWINGS.
- CONTRACTOR TO PROTECT IN PLACE ALL EXISTING UTILITIES AND VERIFY LOCATION PRIOR TO ANY CONSTRUCTION

BASIS OF BEARING
NORTH 89°45'05" EAST BEING THE SOUTH LINE OF THE SOUTHWEST QUARTER (SW 1/4) OF SECTION 35, TOWNSHIP 20, RANGE 59 EAST, M.D.M., AS SHOWN BY MAP ON FILE IN FILE 91, PAGE 28 OF PARCEL MAPS IN THE CLARK COUNTY RECORDER'S OFFICE, CLARK COUNTY, NEVADA.

BENCHMARK
NDOT BRASS REFERENCE CAP, 50.00 FEET RIGHT OF STATION 787+19.42 OF CHARLESTON BLVD. (NO. 0LV09-34SSE6)
* 3209.81 NAVD 1988 DATUM (978.351 M)
* 3207.61 SUMMERLIN DATUM
* THIS PROJECT BASED ON NAVD 1988 DATUM

DESIGN: _____
DRAWN: _____
CHECK: _____
ISSUE DATE: _____
PLOT DATE: 03-25-02
PLOT TIME: 14:31:27

G.C. WALLACE, INC.
Engineering/Architecture
1555 SOUTH RAINBOW BLVD., LAS VEGAS, NEVADA 89146
TELEPHONE: (702) 804-2000 • FAX: (702) 804-2299
F: 650202\314.DWG\MP5.DWG - P017.dwg

SUMMERLIN
V 19/20 CHARLESTON BOULEVARD IMPROVEMENTS
STATION 787+31 TO STATION 841+02
PLAN & PROFILE - SEWER INTERCONNECT
STA. 13+00 TO 18+37.38

SHEET
C-17
17 OF 30 SHEETS

JOB NO. 62020224