

MATCHLINE STA 795+00 SEE BELOW

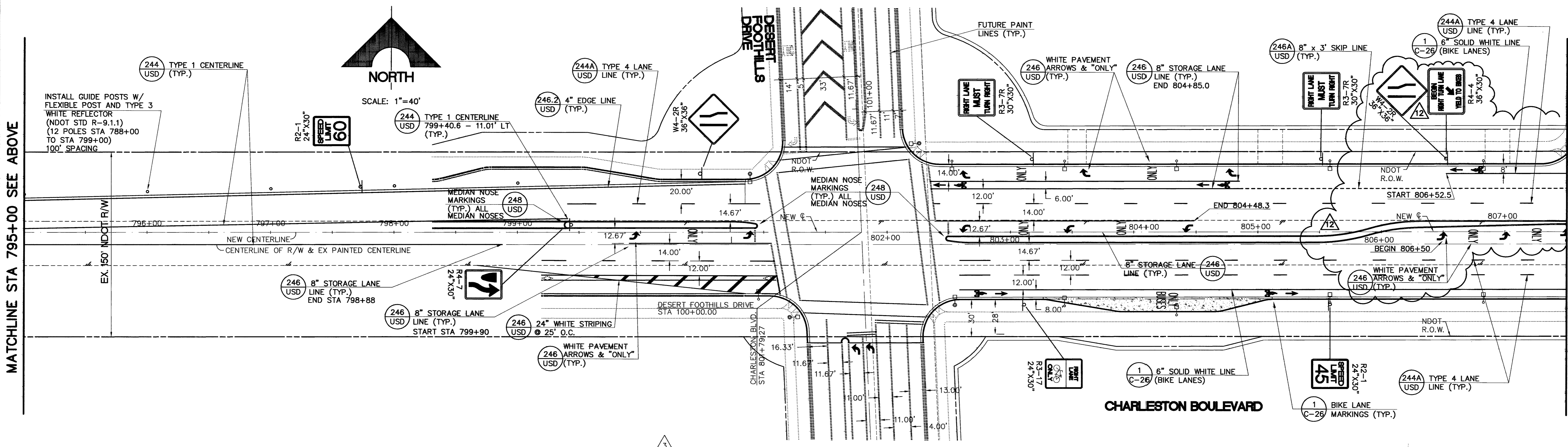

MATCHLINE STA 795+00 SEE ABOVE

MATCHLINE STA 807+50 SEE SHEET C-27

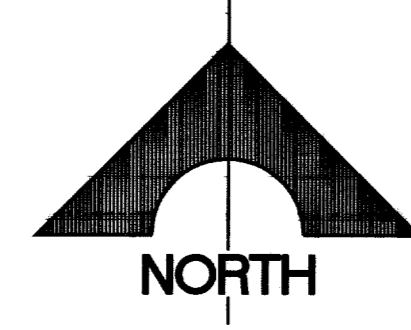

- GENERAL NOTES**
- FOLLOWING THE COMPLETION OF THE 3/4" OPEN GRADE ASPHALT, THE FINAL STRIPING SHALL BE INSTALLED PER THIS PLAN.
 - SIGNAGE SHALL BE INSTALLED PRIOR TO OPENING ANY PORTION OF THE ROADWAY TO PUBLIC TRAFFIC.
 - ALL LANE DELINEATIONS TO BE MEASURED AT RIGHT ANGLES AND PARALLEL TO BACK OF CURB TO CONFORM TO CURB ANGLE POINTS AND TRANSITIONS.
 - SEE SHEET C-2 (OF THIS CONTRACT SET) FOR TRAFFIC NOTES.
 - ALL COLD POLYMER FILM STOP BARS, CROSSWALKS, PAVEMENT ARROWS AND PAVEMENT MARKINGS SHALL BE 3M-N440 OR EQUIVALENT.
 - ALL CONSTRUCTION AND MATERIALS FOR THIS PROJECT SHALL BE IN ACCORDANCE WITH THE "UNIFORM STANDARD SPECIFICATIONS FOR PUBLIC WORKS CONSTRUCTION" CLARK COUNTY AREA, NEVADA, THIRD EDITION, AND THE DEPARTMENT OF PUBLIC WORKS, CLARK COUNTY, NEVADA "IMPROVEMENTS STANDARDS 1983" - REVISED MAY, 1990 UNLESS OTHERWISE SPECIFIED BY NOTE ON THE DRAWINGS AND/OR SPECIFICATIONS.
 - ALL DIMENSIONS ARE TAKEN TO BACK OF CURB AND LANE LINES UNLESS OTHERWISE NOTED.
 - SIDEWALK RAMP TO BE INSTALLED BY OTHERS. DEPRESSED CURB CONSTRUCTION AT FUTURE RAMP LOCATIONS AS PER SUMMERLIN STANDARDS S-75
 - TEMPORARY STRIPING SHALL BE DEFINED AS ALL 4" WIDE PAINTED STRIPING IN THE CONFIGURATION AS THE FINAL STRIPING INDICATED ON THIS PLAN UNLESS NOTED OTHERWISE

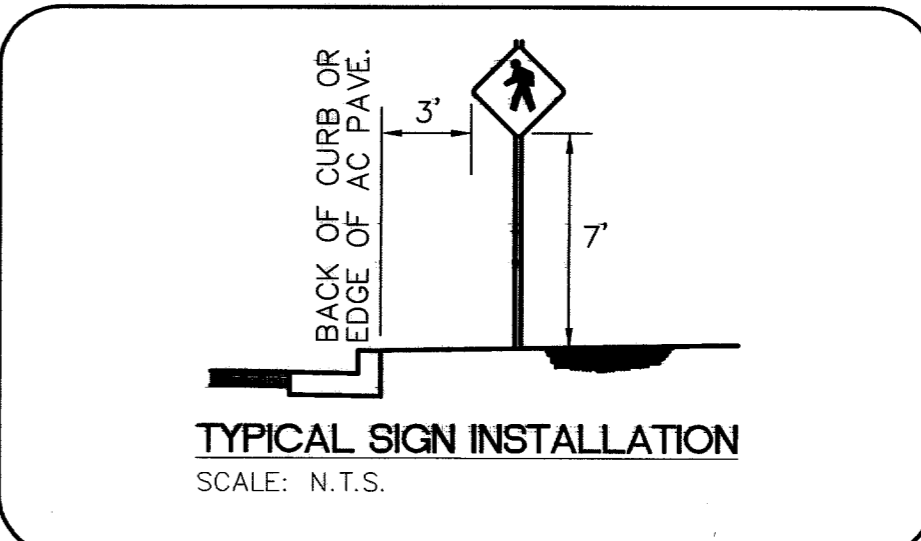
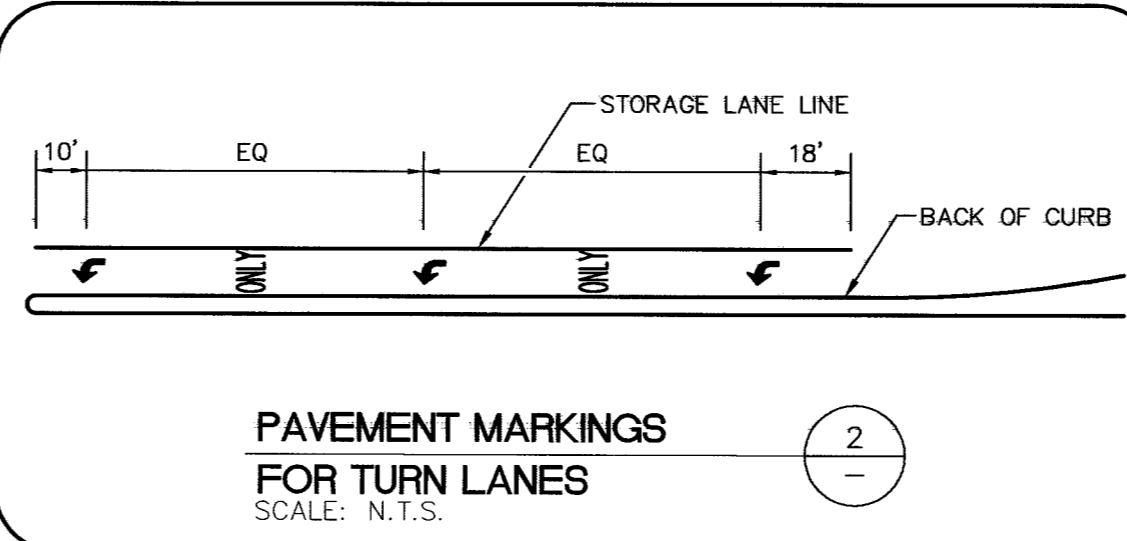
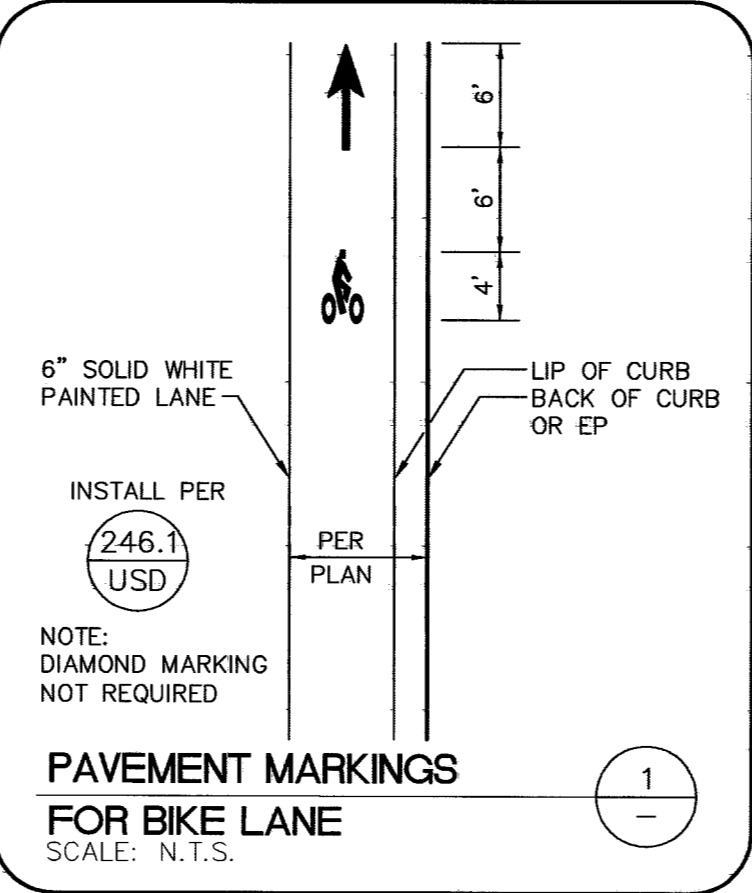

NDOT ENCROACHMENT PERMIT REQUIRED

Civil Engineering Division
Clark County Development Services
By: *[Signature]*
ACCEPTED
Date: *[Date]*

ACCEPTANCE OF THESE PLANS SHALL NOT BE CONSTRUED TO BE A PERMIT FOR OR AN APPROVAL OF ANY VIOLATION OF STATE, COUNTY, OR FEDERAL LAW, SPECIFICATIONS, OR THE MANUAL ON UNIFORM TRAFFIC CONTROL DEVICES.

JOB NO. 62020.224

SHEET C-26 26 OF 30 SHTS

SUMMERLIN V 19/20 CHARLESTON BOULEVARD IMPROVEMENTS STATION 787+81 TO STATION 84+02 SIGNAGE AND STRIPING PLAN

G. C. WALLACE, INC. Engineering/Architecture 1555 SOUTH HANBROW BLVD./LAS VEGAS, NEVADA 89146 P. 702.804.2289 F. 702.804.2289

REV.	DATE	DESCRIPTION
1	12/14/14	ISSUE DATE: 8/18/04 ADD RIGHT TURN LANE & MEDIAN ISLAND OPENING FOR PARKED A ENTRY. ISSUE EDITOR: <i>[Signature]</i> PLOT DATE: 12-10-04
2	8/28/02	SPEED, SIGN, BIKE SIGNS AND MARKINGS REVISED. FLEXIBLE REFLECTOR POLES ADDED AND CHEWINGS ADDED. SOME REMOVE