

BENCHMARK
 CLARK COUNTY BENCHMARK NO. 7001, 1966 - RIVET AND PLATE IN TOP OF CURB SOUTHEAST RETURN OF RANCHO DRIVE AND CORAN LANE.
 NAVD 1988 DATUM
 ELEVATION = 656.6065 METERS
 2154.22 FEET

BASIS OF BEARING
 THE BASIS OF BEARING FOR THIS PROJECT IS GRID NORTH AS DEFINED BY THE NEVADA COORDINATE SYSTEM OF 1983 (NCS83). EAST ZONE (2701). DETERMINED BY GIS CONTROL POINTS, 825' AND 'TUPICS' AS SHOWN ON A RECORD OF SURVEY ON FILE IN THE CLARK COUNTY RECORDER'S OFFICE. IN FILE 88 OF SURVEYS, AT PAGE 53.

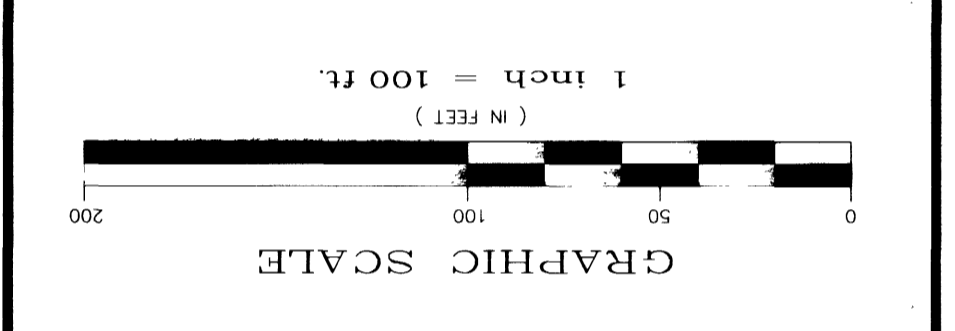

PHASE 5-B

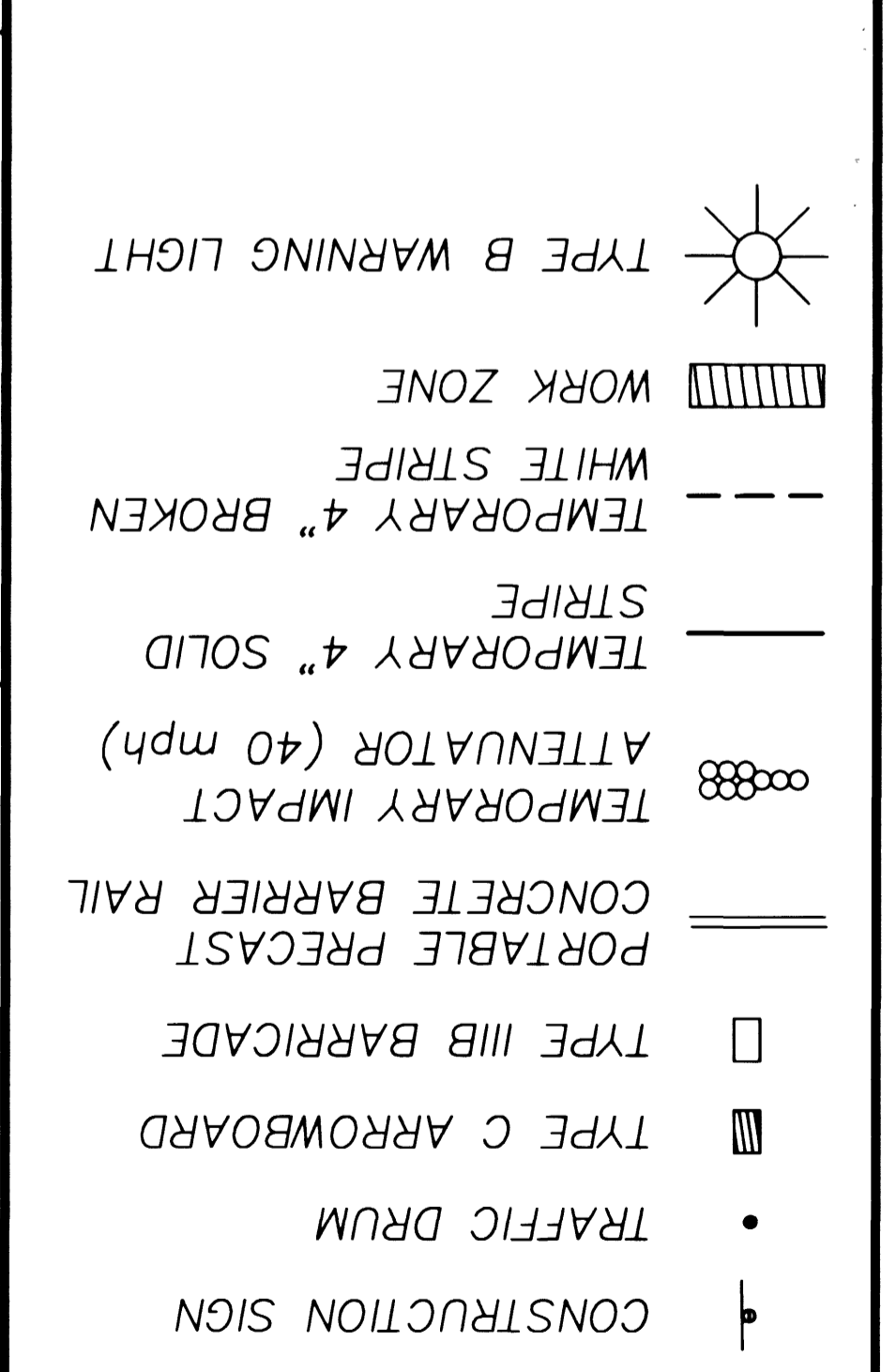
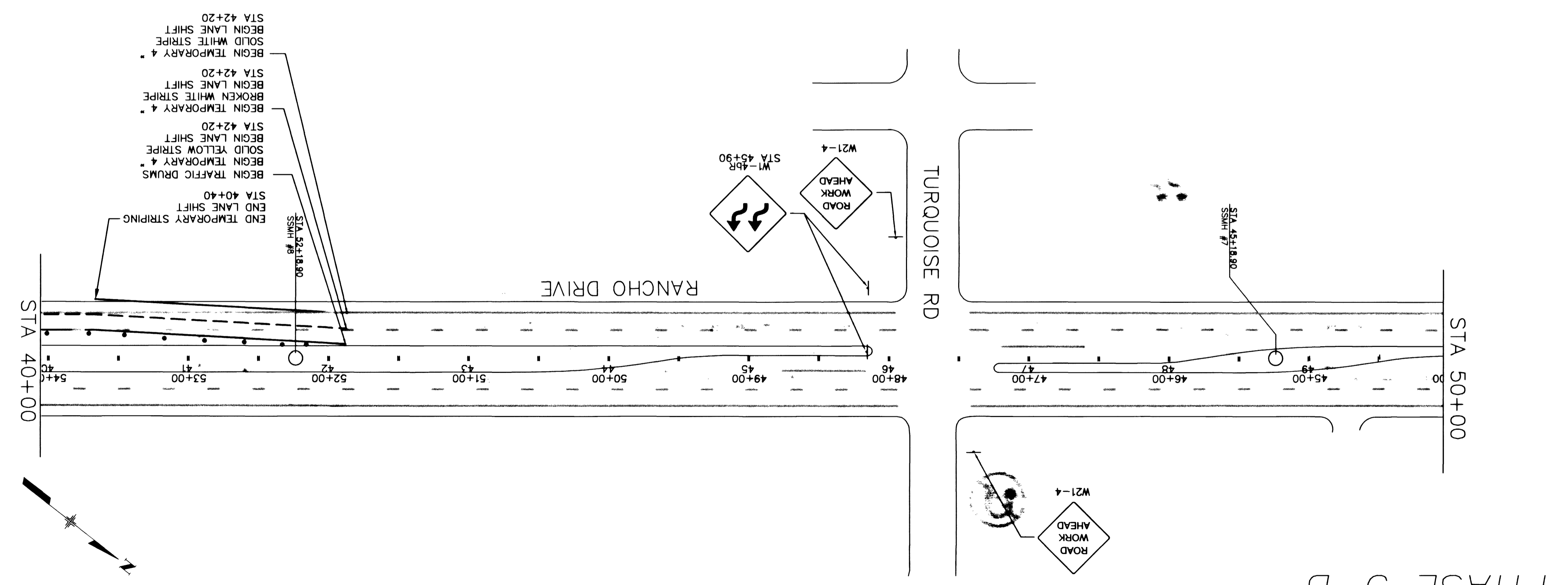

TC 26
 DRAWING NO. 307-V-799
 17

Department of Public Works
 U.S. 95 / RANCHO SEWER
 TRAFFIC CONTROL PLAN

US 95/RANCHO SEWER PHASE 5B
 DRAWN BY: J. HANNAK
 CHECKED BY: R. PLUMMER
 DATE: JULY 17, 2000

REVISIONS

NO.	DATE	DESCRIPTION	APPROVED

