

PHASE 3-B

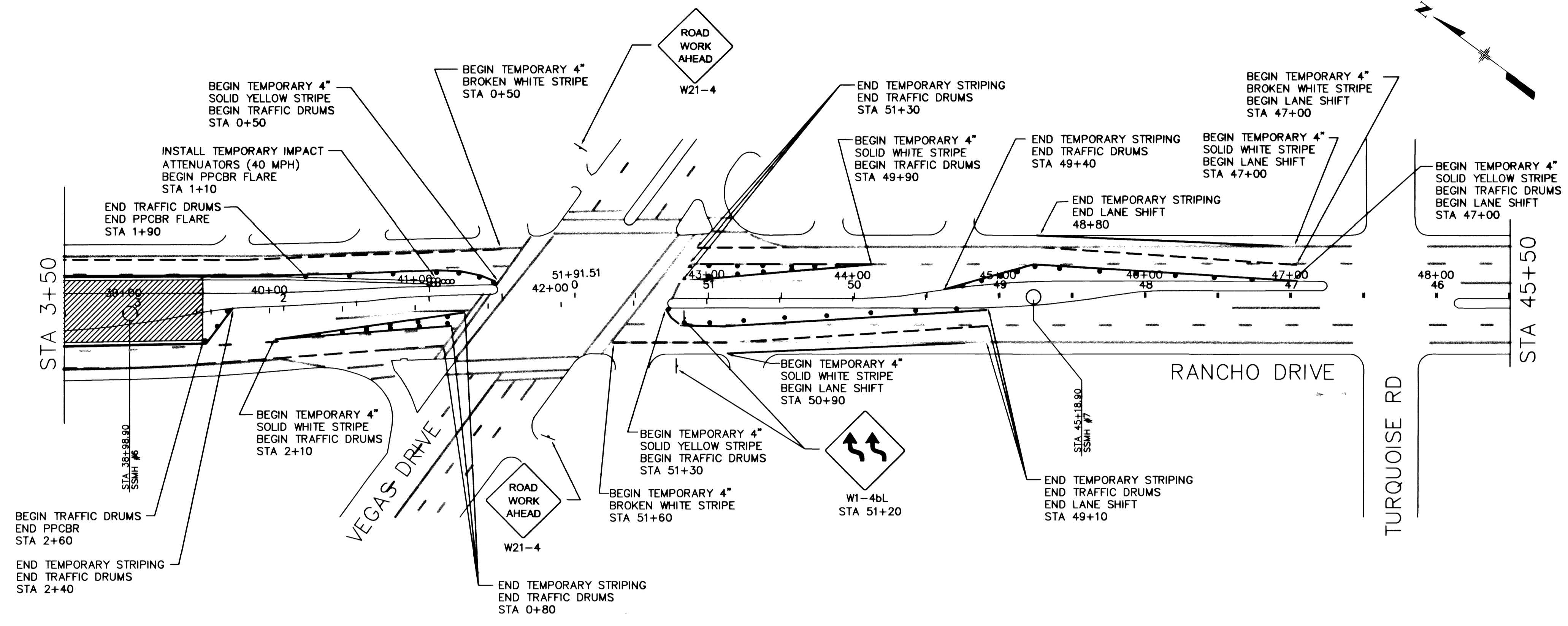

- LEGEND**
- CONSTRUCTION SIGN
 - TRAFFIC DRUM
 - TYPE C ARROWBOARD
 - TYPE III B BARRICADE
 - PORTABLE PRECAST CONCRETE BARRIER RAIL
 - TEMPORARY IMPACT ATTENUATOR (40 mph)
 - TEMPORARY 4" SOLID STRIPE
 - TEMPORARY 4" BROKEN WHITE STRIPE
 - WORK ZONE
 - TYPE B WARNING LIGHT

REVISIONS

NO.	DATE	DESCRIPTION	APPROVED

US 95/RANCHO SEWER PHASE 3-B
 DESIGNED BY: J. HANAK
 CHECKED BY: R. PLUMMER
 DATE: JULY 17, 2000
 DRAWING No. 307-V-799/16
 SHEET INDEX 16/55

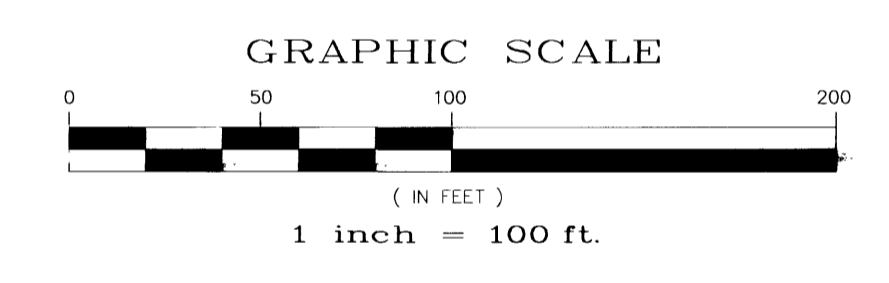

BASIS OF BEARING
 THE BASIS OF BEARING FOR THIS PROJECT IS GRID NORTH AS DEFINED BY THE NEVADA COORDINATE SYSTEM OF 1983 (NCS83), EAST ZONE, (2701), DETERMINED BY GIS CONTROL POINTS, "829" AND "PUPPIES", AS SHOWN ON A RECORD OF SURVEY ON FILE IN THE CLARK COUNTY RECORDER'S OFFICE, IN FILE 88 OF SURVEYS, AT PAGE 53.

BENCHMARK
 CLARK COUNTY BENCHMARK NO. 7C01 1965 - RIVET AND PLATE IN TOP OF CURB SOUTHEAST RETURN OF RANCHO DRIVE AND CORAN LANE.
 NAVD 1988 DATUM
 ELEVATION = 656.6065 METERS
 2154.22 FEET

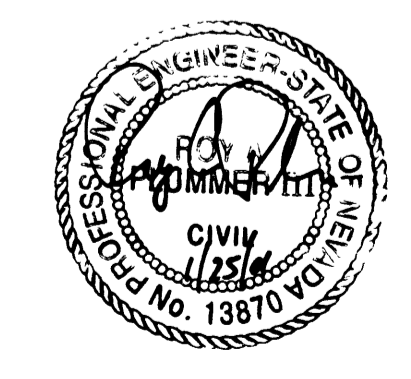
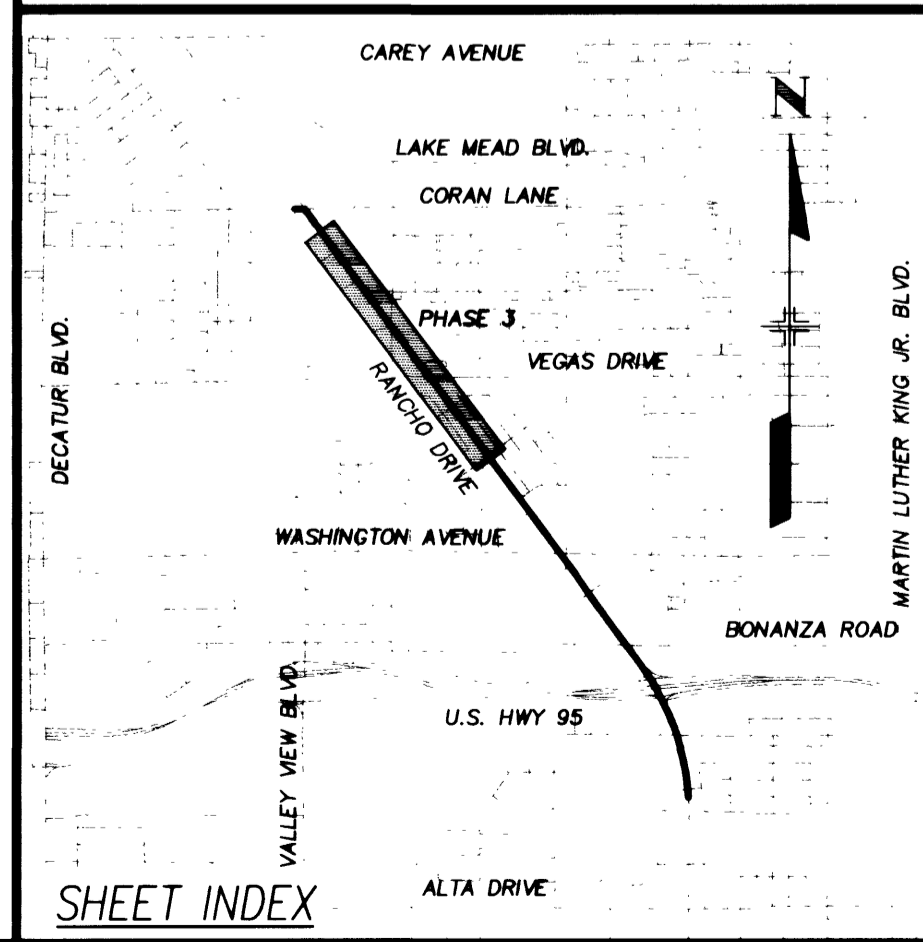
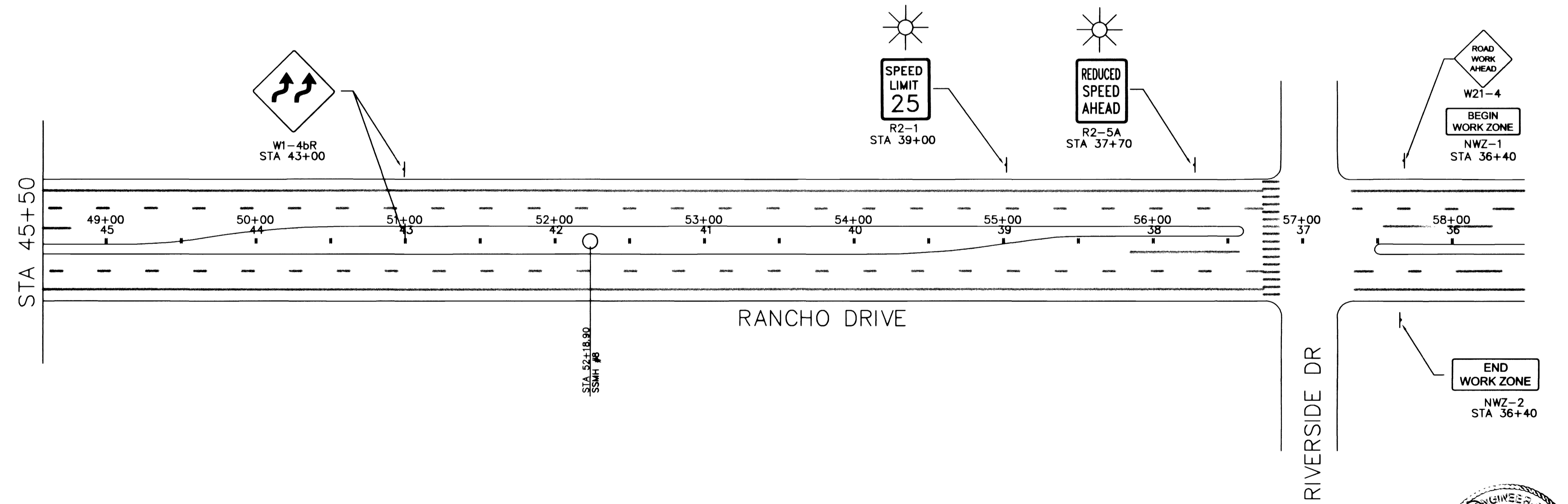

Department of Public Works
 U.S. 95 / RANCHO SEWER
 TRAFFIC CONTROL PLAN

CITY OF LAS VEGAS
 NEVADA
 307-V-799 / 16
 DRAWING No. 16
 TC 16

PHASE 3-B

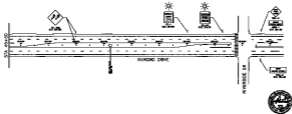
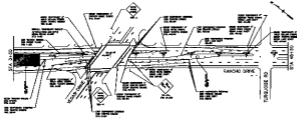

- LEGEND**
- ▲ CONSTRUCTION SIGN
 - TRAFFIC SIGN
 - TYPE 2 APPROVED
 - TYPE 10 SIGNAGE
 - PORTABLE CONCRETE CONDUIT BARRIER (PCB)
 - TEMPORARY PORTABLE APPROXIMATE (TAP) SIGN
 - TEMPORARY "A" SIGN (TAP)
 - TEMPORARY "B" SIGN (TAP)
 - ROAD ZONE
 - ☼ TYPE 2 WARNING LIGHT



AREA OF WORK
 THE AREA OF WORK IS INDICATED BY A SHADING AND A BOUNDARY LINE. THE BOUNDARY LINE IS A POLYLINE WHICH IS A LINE WITH VERTICES AT THE CORNERS OF THE AREA OF WORK.

REMARKS
 THIS PLAN IS A PRELIMINARY PLAN AND IS SUBJECT TO CHANGE WITHOUT NOTICE.



Department of Public Works
 U.S. 80 / SANDRO DRIVE
 TRAFFIC CONTROL PLAN

DATE: 10/15/2010
 TIME: 10:00 AM
 DRAWN BY: [Name]
 CHECKED BY: [Name]
 APPROVED BY: [Name]