

PHASE 3-B

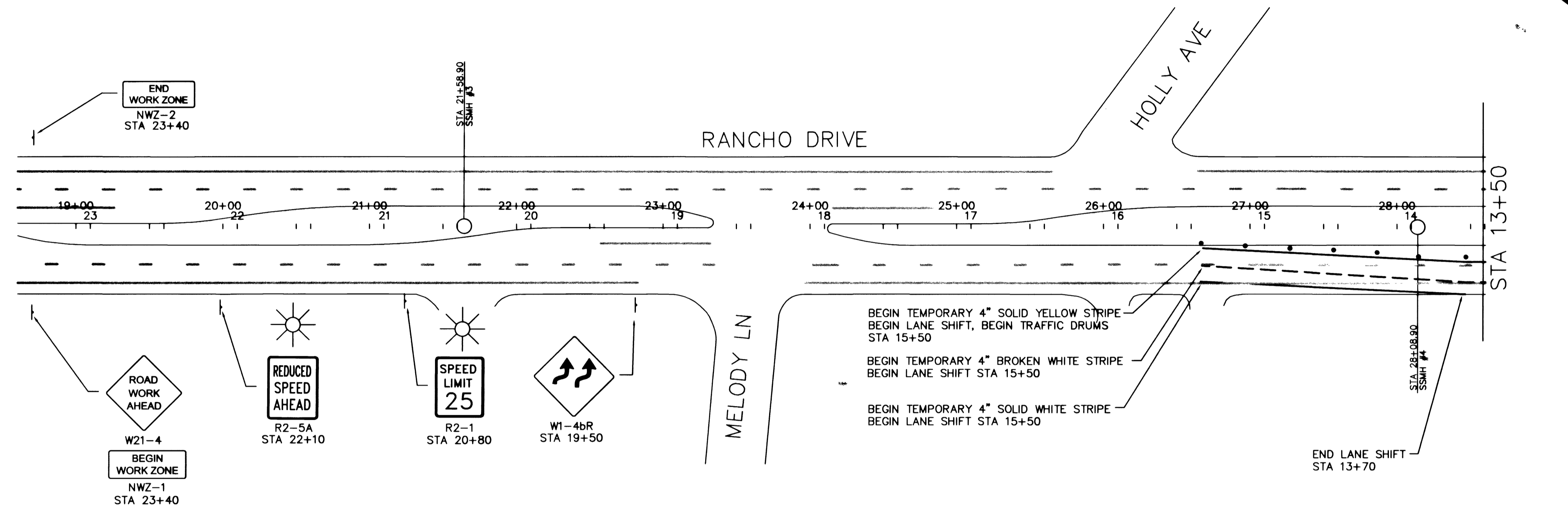

- LEGEND**
- ⊥ CONSTRUCTION SIGN
 - TRAFFIC DRUM
 - ▩ TYPE C ARROWBOARD
 - TYPE III B BARRICADE
 - PORTABLE PRECAST CONCRETE BARRIER RAIL
 - ⊙ TEMPORARY IMPACT ATTENUATOR (40 mph)
 - TEMPORARY 4" SOLID STRIPE
 - - - TEMPORARY 4" BROKEN WHITE STRIPE
 - ▨ WORK ZONE
 - ☀ TYPE B WARNING LIGHT

| REVISIONS | | NO. | DATE | DESCRIPTION | APPROVED |
|-----------|--|-----|------|-------------|----------|
| | | | | | |
| | | | | | |

US 95/RANCHO SEWER PHASE 3-B
 DESIGNED BY: J. HANAK
 CHECKED BY: R. PLUMMER
 DATE: JULY 17, 2000
 JOB NO: 510755

Department of Public Works
 U.S. 95 / RANCHO SEWER
 TRAFFIC CONTROL PLAN

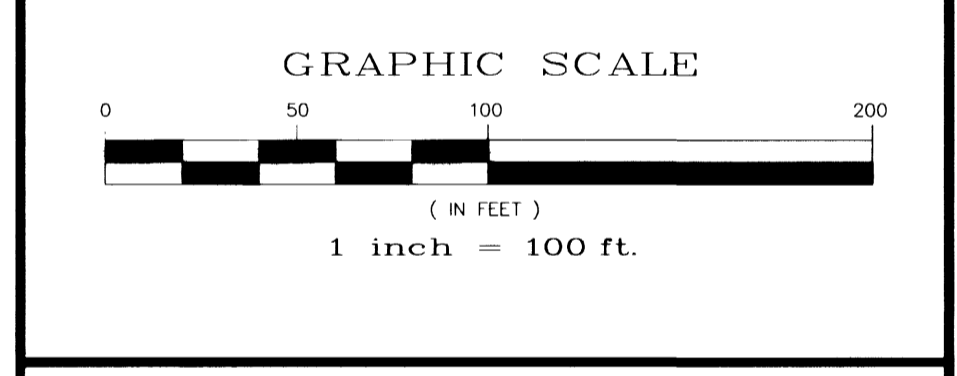

BASIS OF BEARING
 THE BASIS OF BEARING FOR THIS PROJECT IS GRID NORTH AS DEFINED BY THE NEVADA COORDINATE SYSTEM OF 1983 (NCS83), EAST ZONE, (2701), DETERMINED BY GIS CONTROL POINTS, "B25" AND "PUPPIES" AS SHOWN ON A RECORD OF SURVEY ON FILE IN THE CLARK COUNTY RECORDER'S OFFICE, IN FILE 88 OF SURVEYS, AT PAGE 53.

BENCHMARK
 CLARK COUNTY BENCHMARK NO. 7C01 1966 - RIVET AND PLATE IN TOP OF CURB SOUTHEAST RETURN OF RANCHO DRIVE AND CORAN LANE.
 NAVD 1988 DATUM
 ELEVATION = 656.6065 METERS
 2154.22 FEET

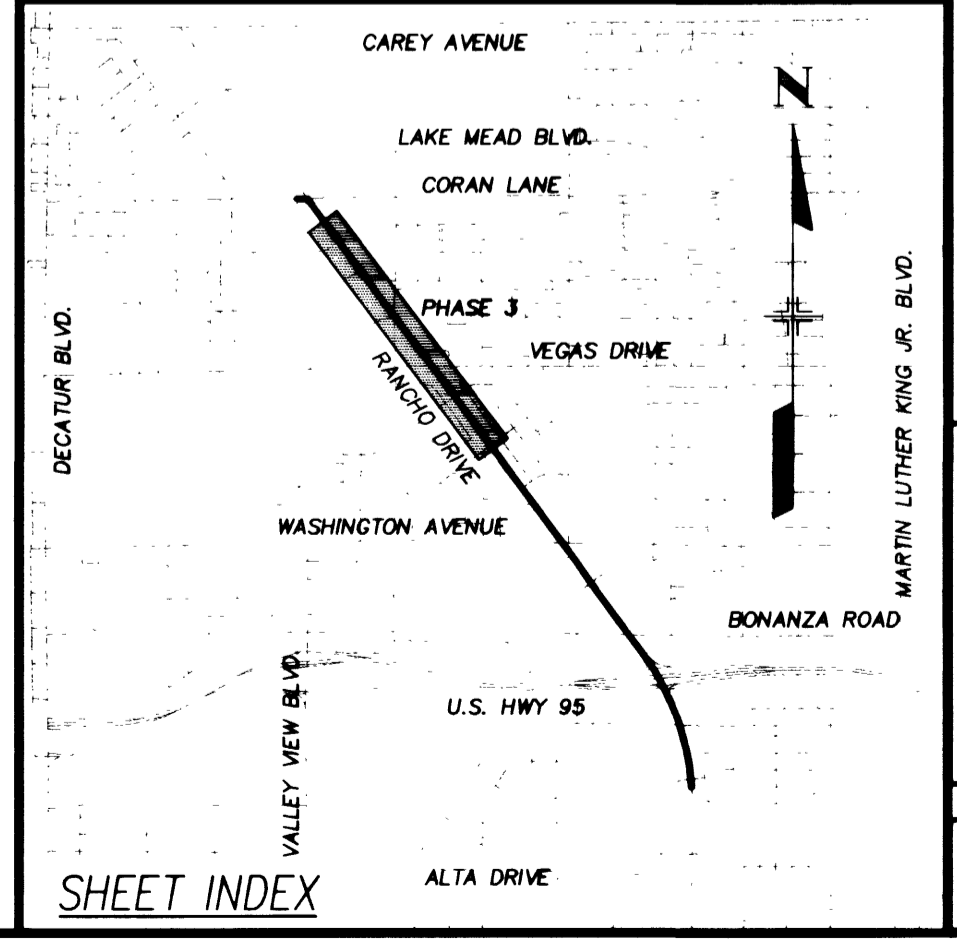
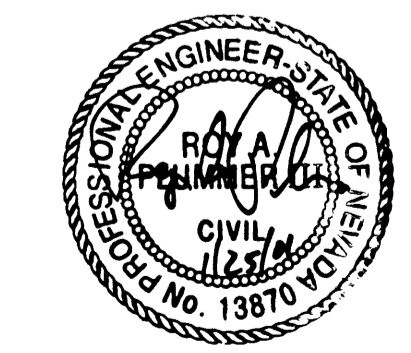
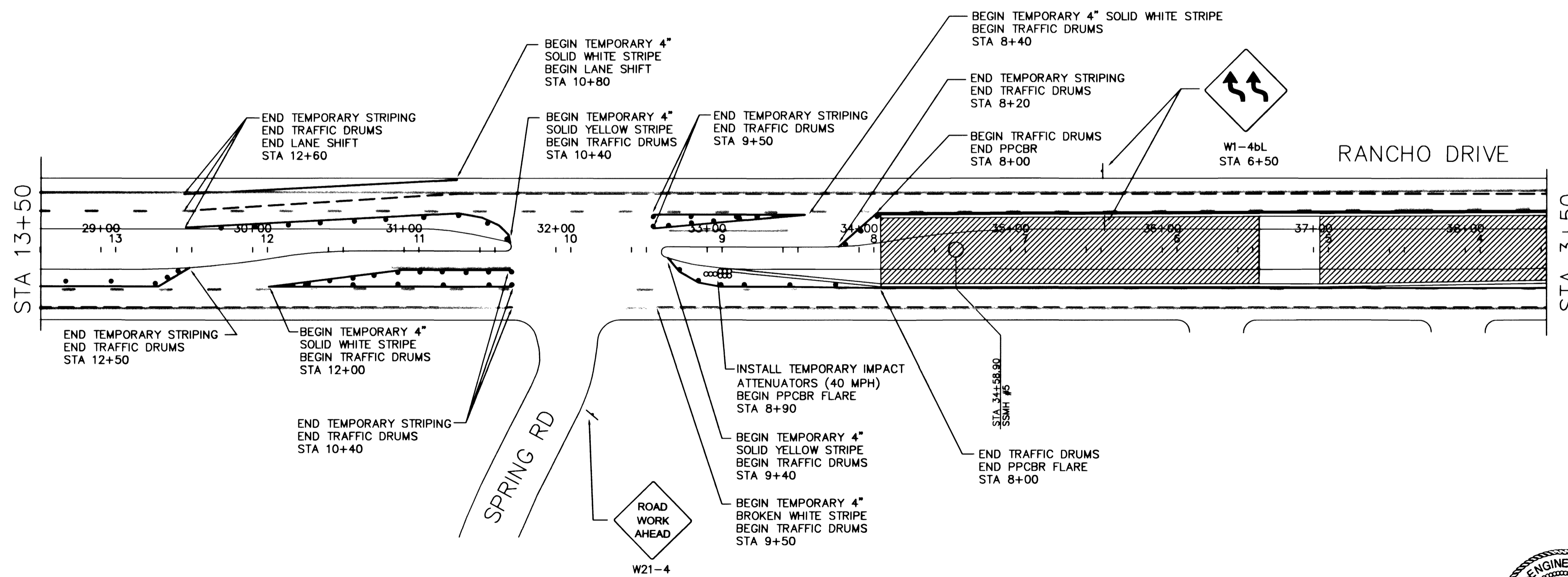

CITY OF LAS VEGAS
 307-V799
 DRAWING No. 15
 TC 15

PHASE 3-B

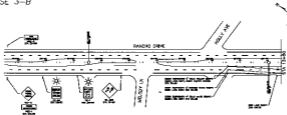

- LEGEND
- CONSTRUCTION SIGN
 - TRAFFIC SIGN
 - TYPE 5 APPROXIMATE
 - TYPE 4 APPROXIMATE
 - PORTABLE IMPACT ATTENUATOR (40 MPH)
 - PORTABLE IMPACT ATTENUATOR (20 MPH)
 - TEMPORARY 4' WIDE LANE
 - TEMPORARY 6' WIDE LANE
 - TEMPORARY 4' WORK ZONE
 - TEMPORARY 2' WORKING LANE

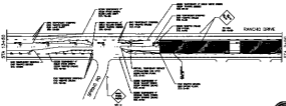

NOT TO SCALE
 THIS PLAN IS FOR INFORMATION ONLY AND IS NOT TO BE USED FOR CONSTRUCTION. THE CONTRACTOR SHALL BE RESPONSIBLE FOR VERIFYING THE ACCURACY OF ALL DIMENSIONS AND LOCATIONS. THE CONTRACTOR SHALL BE RESPONSIBLE FOR OBTAINING ALL NECESSARY PERMITS AND APPROVALS. THE CONTRACTOR SHALL BE RESPONSIBLE FOR OBTAINING ALL NECESSARY UTILITIES INFORMATION. THE CONTRACTOR SHALL BE RESPONSIBLE FOR OBTAINING ALL NECESSARY TRAFFIC CONTROL PLAN APPROVALS. THE CONTRACTOR SHALL BE RESPONSIBLE FOR OBTAINING ALL NECESSARY CONSTRUCTION SIGN APPROVALS. THE CONTRACTOR SHALL BE RESPONSIBLE FOR OBTAINING ALL NECESSARY TRAFFIC SIGN APPROVALS. THE CONTRACTOR SHALL BE RESPONSIBLE FOR OBTAINING ALL NECESSARY IMPACT ATTENUATOR APPROVALS. THE CONTRACTOR SHALL BE RESPONSIBLE FOR OBTAINING ALL NECESSARY LANE AND WORK ZONE APPROVALS. THE CONTRACTOR SHALL BE RESPONSIBLE FOR OBTAINING ALL NECESSARY WORKING LANE APPROVALS.



Department of Public Works
 U.S. DE. / SANDOZ DRIVE
 TRAFFIC CONTROL PLAN

DATE: 10/15/2010
 DRAWN BY: [Name]
 CHECKED BY: [Name]
 APPROVED BY: [Name]