

PHASE 2-B

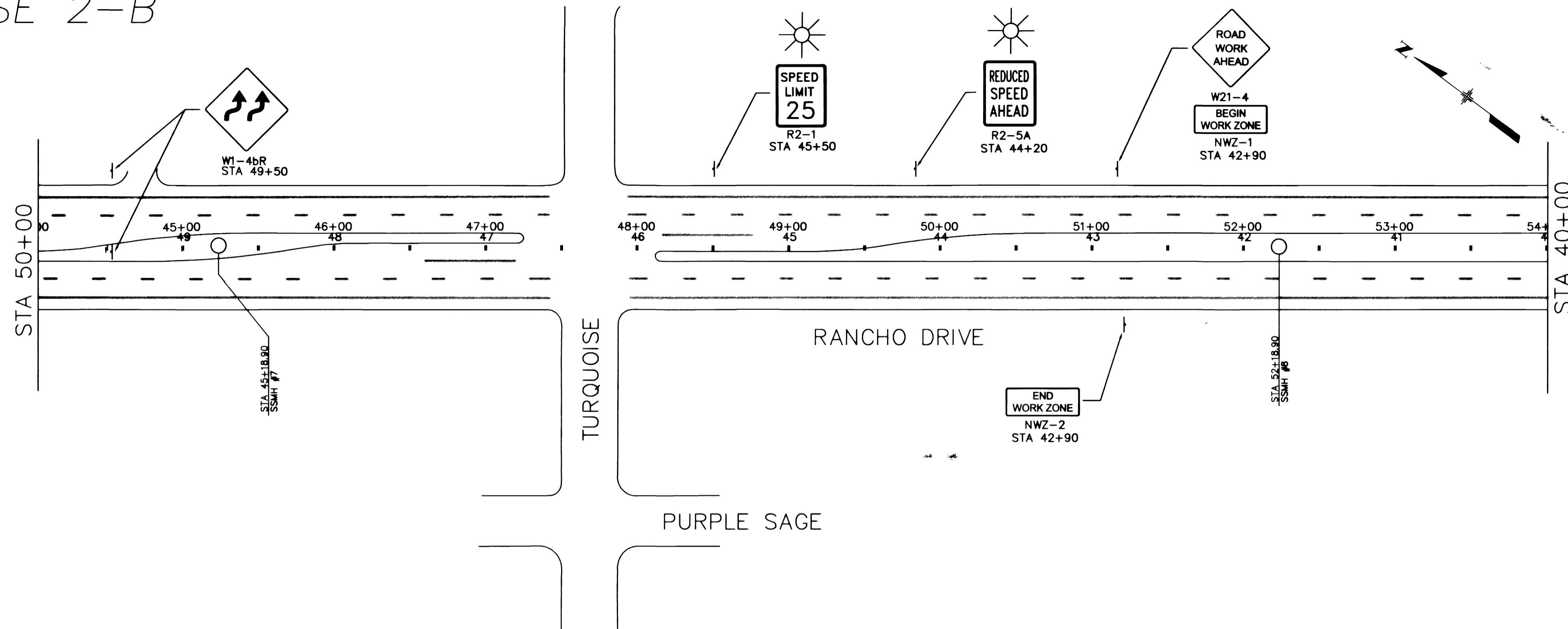

- CONSTRUCTION SIGN
- TRAFFIC DRUM
- TYPE C ARROWBOARD
- TYPE III B BARRICADE
- PORTABLE PRECAST CONCRETE BARRIER RAIL
- TEMPORARY IMPACT ATTENUATOR (40 mph)
- TEMPORARY 4" SOLID STRIPE
- TEMPORARY 4" BROKEN WHITE STRIPE
- WORK ZONE
- TYPE B WARNING LIGHT

REVISIONS	
NO.	DESCRIPTION

US 95/RANCHO SEWER PHASE IB
 DRAWN BY: J. HANAK
 DESIGNED BY: J. REAM
 CHECKED BY: R. PLUMMER
 DATE: JULY 17, 2000
 JOB NO: 30735
 PROJECT: U.S. 95 / RANCHO SEWER TRAFFIC CONTROL PLAN
 DRAWING NO. 12
 SHEET 39/77
 APPROVED: [Signature]

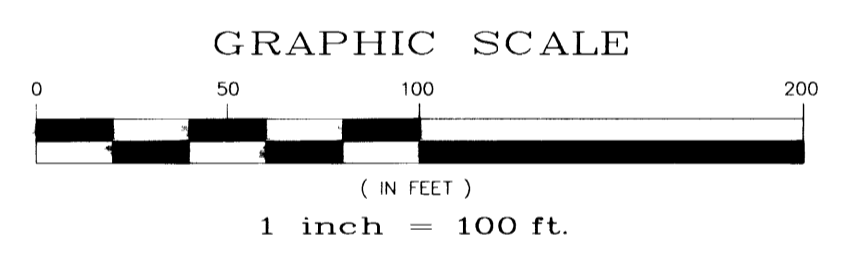

BASIS OF BEARING
 THE BASIS OF BEARING FOR THIS PROJECT IS GRID NORTH AS DEFINED BY THE NEVADA COORDINATE SYSTEM OF 1983 (NCS83), EAST ZONE, (2701), DETERMINED BY GIS CONTROL POINTS, "B25" AND "PUPPIES" AS SHOWN ON A RECORD OF SURVEY ON FILE IN THE CLARK COUNTY RECORDER'S OFFICE, IN FILE 88 OF SURVEYS, AT PAGE 53.

BENCHMARK
 CLARK COUNTY BENCHMARK NO. 7C01 1966 - RIVET AND PLATE IN TOP OF CURB SOUTHEAST RETURN OF RANCHO DRIVE AND CORAN LANE.
 NAVD 1988 DATUM
 ELEVATION = 656.6065 METERS
 2154.22 FEET

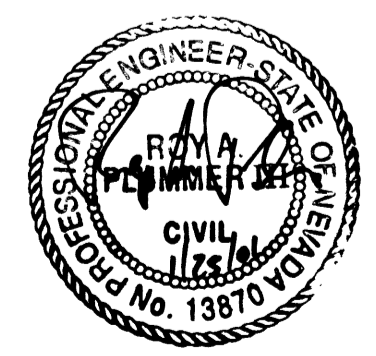
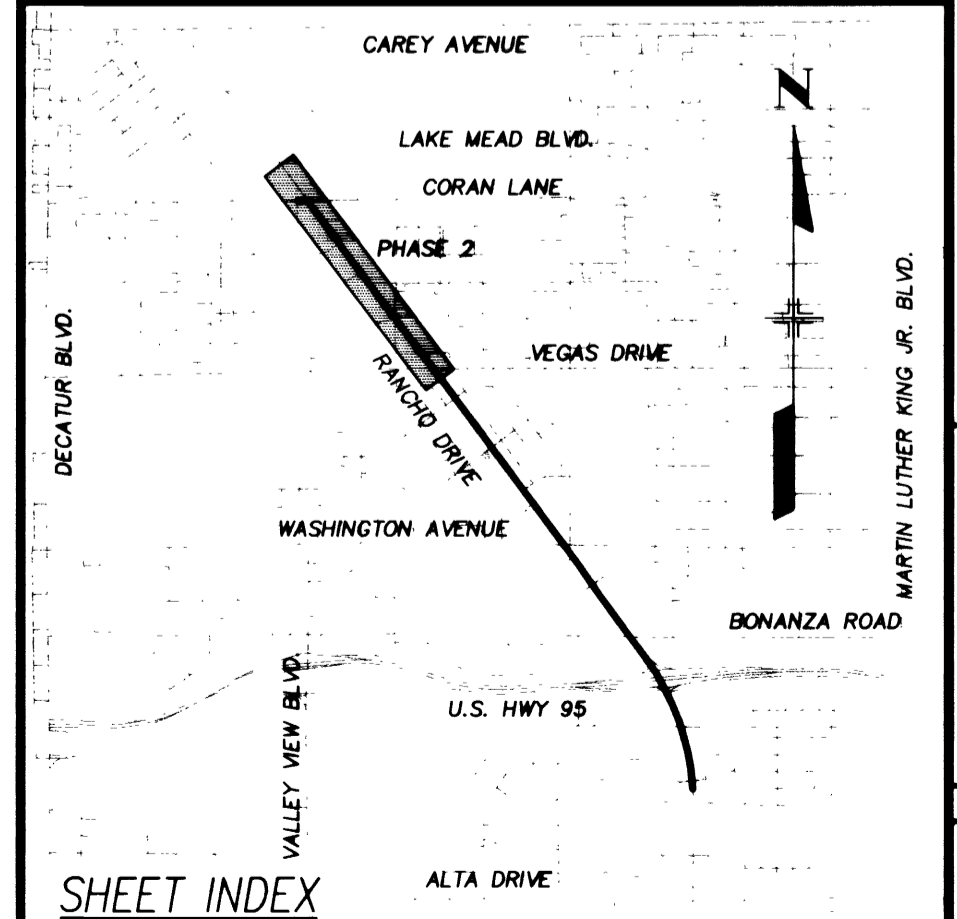

Department of Public Works
 U.S. 95 / RANCHO SEWER
 TRAFFIC CONTROL PLAN

CITY OF LAS VEGAS
 NEVADA
 DRAWING No. 12
 SHEET 39/77
 TC 12

PHASE 2-B



- LEGEND**
- ▲ CONSTRUCTION SIGN
 - ▲ ROAD WORK
 - ROAD WORK AHEAD
 - ROAD WORK
 - PAVED IMPACT SURFACE BARREL ROW
 - TEMPORARY IMPACT ATTENUATOR (50 MPH)
 - TEMPORARY 1" SLOPE CURB
 - TEMPORARY 1" SLOPE SIDE CURB
 - ROAD WORK
 - ★ ROAD WORK LIGHT



DATE OF WORK:
 11/15/2011
 11/16/2011
 11/17/2011
 11/18/2011
 11/19/2011
 11/20/2011
 11/21/2011
 11/22/2011
 11/23/2011
 11/24/2011
 11/25/2011
 11/26/2011
 11/27/2011
 11/28/2011
 11/29/2011
 11/30/2011
 12/01/2011
 12/02/2011
 12/03/2011
 12/04/2011
 12/05/2011
 12/06/2011
 12/07/2011
 12/08/2011
 12/09/2011
 12/10/2011
 12/11/2011
 12/12/2011
 12/13/2011
 12/14/2011
 12/15/2011
 12/16/2011
 12/17/2011
 12/18/2011
 12/19/2011
 12/20/2011
 12/21/2011
 12/22/2011
 12/23/2011
 12/24/2011
 12/25/2011
 12/26/2011
 12/27/2011
 12/28/2011
 12/29/2011
 12/30/2011
 12/31/2011



DIVISIONS

Department of Public Works

U.S. DE. OF TRANSPORTATION
 FEDERAL AID DISTRICT OFFICE

10 11 12