

PHASE 2-B

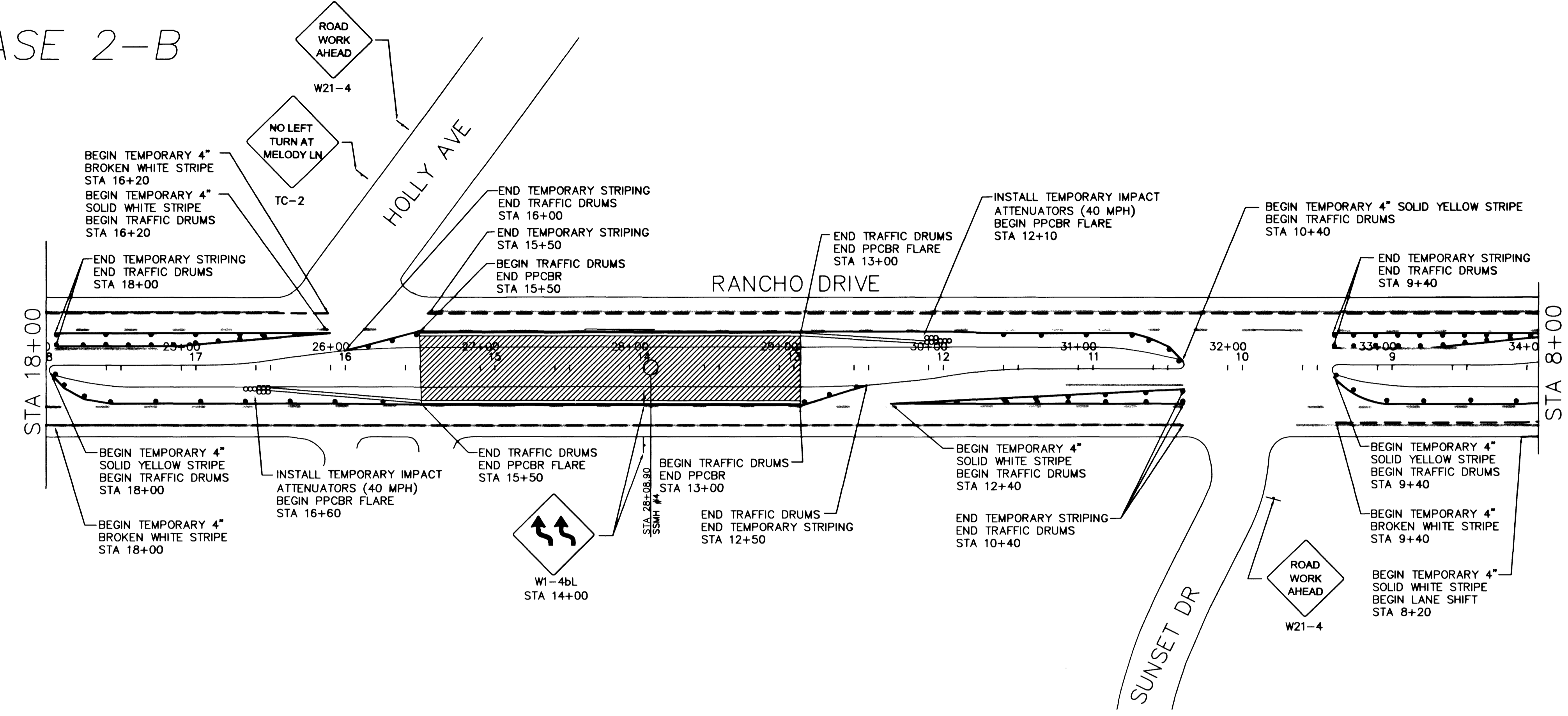

- LEGEND**
- CONSTRUCTION SIGN
  - TRAFFIC DRUM
  - TYPE C ARROWBOARD
  - TYPE III B BARRICADE
  - PORTABLE PRECAST CONCRETE BARRIER RAIL
  - TEMPORARY IMPACT ATTENUATOR (40 mph)
  - TEMPORARY 4" SOLID STRIPE
  - TEMPORARY 4" BROKEN WHITE STRIPE
  - WORK ZONE
  - TYPE B WARNING LIGHT

REVISIONS		US 95/RANCHO SEWER PHASE 1B	
NO.	DATE	DESCRIPTION	APPROVED

DESIGNED BY: J. HANAK  
 CHECKED BY: R. PLUMMER  
 DATE: JULY 17, 2000  
 DRAWING NO: 307-799  
 SHEET NO: 11  
 PROJECT: U.S. 95 / RANCHO SEWER TRAFFIC CONTROL PLAN

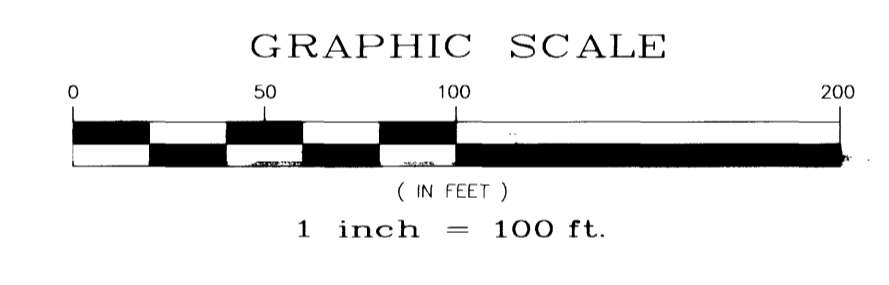

**BASIS OF BEARING**  
 THE BASIS OF BEARING FOR THIS PROJECT IS GRID NORTH AS DEFINED BY THE NEVADA COORDINATE SYSTEM OF 1983 (NCS83), EAST ZONE, (2701), DETERMINED BY GIS CONTROL POINTS, "825" AND "PUPPIES" AS SHOWN ON A RECORD OF SURVEY ON FILE IN THE CLARK COUNTY RECORDER'S OFFICE, IN FILE 88 OF SURVEYS, AT PAGE 53.

**BENCHMARK**  
 CLARK COUNTY BENCHMARK NO. 7C01 19E6 - RIVET AND PLATE IN TOP OF CURB SOUTHEAST RETURN OF RANCHO DRIVE AND CORAN LANE.  
 NAVD 1988 DATUM  
 ELEVATION = 656.6065 METERS  
 2154.22 FEET

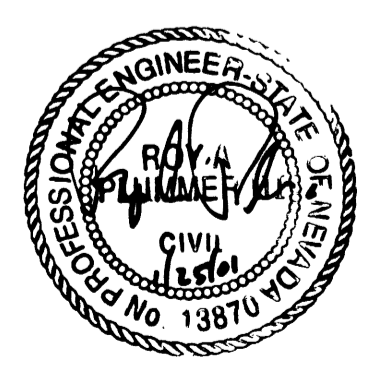
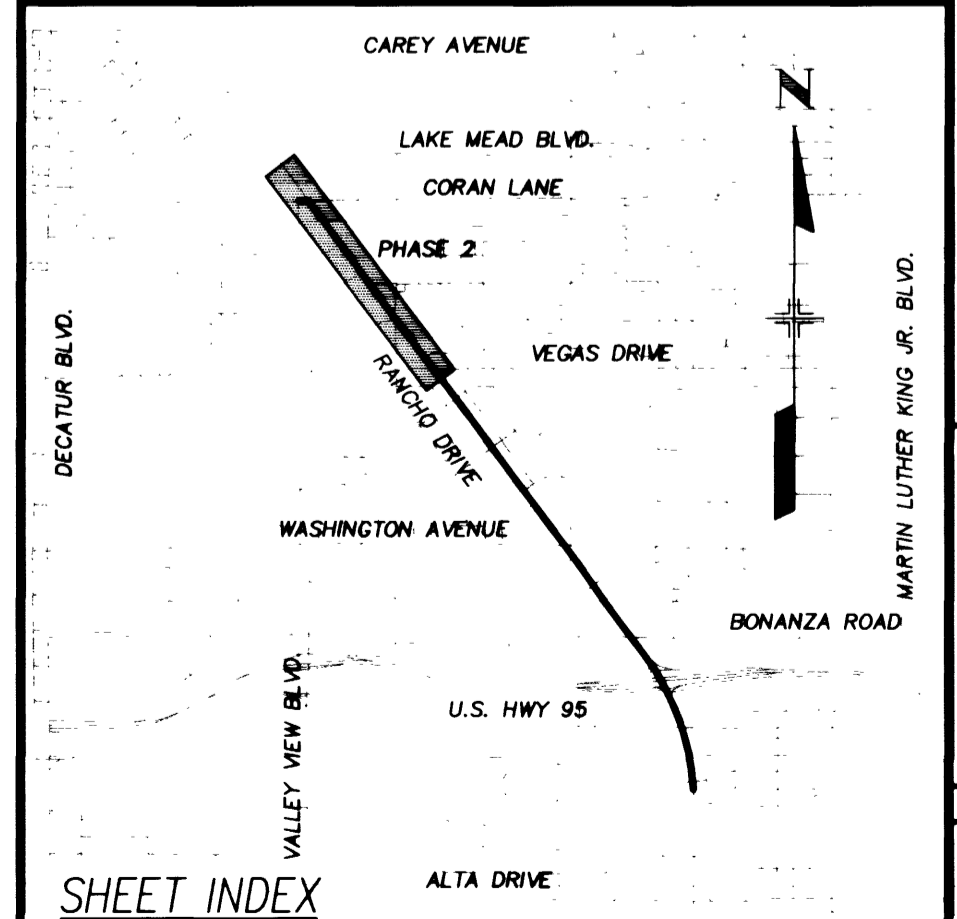
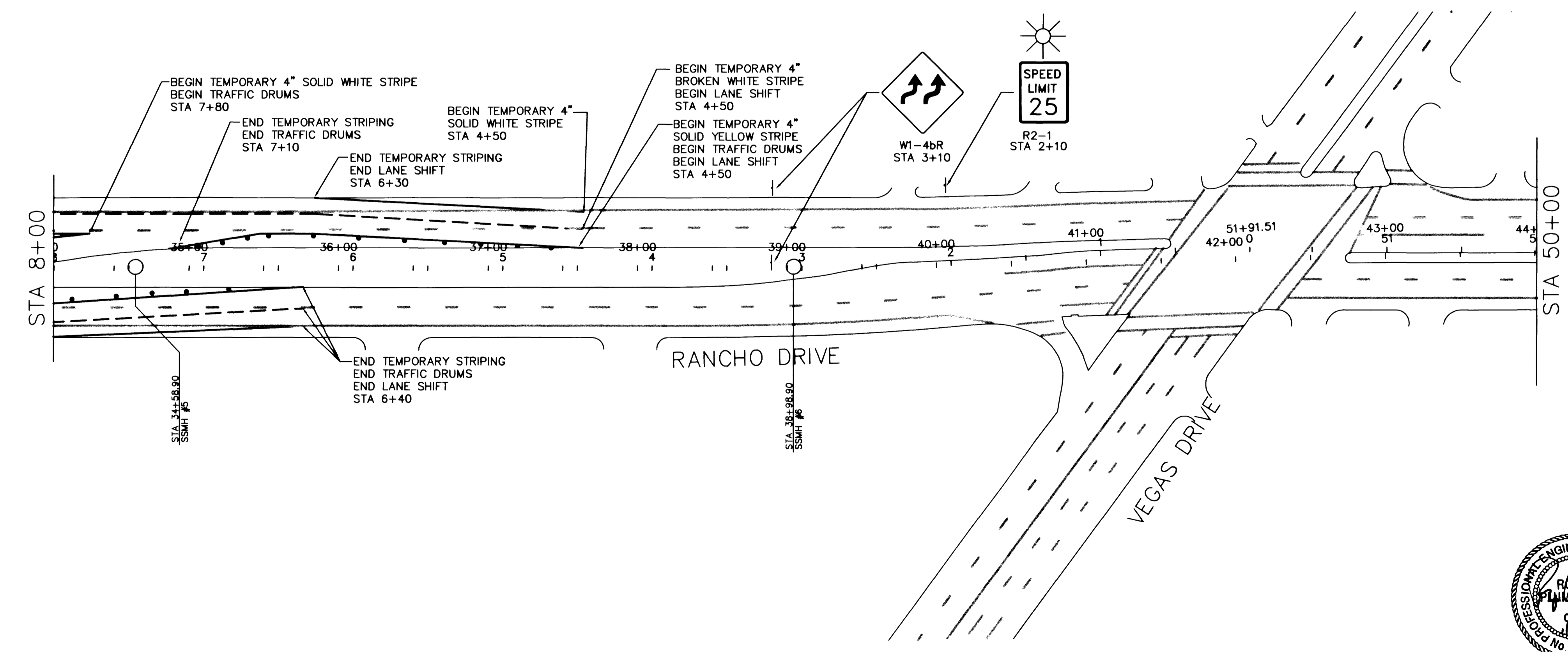

Department of Public Works  
 U.S. 95 / RANCHO SEWER TRAFFIC CONTROL PLAN

307-799 33/77  
 DRAWING No. 11  
 SHEET INDEX TC 11 55

