

Call before you dig  
1-800-227-2800

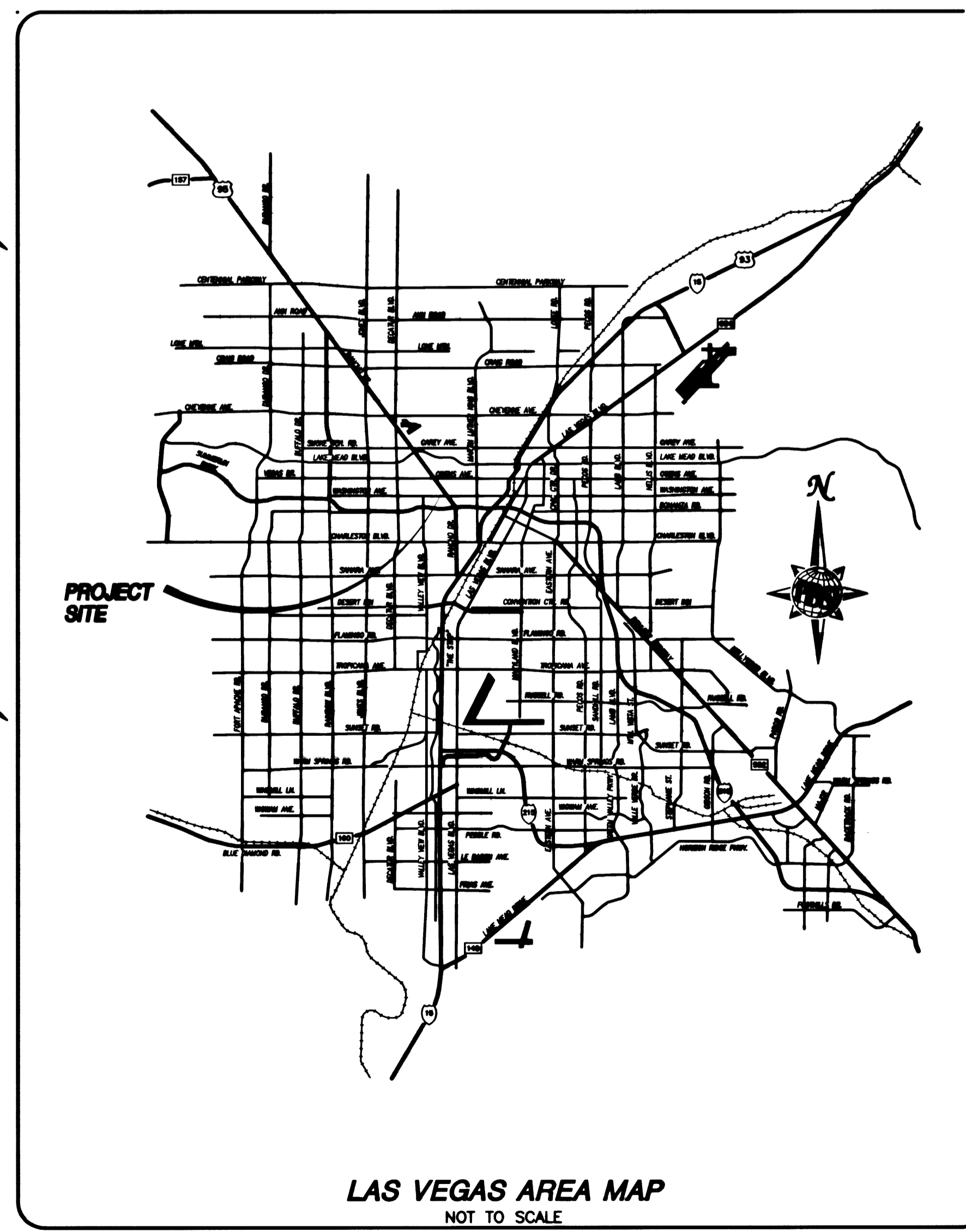
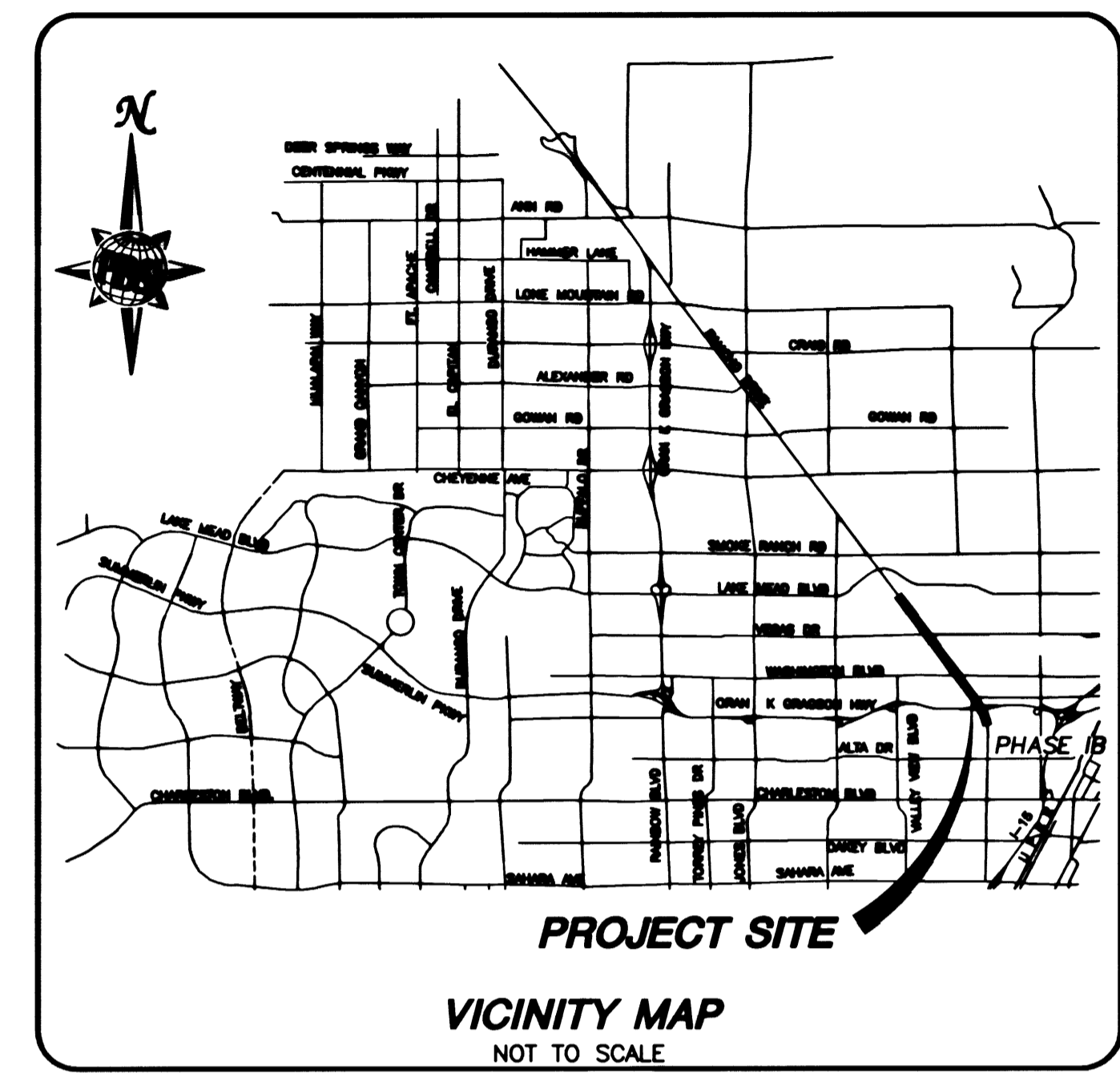
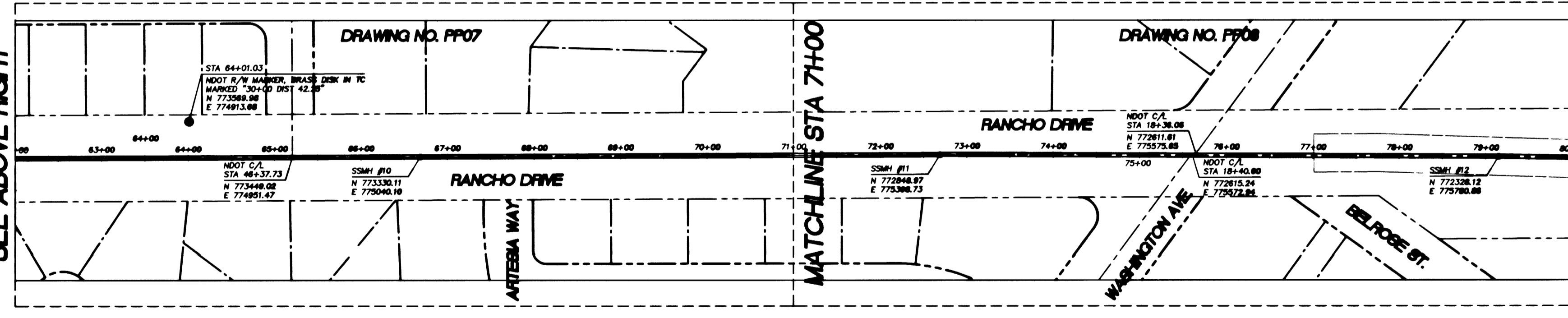
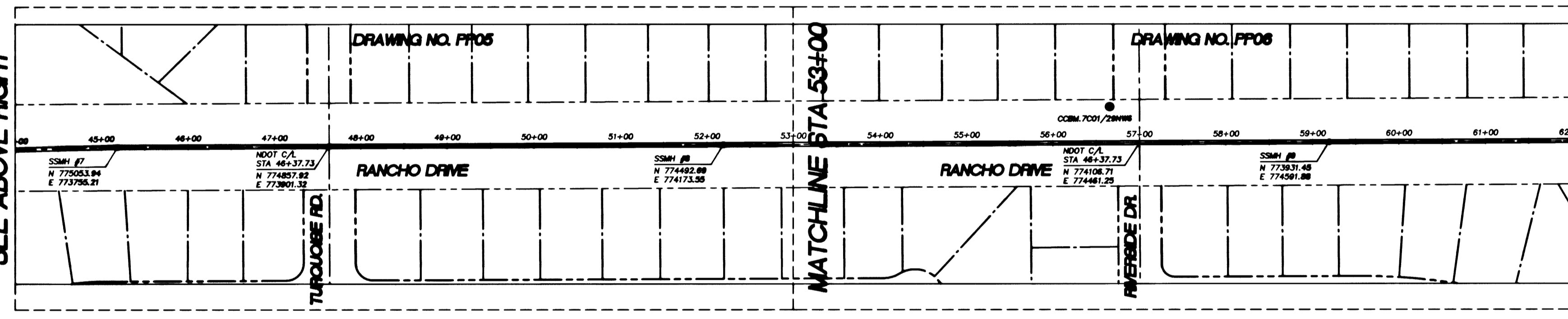
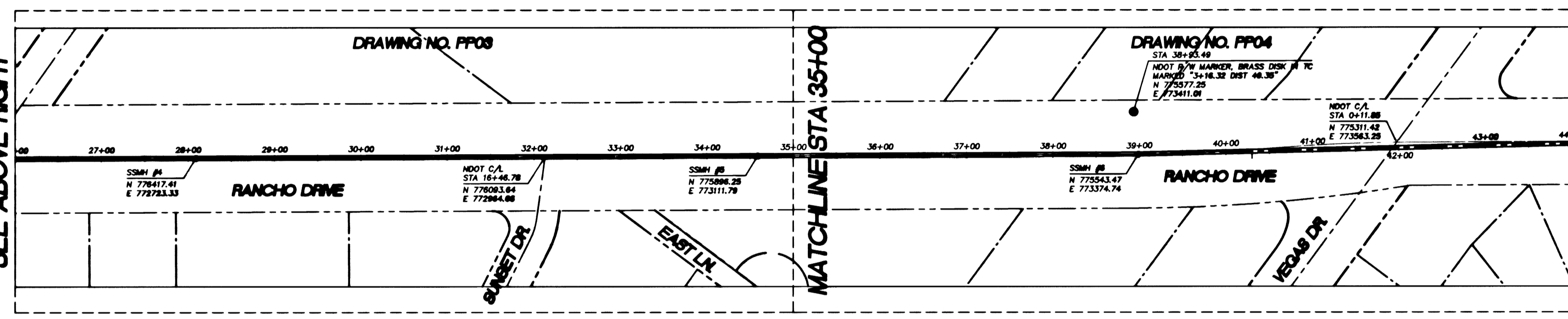
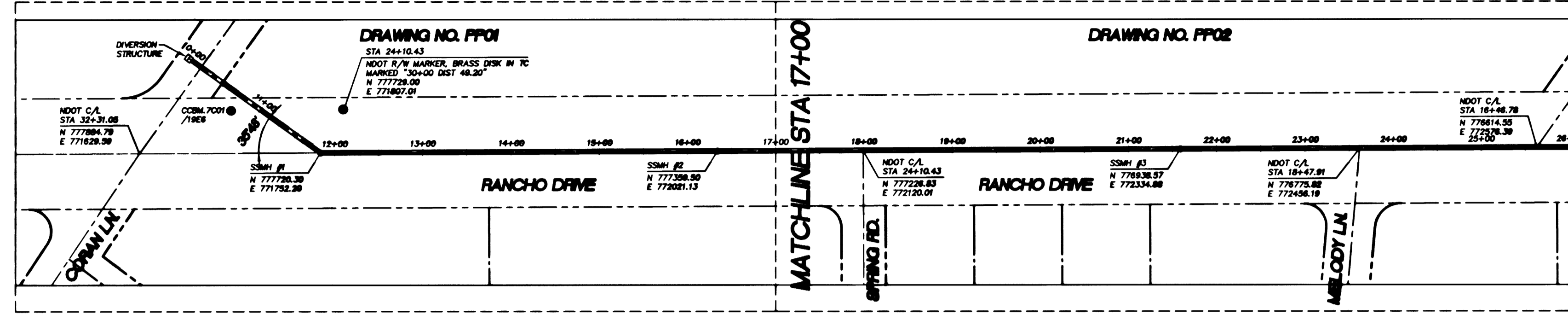
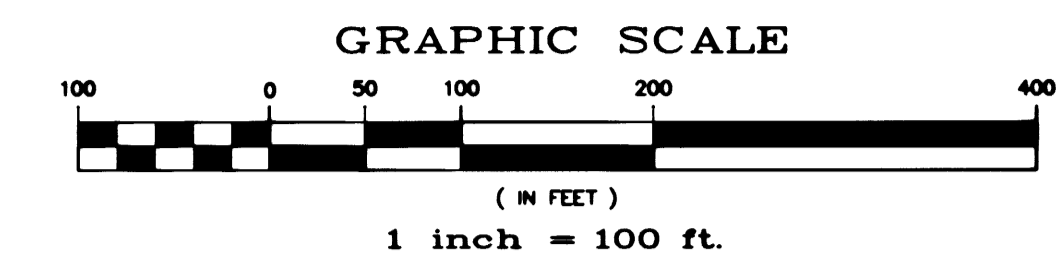

REVISIONS

NO.	DATE	DESCRIPTION

US 95/RANCHO SEWER PHASE IB  
 DATE: 8/9/99  
 DRAWN BY: J. JOHNSON  
 CHECKED BY: P. THORNTON  
 DESIGNED BY: B. MEYER  
 51755

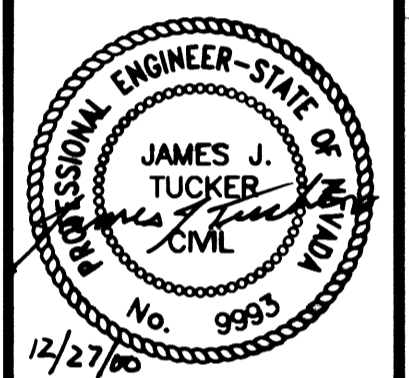

Department of Public Works  
 US 95/RANCHO SEWER PHASE IB  
 SURVEY CONTROL, VICINITY MAP,  
 AND AREA MAP



DRAWING No. 3  
 G3  
 PLAN# 307-V799

MANHOLE #	SHT #	NORTHING	EASTING	MH DIAMETER	PIPE DIAMETER	BEARING	ANGLE	DISTANCE
DIVERSION STRUCTURE	PP01	777904.20	771749.30	N/A	42" THRU	N00°54'08"W	89°	183.90
SSMH #1	PP1	777720.30	771752.20	72"	42" THRU	N36°41'59"W	35°48'00"	450.00
SSMH #2	PP1	777359.50	772021.13	72"	42" THRU	N36°41'59"W	0°0'0"	525.00
SSMH #3	PP2	776938.57	772334.88	72"	42" THRU	N36°41'59"W	0°0'0"	650.00
SSMH #4	PP3	776417.41	772723.33	72"	42" THRU	N36°41'59"W	0°0'0"	650.00
SSMH #5	PP3	775896.25	773111.79	72"	42" THRU	N36°41'59"W	0°0'0"	440.00
SSMH #6	PP4	775543.47	773374.74	72"	42" THRU	N37°51'18"W	0°9'19"	620.00
SSMH #7	PP5	775053.94	773755.21	72"	42" THRU	N36°41'59"W	0°0'0"	700.00
SSMH #8	PP5	774492.69	774173.55	72"	42" THRU	N36°41'59"W	0°0'0"	700.00
SSMH #9	PP6	773931.45	774591.88	72"	42" THRU	N36°41'59"W	0°0'0"	750.00
SSMH #10	PP7	773370.20	775010.22	72"	42" THRU	N36°41'59"W	0°0'0"	600.10
SSMH #11	PP8	772808.96	775428.55	84"	42" IN/60" OUT	N36°13'48"W	0°28'11"	646.00
SSMH #12	PP8	772328.12	775780.86	84"	60" THRU	N35°21'38"W	0°52'10"	685.00

MANHOLE TABLE

**BASIS OF BEARING**  
 THE BASIS OF BEARING FOR THIS PROJECT IS GRID NORTH AS DEFINED BY THE NEVADA COORDINATE SYSTEM OF 1983 (NCS83), EAST ZONE, (2701), DETERMINED BY GIS CONTROL POINTS, "825" AND "PUPPIES" AS SHOWN ON A RECORD OF SURVEY ON FILE IN THE CLARK COUNTY RECORDER'S OFFICE, IN FILE 88 OF SURVEYS, AT PAGE 53.

**BENCHMARK**  
 CLARK COUNTY BENCHMARK NO. 7001 1966 - RIVET AND PLATE IN TOP OF CURB SOUTHEAST RETURN OF RANCHO DRIVE AND CORAN LANE.  
 NAVD 1988 DATUM  
 ELEVATION = 656.6065 METERS  
 2154.22 FEET

**NOTE**  
 CONTRACTOR TO VERIFY SURVEY CONTROL PRIOR TO CONSTRUCTION

30499

