

CONSTRUCTION NOTES

- ① CONTRACTOR SHALL MAINTAIN THE EXISTING FLASHER SIGNAL CONDUIT AND CONDUCTOR RUNS OR INSTALL TEMPORARY OVERHEAD CABLE FOR THE OPERATION OF THE FLASHER SIGNAL. IN EITHER CASE THE FLASHER SIGNAL SHALL BE OPERATIONAL AT ALL TIMES.
- ② CONTRACTOR SHALL MAINTAIN AND/OR RESTORE THE FLASHER SIGNAL CONDUIT AND CABLE. DURING CONSTRUCTION. IF THE CONTRACTOR DAMAGES AND/OR REMOVES CONDUIT AND CONDUCTORS DURING CONSTRUCTION, THE CONDUIT WILL BE REPLACED AND CONDUCTORS WILL BE INSTALLED WITHOUT SPLICING BETWEEN THE POLES AND THE CONTROLLER.
- ③ CONTRACTOR IS RESPONSIBLE FOR ANY DAMAGE TO INTER CONNECT CABLE PER TRAFFIC SIGNAL GENERAL NOTES. IN THE CASE OF DAMAGE TO TRAFFIC SIGNAL INTER CONNECT CABLE, CONTRACTOR SHALL INSTALL NEW 22 PAIR INTERCONNECT CABLE FROM THE LAS VEGAS BOULEVARD/WASHINGTON AVENUE. INTERSECTION SIGNAL CONTROLLER TO THE MAIN STREET/WASHINGTON AVENUE INTERSECTION SIGNAL CONTROLLER WITH IN EXISTING CONDUIT.

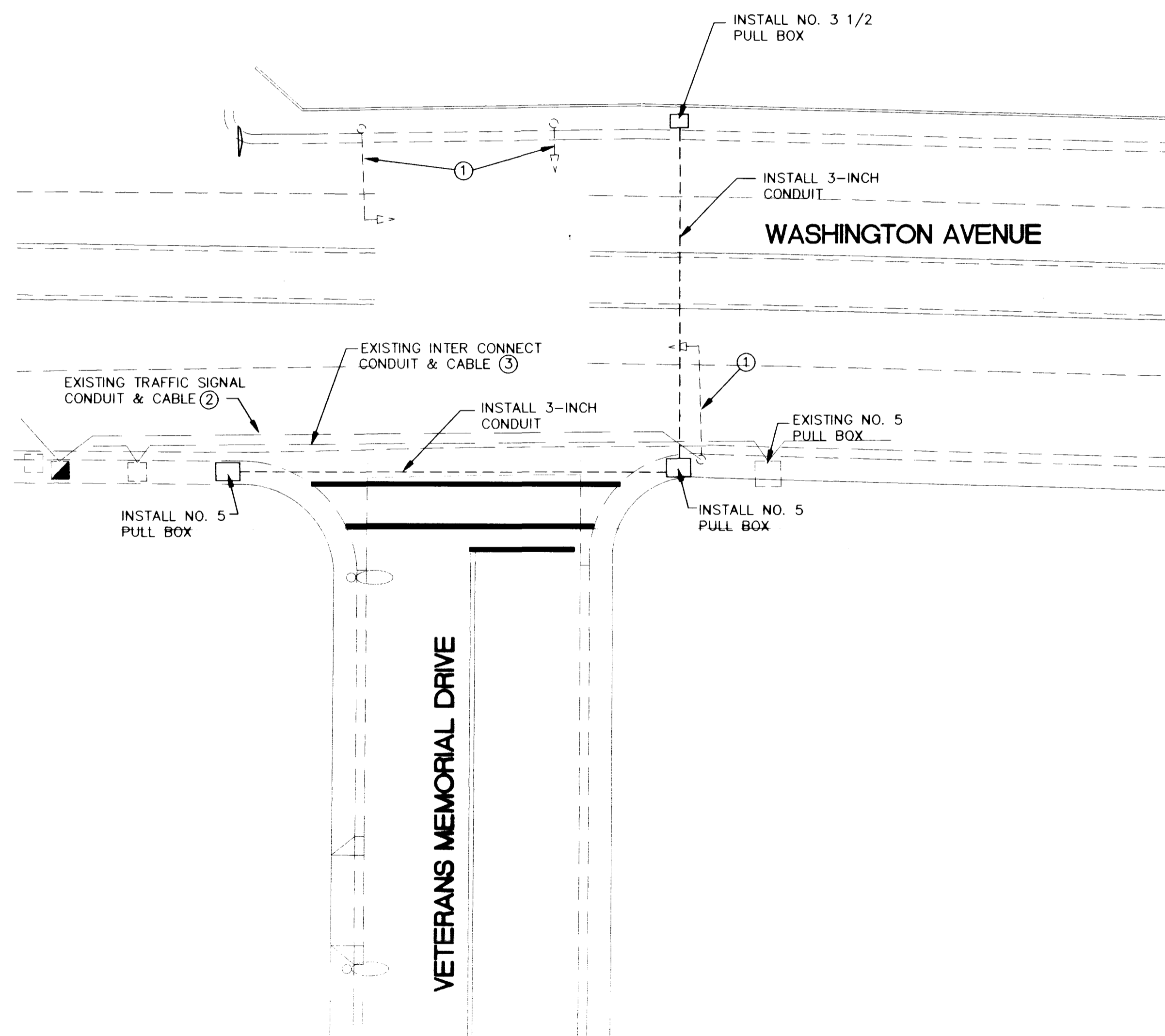

VETERANS MEMORIAL DRIVE AND WASHINGTON AVENUE

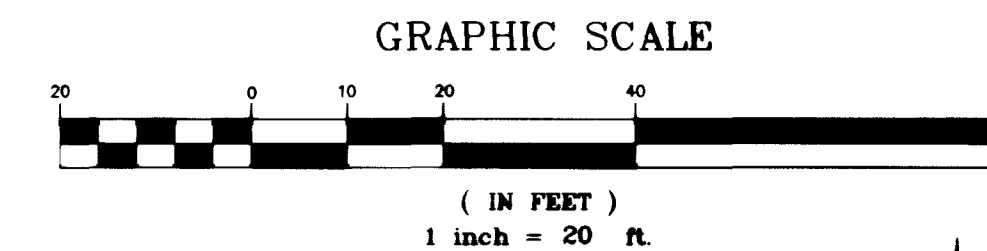

CONSTRUCTION NOTES

- ① CONTRACTOR SHALL MAINTAIN THE EXISTING CONDUIT AND CONDUCTOR RUNS OR INSTALL TEMPORARY OVERHEAD CABLE FOR THE OPERATION OF THE TRAFFIC SIGNAL. IN EITHER CASE, THE TRAFFIC SIGNAL SHALL REMAIN OPERATIONAL AT ALL TIMES.
- ② CONTRACTOR SHALL MAINTAIN AND/OR RESTORE THE TRAFFIC SIGNAL CONDUIT AND CABLE. DURING CONSTRUCTION. IF THE CONTRACTOR DAMAGES AND/OR REMOVES CONDUIT AND CONDUCTORS DURING CONSTRUCTION, THE CONDUIT WILL BE REPLACED AND CONDUCTORS WILL BE INSTALLED WITHOUT SPLICING BETWEEN THE POLES AND THE CONTROLLER.
- ③ CONTRACTOR SHALL REPLACE 6'x6' LOOP DETECTORS (12) FOR WEST BOUND LEFT TURN MOVEMENT - LOOPS SHALL BE CENTERED IN LEFT TURN LANES.
- ④ CONTRACTOR SHALL REPLACE 6'x6' ADVANCED LOOP DETECTORS - SHALL BE CENTERED IN THRU TRAVEL LANES.

LEGEND

- EXISTING CONDUIT
- - - PROPOSED CONDUIT
- [TS] EXISTING PULL BOX
- [TS] PROPOSED PULL BOX
- EXISTING SIGNAL POLE
- ⊥ EXISTING SIGNAL HEAD W/ BACK PLATE
- ⊥ EXISTING SIGNAL HEAD W/ DIRECTIONAL ARROWS
- ⊥ EXISTING M-5 SIGNAL HEAD W/ BACK PLATE
- ⊠ EXISTING CONTROLLER CABINET
- EXISTING CURB & GUTTER
- EXISTING SIDEWALK
- ② TRAFFIC SIGNAL CONSTRUCTION NOTE

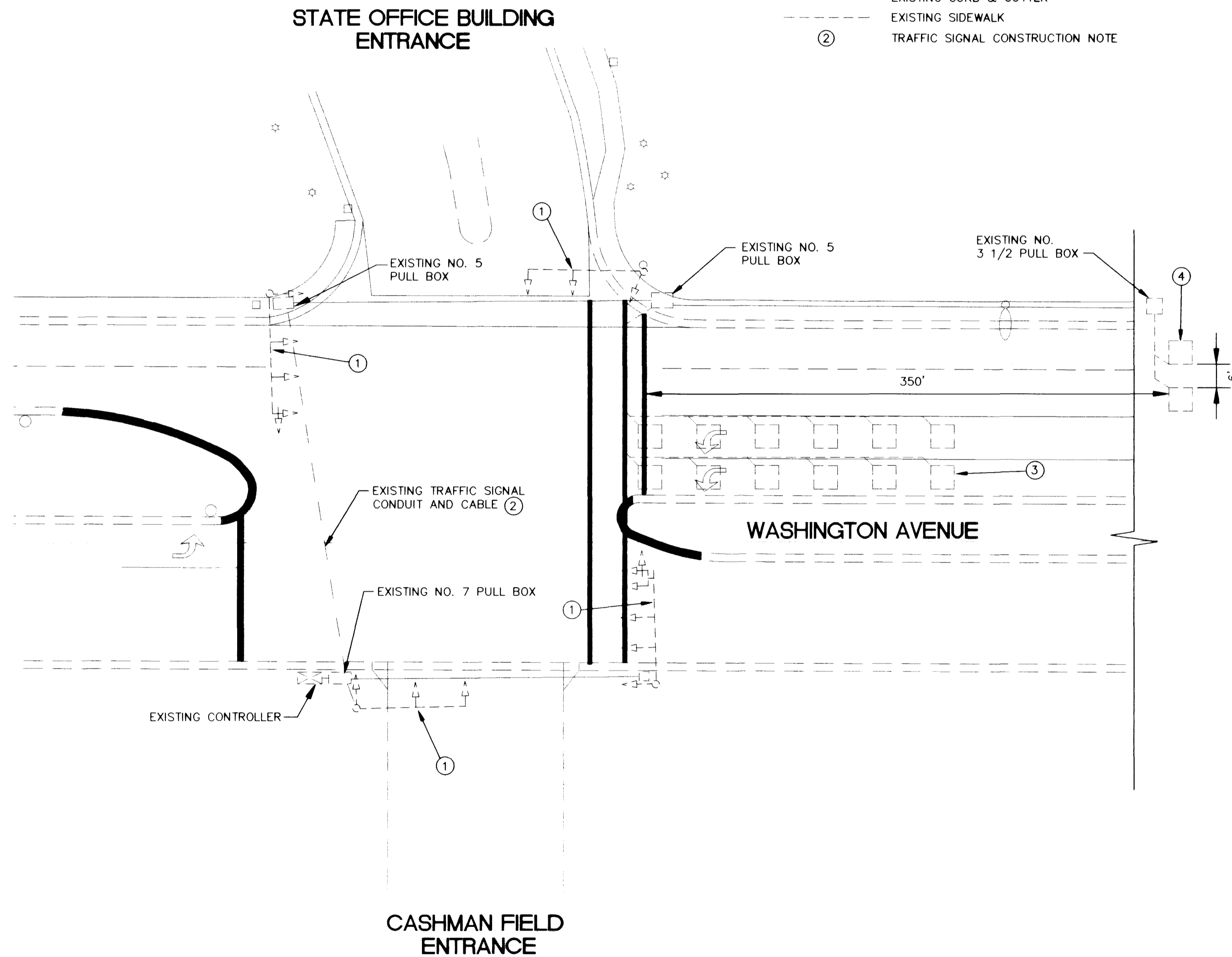

WASHINGTON AVENUE AND STATE OFFICE BUILDING ENTRANCE

REVISIONS	
No.	Date

RECORD DRAWINGS
 These Record Drawings have been prepared by the Engineer and are intended to be used as a permanent record of the project. They are not to be used for construction purposes. If any changes are made to these drawings, they must be approved by the Engineer and the City of Las Vegas.

DESIGNED BY: ARV	REVIEWED BY: RB/LS
DRAWN BY: GRR	CHECKED BY: GRR
JOB No: 661-95	DATE: 12/01/99
HORIZ: 1" = 20'	VERT: NONE

Carter Burgess
 Consultants in Engineering
 2965 S. Grand Ave., Suite 105
 Las Vegas, NV 89120
 (702) 798-1007 Fax (702) 798-7056

PROJECT: CITY OF LAS VEGAS UPPER WASHINGTON AVENUE CONVEYANCE SYSTEM
DESCRIPTION: PHASE 1 TRAFFIC SIGNAL RESTORATION PROJECT NO. 98.1730.21-RC
DRAWING NO. 731-54E
SHEET TS1 33 OF 35

