

PLAN VIEW - WEST CLARK AVENUE

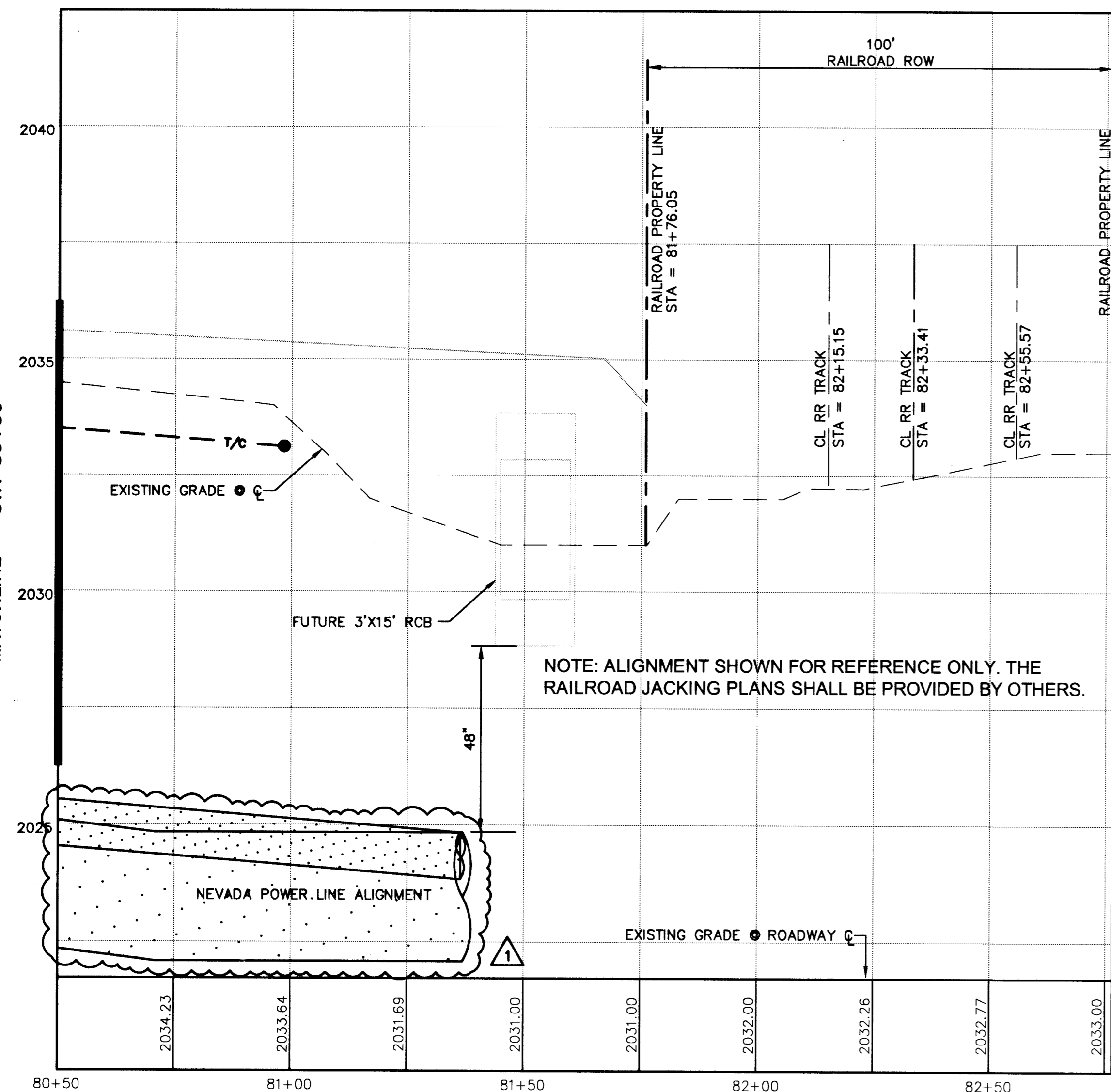

PROFILE VIEW - WEST CLARK AVENUE

SCALE: (H) 1" = 20'
(V) 1" = 2'

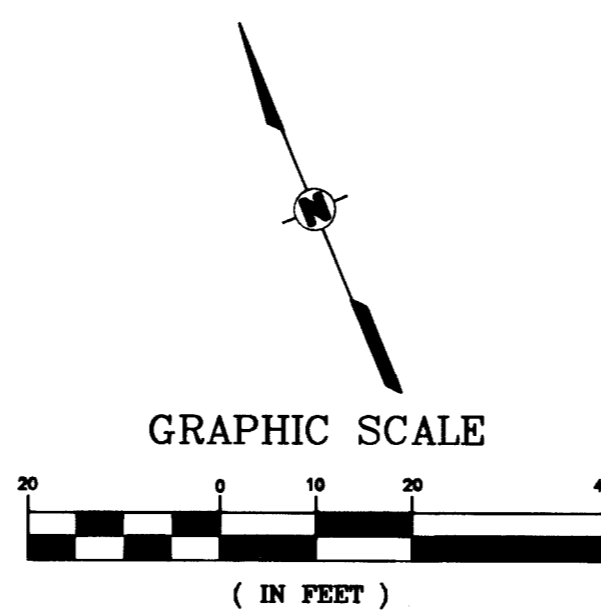
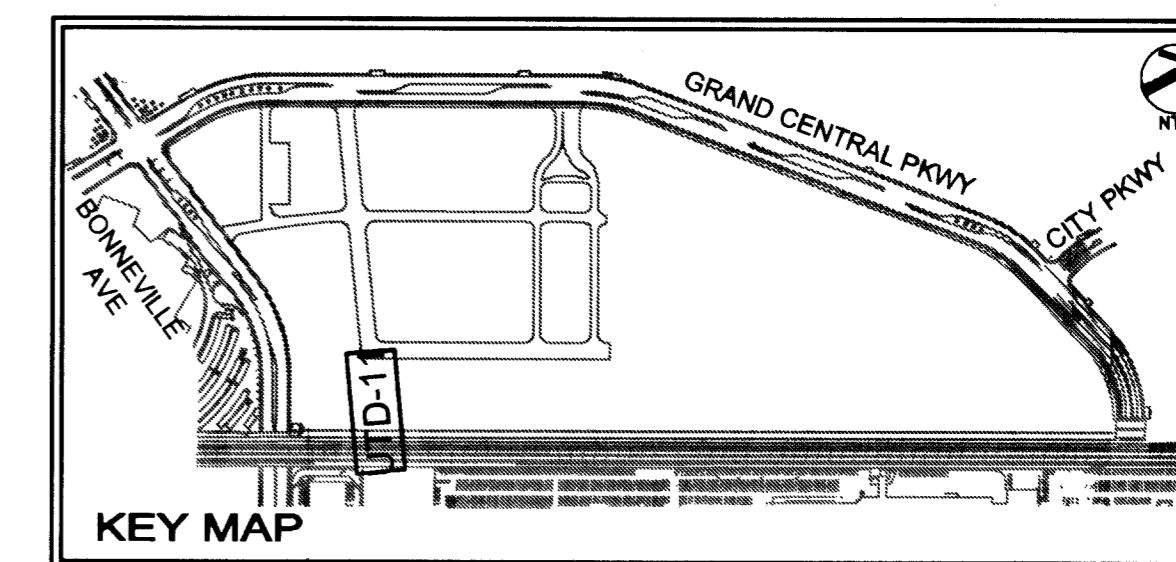

BASIS OF BEARING

NORTH 03°50'03" WEST, BEING THE BEARING OF A PORTION OF THE CENTERLINE OF GRAND CENTRAL PARKWAY, AS SHOWN ON BOOK 43, PAGE 61 OF PLATS ON FILE AT THE CLARK COUNTY, NEVADA RECORDER'S OFFICE

BENCHMARK

CITY OF LAS VEGAS VERTICAL CONTROL POINT "0LV01 3366", BEING A RIVET AND PLATE IN TOP OF CURB AT NW CORNER OF BONNEVILLE AVENUE & GRAND CENTRAL PARKWAY.

ELEVATION: 2036.09 (FEET)
620.6014 (METERS)
CITY OF LAS VEGAS VERTICAL CONTROL v.2002 BASED ON NORTH AMERICAN VERTICAL DATUM OF 1988 (NAVD 88).

GENERAL NOTES

1. THE CONTRACTOR SHALL PROTECT ALL EXISTING UNDERGROUND UTILITIES IN PLACE DURING EXCAVATION AND BACKFILL.
2. THE DRY UTILITY ALIGNMENTS, (GAS, ELECTRIC, TELEPHONE, CABLE) ARE SHOWN FOR REFERENCE AND ONLY THE MANHOLE LOCATIONS ARE INDICATED. SEE THE RESPECTIVE UTILITY DESIGN FOR FURTHER DETAILS. ANY RELOCATION OF THE MANHOLES FROM THE POSITIONS INDICATED MUST BE COORDINATED WITH THE ENGINEER.
3. CONTRACTOR SHALL MAINTAIN 3' HORIZONTAL DISTANCE BETWEEN WATER MAIN AND ANY DRY UTILITY.
4. ALL DRY UTILITY STRUCTURES ARE SHOWN WITH STATIONS AND OFFSETS TO THE CENTER OF THE STRUCTURE.

LEGEND

	PROP. NEVADA POWER CONDUIT
	PROP. COX COMMUNICATIONS
	PROP. TELEPHONE (BY OTHERS)
	PROP. TELEPHONE/CABLE
	PROP. GAS LINE
	SPRINT 650 MH (BY OTHERS)
	SPRINT 510 MH (BY OTHERS)
	MH PER NPC STDS
	B200 MH PER COX STDS
	PULLBOX PER NPC STDS
	TRANSFORMER PAD PER NPC STDS
	SUBMERSIBLE SWITCH VAULT PER NPC STDS

REV.	DATE	BY	DESCRIPTION
1	02/08/08	PAB	12" ST. GAS PROFILE / N/P CONDUIT

DESIGNED BY: DDW
CHECKED BY: DDW
DATE: February 2008

DESIGNED BY: PAB
SCALE (H): 1"=20'
SCALE (V): 1"=2'

Kimley-Horn and Associates, Inc.
© 2008
Engineering, Planning, and Environmental Consultants
2080 East Flamingo Road, Suite 210
Las Vegas, Nevada 89119
TEL: (702) 734-6666
FAX: (702) 735-4949

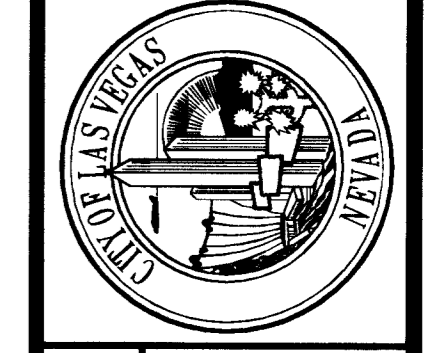

DEPARTMENT OF PUBLIC WORKS

PROJECT: **UNION PARK PHASE 1**

SHEET: **DRY UTILITIES - WEST CLARK AVE PLAN AND PROFILE STA: 80+50 - 81+76.06**

DAVID D. WILSON
Exp. 6/30/08
CIVIL

107V4816

SAFETY ALERT

Call before you Dig
Call Before You Overhead

811

1-702-455-7511
1-702-227-2929

H# 18393

092587003 - UNION PARK PHASE 1