

PLAN VIEW - UNION PARK PROMENADE WAY

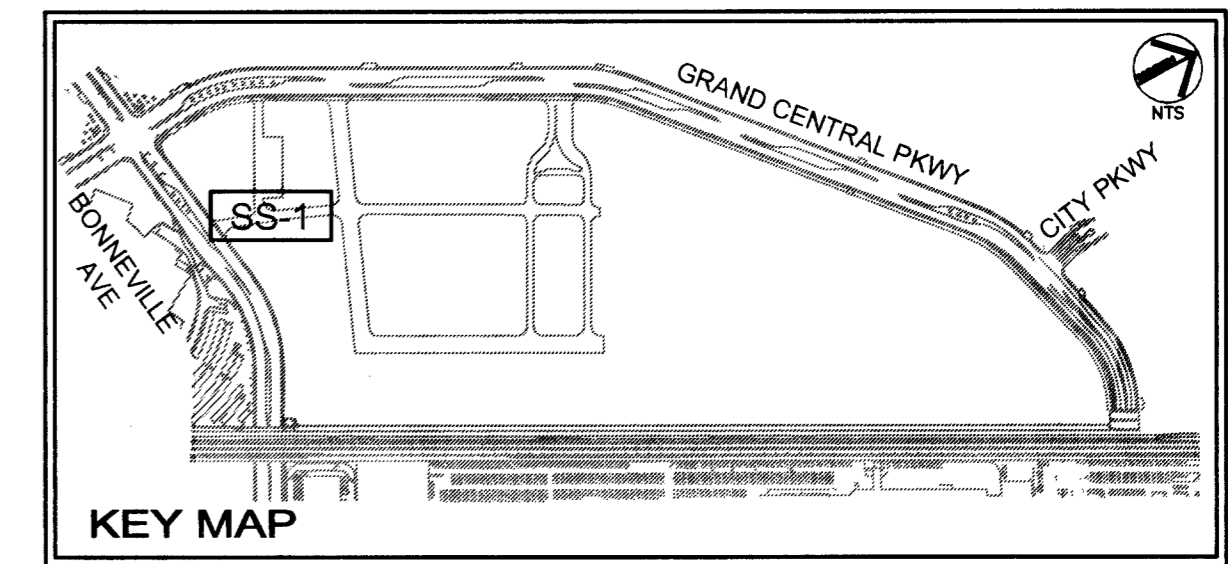
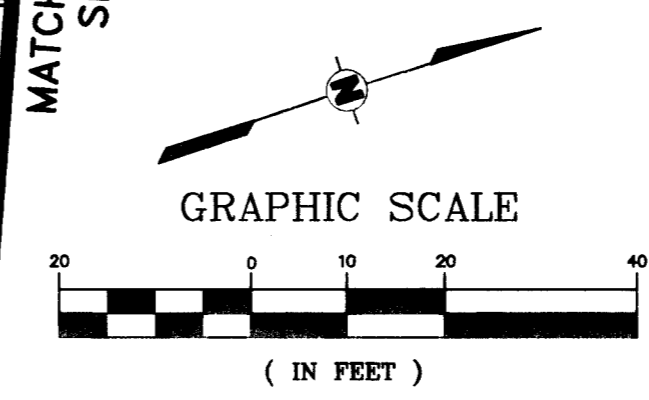

**BASIS OF BEARING**

NORTH 03°50'03" WEST, BEING THE BEARING OF A PORTION OF THE CENTERLINE OF GRAND CENTRAL PARKWAY, AS SHOWN ON BOOK 43, PAGE 61 OF PLATS ON FILE AT THE CLARK COUNTY, NEVADA RECORDER'S OFFICE

**BENCHMARK**

CITY OF LAS VEGAS VERTICAL CONTROL POINT "0LV01 33E6", BEING A RIVET AND PLATE IN TOP OF CURB AT NW CORNER OF BONNEVILLE AVENUE & GRAND CENTRAL PARKWAY.  
 ELEVATION: 2036.09 (FEET)  
 620.6014 (METERS)  
 CITY OF LAS VEGAS VERTICAL CONTROL v.2002 BASED ON NORTH AMERICAN VERTICAL DATUM OF 1988 (NAVD 88).

**CONSTRUCTION NOTES**

- 1 48" TYPE I MANHOLE PER DCSWCS SD-1.
- 3 8" SDR-35 PVC SEWER LATERAL (PRIVATE), MARK END OF PIPE PER DCSWCS SD No. 12.
- 4 SDR-35 SEWER MAIN. REFER TO PLAN FOR SIZE.
- 6 CONSTRUCT 60" MANHOLE OVER EXISTING 21" SEWER WITHIN BONNEVILLE AVENUE.

**GENERAL NOTES**

- 1. THE CONTRACTOR SHALL PROTECT ALL EXISTING UNDERGROUND UTILITIES IN PLACE DURING EXCAVATION BACKFILL.
- 2. THE CONTRACTOR SHALL MARK THE ENDS OF ALL UTILITY STUBOUTS, SEE DETAIL ON SHEET DT-2
- 3. ALL MAIN LINE SEWERS SHALL BE CONSIDERED PUBLIC, ALL LATERAL SEWERS SHALL BE CONSIDERED PRIVATE.

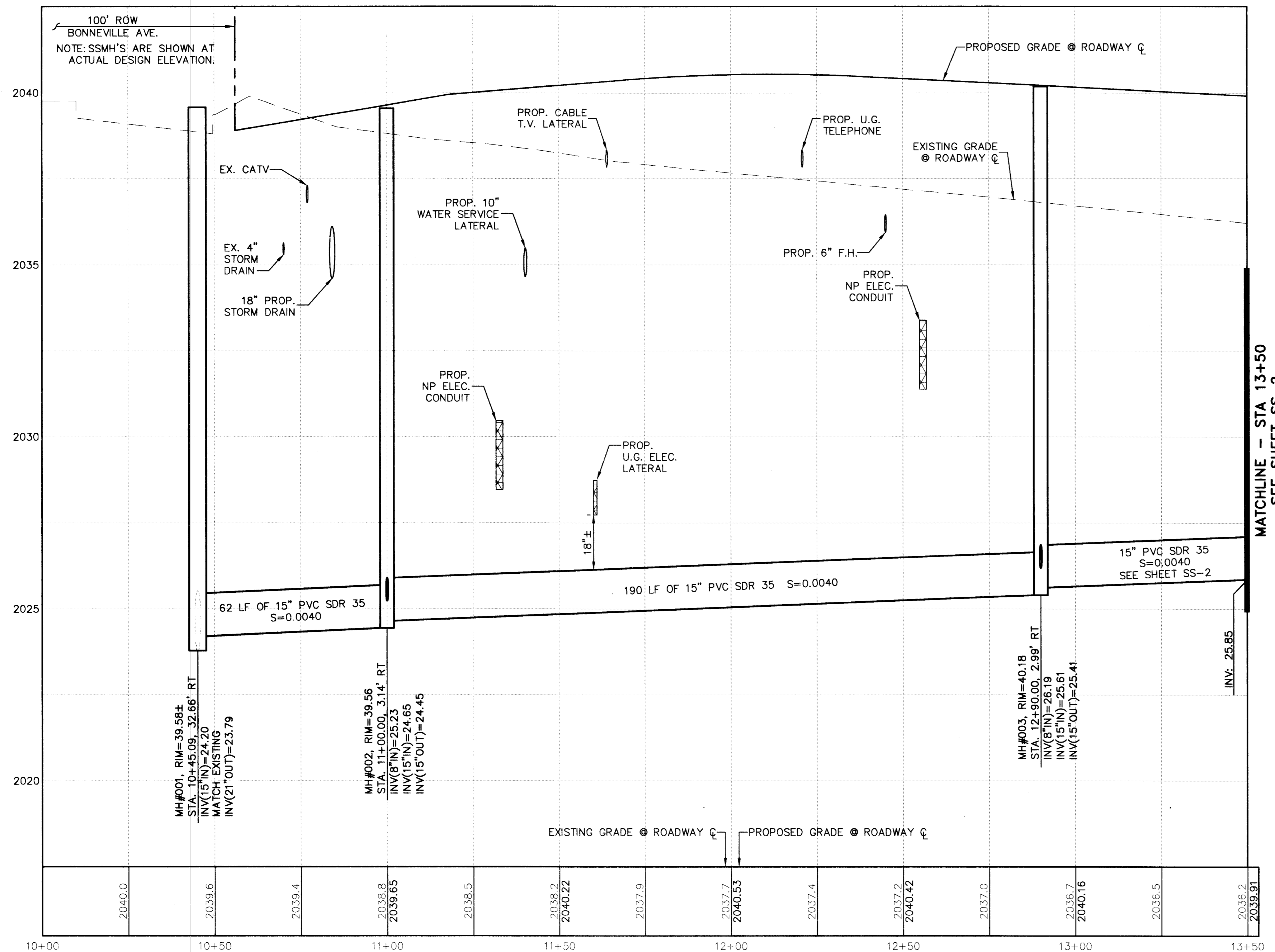

PROFILE VIEW - UNION PARK PROMENADE WAY

SCALE: (H) 1" = 20'  
 (V) 1" = 2'

APPROVED FOR CONSTRUCTION

LAS VEGAS VALLEY WATER DISTRICT PROJECT# 114260 DATE \_\_\_\_\_

**SAFETY ALERT**

Call before you Dig  
 811

Call Before You Overhead  
 1-702-227-2929

Call before you UnderGround  
 1-702-455-7511

CLARK COUNTY TRAFFIC OPERATIONS AND LAS VEGAS AREA COMPREHENSIVE TRAFFIC SYSTEM

DEPARTMENT OF PUBLIC WORKS

PROJECT: UNION PARK SANITARY SEWER PHASE 1

SHEET: SS-1

UNION PARK SANITARY SEWER STA: 10+00 TO 13+50

DATE: November 2007

DESIGNED BY: PAB SCALE: 1"=2'

CHECKED BY: DW

DRAWN BY: KHA SCALE: 1"=20'

Kimley-Horn and Associates, Inc.  
 Engineering, Planning, and Environmental Consultants  
 7085 E. Flamingo Ave., Suite 210  
 Las Vegas, Nevada 89119  
 TEL: (702) 734-5666  
 FAX: (702) 735-4949

DATE: 10/7/07

SS-1

SHEET 79 OF 166

DRAWING NO: 107/4816

REV. DATE BY

092587003 - UNION PARK PHASE 1

BID# 06178011

Date: November 29, 2007 - 9:09am / User: wade.walsh@nv.gov  
 Path: K:\CV\1092587 - Nevada\003 - Phase 1\03\SS1\SS1.dwg

107392

H# 18393