

VICINITY MAP
N.T.S.

LEGEND

	EXISTING CONTOUR
	EXISTING STORM DRAIN
	EXISTING GAS LINE
	EXISTING WATER LINE
	EXISTING SANITARY SEWER LINE
	EXISTING BURIED TELEPHONE LINE
	STREET CENTERLINE
	EXISTING EDGE OF PAVEMENT
	EXISTING CURB AND GUTTER
	EXISTING STREET LIGHT
	EXISTING UTILITY BOXES (AS NOTED)
	EXISTING TRAFFIC SIGNAL BOXES
	EXISTING SPRINKLER VALVE
	EXISTING WATER VALVE
	EXISTING TELEPHONE MANHOLE
	EXISTING SANITARY SEWER MANHOLE
	EXISTING FIRE HYDRANT
	EXISTING NATURAL GRADE
	EXISTING CURB OR EXISTING PAVEMENT TO BE REMOVED
	PROPOSED CONCRETE
	PROPOSED PAVEMENT
	PROPOSED CONTOUR

LAS VEGAS VALLEY WATER DISTRICT NOTES

- NO WORK SHALL BEGIN ON WATER PLANS UNTIL THEY HAVE BEEN RELEASED FOR CONSTRUCTION BY LVVWD. FOLLOWING APPROVAL OF THE PLANS, NOTICE MUST BE GIVEN TO THE LVVWD CUSTOMER SERVICE DEPARTMENT (870-4194) 48 HOURS PRIOR TO ACTUAL CONSTRUCTION AND 24 HOURS PRIOR TO AN INSPECTION.
- CALL BEFORE YOU DIG 1-800-227-2600
- ALL WORK SHALL CONFORM TO LVVWD LATEST STANDARD PLATES DRAWINGS, AND SPECIFICATIONS.
- ALL WORK, EXCEPT AS MODIFIED HEREON OR BY NOTE 3, SHALL BE DONE IN ACCORDANCE WITH THE MOST CURRENT DRAFT OR ADDITION OF UNIFORM STANDARD SPECIFICATIONS FOR PUBLIC WORKS CONSTRUCTION OFF-SITE IMPROVEMENT, CLARK COUNTY AREA.
- DISTRICT APPROVED SERVICE SADDLES OR TAPPED COLLARS WILL BE REQUIRED ON ALL 3/4" AND 1" SERVICE LATERALS. SERVICE SADDLES ONLY SHALL BE PERMITTED ON 1-1/2" AND 2" SERVICE LATERALS. DOUBLE TAPPED COLLARS ARE NOT PERMITTED.
- COPPER SERVICE LATERALS - ALL 3/4" TO 2" SERVICE LATERALS SHALL BE OF COPPER TUBING IN ACCORDANCE WITH THE DISTRICT'S SPECIFICATIONS AND STANDARD PLATES.
- THE MAXIMUM ALLOWABLE JOINT DEFLECTION FOR ACP AND DUCTILE IRON PIPE SHALL BE AS FOLLOWS:

PIPE SIZES	ACP	DUCTILE IRON SUP JOINT	DUCTILE IRON MECHANICAL JOINT
6 - 12 INCH	2.5 DEG.	2.5 DEG.	3.5 DEG.
14 - 18 INCH	2.5 DEG.	2.5 DEG.	2.5 DEG.
18 - 24 INCH	N/A	1.5 DEG.	1.5 DEG.

ON PVC PIPE, THE MAXIMUM OFFSET FOR A 20' LENGTH OF FACTORY BELLED PIPE SHALL BE 16 INCHES FOR 6" PIPE, 12 INCHES FOR 8" PIPE, AND 9 INCHES FOR 10" AND 12" PIPE. IF THESE OFFSETS CONFLICT WITH THE PIPE MANUFACTURERS RECOMMENDATION, THE MORE STRINGENT REQUIREMENTS SHALL APPLY.

- ALL WATER METER BOXES SHALL BE LOCATED OUTSIDE OF DRIVEWAY AREAS, AND VALLEY GUTTERS.
- ALL VALVES SHALL BE LOCATED OUTSIDE OF DRIVEWAYS AREAS AND VALLEY GUTTERS.
- DETECTOR TAPE REQUIRED IN ACCORDANCE WITH STANDARD PLATE NO.27 WHERE INDICATED, AND AS FOLLOWS:
A. OVER ALL MAINS NOT INSTALLED AT 6 FEET FROM BACK OF CURB.
B. OVER ALL SERVICE LATERAL NOT INSTALLED AT RIGHT ANGLES TO MAINS.
- ALL WATER MAINS ARE TO BE PRESSURE TESTED AT 200 PSI FOR A CONTINUOUS TWO HOUR PERIOD, IN ACCORDANCE WITH DISTRICT STANDARDS.
- ALL WATER MAINS SHALL BE DISINFECTED, FLUSHED, AND AN ACCEPTABLE HEALTH SAMPLE OBTAINED, PRIOR TO THE CONNECTION OF THE WATER MAIN(S) AND/OR LATERAL(S) TO THE DISTRICT'S SYSTEM.
- CONTRACTOR TO OBTAIN ALL METERS 2" AND SMALLER FROM LVVWD CENTRAL STORES. TELEPHONE: 258-3152 FORTY-EIGHT (48) HOURS PRIOR TO PICKUP.

CITY OF LAS VEGAS FIRE DEPT. NOTES

- ALL CONSTRUCTION AND MATERIALS SHALL BE IN ACCORDANCE WITH THE LATEST EDITION OF THE DESIGN & CONSTRUCTION STANDARDS FOR WASTEWATER COLLECTION SYSTEMS AND THE UNIFORM STANDARD SPECIFICATIONS FOR PUBLIC WORKS CONSTRUCTION OFF-SITE IMPROVEMENTS, CLARK COUNTY AREA, NEVADA, AS AMENDED. IN ALL CASES, THESE STANDARDS SHALL SUPERSEDE THE UNIFORM STANDARD SPECIFICATIONS. IT WILL BE THE RESPONSIBILITY OF THE CONTRACTOR TO BE AWARE OF THE CONTENTS OF THE ABOVE SPECIFICATION BOOKS.
- IT SHALL BE THE CONTRACTOR'S RESPONSIBILITY TO PERFORM CONSTRUCTION AS PER PLAN. ANY ADDITIONS, DELETIONS, OR CHANGES SHALL FIRST MEET WITH THE APPROVAL OF THE CONTROLLING AGENCY.
- CHISEL "S" OR "G" IN CURBS WHERE SEWER OR GAS LATERALS PASS UNDER CURB.
- POLYVINYL (PVC) SEWER PIPE SHALL MEET ASTM D-3034 SDR 35 SPECIFICATIONS, AND INSTALLED WITH SAND BEDDING AND BACKFILL OF TYPE II GRAVEL.
- ALL MANHOLES IN PAVED STREETS 80 FT. R/W AND LARGER, SHALL HAVE CONCRETE COLLARS.
- TEE SADDLES SHALL BE USED TO CONNECT SEWER LATERALS TO EXISTING MAIN LINES UP TO 12 IN. DIA. SIZE. CONNECTIONS TO 15 IN. OR LARGER MAINS SHALL REQUIRE SPECIAL PROCEDURES.
- A SEWER MAIN CROSSING OVER A WATER MAIN OR LESS THAN 18 IN. UNDER A WATER MAIN MUST BE REINFORCED CONCRETE ENCASED PIPE FOR A DISTANCE OF NOT LESS THAN TEN FEET (10') ON EACH SIDE OF THE CENTERLINE OF THE WATER MAIN.
- ALL CONTRACTORS INSTALLING SEWER MAINS THAT WILL BE UNDER THE JURISDICTION OF THE CONTROLLING AGENCY MUST BE CLASS "A" CONTRACTORS.

SANITARY SEWER

AVERAGE FLOW 3.19 G.P.M.
PEAK FLOW 11.18 G.P.M.

NOTE:
ALL ONSITE SEWERS ARE PRIVATELY OWNED AND MAINTAINED.

BENCH MARK:
NO. 7C00-345SE6
NORTHEAST CORNER RAINBOW & CHARLESTON - 2"X2" ALUMINUM PLATE AT P.C. IN T.C. - ELEVATION = 2399.60

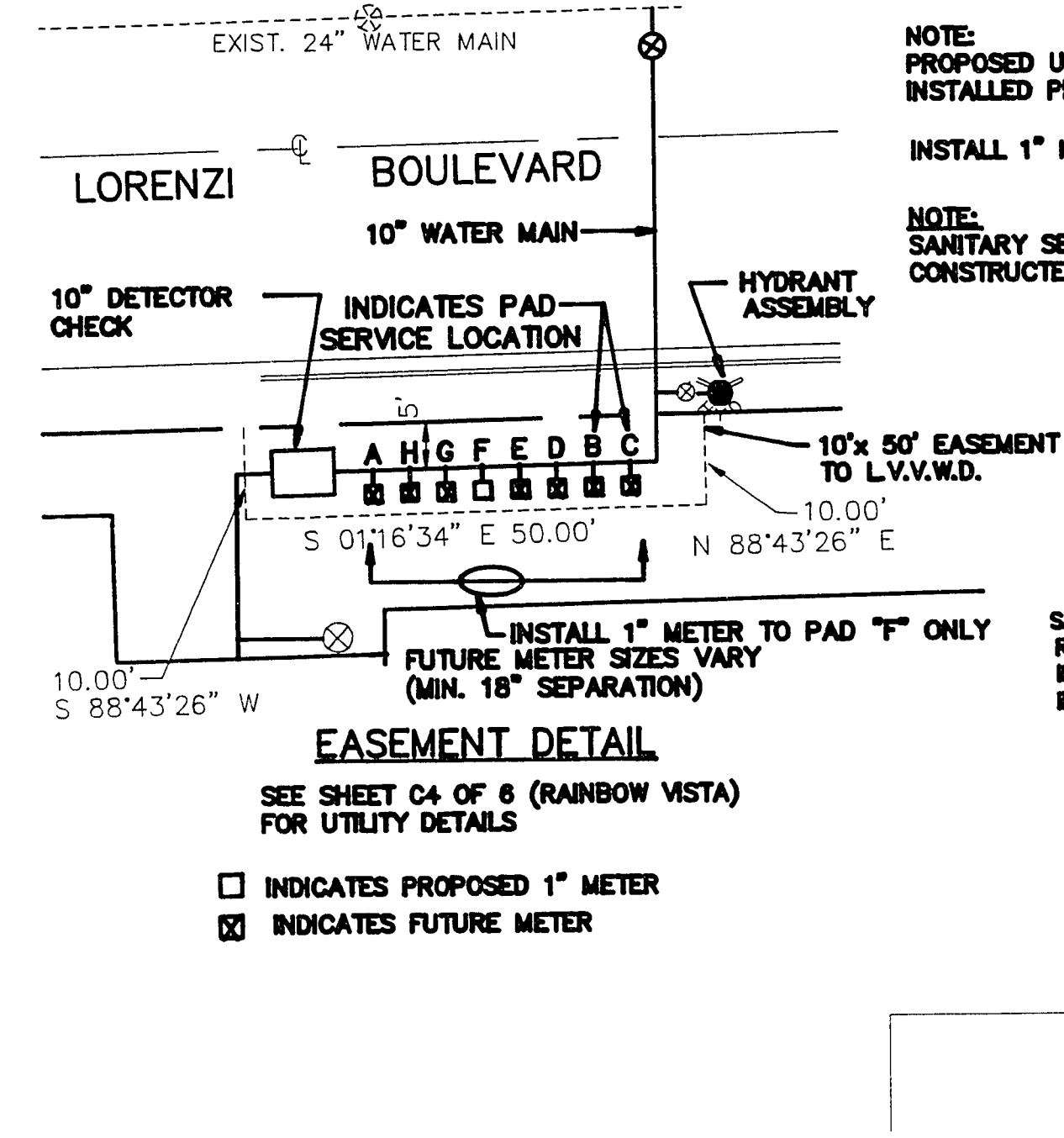

INSTALLATION OF DETECTOR CHECK AND VAULT

THE DETECTOR CHECK(S) AND VAULT(S) WITH THE NON-TRAFFIC BEARING COVER(S) SHALL BE INSTALLED IN ACCORDANCE WITH THE DISTRICT'S STANDARD PLATE 19 AND WITH STANDARD VAULT DRAWING C-475, LATEST REVISION.

ANY BLOCK WALL OR OTHER FENCE MATERIAL SHALL BE DESIGNED AND CONSTRUCTED AROUND THE OUTSIDE OF THE EASEMENT(S), SO AS TO ALLOW THE DISTRICT DIRECT ACCESS TO THE VAULT(S) FROM THE ADJACENT RIGHT-OF-WAY.

CITY OF LAS VEGAS FIRE DEPT. NOTES

- ALL WORK SHALL BE DONE IN STRICT ACCORDANCE WITH THE CITY OF LAS VEGAS FIRE DEPARTMENT "HYDRANT SPECIFICATIONS", "HYDRANT INSTALLATION SPECIFICATIONS" AND ORDINANCE #3677.
- AUTHORIZED HYDRANTS FOR THIS PROJECT ARE:
A. KENNEDY GUARDIAN
B. MUELLER A-423 CENTURIAN
C. CLOW MODEL 2546 MEDALLION
- ON ANY NEW HOME OR BUILDING INSTALLATION, ACCESSIBLE FIRE HYDRANTS SHALL BE INSTALLED BEFORE COMBUSTIBLE CONSTRUCTION COMMENCES AND SAID FIRE HYDRANTS SHALL BE IN GOOD WORKING ORDER WITH AN ADEQUATE WATER SUPPLY.
- CONTRACTOR SHALL PLACE A BLUE REFLECTIVE MARKER AT CENTERLINE OF STREET ADJACENT TO FIRE HYDRANT AS REQUIRED IN ORDINANCE #3677 TO IDENTIFY FIRE HYDRANT LOCATIONS.
- CALL THE LAS VEGAS BUILDING DEPARTMENT AT 229-2071 FOR UNDERGROUND INSPECTION, PRESSURE AND FLUSH VERIFICATION OF ALL FIRE HYDRANTS AND FIRE LINES BEFORE COVERING.
- PAINTING OF THE CURBS AND HYDRANT AND ANY WORK NECESSARY FOR PROTECTION OF HYDRANTS FROM PHYSICAL DAMAGE PER ORDINANCE #3677 SHALL BE COMPLETED BEFORE APPROVAL BY THE CITY OF LAS VEGAS FIRE DEPARTMENT.
- A PERMIT IS REQUIRED FROM THE FIRE DEPARTMENT FOR ON-SITE WATER LINE AND FIRE HYDRANT. THE PERMIT AND CONTRACTORS MATERIAL AND TEST CERTIFICATE FOR UNDERGROUND PIPING FORM SHALL BE OBTAINED FROM THE FIRE PROTECTION ENGINEER PRIOR TO ANY WORK BEGINNING.
- A FLOW TEST MUST BE WITNESSED BY THE FIRE DEPARTMENT PRIOR TO OCCUPANCY FOR VERIFICATION OF REQUIRED ON-SITE WATER SUPPLY.
- ALL ON-SITE FIRE MAIN MATERIALS MUST BE U.L. LISTED AND F.M. APPROVED.
- FIRE HYDRANT SPACING:
RESIDENTIAL - 500 FEET UNSPRINKLERED, 600 FEET SPRINKLERED
COMMERCIAL, INCLUDING MULTI-FAMILY - 300 FEET UNSPRINKLERED, 400 FEET SPRINKLERED
- NO FIRE HYDRANT SHALL BE LOCATED WITHIN THE REQUIRED RADIUS OF CUL-DE-SAC OR WITHIN 20 FEET OF THE PERIMETER OF THE RADIUS OF THE CUL-DE-SAC.
- NO FIRE HYDRANT SHALL BE LOCATED WITHIN 6 FEET OF ANY CURB RETURN, DRIVEWAY, POWER POLE, STREET LIGHT OR ANY OTHER OBSTRUCTION.
- NOT MORE THAN 2 HYDRANTS CAN BE OUT OF SERVICE DUE TO A SINGLE MAIN BREAK.
- THE TURNING RADIUS FOR ANY FIRE APPARATUS ACCESS ROAD AND/OR FIRE LANE, PUBLIC OR PRIVATE SHALL BE NOT LESS THAN 45 FEET OUTSIDE RADIUS AND 22 FEET INSIDE RADIUS.
- A FIRE APPARATUS ROAD SHALL BE REQUIRED WHEN ANY PORTION OF AN EXTERIOR WALL OF THE FIRST STORY IS LOCATED MORE THAN 150 FEET FROM A FIRE DEPARTMENT VEHICLE ACCESS. (SEE EXCEPTIONS UFC 88, SECTION 10.2.07).
- ALL DEAD END FIRE HYDRANTS APPARATUS ACCESS ROADS AND/OR FIRE LANES PUBLIC OR PRIVATE IN EXCESS OF 150 FEET IN LENGTH SHALL BE PROVIDED WITH AN APPROVED TURNAROUND AREA. SEE ORDINANCE #3677, REV: 2/93

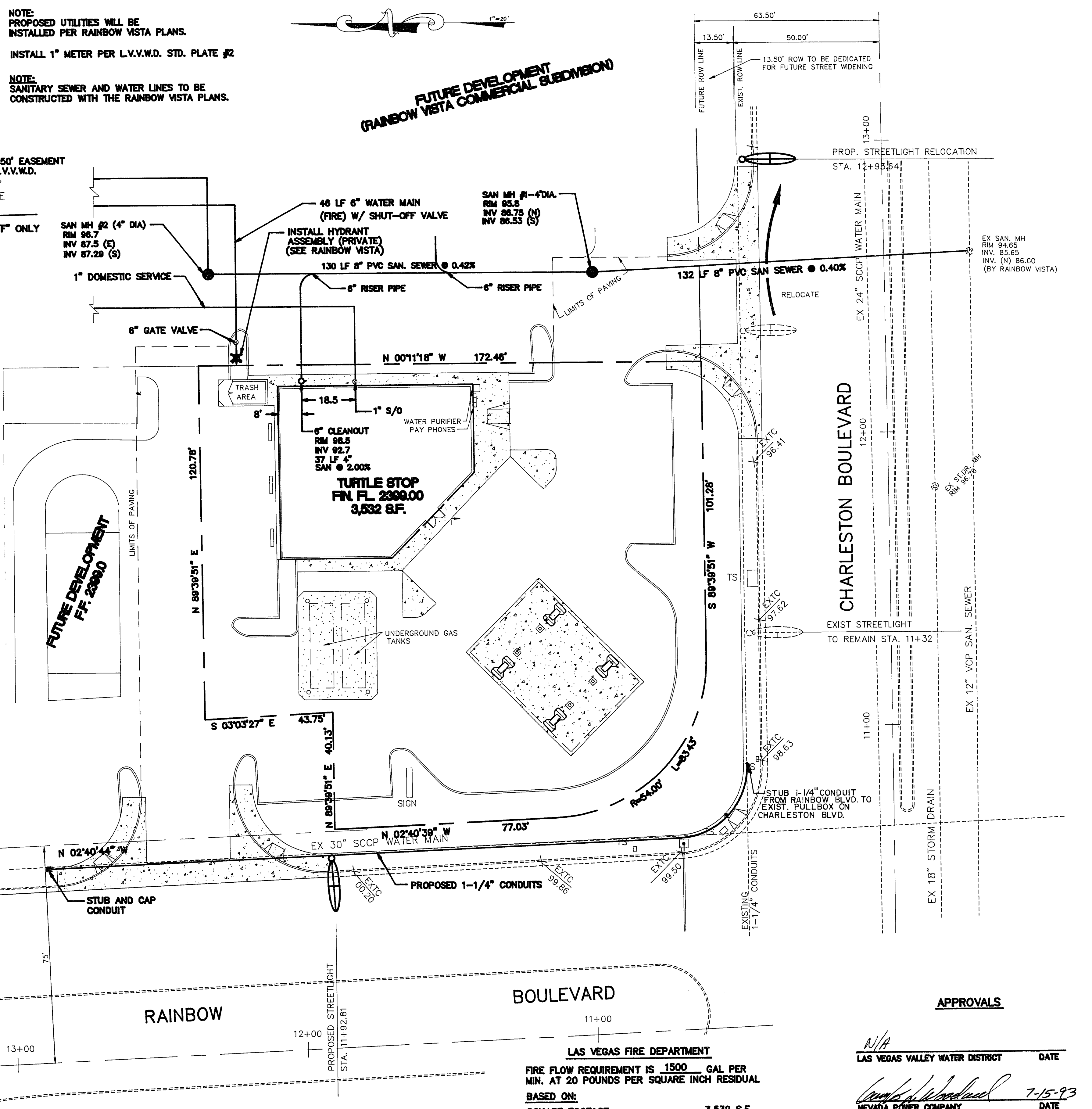

AVOID CUTTING UTILITY LINES IT'S COSTLY

CALL before you DIG.
1-800-227-2600

LAS VEGAS FIRE DEPARTMENT

FIRE FLOW REQUIREMENT IS 1500 GAL PER MIN. AT 20 POUNDS PER SQUARE INCH RESIDUAL

BASED ON:

SQUARE FOOTAGE	3,532 S.F.
LARGEST AREA BETWEEN AREA SEPARATION WALLS	3,532 S.F.
HEIGHT	17'-0"
TYPE OF CONSTRUCTION	TYPE V-N
EXPOSURES	STUCCO
SPRINKLER SYSTEM	NO
OCCUPANCY	B-2

ROOF CONSTRUCTION "CLASS B" BUILT-UP ROOF/TILE
REVIEWED BY: [Signature]
DATE: 7/2/93

APPROVALS

N/A
LAS VEGAS VALLEY WATER DISTRICT DATE

[Signature]
NEVADA POWER COMPANY DATE 7-15-93

N/A
TRAFFIC ENGINEER DATE

N/A
STORM WATER MGMT. DATE

CASHDAN

844 EAST SARARA
LAS VEGAS, NEVADA 89104
(702) 735-7885
FAX (702) 735-8282

LAND SURVEYING
CIVIL ENGINEERING
STRUCTURAL ENGINEERING
FORENSIC ENGINEERING

TURTLE STOP
A COMMERCIAL DEVELOPMENT
A Portion Of The Southeast Quarter Of The Southeast Quarter Of Section 34, Township 20 South, Range 60 East, N.T.B. & M. City Of Las Vegas, Clark County, Nevada

UTILITY PLAN

NO.	DATE	REVISION	APPL.	PROJECT TITLE

DATE: 13 JULY 1993
JOB NO: 93108-300
SCALE: 1"=20'
DRAWN: T.J.E.
DESIGNED: B.P.T.
CHKD BY: B.P.T.
FLD. VOL: N/A

sheet: **C4 OF 4**

107-V2134
11-2-36