



REVISIONS: PLAN CHECK  
DATE: 10/12/05

CONSULTANT

**M&A**  
ENGINEERS  
&  
CONSULTANTS

11701 28th Street  
Suite 102  
Las Vegas, NV 89119  
T: (702) 886-1900  
F: (702) 886-1033  
email: mad@mna-1v.com

Traffic Signal Repair Shop  
2824 E. Charleston Blvd.  
SITE ELECTRICAL PLAN

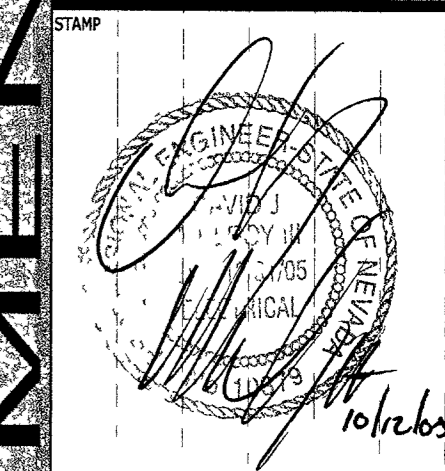

OWNER: CITY OF LAS VEGAS  
DEPARTMENT OF PUBLIC WORKS  
ARCHITECTURAL SERVICES

400 EAST STEWART AVENUE  
LAS VEGAS, NEVADA 89101  
PHONE: (702) 229-6535  
FAX: (702) 384-4846  
TDD: (702) 386-9108

DRAWN	M&A
M&A PROJECT #	L04399
DATE	8-1-05
SCALE	AS NOTED
SHEET NO.	04B34101
CLV DRAW NO.	521-289
SHEET NO.	E1.01

E1.01

**GENERAL NOTES:**

1. ALL CIRCUITS SHALL CARRY A GREEN GROUND CONDUCTOR.

**SHEET NOTES:**

1. APPROXIMATE LOCATION OF NEVADA POWER COMPANY TRANSFORMER. INSTALL ALL WORK PER NEVADA POWER COMPANY ENGINEERED DRAWINGS.
2. MAIN GATE INTERCOM, CARD ACCESS, CAMERA POST. COORDINATE ALL ROUGH-IN WITH GATE INSTALLER.
3. PROVIDE SIZE 3 1/2" PULLBOX FOR FUTURE.
4. PROVIDE (1) 2" CONDUIT TO COMM ROOM 013.
5. PROVIDE (1) 1 1/4" CONDUIT TO EQUIPMENT ROOM 001 TURN UP NEXT TO PANEL FOR FUTURE ACTIVATION.
6. COORDINATE WITH GATE EQUIPMENT INSTALLER FOR ALL ELECTRICAL AND LOW VOLTAGE ROUGH-IN REQUIREMENTS.
7. PROVIDE 1" CONDUIT TO PANEL 'L1'.
8. PROVIDE (2) 4" CONDUIT STUBBED 5' NORTH OF BLOCK WALL FOR FUTURE FAST SYSTEM NETWORK.
9. PROVIDE A SPRINT 400 PULLBOX IN THE SIDEWALK. COORDINATE THIS WORK WITH CITY OF LAS VEGAS.
10. PROVIDE (1) 4" CONDUIT FROM EXISTING NEVADA POWER COMPANY UTILITY POLE (RISE UP POLE MINIMUM OF 3' AND CAP) TO LOCATION SHOWN FOR FUTURE NEVADA POWER SERVICE TO FAST SYSTEM METER PEDESTAL.
11. PROVIDE BUILDING DISCONNECT FOR SHED, INCLUDE ALL SERVICE ENTRANCE GROUNDING PER CODE.
12. INTERCEPT EXISTING 4" CONDUIT (FAST SYSTEM) AND INSTALL NEW ELBOWS AND CONDUIT INTO NEW 400 BOX. INCLUDE ALL COST FOR SAW CUTTING OF ASPHALT AND CONCRETE SIDEWALK, DITCHING, NDOT APPROVALS, LANE CLOSURES, PATCHING, ETC FOR A COMPLETE INSTALLATION.
13. PROVIDE (1) 4" CONDUIT WITH (3) 1 1/4" ORANGE INNER DUCTS WITH FULL STRING IN EACH FROM FAST SYSTEM ENCLOSURE TO COMMUNICATION ROOM 013.
14. PROVIDE 400 BOX IN FAST SYSTEM YARD FOR ALL LOW VOLTAGE CONDUIT TO TERMINATE INTO.

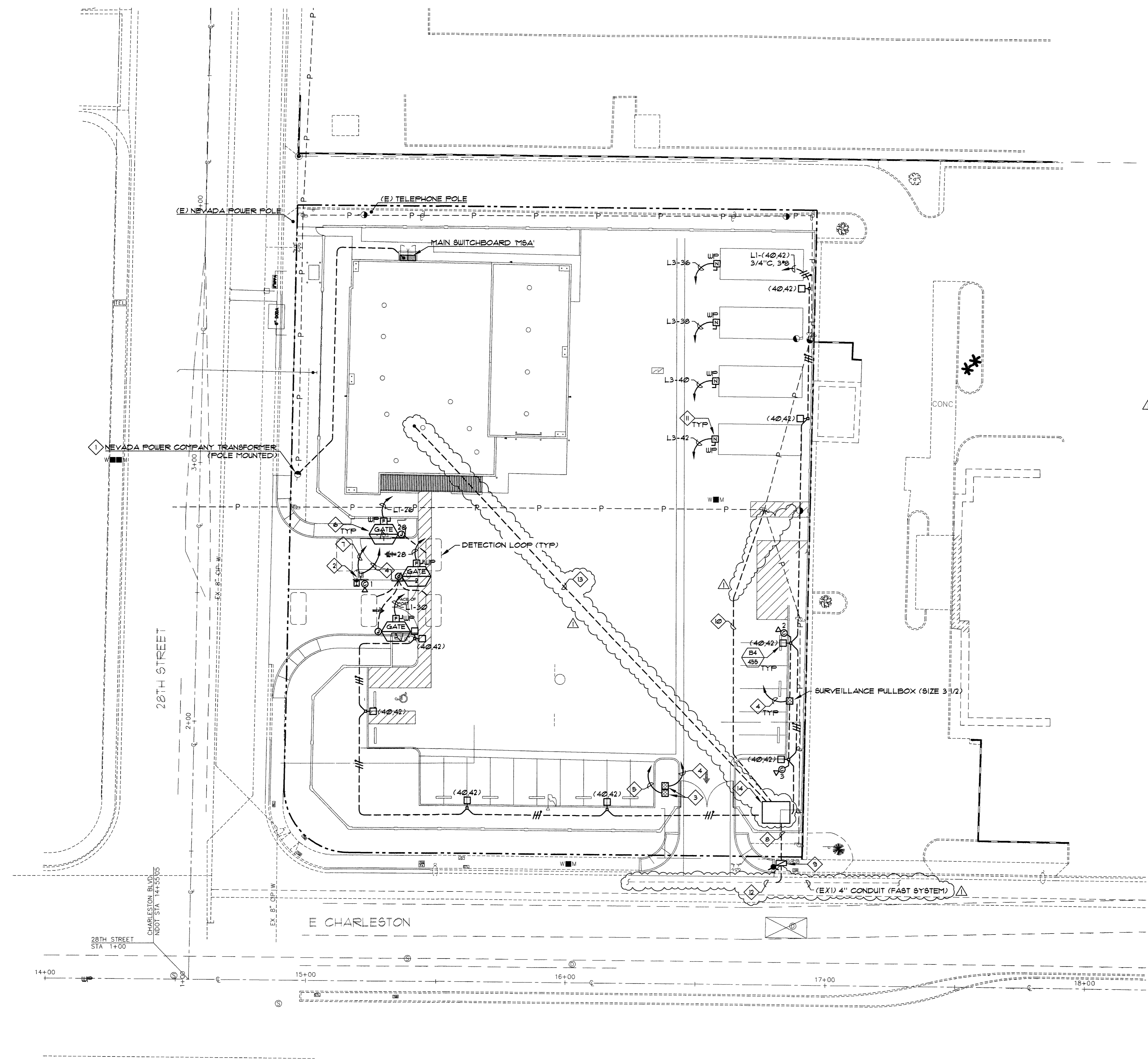

**A SITE ELECTRICAL PLAN**  
E1.01 1" = 20'-0"  
NORTH

103652

10/12/05

DRAWING IS INSTRUMENTS OF SERVICE AND THE PROPERTY OF THE DESIGN PROFESSIONAL. THESE DRAWINGS ARE NOT TO BE REPRODUCED OR TRANSMITTED IN ANY FORM OR BY ANY MEANS, ELECTRONIC OR MECHANICAL, WITHOUT THE WRITTEN PERMISSION OF THE DESIGN PROFESSIONAL. THE CLIENT AND USER OF THESE DRAWINGS SHALL BE RESPONSIBLE FOR THE CONSTRUCTION OF ANY OTHER PROJECTS IN A.C. 003.200