

PROJECT: _____
 SEG/SPAN: _____ SEG
 FROM _____ TO _____
 TO _____
 SECTION: 11
 TOWNSHIP: 20S
 RANGE: 60E

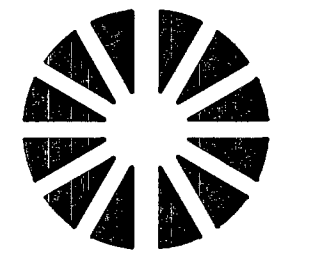

Know what's below.
 Call before you dig.



CenturyLink

TITLE: FIBER OPTIC CABLE ROUTE

N. TORREY PINES DR
 GOWAN RD TO CRAIG RD

REVISIONS

DATE	DESCRIPTION	INITIAL

MP TO MP

SHEET 7 OF 11

DWG. NO. CTL E.422282

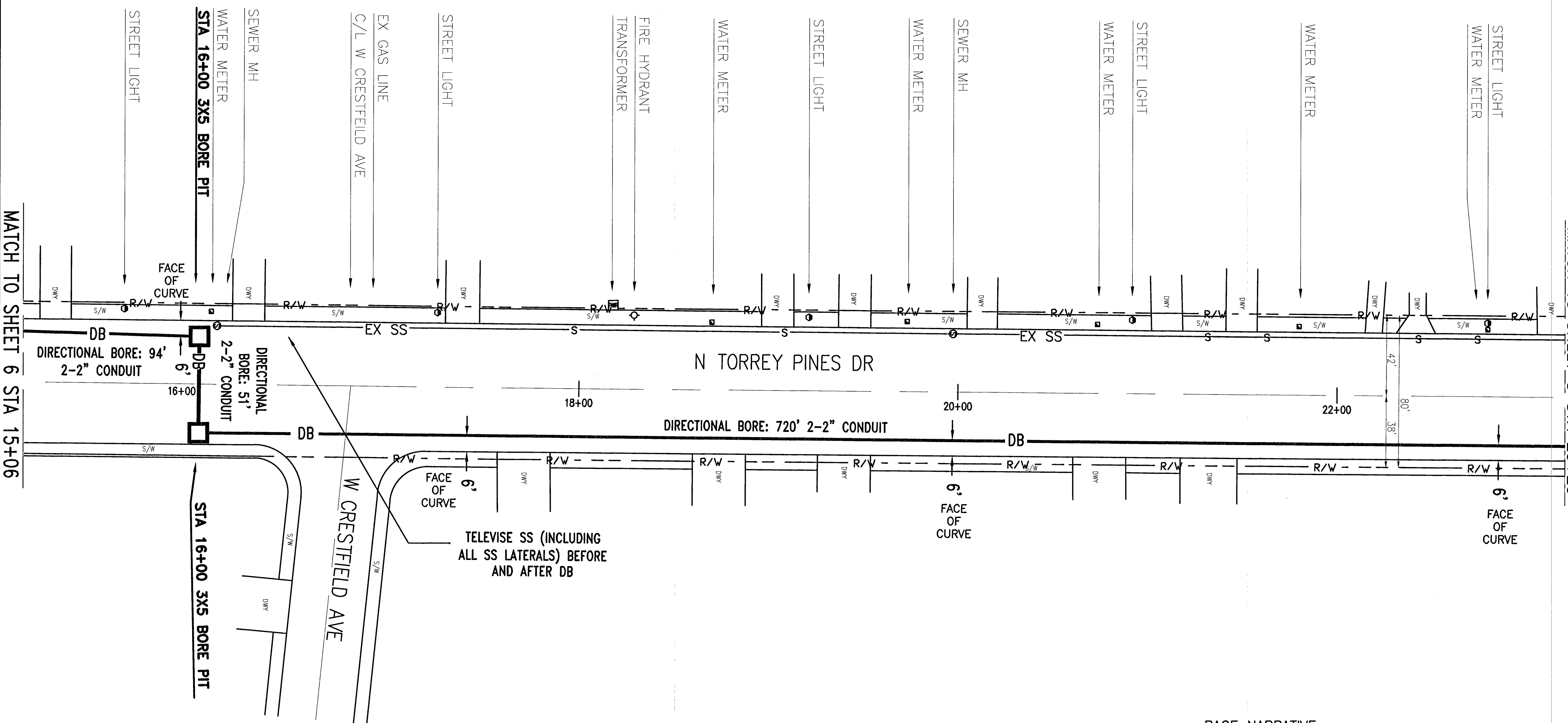

MATCH TO SHEET 6 STA 15+06

MATCH TO SHEET 8 STA 23+20

NOTE:
 DUE TO EXISTING UTILITIES THE CONTRACTOR WILL AT VARIOUS TIMES NEED TO OPEN A WINDOW IN ASPHALT ROADWAY OR SIDEWALK TO DETERMINE EXISTING UTILITY DEPTHS. THE WINDOW WILL BE REPAIRED TO CITY SPECIFICATIONS AS DICTATED BY THE CITY INSPECTOR. POT HOLE LOCATIONS NOT SHOWN ON PLAN REQUIRE SEPARATE PERMIT.

PAGE NARRATIVE:
 CONTINUE BORING NORTH ALONG N TORREY PINES DR A DISTANCE OF 94'. NEXT BORE EAST UNDER N. TORREY PINES FOR A DISTANCE OF 51'. THEN BORE NORTH FOR A DISTANCE OF 720'.

RUS LIST	EST QTY	ACT QTY
BHF(30x60x30)T	-	
BFOV(2)(2)OT	-	
BORE PIT	2	
BM60(2-2)PD	865'	
BM73	10'	

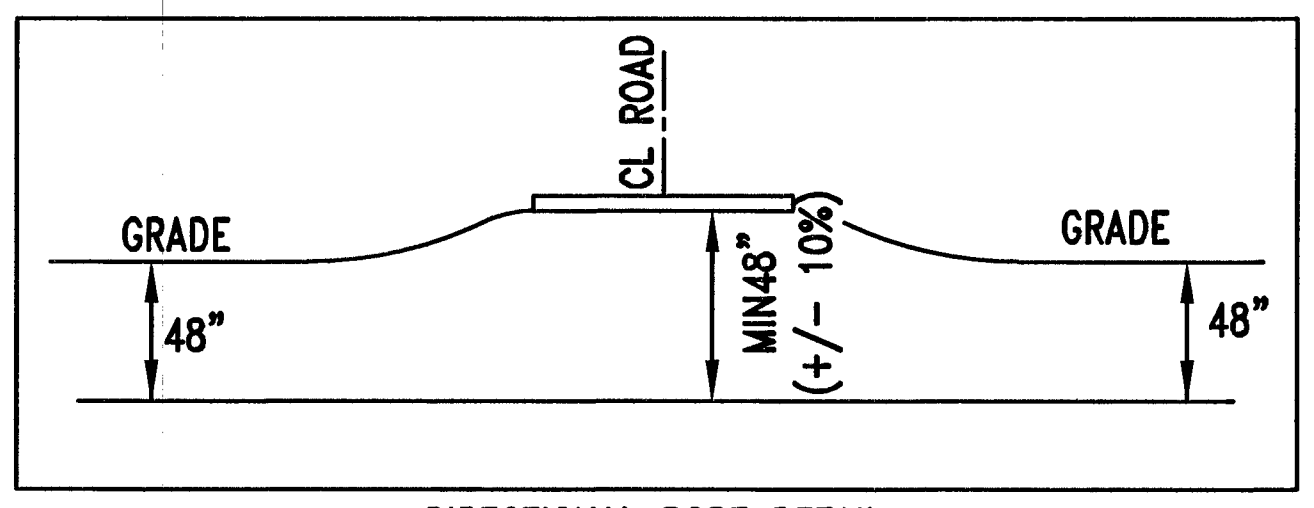

DIRECTIONAL BORE DETAIL
 NOT TO SCALE