

Scale
 Hor: 1" = 40'
 Vert: 1" = 5'

Scale
 Hor: 1" = 40'
 Vert: 1" = 5'

Scale
 Hor: 1" = 40'
 Vert: 1" = 5'

GENERAL NOTE REGARDING STUBS:
 Stub lengths are from the center of the manhole cover to the outer end of the stub.
 Minus distances refer to the depth from existing ground surface to the top of the stub at the outer end.
 Stubs are laid with a rise of 1/8" per foot.

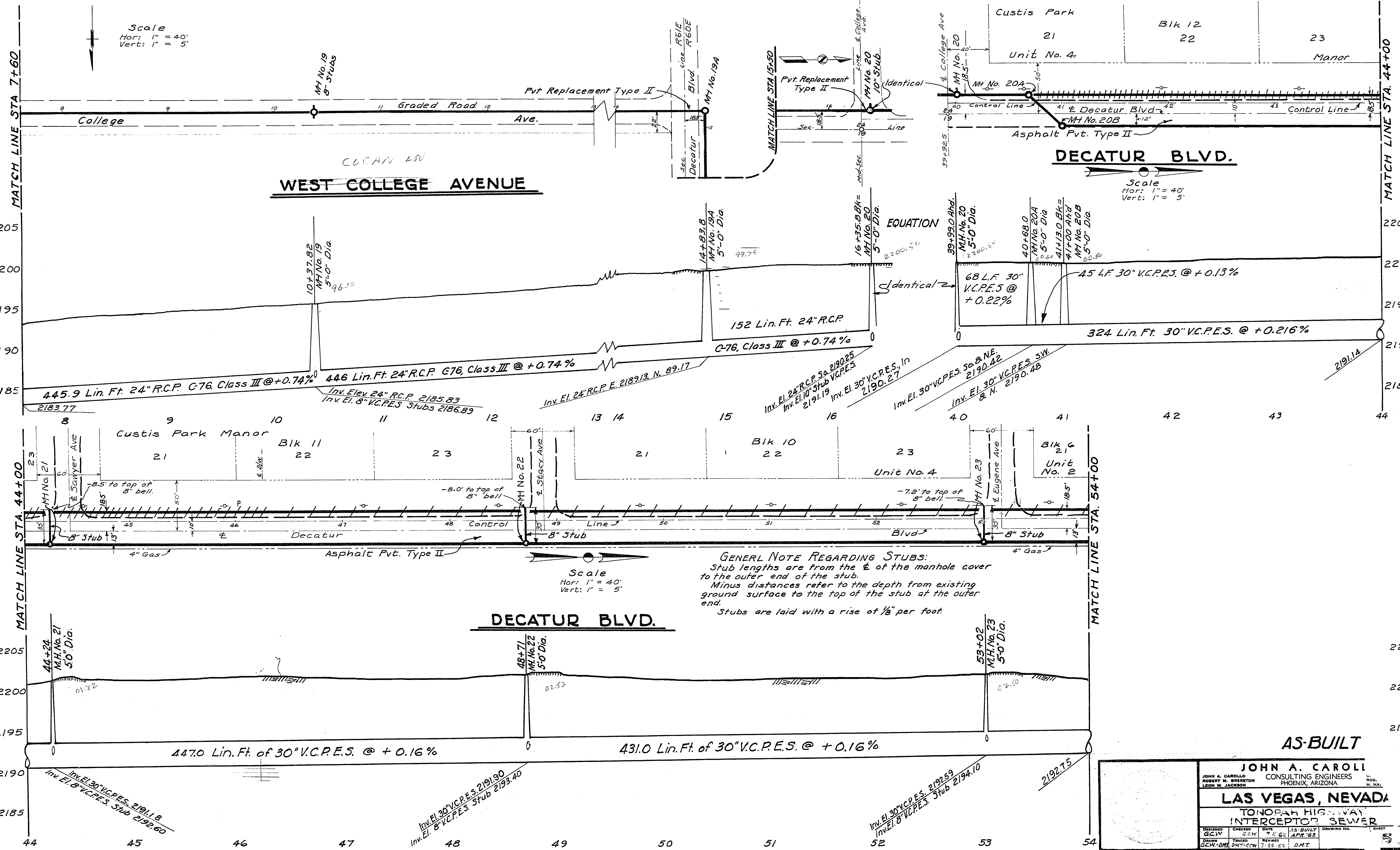

AS-BUILT

JOHN A. CAROLI
 CONSULTING ENGINEERS
 PHOENIX, ARIZONA

LAS VEGAS, NEVADA

TONOPAH HIGHWAY INTERCEPTOR SEWER

| | | | | | |
|------------------|-------------------|--------------------|---------------------|-------------|-------|
| DESIGNED GCW | CHECKED GCW | DATE 7.1.62 | AS-BUILT APR. 63 | DRAWING NO. | SHEET |
| DRAWN GCW-DMT | TRACED DMT-SCW | REVISED 7.25.63 | DMT | | |