

DECATUR BOULEVARD
(PUBLIC)

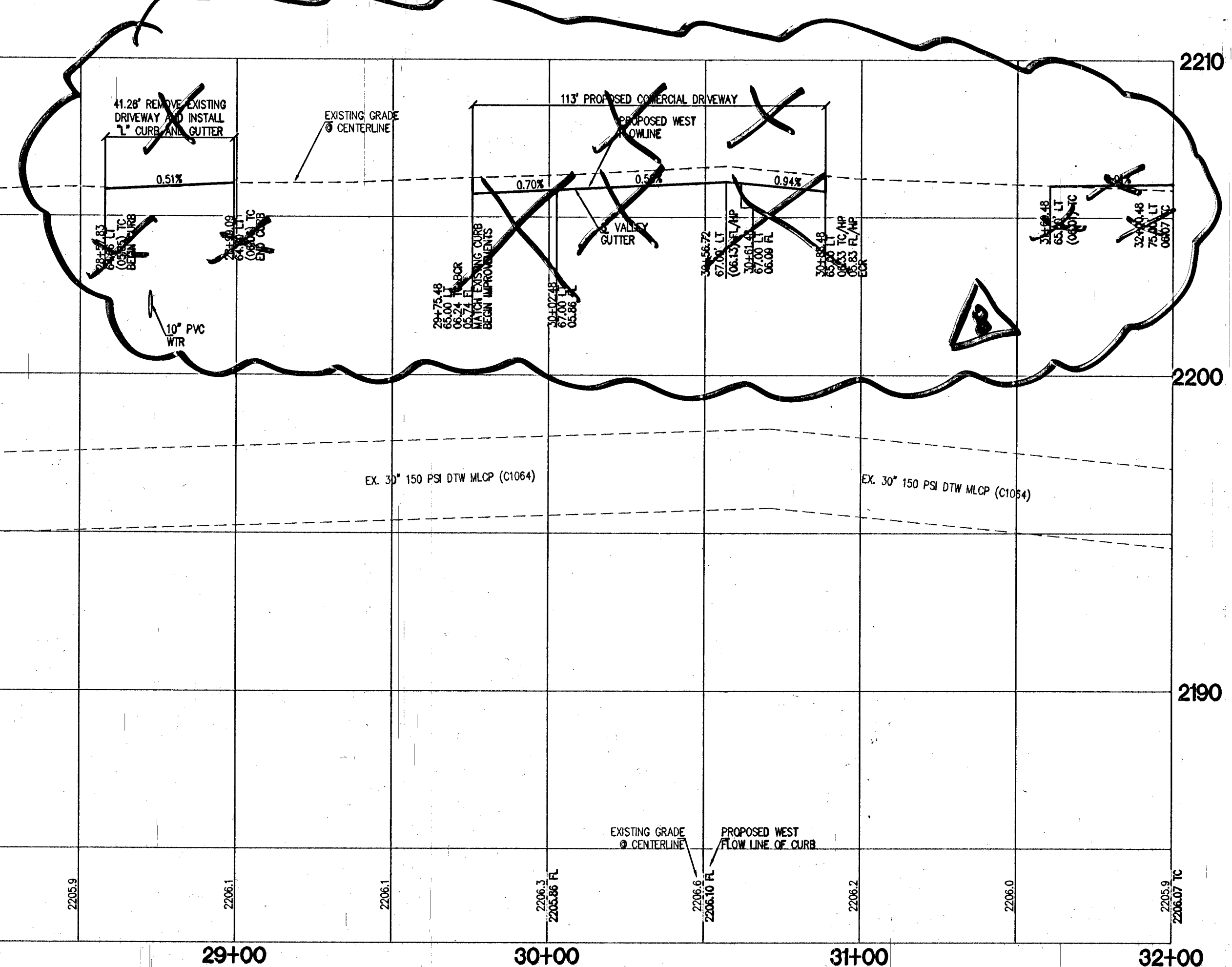

PROFILE
HORIZONTAL SCALE: 1"=30'
VERTICAL SCALE: 1"=3'

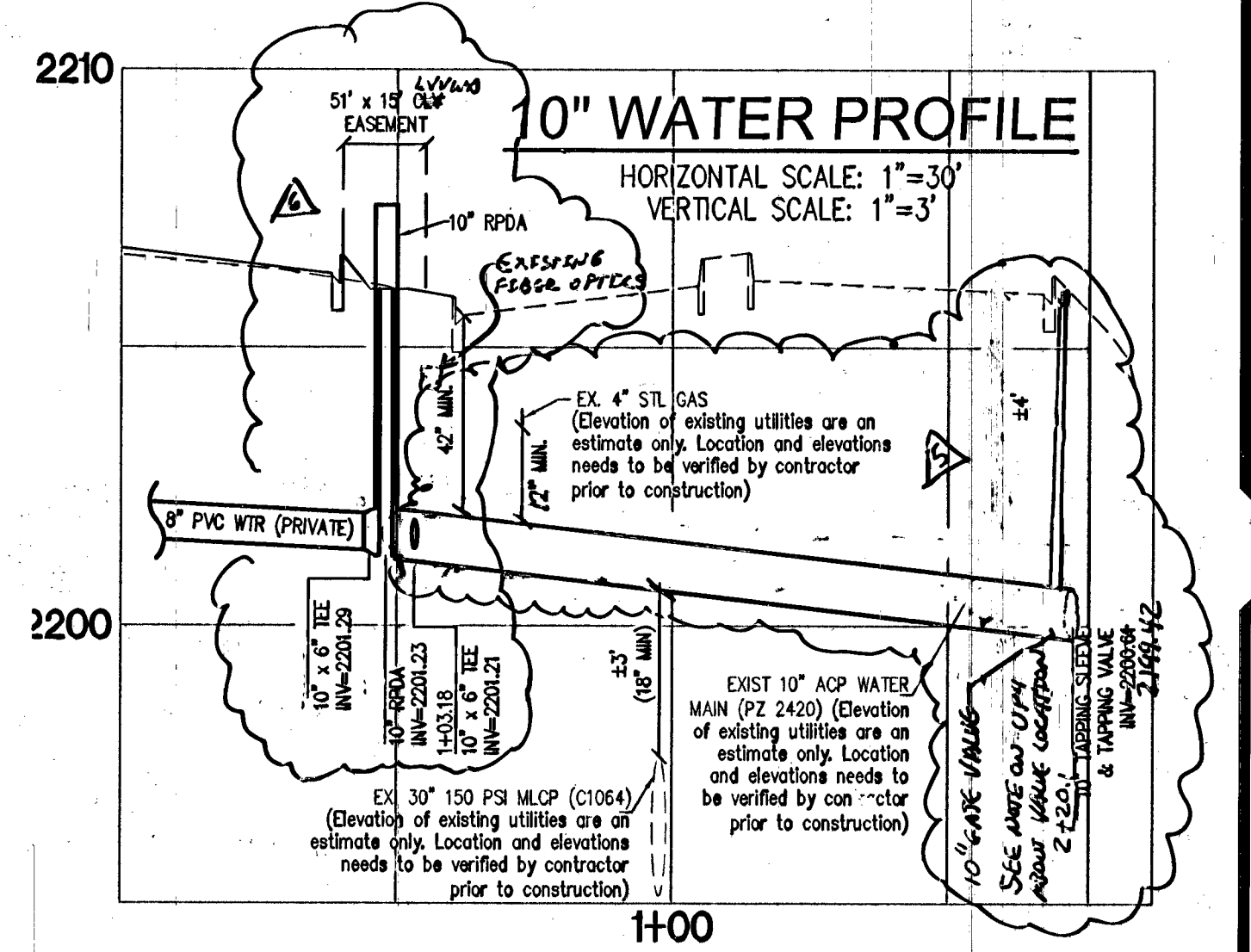

LINE TABLE

LINE	LENGTH	BEARING
L1	51.98	N09°29'54"E
L2	80.00	N00°42'34"W
L3	28.48	S77°42'28"E
L4	197.48	N00°42'34"W
L5	191.88	S00°42'34"E
L6	112.98	N00°42'34"W

CURVE TABLE

CURVE	LENGTH	RADIUS	DELTA	TANGENT
C1	4.45	25.00	101°2'28"	2.23
C2	7.47	25.00	170°8'58"	3.78
C3	39.27	25.00	30°00'00"	23.00
C4	48.21	198.50	135°0'40"	24.22
C5	48.89	200.50	135°8'18"	24.57
C6	4.71	1.50	180°00'00"	INFINITE
C7	11.00	3.50	180°00'00"	INFINITE
C8	49.64	198.50	141°5'28"	24.95
C9	48.48	200.50	135°1'13"	24.38
C10	45.87	249.50	122°2'30"	22.90
C11	47.87	250.50	105°8'58"	24.01

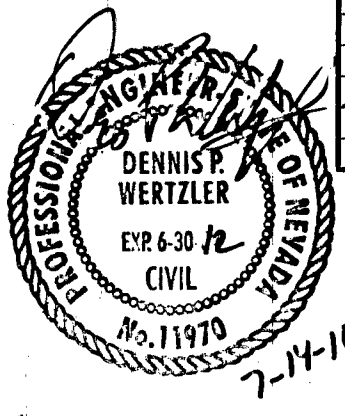

- CONSTRUCTION NOTES**
- CONSTRUCT "A" TYPE ISLAND CURB PER USD NO 219
 - CONSTRUCT "L" TYPE CURB PER USD NO 219
 - CONSTRUCT HEAVY DUTY COMMERCIAL DRIVEWAY PER STD DWG NO. 222A AND 223
 - CONSTRUCT SIDEWALK PER USD NO 234
 - CONSTRUCT SIDEWALK RAMPS USING APPROX 1:12
 - CONSTRUCT SIDEWALK UNDERDRAIN PIPE PER DETAIL ON SHEET D22
 - CONSTRUCT 2" WIDE CONCRETE FLOWLINE PER DETAIL SHEET D22
 - CONSTRUCT 2" VALLEY GUTTER PER DETAIL ON SHEET D22
 - CONSTRUCT TRASH ENCLOSURE PER ARCHITECTURAL
 - CONSTRUCT PARKING PAVEMENT PER DETAIL ON SHEET D22
 - CONSTRUCT TRUCK PAVEMENT PER DETAIL ON SHEET D22
 - CONSTRUCT SIDEWALK UNDERDRAIN PER USD NO 238
 - CONSTRUCT SIDEWALK UNDERDRAIN PIPE PER DETAIL ON SHEET D22
 - CONSTRUCT 2" TYPE CURB PER USD NO 219
 - CONSTRUCT 6" CURB PER DETAIL ON SHEET D22
 - TRANSITION FROM 6" CURB TO 6" CURB
 - CONSTRUCT PRECAST BUMPER BLOCK PER USD NO 238
 - WHERE MATCHING EXISTING IMPROVEMENTS TO THE SAWCUT DETERMINED BY A CIVIL CONSTRUCTION SERVICES
 - INSPECT BLOCK WALL OPENING PER DETAIL ON SHEET D22
 - CONSTRUCT PRIVATE ONSITE SIDEWALK RAMPS PER USD NO 244
 - CONSTRUCT CROSSWALK PAVEMENT PER DETAIL ON SHEET D22
 - CONSTRUCT SCOFFED, HD-100 SERIES, LITHOSCAPE DRAINAGE SYSTEM WITH MESH GRATING OR EQUIVALENT
 - CONSTRUCT COMMERCIAL DRIVEWAY PER USD 224

APPROVAL:
Dennis P. Wertzler
DATE: 8/20/10

LEGEND:

FINISH FLOOR ELEVATION: 05.50
PAD ELEVATION: 03.7
BOUNDARY: [Symbol]
RIGHT OF WAY: [Symbol]
FLOWLINE: [Symbol]
EXISTING CONTOUR: [Symbol]
PROPOSED CONTOUR: [Symbol]
ADA ACCESS ROUTE: [Symbol]
ELEVATION: 3.60
EDGE OF PAVEMENT: [Symbol]
PAVEMENT TO BE SAWCUT AND REMOVED: [Symbol]

ABBREVIATIONS:

LSA LANDSCAPE AREA
ADI AREA DRAIN INLET
ER END RETAINING CONDITION
FD FINISH GRADE
FL FLOW LINE
GB GRADE BREAK
HP HIGH POINT
H RETAINING WALL HEIGHT

SD STORM DRAIN
TC TOP OF CURB
FP FLOWLINE
TRC TOP OF ROLL CURB
TW TOP RETAINING WALL
VG VALLEY GUTTER

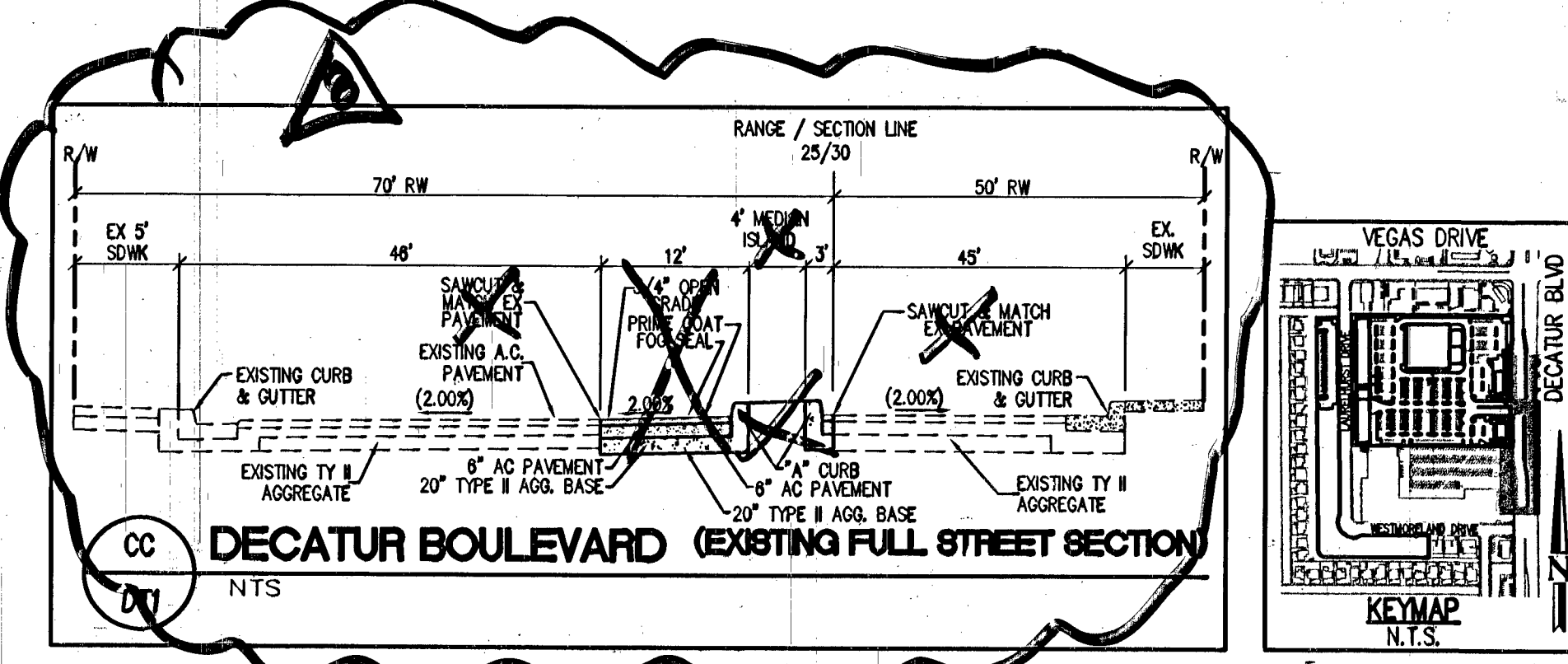

DECATUR BOULEVARD
(EXISTING FULL STREET SECTION)

DISCLAIMER NOTE:
UTILITY LOCATIONS SHOWN HEREON ARE APPROXIMATE ONLY. IT IS THE RESPONSIBILITY OF THE CONTRACTOR TO DETERMINE THE EXACT HORIZONTAL AND VERTICAL LOCATION OF ALL EXISTING UNDERGROUND AND OVERHEAD UTILITIES PRIOR TO COMMENCING CONSTRUCTION. NO ASSURANCE IS MADE THAT ALL EXISTING UTILITIES ARE SHOWN HEREON. THE ENGINEER ASSUMES NO RESPONSIBILITY FOR UTILITIES NOT SHOWN OR UTILITIES NOT NOTICED BY ANY CHANGES OR DISCREPANCIES.

Call before you Overhead
1-702-593-8111

Call before you Dig
811 or 1-800-227-2600

Call before you UnderGround
1-702-229-6611

BENCHMARK:
CITY OF LAS VEGAS BENCHMARK STATION - OLVD1 195WS
RIVET AND PLATE IN TOP OF CURB AT THE NORTHEAST CORNER OF DECATUR BLVD. AND VEGAS DRIVE.
ELEVATION = 871.5760 meters (NAVD'88 PUBLISHED)
ELEVATION = 2203.33 U.S. SURVEY FEET (NAVD'88 PUBLISHED)

BASIS OF BEARINGS:
NORTH 89°57'54" EAST, BEING THE BEARING OF THE NORTH LINE OF THE NORTHEAST QUARTER (NE 1/4) OF THE NORTHEAST QUARTER (NE 1/4) OF SECTION 28, TOWNSHIP 20 SOUTH, RANGE 18 EAST, 11TH MERIDIAN, CLARK COUNTY, NEVADA, AS SHOWN ON THAT CERTAIN MAP ON FILE IN THE CLARK COUNTY RECORDER'S OFFICE IN FILE # OF SURVEYS, AT PAGE 16.

APPROVED: [Signature]
DATE: 8/20/10

REVISION:

REV	DESCRIPTION
1	Revised from Location Review Meeting, 8/18/10
2	Added notes to sheet, 8/20/10
3	Added notes to sheet, 8/20/10
4	Added notes to sheet, 8/20/10
5	Added notes to sheet, 8/20/10
6	Added notes to sheet, 8/20/10
7	Added notes to sheet, 8/20/10
8	Added notes to sheet, 8/20/10
9	Added notes to sheet, 8/20/10
10	Added notes to sheet, 8/20/10

ALPHA OMEGA STRATEGIES
4908 CARMEN BOULEVARD, LAS VEGAS, NEVADA 89108
PHONE: (702) 810-9002 FAX: (702) 933-0017

DRC Development Resource Consultants, Inc.
Civil Engineering - Land Surveying - Land Planning
9330 WEST MARTIN AVENUE
LAS VEGAS, NV 89148
PHONE: (702) 270-6119 - FAX: (702) 270-4899

THE RESIDENCES @ VILLAGE SQUARE

DECATUR BLVD PLAN & PROFILE 1

H.2.9.9.88

DRAWN BY: BWD
DESIGNED BY: CVC
CHECKED BY: DPW
PROJECT NO: LV07-537

DENNIS P. WERTZLER
CIVIL ENGINEER
No. 11970

PP1
9 OF 29 SHEETS
DRAWING NO. 107Y4973