

SEE SHEET GP1 FOR CONTINUATION

SEE SHEET GP4 FOR CONTINUATION

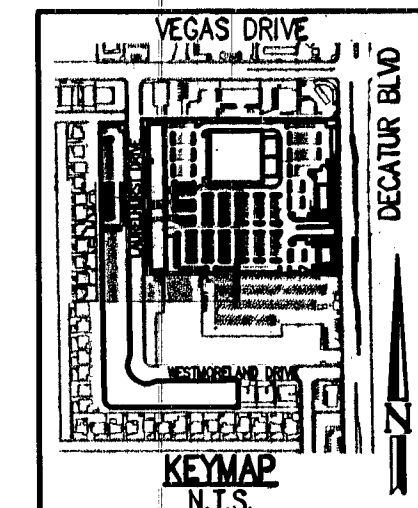
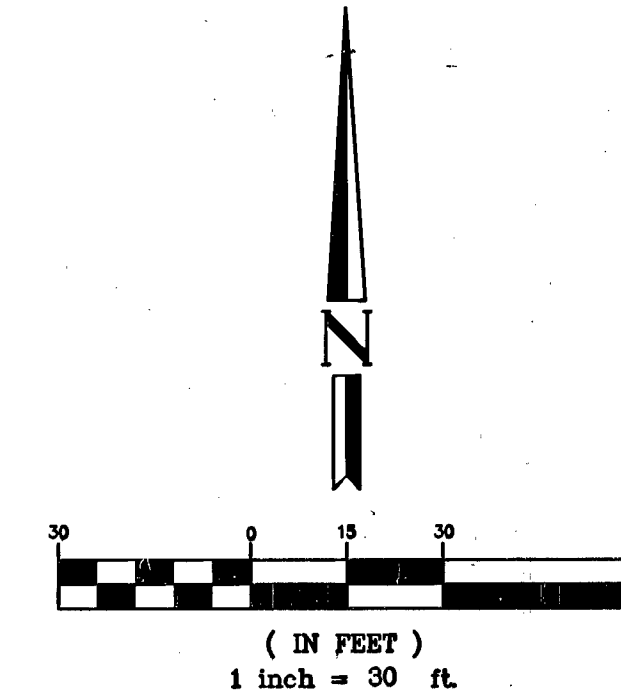
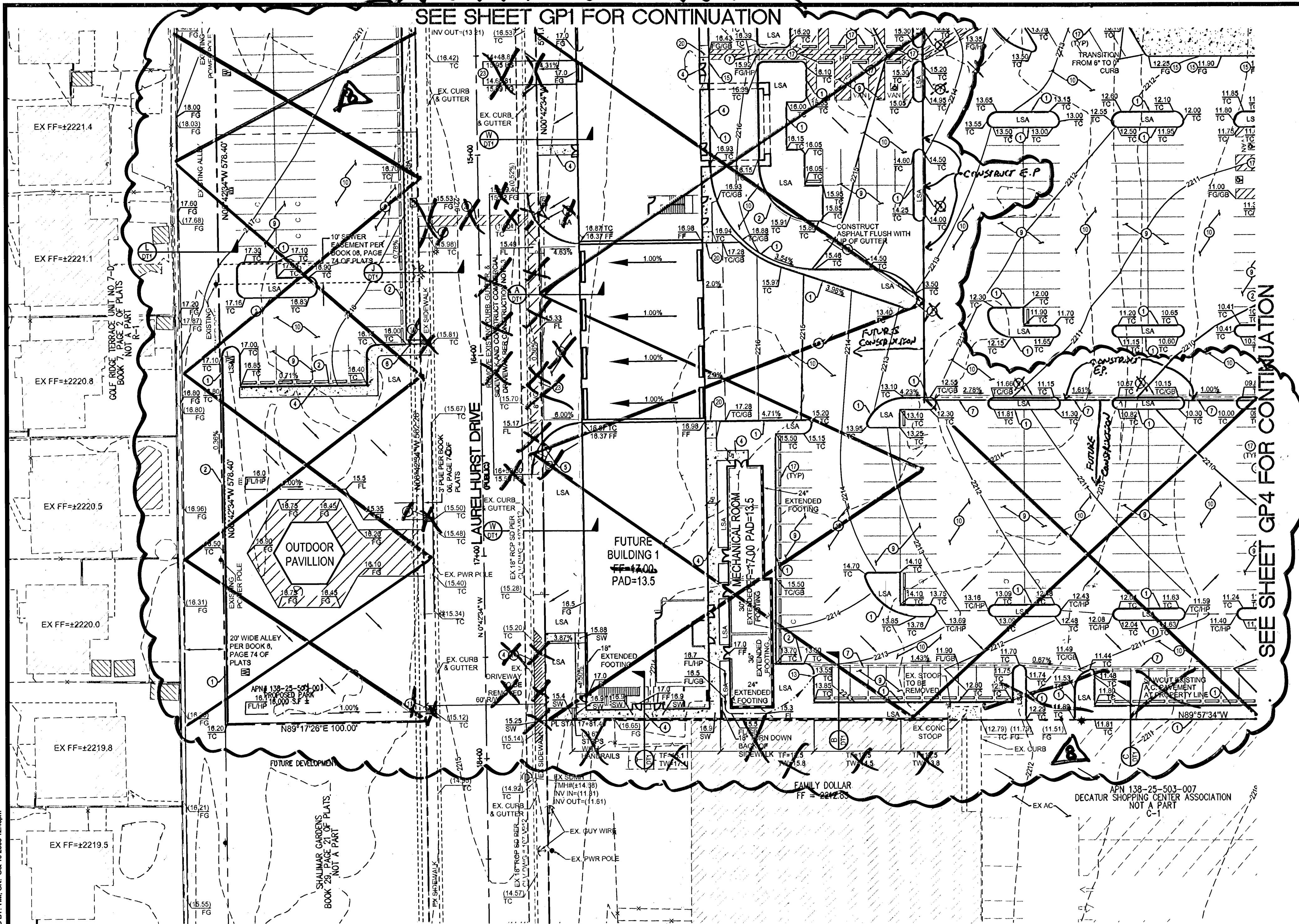

REV	REVISION	DATE	APPROVED BY

ALPHA OMEGA STRATEGIES
 4808 CARMEN BOULEVARD, LAS VEGAS, NEVADA 89108
 PHONE: (702) 810-9002
 FAX: (702) 933-0017

DRC
 Development Resource Consultants, Inc.
 Civil Engineering • Land Surveying • Land Planning
 9300 WEST MARTIN AVENUE
 LAS VEGAS, NV 89148
 PHONE (702) 726-6119 - FAX (702) 270-4889

- ENGINEER'S NOTES:**
- SEE SHEET NT FOR ADDITIONAL NOTES, LEGEND AND QUANTITY ESTIMATE.
 - ALL DIMENSIONS TO CURB ARE TO THE FACE OF CURB ON-SITE AND BACK OF CURB OFF-SITE, UNLESS OTHERWISE NOTED.
 - THE PROPOSED A.C. GRADES ARE 0.5' LOWER THAN THE TOP OF CURB GRADES UNLESS OTHERWISE NOTED.
 - CONTRACTOR IS RESPONSIBLE FOR DUST AND EROSION CONTROL DURING CONSTRUCTION.
 - CONTRACTOR RESPONSIBLE FOR ADHERING TO ALL ADA PROVISIONS.
 - THE CONTRACTOR SHALL VERIFY THE VERTICAL AND HORIZONTAL LOCATION OF ALL EXISTING UTILITIES AND SURFACE FEATURES PERTINENT TO THIS PROJECT PRIOR TO CONSTRUCTION.
 - CONTRACTOR TO VERIFY FINISH FLOOR TO PAD DIFFERENCE WITH STRUCTURAL PLANS AND SOILS REPORT PRIOR TO GRADING. NOTIFY ENGINEER IF SECTION IS DIFFERENT THAN SHOWN ON THESE PLANS.
 - SEE LANDSCAPE PLANS FOR LANDSCAPING, DETAILED Hardscape INFORMATION, AND ON-SITE IRRIGATION.
 - SEE ARCHITECTURAL PLANS DETAILS OF BUILDING, EXTENDED FOOTINGS, STEM WALLS, AND TRASH ENCLOSURE DESIGN.
 - THESE PLANS SHALL NOT, IN PART OR IN WHOLE, BE USED FOR CONSTRUCTION UNTIL APPROVED AND SIGNED BY THE GOVERNING AGENCIES.
 - NOTIFY ENGINEER OF ANY DISCREPANCIES IMMEDIATELY.
 - ALL WORK SHALL CONFORM WITH THE SOILS REPORT PREPARED BY TERRACON CONSULTANTS, INC. PROJECT: 04075104 DATED: JANUARY 25, 2008 REVISED: APRIL 2, 2008
 - ESTIMATED EARTHWORK QUANTITIES:
 CUT: 13,983 CY (UNADJUSTED)
 FILL: 2,690 CY (UNADJUSTED)

FEMA FLOOD HAZARD ZONE NOTE:
 THE SPECIAL FLOOD HAZARD AREAS FOR CLARK COUNTY, NEVADA ARE OUTLINED IN THE FEDERAL EMERGENCY MANAGEMENT AGENCY (FEMA) FLOOD INSURANCE RATE MAP (FROM DATED SEPTEMBER 27, 2002, REVISED TO REFLECT LATE MAINT DECISIONS) AND ACCORDING TO THE FEMA FLOOD COMMUNITY PANEL NUMBER 3200321255 & 3200321850. THE SITE IS LOCATED IN A "ZONE X" ZONE 3, DESCRIBED AREAS DETERMINED OUTSIDE THE 0.2% ANNUAL CHANCE FLOOD PLAIN.

BENCHMARK:
 CITY OF LAS VEGAS BENCHMARK STATION - OLVD1195W
 BRET AND PLATE IN TOP OF CURB AT THE NORTHEAST CORNER OF DECATUR BLVD. AND VEGAS DRIVE.
 ELEVATION = 671.576 meters (NAV'D88 PUBLISHED)
 ELEVATION = 2203.33 U.S. SURVEY FEET (NAV'D88 PUBLISHED)

BASIS OF BEARINGS:
 NORTH 89°57'34" EAST, BEING THE BEARING OF THE NORTH LINE OF THE NORTHEAST QUARTER (NE 1/4) OF THE NORTHEAST CORNER (NE 1/4) OF SECTION 25, TOWNSHIP 20 SOUTH, RANGE 12 EAST, COUNTY OF CLARK, NEVADA, AS SHOWN ON THAT CERTAIN MAP ON FILE IN THE CLARK COUNTY RECORDER'S OFFICE IN FILE 4 OF SURVEYS, AT PAGE 18.

VERIFY THAT THIS GRADING PLAN IS IN CONFORMANCE WITH THE APPLICABLE ORDINANCES AND REGULATIONS OF THE CITY OF LAS VEGAS FOR THIS PROJECT, DS 4309
 Dennis P. Wertzler, P.E. No. 11970
 11/16/08 DATE

NOTE:
 NO STRUCTURE, VEGETATION, OR OBJECT OF ANY KIND IS PERMITTED OVER TWENTY-FOUR (24) INCHES IN HEIGHT (MEASURED FROM THE TOP OF THE ADJACENT CURB IF CURB EXISTS) WITHIN THE SIGHT VISIBILITY ZONES.

ADA NOTE:
 ALL SIDEWALKS AND HANDICAP ACCESS RAMP SHALL MEET ADA REQUIREMENTS. CONTRACTOR SHALL NOTIFY THE ENGINEER OF ANY DISCREPANCIES BETWEEN DESIGN INFORMATION AND ADA REQUIREMENTS PRIOR TO CONSTRUCTION.

No.	GRADE (ft)	AREA (sq ft)	TYPE	P.T.
(1)	-6 TO -5.01	4.5'	21.5'	
(2)	-5 TO -4.01	4.5'	15.0'	
(3)	-4 TO -3.01	4.5'	12.0'	
(4)	-3 TO -2.01	4.5'	9.5'	
(5)	-2 TO 2	8.0'	8.0'	
(6)	2.01 TO 3	9.5'	4.5'	
(7)	3.01 TO 4	12.0'	4.5'	
(8)	4.01 TO 5	15.0'	4.5'	
(9)	5.01 TO 6	21.5'	4.5'	

SIDEWALK RAMP:
 PER STD. DWG. NO. 235 - CASE 1

LEGEND:

FINISH FLOOR ELEVATION	FF=05.50
PAD ELEVATION	PAD=03.7
BOUNDARY / RIGHT OF WAY	---
CENTER LINE	---
FLOWLINE	---
EXISTING CONTOUR	(42)
PROPOSED CONTOUR	42
CONCRETE	---
ADA ACCESS ROUTE	---
ELEVATION	3.60
EDGE OF PAVEMENT	---
PAVEMENT TO BE SAWCUT AND REMOVED & EXISTING MEDIAN ISLAND TO BE REMOVED	---

ABBREVIATIONS:

ADI AREA DRAIN INLET	SD STORM DRAIN
ER END RETAINING CONDITION	TC TOP OF CURB
FG FINISH GRADE	TOF TOP OF FOOTING
FL FLOW LINE	TOG TOP OF GRATE
GB GRADE BREAK	TRC TOP OF ROLL CURB
HP HIGH POINT	TW TOP RETAINING WALL
HR RETAINING WALL HEIGHT	VG VALLEY GUTTER
LSA LANDSCAPE AREA	

- CONSTRUCTION NOTES:**
- CONSTRUCT "A" TYPE ISLAND CURB PER USD NO 219
 - CONSTRUCT "L" TYPE CURB PER USD NO 219
 - CONSTRUCT HEAVY DUTY COMMERCIAL DRIVEWAY PER STD DWG NO 228 WITH GEOMETRICS OF STD DWG NO. 222A AND 222B
 - CONSTRUCT SIDEWALK PER USD NO 234
 - CONSTRUCT SIDEWALK RAMPS USING ARMOR TILE
 - TRUNCATED DOMES OR EQUIVALENT PER OCAUSD NO. 235 - CASE 1
 - CONSTRUCT 2" WIDE CONCRETE FLUME PER DETAIL SHEET DT2
 - CONSTRUCT 2" VALLEY GUTTER PER DETAIL ON SHEET DT2
 - CONSTRUCT TRASH ENCLOSURE PER ARCHITECTURAL
 - CONSTRUCT PARKING PAVEMENT PER DETAIL ON SHEET DT2
 - CONSTRUCT TRUCK PAVEMENT PER DETAIL ON SHEET DT2
 - CONSTRUCT SIDEWALK UNDERDRAIN PER USD NO 238
 - CONSTRUCT SIDEWALK UNDERDRAIN PIPE PER DETAIL ON SHEET DT2
 - 24" CURB OPENING PER DETAIL ON SHEET DT2
 - CONSTRUCT "L" TYPE CURB PER USD NO 219
 - CONSTRUCT "O" CURB PER DETAIL ON SHEET DT2
 - TRANSITION FROM 0" CURB TO 6" CURB
 - CONSTRUCT PRECAST BUMPER BLOCK PER USD NO 238 WHERE MATCHING EXISTING IMPROVEMENTS THE SAWCUT LINES AND LIMITS OF A.C. REMOVAL SHALL BE DETERMINED BY A CLV CONSTRUCTION SERVICES INSPECTOR
 - CONSTRUCT BLOCK WALL OPENING PER DETAIL 8 ON SHEET DT2
 - CONSTRUCT PRIVATE ONSITE SIDEWALK RAMPS PER DETAIL 7 ON SHEET ADA1
 - CONSTRUCT CROSSWALK PAVEMENT MARKINGS PER USD NO 254A
 - INSTALL SCOFFLED, HD-100 SERIES, LITHOSCAPE DRAINAGE SYSTEM WITH MESH GRATING OR EQUIVALENT.
 - CONSTRUCT COMMERCIAL DRIVEWAY PER USD 224

DISCLAIMER NOTE:
 UTILITY LOCATIONS SHOWN HEREON ARE APPROXIMATE ONLY. IT SHALL BE THE CONTRACTOR'S RESPONSIBILITY TO DETERMINE THE EXACT LOCATION AND DEPTH OF ALL EXISTING UNDERGROUND OR OVERHEAD UTILITIES OF ALL COMMON AND PRIVATE UTILITIES ARE SHOWN IN THEIR PROPER LOCATION. CONTRACTOR TO NOTIFY ENGINEER OF ANY CHANGES OR DISCREPANCIES.

Avoid overhead power line contact, it's costly.
 Avoid cutting underground utility lines, it's costly.

Call before you Overhead
 1-702-593-8111
 NEVADA POWER ENVIRONMENT AND SAFETY SERVICES DEPARTMENT

Call before you Dig
 811 or 1-800-227-2600

Call before you UnderGround
 1-702-229-6611
 F.A.S.T.

THE RESIDENCES @ VILLAGE SQUARE

H29988

GRADING PLAN 3

DRAWN BY: BWD
 DESIGNED BY: CWC
 CHECKED BY: DPW
 PROJECT NO: LV07-537

DENNIS P. WERTZLER
 CIVIL ENGINEER
 No. 11970

SHEET **GP3**
 5 OF 29 SHEETS
 DRAWING NO. 1074973