

NOTE
INSTALL PIPELINE MARKER BALLS IN TRENCH ABOVE EACH HORIZONTAL ELBOW FITTING, PER MANUFACTURER INSTRUCTIONS.

PASEO MIST DRIVE SPOKE 'A'
SCALE: HORIZ. 1" = 20'
VERT. 1" = 5'
REFER TO SHEET 2 FOR CONSTRUCTION NOTES

NOTE
THIS SET OF DRAWINGS IS BASED UPON NAVD 88 DATUM. PREVIOUS DRAWINGS MAY BE BASED ON OTHER DATUM. CARE SHOULD BE OBSERVED WHEN UTILIZING THIS SET OF DRAWINGS.

Avoid cutting underground utility lines. It's costly.
Call before you Dig.
1-800-227-2600
UNDERGROUND SERVICE ALERT (USA)

Avoid hitting overhead power lines. It's costly.
CALL BEFORE YOU DO OVERHEAD
CALL 1-702-593-6111

APPROVAL:
LAS VEGAS VALLEY WATER DISTRICT
DATE: 9/11/02

BENCHMARK			
CLV BM NO.	DESC.	NAVD 88 DATUM	NAVD 88 DATUM
D368 3	U.S.C. & G.S. BRASS DISC SET IN ROCK ON THE EAST SIDE OF CHARLESTON BOULEVARD AND SOUTH OF THE RED ROCK DETENTION BASIN.	3246.71 (FEET)	989.599 (METERS)

BASIS OF BEARINGS
NORTH 89°45'05" EAST BEING THE SOUTH LINE OF THE SOUTHWEST QUARTER (SW 1/4) OF SECTION 35, TOWNSHIP 20 SOUTH, RANGE 59 EAST, M.D.M., AS SHOWN BY MAP ON FILE IN FILE 91, PAGE 28 OF PARCEL MAPS IN THE CLARK COUNTY RECORDER'S OFFICE, CLARK COUNTY, NEVADA

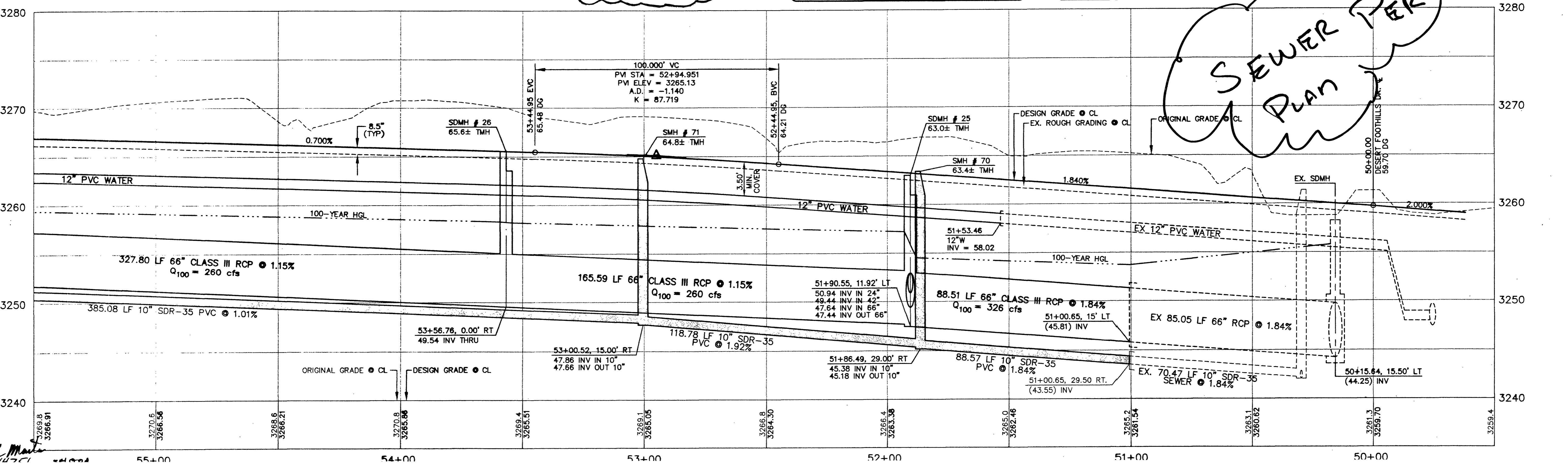

SEWER PLAN

DESIGN: JJJ
DRAWN: SSC
CHECK: GBW
ISSUE DATE: 7/15/02
PLOT DATE: 08-22-02
PLOT TIME: 19:26:17

G.C. WALLACE, INC.
Engineers/Planners/Surveyors
1555 SOUTH RAINBOW BLVD./LAS VEGAS, NEVADA 89148
SUMMERLIN OFFICE: 10000 CHARLESTON BLVD., STE. 130
OFFICE: (702) 804-2180, FAX: (702) 804-2295
E:\V23\Unit 1\Draw\23A15028.dwg

SUMMERLIN
VILLAGE 23A UNIT 1 IMPROVEMENTS
PASEO MIST DRIVE
SPOKE 'A' PLAN AND PROFILE
STA 66+60 TO END

SHEET 29
JOB NO. 6202321