

REVISION	BY	DATE	REV
REV. SEWER THEY EASEMENT	PJS	7-14-88	1

ES/ENGINEERS & ARCHITECTS INC.	PAUL E. VALENTI
REGISTERED PROFESSIONAL ENGINEER	CIVIL
705 W. CHANDLER AVENUE	STATE OF NEVADA
SPRINGFIELD, NEVADA 89117	

705 W. CHANDLER AVENUE
SPRINGFIELD, NEVADA 89117
REGISTERED PROFESSIONAL ENGINEER
CIVIL
STATE OF NEVADA
PAUL E. VALENTI
SUBMITTED BY:

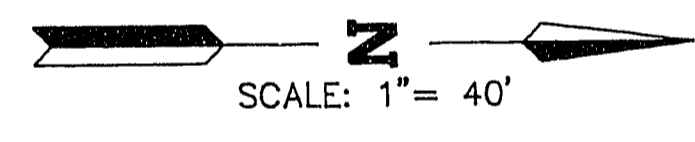

BENCHMARK
 CLARK COUNTY BENCHMARK NO. C105W04:
 RAILROAD SPIKE AT INTERSECTION OF SAHARA AVENUE AND DURANGO DRIVE.
 ELEVATION: 2659.63'
 (C.C. DATUM -1.04 = C.L.V. DATUM)

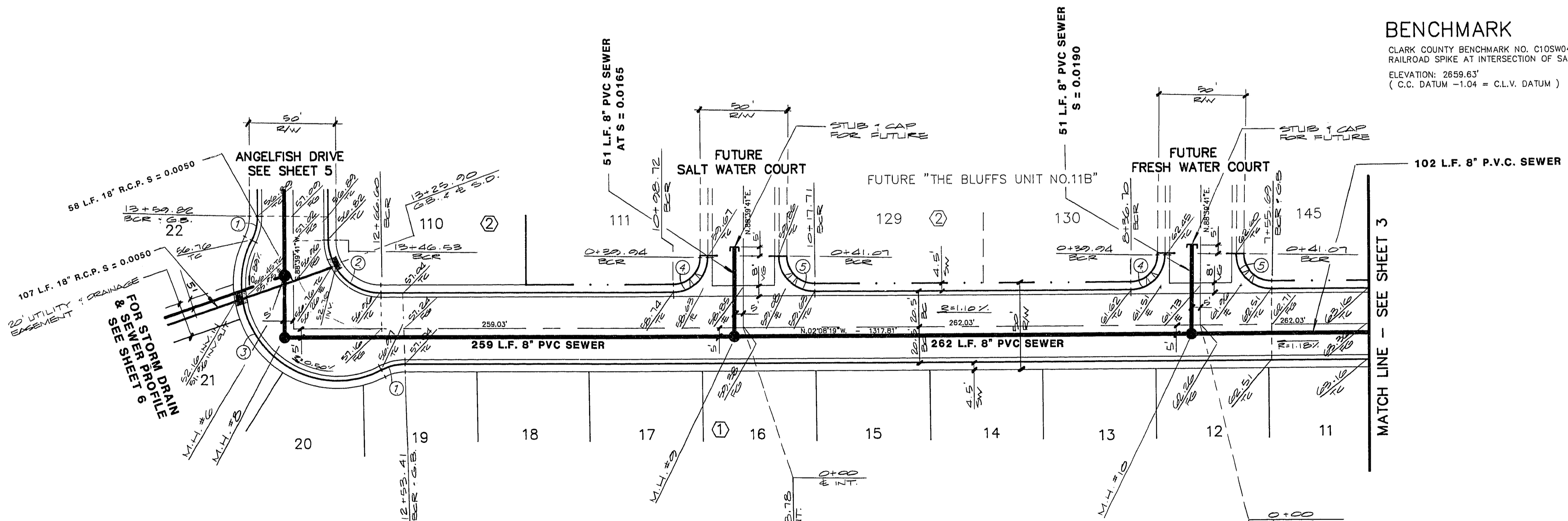

CURVE DATA TABLE

CURVE	RADIUS	LENGTH	TANGENT	DELTA
1	30.00'	14.32'	7.30'	27°20'53"
2	30.00'	47.54'	30.42'	90°48'00"
3	55.00'	139.57'	172.10'	145°29'43"
4	28.00'	31.14'	19.72'	89°14'00"
5	28.00'	31.70'	20.28'	90°48'00"

QUANTITY ESTIMATE

2.0" ASPHALTIC CONCRETE PAVING	2,834 S.F.
30"ROLL" TYPE CURB & GUTTER	1,189 L.F.
CONCRETE VALLEY GUTTER	1,200 S.F.
CONCRETE SIDEWALK	5,854 S.F.

OCEAN PORT DRIVE

TITLE
STREET & SEWER PLAN & PROFILE
 (OCEAN PORT DRIVE - STA.7+00 TO STA.13+17.81)

PROJECT
THE BLUFFS UNIT NO.11A

WO NO.	4088A
BY	P. CHAO
DATE	5/88
SCALE	HORIZ. 1" = 40' VERT. 1" = 4'

SHEET
4
 OF 14 SHEETS

101-13 107X-911-11A