

BACK OF CURB CURVE TABLE

CURVE	RADIUS	DELTA	ARC	CHORD	TANGENT
C3	15.00	90°00'00"	23.56	21.21	15.00
C4	5.00	90°00'00"	7.85	7.07	5.00
C5	5.00	85°41'40"	7.48	6.80	4.64
C6	5.00	106°32'05"	9.30	8.01	6.70
C7	5.00	90°04'40"	7.86	7.08	5.01
C8	2.00	129°44'13"	4.53	3.62	4.26
C9	5.00	90°00'00"	7.85	7.07	5.00
C10	8.14	90°00'00"	12.79	11.51	8.14
C11	3.00	70°21'28"	3.68	3.46	2.11
C12	3.00	109°38'32"	5.74	4.90	4.26
C13	3.00	103°55'29"	5.44	4.73	3.83
C14	25.00	48°22'45"	21.11	20.49	11.23
C15	5.00	117°41'55"	10.27	8.56	8.27
C16	5.00	90°00'00"	7.85	7.07	5.00
C19	20.00	82°18'05"	21.75	20.69	12.09
C20	5.00	90°00'00"	7.85	7.07	5.00
C21	20.00	90°00'00"	31.42	28.28	20.00
C22	20.00	79°14'48"	27.66	25.51	16.56
C23	25.00	50°12'29"	21.91	21.21	11.71
C24	25.00	16°04'16"	7.01	6.99	3.53

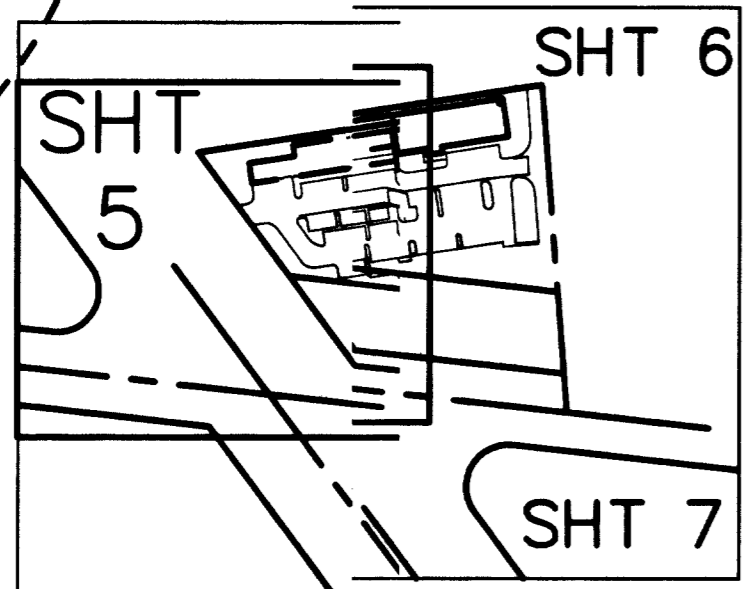

EASEMENTS / RIGHT OF WAYS

- Ⓐ 10' WIDE SOUTHERN NEVADA POWER COMPANY EASEMENT BOOK 82 INSTRUMENT 68441 RECORDED ON JANUARY 27, 1956.
 - Ⓑ 5' WIDE WATER LINE EASEMENT AS SHOWN ON PARCEL MAP FILE 34 PAGE 83.
 - Ⓒ 20' PRIVATE ROAD AS SHOWN ON PARCEL MAP FILE 34 PAGE 83.
 - Ⓓ NON-EXCLUSIVE RIGHT OF WAY AND EASEMENT FOR A WATER LINE BOOK 970204 INSTRUMENT 0070 RECORDED ON FEBRUARY 4, 1997.
 - Ⓔ NON-EXCLUSIVE RIGHT OF WAY AND EASEMENT FOR EGRESS & INGRESS BOOK 970204 INSTRUMENT 0070 RECORDED ON FEBRUARY 4, 1997.
 - Ⓕ CENTRAL TELEPHONE COMPANY RIGHT OF WAY BOOK 524 INSTRUMENT 421759 RECORDED ON MARCH 24, 1984 FOR ROAD & EGRESS & INGRESS PER A MAP ON FILE IN FILE 34, PAGE 83 OF PARCEL MAP.
 - Ⓖ 20' PRIVATE ROAD PER ASSESSOR'S MAP, NO DOCUMENT FOUND.
 - Ⓗ EASEMENT FOR INGRESS, EGRESS, PARKING, & UTILITIES BOOK 20070212 INSTRUMENT 1231, RECORDED FEB. 1, 2007.
- PROPERTY IS ALSO SUBJECT TO:
- 20' WIDE BELL TELEPHONE RIGHT OF WAY RECORDED IN BOOK 31 PAGES 80-81 DOCUMENT 145033 DATED JULY 13, 1942; LOCATION NOT DESCRIBED.

BASIS OF BEARINGS

SOUTH 83°40'36" EAST, BEING THE SOUTH LINE OF THE SW 1/4 OF SECTION 35, T. 19 S., R. 80 E. M.D.M., CITY OF LAS VEGAS, CLARK COUNTY, NEVADA PER A MAP ON FILE IN FILE 34, PAGE 83 OF PARCEL MAP.

BENCHMARK

CITY OF LAS VEGAS BENCHMARK 11990 34SES, BEING A RIVET AND PLATE IN TOP OF CURB, NORTHWEST CORNER OF LONE MOUNTAIN AND RAINBOW. ELEV.=707.0461 METERS (2319.70 FEET)

VERTICAL CONTROL JUNE 2002, BY WESCO SURVEYS, INC. DATED 2/28/06. RED

LEGEND

- CL --- CENTERLINE
- R/W --- RIGHT-OF-WAY
- BFE --- BASE FLOOD ELEVATION
- FG --- FINISH GRADE
- FL --- FLOW LINE
- EX --- EXISTING
- BCR --- BEGIN CURVE RETURN
- TC --- TOP OF CURB
- PT --- POINT OF TANGENCY
- B/C --- BACK OF CURB
- FF --- FINISH FLOOR
- S.V.R.Z. --- SITE VISIBILITY RESTRICTION ZONE (24' MAX. HEIGHT IN ZONE)

REFERENCE

- APN 125-35-401-006
- C2 (GENERAL COMMERCIAL) SD# 5190

LEGAL DESCRIPTION

FOR SW 1/4 SW 1/4 SEC. 35, T.19S., R.80E., M.D.M., CITY OF LAS VEGAS, CLARK COUNTY, NEVADA. LOT 2, PARCEL MAP FILE 34, PAGE 83 DEED 19970204:00070

FLOOD ZONE DESIGNATION

UN-SHADED FLOOD ZONE "X" COMMUNITY MAP NUMBER 32003 C 2155 E DATED DECEMBER 31, 2003

SOILS REPORT

TERRACON 64055169, DATED 1/24/06 (702) 597-9393 FAX 597-9009

SPECIAL NOTES

ALL EXISTING UTILITY STRUCTURES WITHIN CONSTRUCTION AREA SHALL BE ADJUSTED TO MATCH FINISH GRADE (I.E. W. BOX, W.M.H. ANNODE BOX, F.H. TEL. BOX, ETC.)

CONSTRUCTION NOTES

- 1 CONCRETE SIDE WALK PER SOILS REPORT
- 2 24" VALLEY GUTTER PER DETAIL #2, SHEET #13
- 3 AC PAVING PER SOILS REPORT
- 4 AUTO PARKING 2" AC / 4" TYPE II
- 5 MAIN CORRIDORS 3" AC / 4" TYPE II
- 6 "L" TYPE CURB & GUTTER PER STD DWG #216
- 7 "A" TYPE CURB & GUTTER PER STD DWG #219 (6" CURB FACE)
- 8 SAW CUT & MATCH EX. AC PAVING
- 9 8" CROSS GUTTER PER STD DWG #228
- 10 TRASH ENCLOSURE PER DETAIL ARCHITECTURAL DETAILS
- 11 SIDEWALK RAMP PER STD DWG #235 CASE 1 USING ARMOR PLATE TRUNCATED DORIES OR APPROVED EQUAL
- 12 CURVE # SLOPE "A" "B"
- 13 C21 0.03% 8.0 8.0
- 14 C22 0.69% 8.0 8.0
- 15 PLANTER
- 16 "A" TYPE CURB & GUTTER PER STD DWG #219 (6" CURB FACE)
- 17 "DRAIN THRU" PER DETAIL #12, SHEET #13
- 18 WHEEL STOPS REQUIRED AT PEDESTRIAN WALKWAYS AND LANDSCAPE AREAS. SEE NOTE 7, SHEET #9
- 19 DEPRESS CURB FOR ACCESSIBLE ROUTE
- 20 6" SIDEWALK PER STD DWG #234
- 21 10" CROSS GUTTER PER STD DWG #228 (1% CROSS FALL)
- 22 10" SIDEWALK PER STD DWG #234
- 23 EX. POWER POLE TO BE RELOCATED SEE NV POWER DWGS.
- 24 REMOVE EX. LANDSCAPE CURB
- 25 RELOCATE EX. FENCE TO BACK OF CURB
- 26 6" DECORATIVE BLOCK WALL w/ 20% MIN CONTRASTING MATERIAL & CAP
- 27 AC SIDE WALK PER SOILS REPORT
- 28 5' SIDEWALK PER STD DWG #234
- 29 ROUGH GRADE PAD ELEVATION IS 18" (1.5 FEET) BELOW FINISH FLOOR ELEVATION. VERIFY WITH STRUCTURAL PLANS PRIOR TO ANY CONSTRUCTION. REPORT ANY DISCREPANCY TO ENGINEER.

SEE SHEET #6

SEE SHEET #7

VICINITY MAP

DESCRIPTION

REVISE EX. FF & ONSITE GRADES

REV #

1

DATE

3-18-09

DUNNAM CIVIL ENGINEERS

9471 WEST OAKWOOD ROAD SUITE 202
LAS VEGAS, NV 89116
(702) 796-1066 (702) 798-9686 FAX

THE ANNEX

GRADING PLAN (NW)

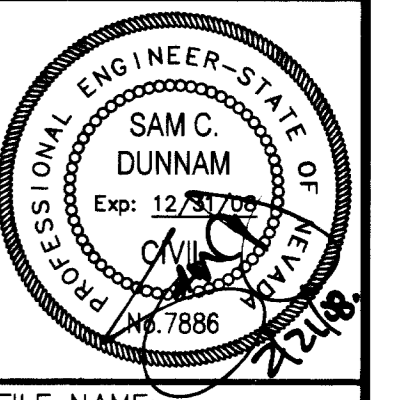

FILE NAME: KALB55C.dwg
PLOT SCALE: 1" = 20'
SHEET 5 OF THIRTEEN
CLV DRAWING # 107V4960

Call before you OVERHEAD

1-702-227-2929

Call before you Dig UnderGround

1-800-227-2600

1-702-455-7511

1-702-229-8611

DATE

SCALE IN FEET
1 INCH = 20 FT.

109686

18912