

FARM ROAD
(PUBLIC STREET)
HORIZONTAL: 1"=40'
VERTICAL: 1"=4'

CONSTRUCTION NOTES

- ② 80' PUBLIC R/W HALF STREET = 4" AC PAVING OVER 4.5" TYPE II BASE PER U.S.D.C.C.A. MODIFIED STANDARD DWG.
- ③ CONSTRUCT "L" CURB PER U.S.D.C.C.A. STANDARD DWG. NO. 216
- ④ CONSTRUCT 8" WIDE CROSS GUTTER PER U.S.D.C.C.A. STANDARD DRAWING NO. 228
- ⑤ CONSTRUCT 5" WIDE CONCRETE SIDEWALK PER U.S.D.C.C.A. STANDARD DRAWING NO. 234
- ⑥ CONSTRUCT SIDEWALK RAMP PER U.S.D.C.C.A. DWG. NO. 235. TRANSITIONS PER RAMP DATA TABLE.
- ⑦ CONSTRUCT SIDEWALK UNDER-DRAIN PER U.S.D.C.C.A. DWG. NO. 236.
- ⑧ CONSTRUCT REMOVABLE BOLLARD POLE, SEE DETAIL 1/DT2.
- ⑨ END ROAD MARKERS
- ⑩ REMOVE EXISTING TEMPORARY OVERPAVE
- ⑪ CONSTRUCT ROCKERY WALL

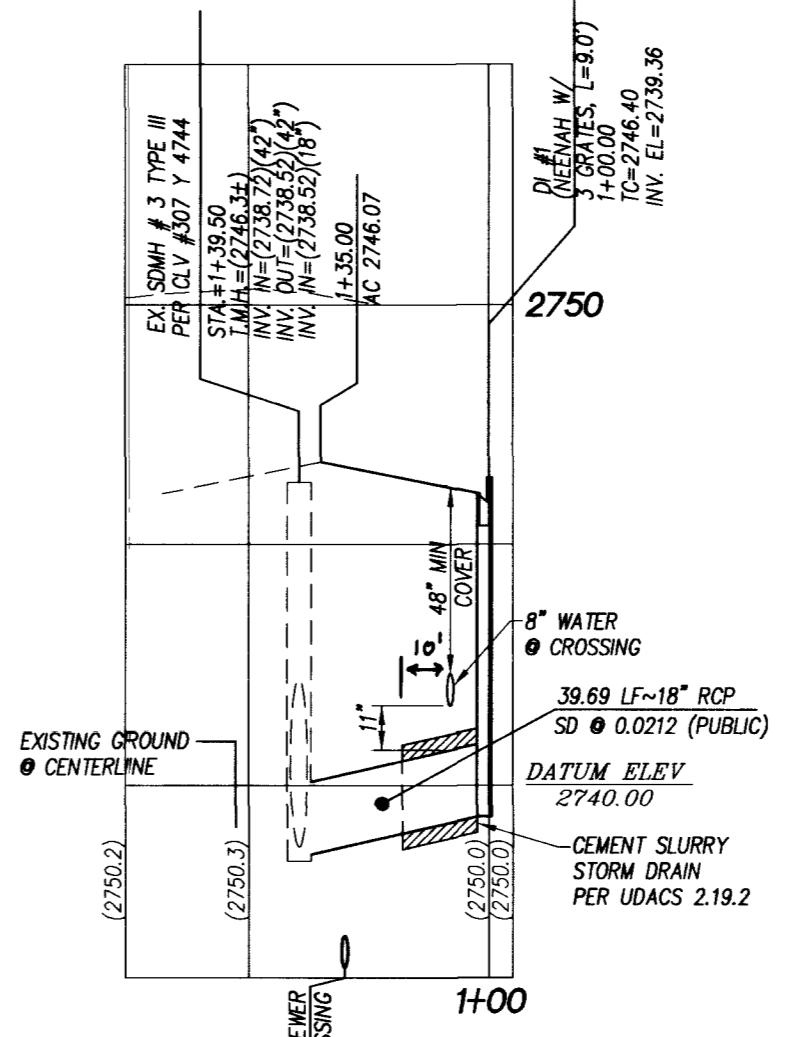

DI #1 - LATERAL
HORIZONTAL SCALE: 1"=40'
VERTICAL SCALE: 1"=4'

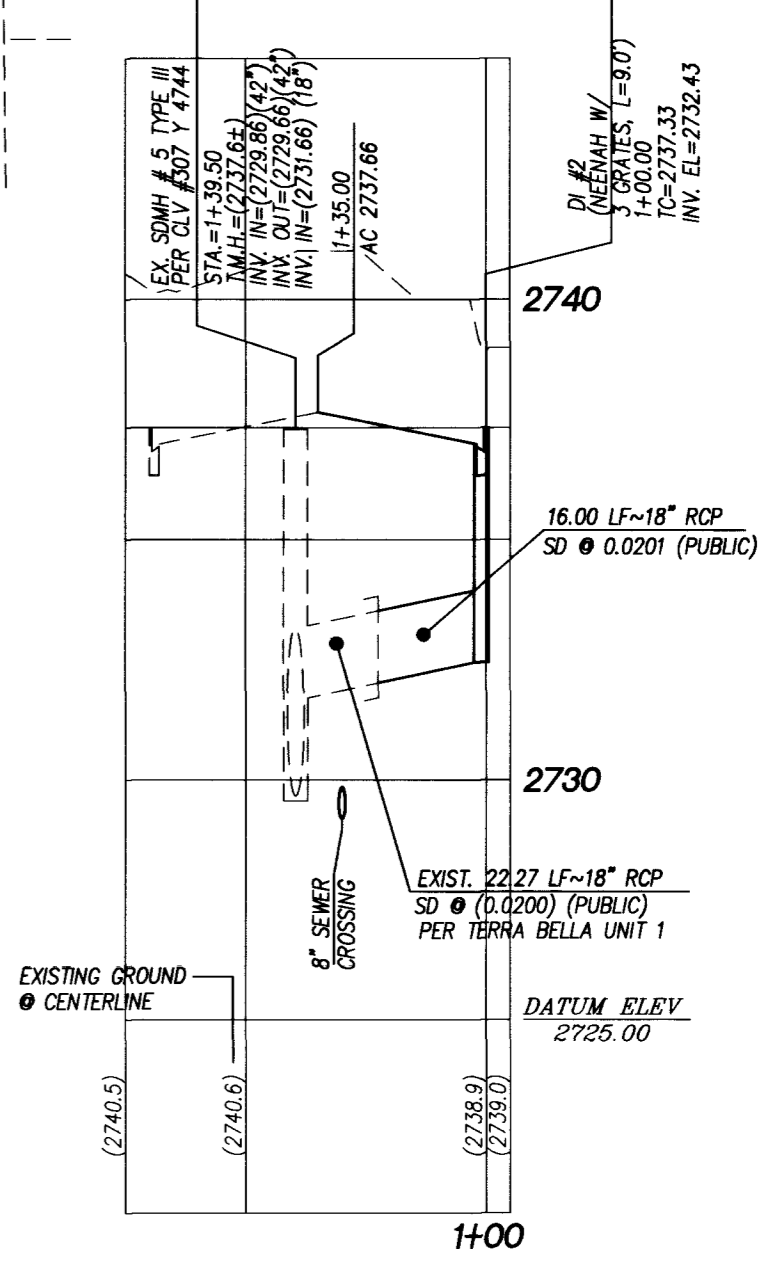

DI #2 - LATERAL
HORIZONTAL SCALE: 1"=40'
VERTICAL SCALE: 1"=4'

LEGEND

- MATCHLINE
- PROPERTY LINE / RIGHT-OF-WAY
- "L" TYPE CURB AND GUTTER
- CROSS GUTTER
- WHEELCHAIR RAMP
- CUT OR FILL SLOPE
- PROPOSED AC PAVEMENT AREA
- PROPOSED ELEVATION (DESCRIPTION AS SHOWN)
- EXISTING ELEVATION (DESCRIPTION AS SHOWN)
- EXISTING DESIGN ELEVATION (DESCRIPTION AS SHOWN)
- TOP OF RETAINING WALL (ELEV.)
- TOP OF FOOTING (ELEV.)
- SLOPE
- DETAIL OF SECTION NUMBER SHEET DETAIL IS SHOWN
- BLOCK WALL
- RETAINING WALL
- ROCKERY WALL
- LOT NUMBER
- PAD ELEVATION
- FINISHED FLOOR ELEVATION
- END OF ROAD MARKERS

H.C. RAMP DATA
PER STANDARD DRAWING. 235

NO.	"A"	"B"	CASE
A	8.0'	8.0'	1
B	4.5'	12.0'	1
C	15.0'	4.5'	1
D	12.0'	4.5'	1
E	21.5'	4.5'	1
F	9.5'	4.5'	1

CURVE TABLE

CURVE	LENGTH	RADIUS	TANGENT	DELTA
C31	7.85'	5.00'	5.00'	90°00'00"
C32	7.85'	5.00'	5.00'	90°00'00"
C38	9.42'	3.00'	INFINITE	180°00'00"
C39	9.42'	3.00'	INFINITE	180°00'00"
C42	39.27'	25.00'	25.00'	90°00'00"
C43	39.27'	25.00'	25.00'	90°00'00"
C48	31.42'	20.00'	20.00'	90°00'00"
C49	31.42'	20.00'	20.00'	90°00'00"

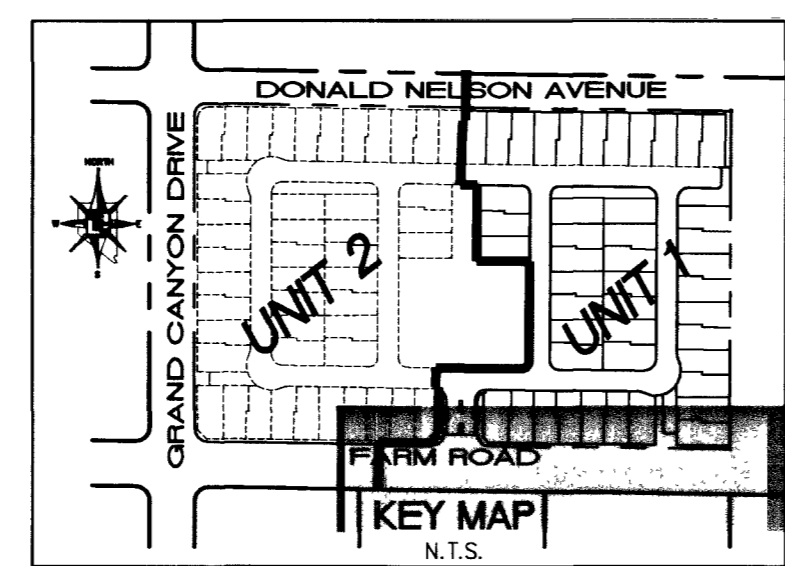

BENCHMARK
CITY OF LAS VEGAS BENCHMARK -2090-20W4
REBAR #124 FT. NORTHEAST OF DEER SPRINGS AND FORT APACHE
ELEVATION = 806.867 METERS (NAVDB88) ELEVATION = 2647.20 FEET (NAVDB88)

BASIS OF BEARING
BEARING SOUTH 00°13'40" EAST; BEING THE WEST LINE OF THE SOUTHWEST QUARTER (SW 1/4) OF THE NORTHWEST QUARTER (NW 1/4) OF SECTION 20, TOWNSHIP 19 SOUTH, RANGE 60 EAST, CLARK COUNTY, NEVADA, AS SHOWN ON FILE 25, PAGE 44 SURVEYS.

NOTE:
ALL PRIVATE STREETS & DRIVES ARE P.U.E., CLV SEWER EASEMENTS, AND PUBLIC DRAINAGE EASEMENTS TO BE PRIVATELY MAINTAINED BY H.O.A.

Call before you Dig
1-800-227-2600
Underground Utility Service (USA)

Call before you Overhead
1-702-593-6111
Overhead Power Line Service (USA)

KIMBALL HILL HOMES
8 SUNSET WAY, SUITE 101
LAS VEGAS, NEVADA 89014
(702) 436-4582

TERRASANO UNIT 1
CITY OF LAS VEGAS

TETRA TECH, INC.
INFRASTRUCTURE SOUTHWEST GROUP
401 N. Burbank Dr., Suite 100, Las Vegas, Nevada 89101
(702) 242-4200

PP2
9 OF 15
DRAWING NO. 10714798

PROFESSIONAL ENGINEER
STATE OF NEVADA
No. 503
1-14-04

APPROVED FOR CONSTRUCTION
LAS VEGAS VALLEY WATER DISTRICT
(PROJECT #26555)