

- TRAFFIC STRIPING**
- (50) TYPE 1 CENTERLINE (USD NO 224)
  - (51) TYPE 2 CENTERLINE (USD NO 224)
  - (52) TYPE 4 LANE LINE (USD NO 224A)
  - (53) TRANSITION SECTION (USD NO 245)
  - (54) RIGHT TURN LANE (USD NO 246)
  - (55) MINOR RIGHT TURN LANE (USD NO 246.2)
  - (56) STORAGE LANE LINE (USD NO 246)
  - (57) MEDIAN NOSE MARKING (USD NO 248)
  - (58) 24" WIDE CROSSWALK LINES (PMF)
  - (59) 6" WIDE SOLID WHITE LINE (PMF)
  - (60) WHITE PAVEMENT "ARROW" (PMF)
  - (61) WHITE PAVEMENT "ONLY" (PMF)
  - (62) 24" WIDE STOP BAR (PMF)
  - (63) WHITE PAVEMENT "BIKE LANE" (PMF)
  - (64) 8" SOLID WHITE LINE
  - (64A) WHITE PAVEMENT "BIKE LANE" (PMF) (INCLUDES DIAMOND AND ARROW PAINTED AT APPROXIMATE 250' INTERVALS WITHIN DESIGNATED BIKE LANE.)
  - (65) 8"x2" STRIPES 8' ON CENTER (USD 246.1)
  - (66) 8"x3" STRIPES DROP LANE (USD 246A)
- TRAFFIC SIGNAGE**
- (70) INSTALL NEW TRAFFIC SIGN
  - (71) INSTALL PORTABLE TYPE IIIA BARRICADE PER USD NO. 601

- SIGN LEGEND**
- |  |       |  |             |
|--|-------|--|-------------|
|  | R1-1  |  | R3-7R       |
|  | R2-1  |  | R3-7L       |
|  | R3-17 |  | R4-7        |
|  | R6-1R |  | R3-7L (SPL) |
|  | W1-2L |  | R4-4        |
|  | R2-50 |  |             |

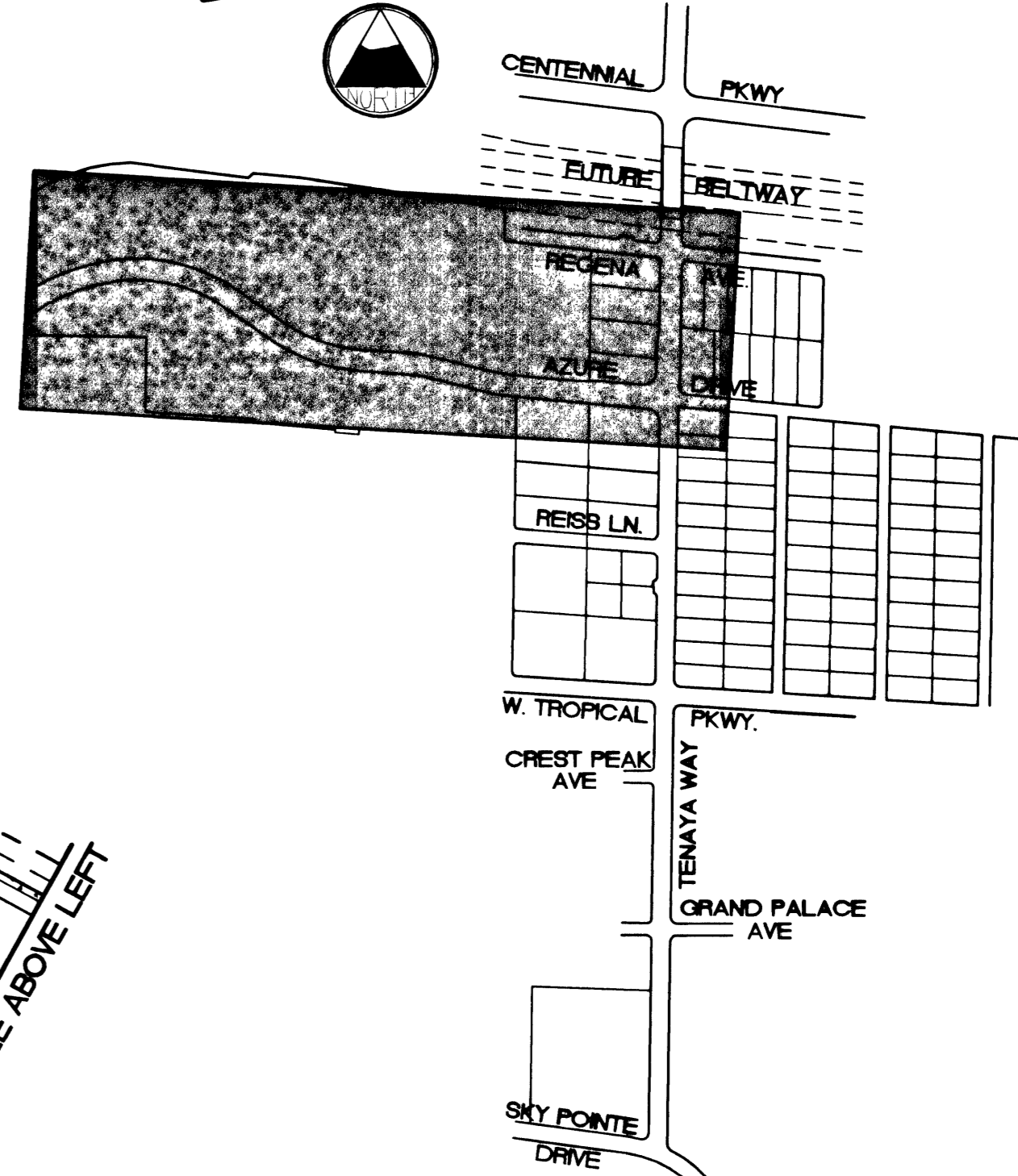

**BASIS OF BEARING**  
 NORTH AMERICAN DATUM - 1983 (NAD83), NEVADA COORDINATE SYSTEM - 1983 (NCS'83), EAST ZONE (2701), MODIFIED AS SHOWN BY A MAP ON FILE IN THE OFFICE OF THE COUNTY RECORDER, CLARK COUNTY, NEVADA IN FILE 89 OF RECORDS OR SURVEYS, PAGE 3

**BENCHMARKS**  
 #1LV90/27N4, CLV, PLS 2050 AL CAP W1/4 SEC.27 ELEV. 2381.17 NAVD 88  
 #1LV90/27N4, CLV, AL CAP, PLS 2984, CENTENNIAL PKWY & TENAYA WAY ELEV. 2356.41 NAVD 88

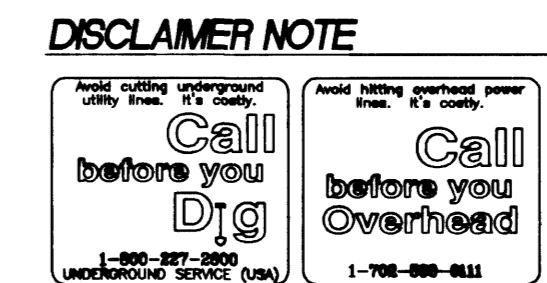

**DISCLAIMER NOTE**  
 UTILITY LOCATIONS SHOWN HEREON ARE APPROXIMATE ONLY. IT SHALL BE THE CONTRACTOR'S RESPONSIBILITY TO DETERMINE THE EXACT HORIZONTAL AND VERTICAL LOCATION OF ALL EXISTING UNDERGROUND UTILITIES PRIOR TO COMMENCING CONSTRUCTION. NO REPRESENTATION IS MADE THAT ALL EXISTING UTILITIES ARE SHOWN HEREON. THE ENGINEER ASSUMES NO RESPONSIBILITY FOR UTILITIES NOT SHOWN OR UTILITIES NOT SHOWN IN THEIR PROPER LOCATION.

SHEET <b>AZURE DRIVE          SIGNAGE AND STRIPING PLAN          STA 10+00 TO 36+50</b>	ENGINEERING DESIGN SECTION DEPARTMENT OF PUBLIC WORKS 400 EAST STEWART LAS VEGAS, NV 89101 (702) 229-5276	CITY ENGINEER: CHARLES KAJKOWSKI, JR., P.E. PROJECT MANAGER: THERESA M. HANRAHAN, P.E. 1091 SHARROW ROAD, SUITE A-3 LAS VEGAS, NV 89119 (702) 228-8194	<b>PRIMAS AND          ASSOCIATES          CONSULTING          ENGINEERS</b>	TITLE <b>TENAYA WAY / AZURE DRIVE          ROADWAY IMPROVEMENTS</b>	SCALE: 1" = 40' HORZ VERT	DRAWN BY: DESIGNED BY: CHECKED BY: PROJECT NO.: 907.01001	REVISION NO. DATE BY 1 11/1/02 KJ 2 11/1/02 KJ 3 11/1/02 KJ 4 11/1/02 KJ 5 11/1/02 KJ 6 11/1/02 KJ 7 11/1/02 KJ 8 11/1/02 KJ 9 11/1/02 KJ 10 11/1/02 KJ
--	---	--	--	--	---------------------------------	--	--