

MATCHLINE SEE SHEET SD-01 FOR CONTINUATION

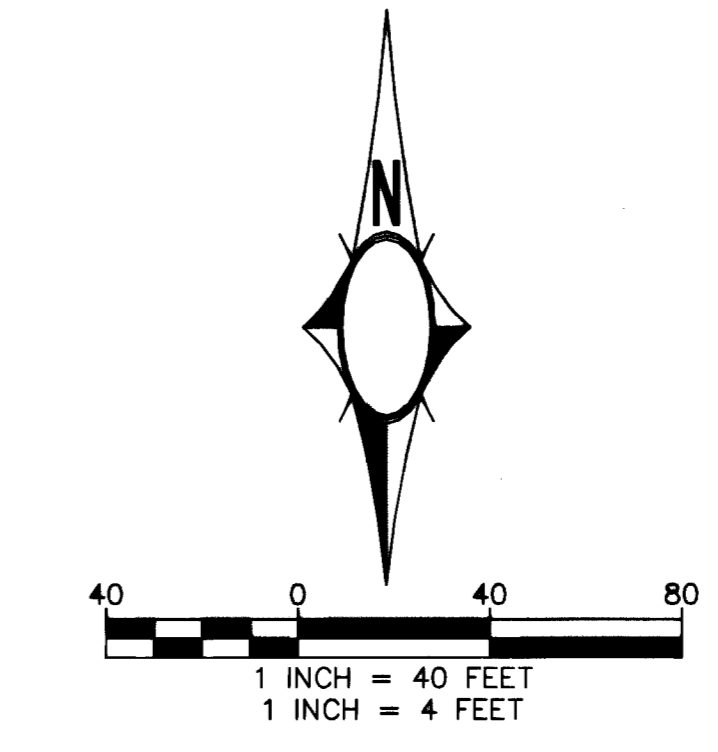
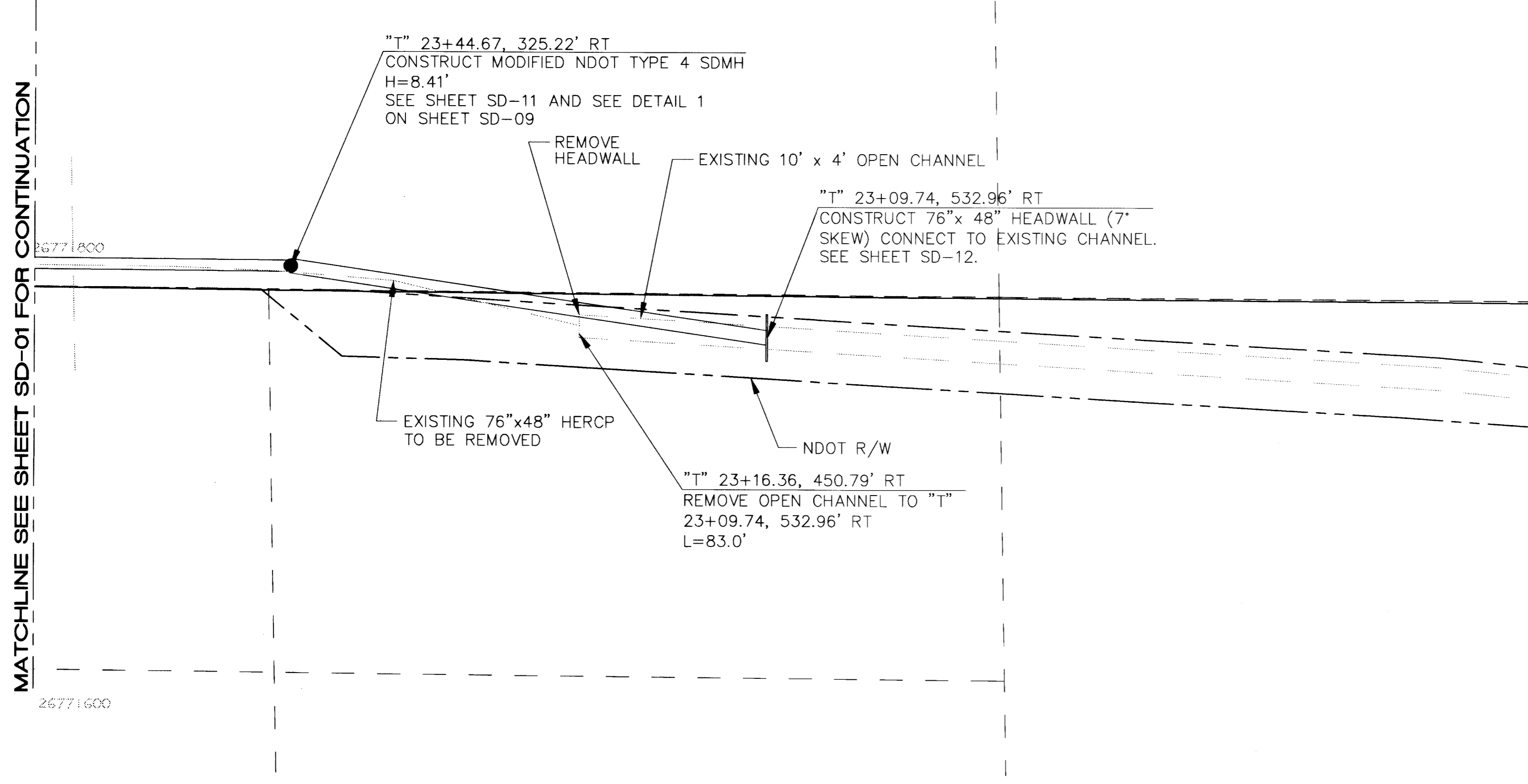

- STORM DRAIN NOTES:**
- UNLESS OTHERWISE DESIGNATED, STORM DRAIN DROP INLETS AND MANHOLES AS SHOWN IN PROFILE SHALL BE CONSTRUCTED PER "UNIFORM STANDARD DRAWINGS FOR PUBLIC WORKS CONSTRUCTION, OFF-SITE IMPROVEMENTS, CLARK COUNTY AREA, NEVADA" LATEST EDITION. NDOT STORM DRAIN DROP INLETS AND NDOT MANHOLES SHALL BE CONSTRUCTED PER THE "NEVADA DEPARTMENT OF TRANSPORTATION (NDOT) ENGLISH STANDARD PLANS" LATEST EDITION.
 - ALL PIPE LENGTHS MEASURED ALONG PIPE CENTERLINE TO CENTER OF MANHOLE OR INSIDE EDGE OF DI, RCB, OR STRUCTURE.
 - ALL RCP SHALL BE CLASS III UNLESS OTHERWISE DESIGNATED.
 - CLSM BACKFILL TO BE USED FOR ALL BACKFILL ALONG WASHINGTON AVENUE.

WATERLINE NOTES:

ALL SEWER/STORM DRAINS CROSSING WATER LINES MUST CONFORM TO SECTION 2.19 OF THE UNIFORM DESIGN AND CONSTRUCTION STANDARDS FOR POTABLE WATER SYSTEMS (UDACS) FOR WATER AND STORM MAIN CROSSINGS AND CLEARANCES.

NO.	DATE	DESCRIPTION

DEPARTMENT OF PUBLIC WORKS
 ENGINEERING DESIGN SECTION

CITY ENGINEER: JORGE CERVANTES, P.E.
 PROGRAM MANAGER: MARK SORENSEN, P.E.

DESIGNED BY: RCB
 DRAWN BY: MF
 CHECKED BY: HT

HDR Engineering, Inc.

HORIZONTAL SCALE: 1"=40'
 VERTICAL SCALE: 1"=4'

DATE: 1/2/08

MATCHLINE SEE SHEET SD-01 FOR CONTINUATION

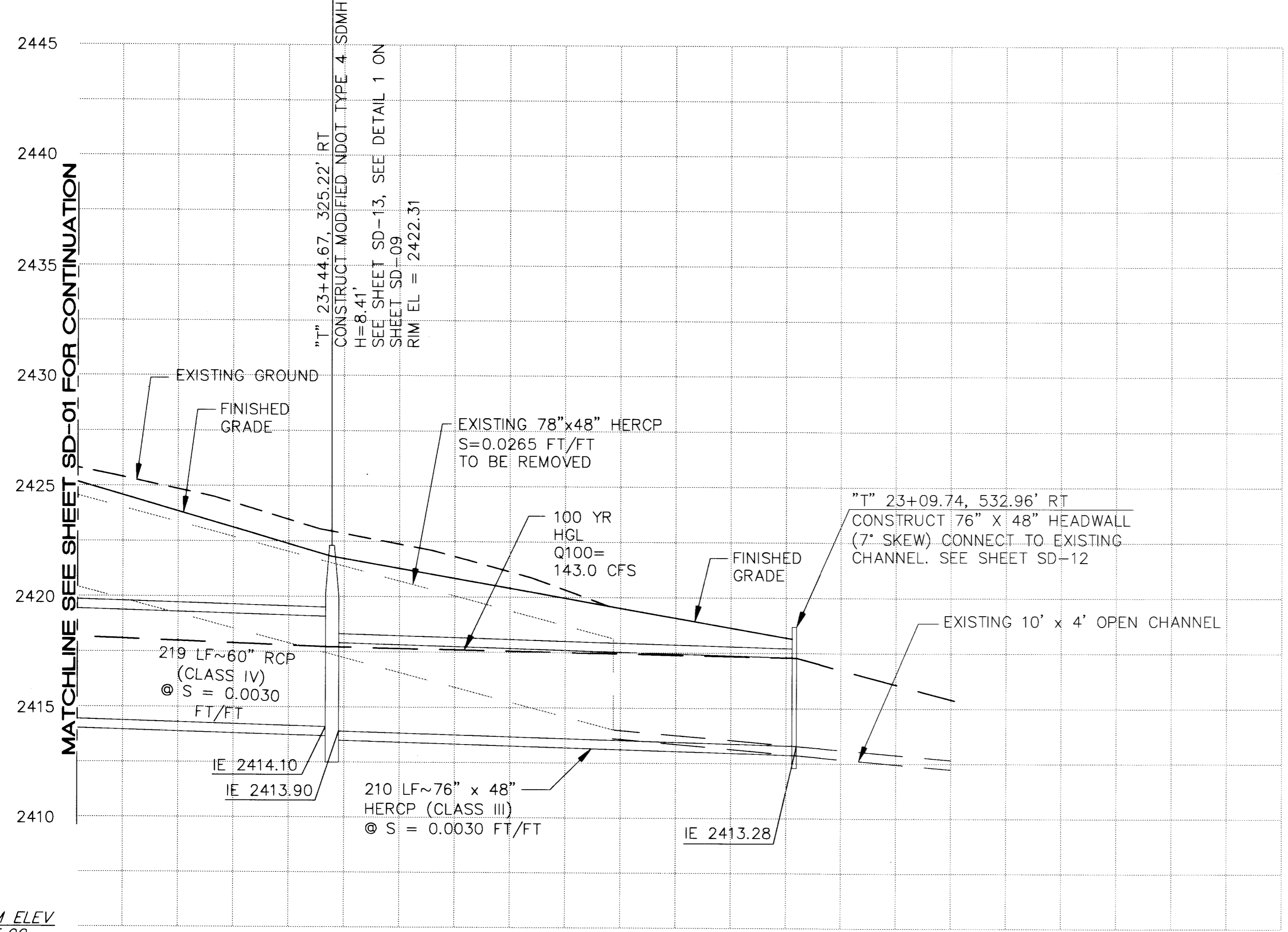

DATUM ELEV 2405.00

TITLE: TENAYA WAY OVERPASS AT SUMMERLIN PKWY H-2858

SHEET: STORM DRAIN PLAN AND PROFILE



Call before you Dig. Safety Alert. Call before you Dig. Overhead.

1-702-455-7511
 1-702-452-5300
 1-800-227-2600
 1-702-593-6111

Sheet SD-02
 18 of 96
 DRAWING NO. 1074452