

DEPTH (feet)	SAMPLES	BLOWS/FOOT	MOISTURE (%)	DRY DENSITY (PCF)	SYMBOL	CLASSIFICATION U.S.C.S.	DATE DRILLED	BORING NO.	
							04/23/2003	B-9	
							GROUND ELEVATION	SHEET	OF
							2,427± (NAVD '88)	3	3
							METHOD OF DRILLING 6" diameter air-rotary (rock bit)		
							DRIVE WEIGHT	DROP	
							140 lbs.	30"	
							SAMPLED BY DDM LOGGED BY DDM REVIEWED BY BDB		
							DESCRIPTION/INTERPRETATION		
40		50/<1"					ALLUVIUM (continued): Brown, damp, hard, CALICHE; strongly cemented; composed primarily of coarse-grained material; sampler refusal at depth of 40'.		
45		50/1"				GM	Brown, damp, very dense, silty fine and coarse GRAVEL with sand; slightly cemented.  Sampler refusal after 1".		
50		50/1"					Sampler refusal after 1". Total depth = 50.1 feet. Groundwater not encountered during drilling. Backfilled with lean concrete on 04/24/2003.  Boring Location: Station = 18+72 Offset = 45' Right.		

LOG NO. B-9

DEPTH (feet)	SAMPLES	BLOWS/FOOT	MOISTURE (%)	DRY DENSITY (PCF)	SYMBOL	CLASSIFICATION U.S.C.S.	DATE DRILLED	BORING NO.	
							04/23/2003	B-10	
							GROUND ELEVATION	SHEET	OF
							2,427± (NAVD '88)	1	6
							METHOD OF DRILLING 6" diameter air-rotary (rock bit)		
							DRIVE WEIGHT	DROP	
							140 lbs.	30"	
							SAMPLED BY DDM LOGGED BY DDM REVIEWED BY BDB		
							DESCRIPTION/INTERPRETATION		
0						GM	ALLUVIUM: Brown, damp, medium dense, silty fine and coarse GRAVEL with sand; overlain by layer of up to approximately 4" thick landscape cobbles. Sampler refusal after 5".		
5		50/1"					Brown, damp, moderately hard to hard, CALICHE; moderately to strongly cemented; composed primarily of coarse-grained material; a few sandy gravel layers up to a few inches thick.  Sampler refusal after 1".		
10		50/<1"					Very hard; sampler refusal.		
15		50/<1"					Sampler refusal.		

LOG NO. B-10

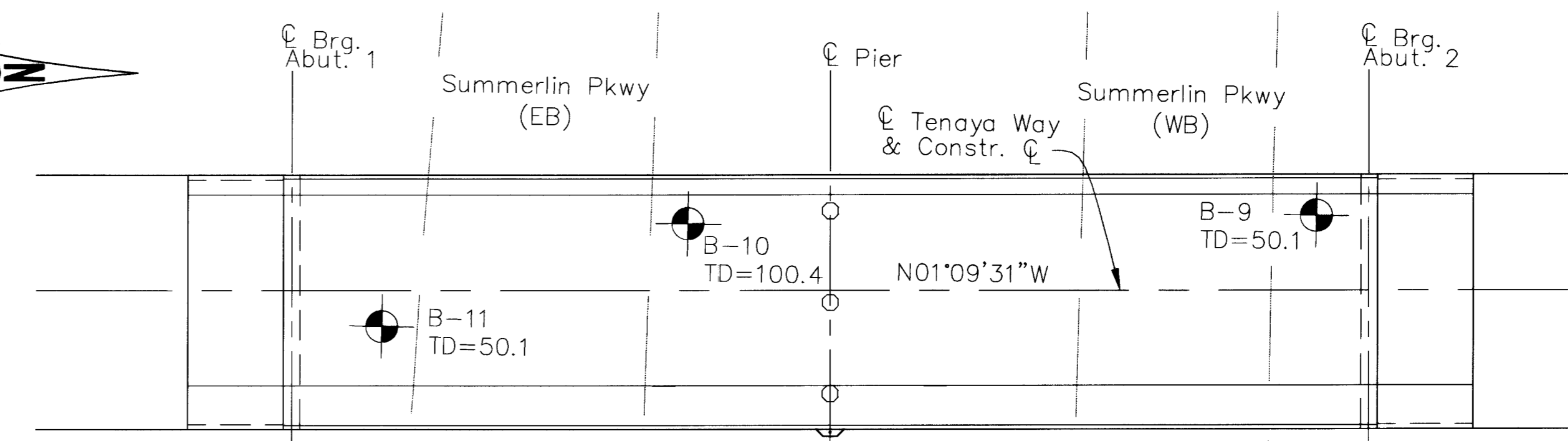
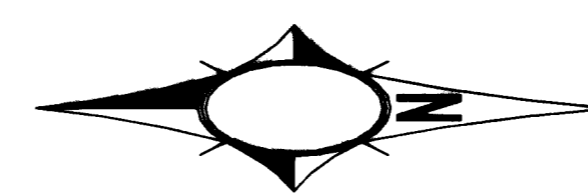

BORING PLAN

NO.	DATE	DESCRIPTION

DEPARTMENT OF PUBLIC WORKS  
 ENGINEERING DESIGN SECTION  
 CITY ENGINEER: JORGE CERVANTES, P.E.  
 PROGRAM MANAGER: MARK SORENSEN, P.E.  
 DESIGNED BY: XXX HORIZONTAL SCALE: N/A  
 DRAWN BY: XXX VERTICAL SCALE: N/A  
 CHECKED BY: XXX DATE: 10/2007

TENAYA WAY OVERPASS  
 AT SUMMERLIN PKWY  
 LOG OF BORINGS 2  
 TITLE: \_\_\_\_\_  
 SHEET: \_\_\_\_\_

Sheet  
**SH-02**  
 38 of 96  
 DRAWING NO.  
**107Y4452**

P:\Tenaya\Sheets\SH-02.dwg 10/18/07 4:05pm aabdo

104531