

FOR CONTINUATION SEE SHEET GP4

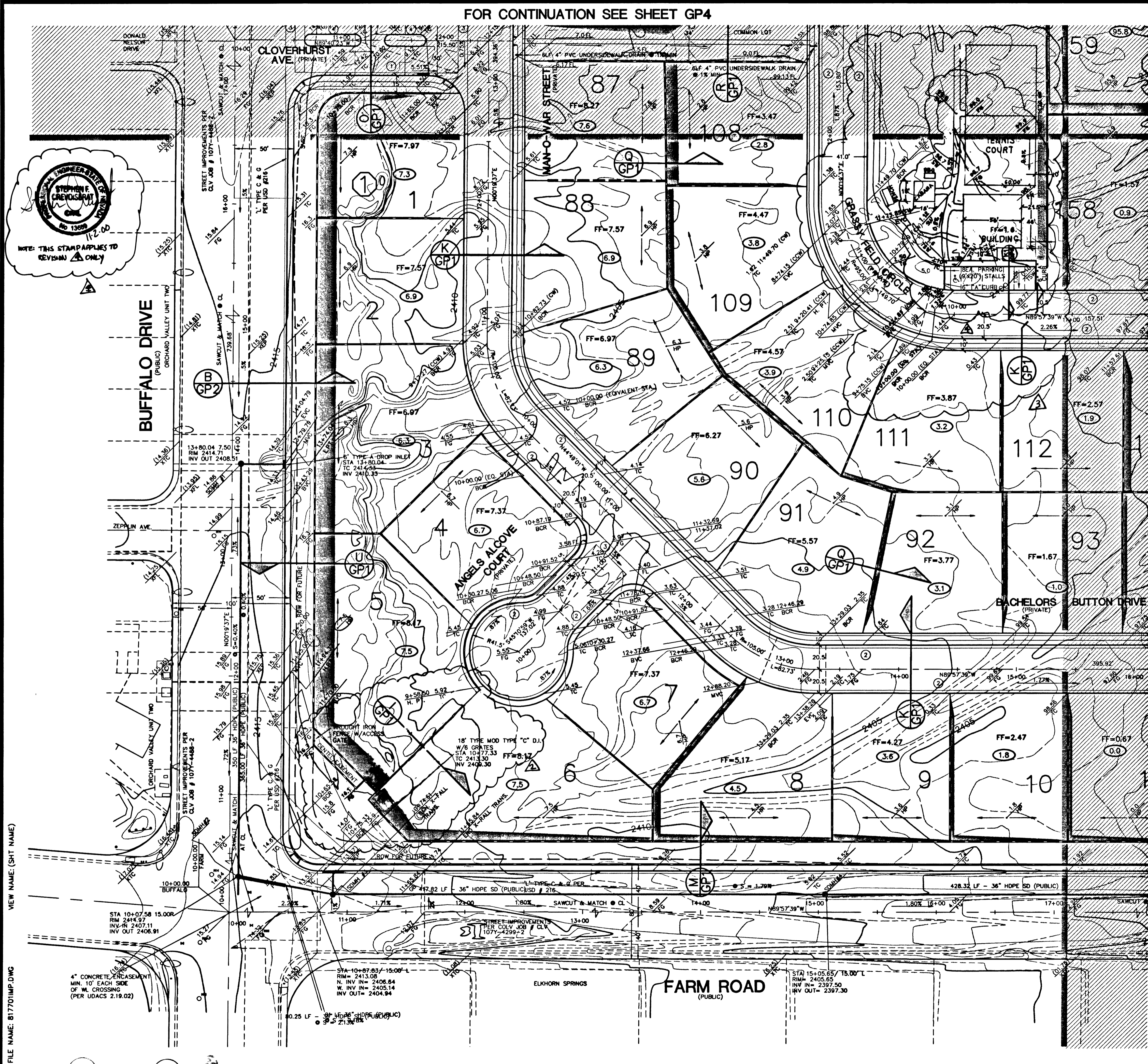

FOR CONTINUATION SEE SHEET GP5

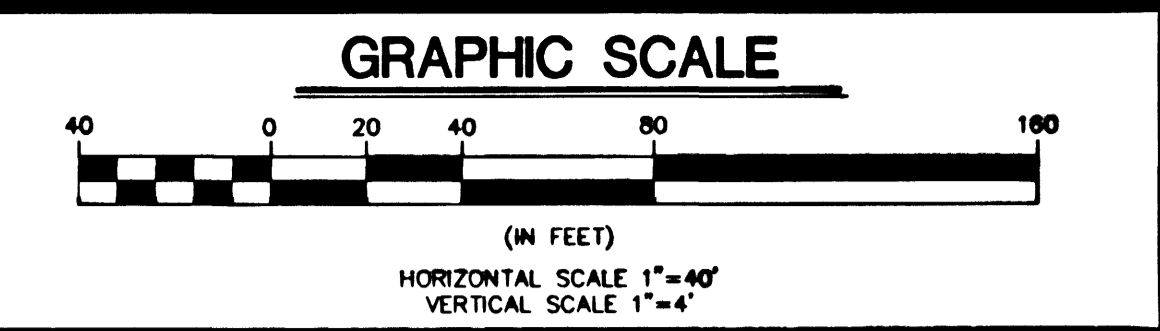

BASIS OF BEARINGS
 THE BASIS OF BEARINGS FOR THIS MAP IS THE WEST LINE OF THE NORTHWEST QUARTER (NW 1/4) OF SECTION 15, TOWNSHIP 19 SOUTH, RANGE 60 EAST, M.D.M. WHICH BEARS NORTH 00°19'37" EAST AS SHOWN ON THE OFFICIAL PLAT OF ORCHARD VALLEY AT ELKHORN SPRINGS - UNIT 2 IN THE OFFICE OF THE CLARK COUNTY, NEVADA, RECORDER IN BOOK 81 OF PLATS ON PAGE 65.

BENCHMARK
 CITY OF LAS VEGAS BENCHMARK No. 39 STATION 1LV90-15N4 REBAR AND ALUMINUM CAP, RLS 1803, GRAND TETON AND TENAYA WAY, 728.1093 METERS (NAV80)
 728.1093 x (3937/1200) = 2,385.805 FEET (NAV80)

- GRADING NOTES**
1. ALL GRADES SHOWN ARE 3 FEET BELOW FINISH GRADE TO ALLOW FOR LANDSCAPING, EXCEPT TC, FL, AND FG, WHICH ARE TO FINISH GRADE.
 2. FINAL GRADES ADJACENT TO STRUCTURE AFTER LANDSCAPING SHALL BE 0.7 FEET BELOW FINISH FLOOR.
 3. THE QUANTITIES SHOWN ARE ESTIMATES ONLY AND ARE NOT TO BE USED FOR BIDDING PURPOSES.
 4. THE CONTRACTOR SHALL VERIFY ALL CONDITIONS AND DIMENSIONS AND REPORT ALL DISCREPANCIES TO THE ENGINEER BEFORE BEGINNING WORK.
 5. FINISH FLOOR ELEVATION IS TO BE 0.8 FOOT ABOVE PAD GRADE.
 6. ALL LOTS ARE TO BE F.H.A. TYPE "A" DRAINAGE UNLESS OTHERWISE NOTED.
 7. ALL IMPROVEMENTS TO BE PROTECTED FROM EROSION.
 8. ALL SLOPES ARE TO BE THREE FEET HORIZONTAL TO ONE FOOT VERTICAL UNLESS OTHERWISE NOTED.
 9. SEE FINAL MAP FOR EXACT BEARINGS AND DISTANCES.
 10. SEE DETAIL SHEETS FOR STREET SECTIONS AND DETAILS.
 11. 3' MAXIMUM WALL HEIGHT IS ALLOWED WITHIN THE FRONT SETBACK AREA WITH EACH UNIT.
 12. THE ENTIRE SITE IS TO BE ROUGH GRADED WITH UNIT 1. FINISHED GRADES TO BE DETERMINED WITH THE APPROVAL OF EACH UNIT.
 13. THE PERIMETER WALL IS TO BE CONSTRUCTED BY OTHERS WITH UNIT 1.
 14. THE RETAINING WALLS ON THE INTERIOR OF THE PROJECT ARE TO BE CONSTRUCTED WITH EACH UNIT.
 15. ALL INTERIOR STREETS ARE PRIVATE STREETS WITH PUBLIC UTILITY EASEMENT, CLV SEWER EASEMENTS, AND PUBLIC DRAINAGE EASEMENTS TO BE PRIVATELY MAINTAINED.

- LEGEND**
- FUTURE IMPROVEMENTS
 - EX. IMPROVEMENTS
 - BLOCK RETAINING WALL
 - INDEX CONTOUR
 - INTERMEDIATE CONTOUR
 - SCARP (3:1 MAX)
 - A.C. SWALE
 - HINGE LINE
 - UNIT LINE
 - FF FINISH FLOOR
 - BW BOTTOM WALL
 - FG FINISH GRADE
 - FL FLOW LINE
 - TC TOP OF CURB
 - 99.9 PAD GRADE

- CONSTRUCTION NOTES**
1. "L" TYPE CURB (UDS#218)
 2. 30" ROLL CURB AND GUTTER (UDS#217A)
 3. VALLEY GUTTER (UDS#228)
 4. "A" TYPE ISLAND CURB (UDS#219)
 5. INSTALL TEMP. 5"x5" RIP-RAP PAD AT TERMINATION OF CURB AND GUTTER AND GRADE TO DRAIN - D(50)=3"

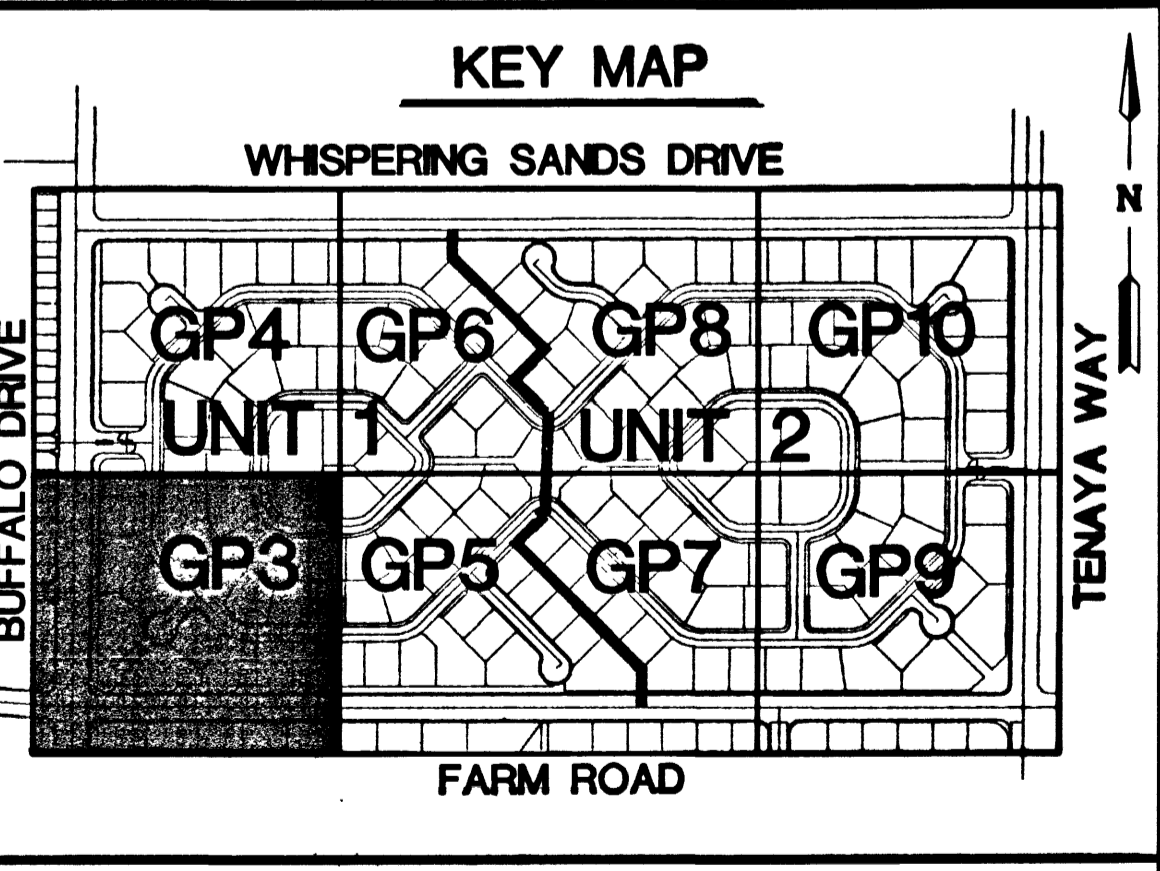

NOTICE!
 EXISTING UTILITIES ARE SHOWN ON PLANS FOR THE CONVENIENCE OF THE CONTRACTOR ONLY. THE CONTRACTOR IS RESPONSIBLE FOR THE PROTECTION OF ALL UTILITIES. THE ENGINEER BEARS NO RESPONSIBILITY FOR UTILITIES NOT SHOWN OR SHOWN INCORRECTLY.

AVOID CUTTING UNDERGROUND UTILITIES. ITS COSTLY.

Call Before You Dig

1-800-227-2600 UNDERGROUND SERVICE (USA)

"I CERTIFY THAT THIS GRADING PLAN CONFORMS TO THE APPROVED DRAINAGE STUDY ON FILE AT THE CITY OF LAS VEGAS." (FOR THIS PROJECT)

Edward F. Taney P.E. 5-5-00
 EDWARD F. TANEY P.E. #9903 DATE

| | | |
|--------------------------|---------|---|
| DESIGNED BY: ET | 7.2.99 | |
| CHECKED BY: ET | 7.16.99 | |
| PROJECT NO.: | B17701 | |
| DRAWING NO.: | | 1074-4618-1 |
| SHEET: | | GP3 |
| OF 35 SHEETS | | |
| DRAWN BY: | | |
| TITLE: | | TENAYA FARMS UNIT 1 |
| COMPANY: | | ALPHA & COMPANY |
| ADDRESS: | | 50 So. Jones #202, Las Vegas, NV 89107 Telephone: (702) 877-1300 |
| SPECTRUM DEVELOPMENT CO. | | |
| GRADING PLAN SOUTHWEST | | |

FILE NAME: B17701IMP.DWG
 22304 25703 27546

Replot