

DRAINAGE CERTIFICATION
 I CERTIFY THIS GRADING PLAN IS IN CONFORMANCE WITH THE APPROVED DRAINAGE STUDY ON FILE WITH THE CITY OF LAS VEGAS FOR THIS PROJECT.
Daniel LaRubio
 DANIEL LaRUBIO, P.E. No. 8925
 4-6-01
 DATE

CURB LINE TABLE

LINE	LENGTH	BEARING
L1	17.07'	N03°42'43"W
L1A	151.67'	N03°42'43"W
L2	75.00'	N89°55'13"W
L3	75.00'	N90°00'00"W
L4	39.46'	N03°42'43"W
L5	35.08'	N03°42'43"W
L6	339.99'	N55°02'06"W
L7	208.05'	N55°02'06"W

CURB CURVE TABLE

CURVE	RADIUS	DELTA	LENGTH	TANGENT
C1	465.00'	03°37'06"	29.37'	14.69'
C1A	15.00'	86°21'42"	22.61'	14.08'
C2	25.00'	93°33'12"	40.82'	26.60'
C1B	25.00'	86°12'30"	37.62'	23.40'
C3	25.00'	95°07'17"	41.50'	27.34'
C4	25.00'	93°42'43"	40.89'	26.67'
C5	345.00'	28°07'20"	169.34'	86.41'
C6	275.00'	25°07'18"	120.58'	61.27'
C7	25.00'	83°47'37"	36.56'	22.43'
C8	25.00'	99°12'25"	43.29'	29.38'
C9	25.00'	83°47'37"	36.56'	22.43'
C10	25.00'	99°12'25"	43.29'	29.38'
C11	345.00'	10°47'18"	64.96'	32.55'
C12	275.00'	7°47'15"	37.38'	18.72'

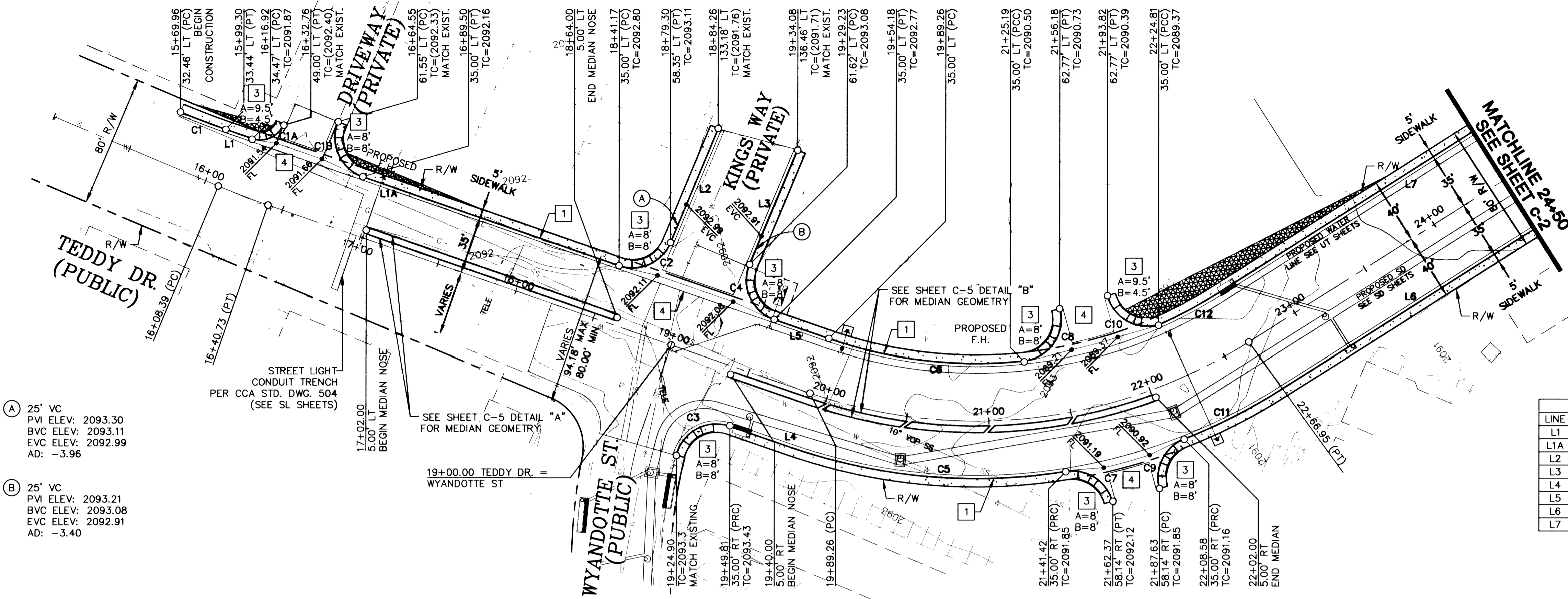

- (A) 25' VC
 PVI ELEV: 2093.30
 BVC ELEV: 2093.11
 EVC ELEV: 2092.99
 AD: -3.96
- (B) 25' VC
 PVI ELEV: 2093.21
 BVC ELEV: 2093.08
 EVC ELEV: 2092.91
 AD: -3.40

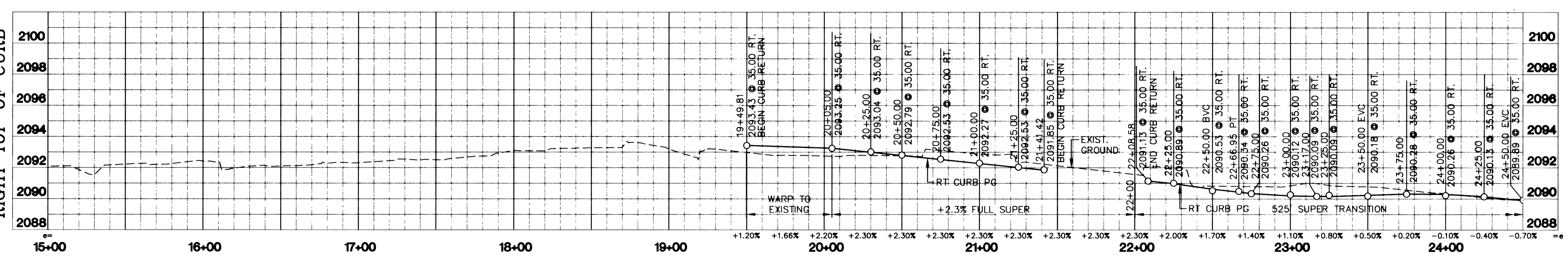
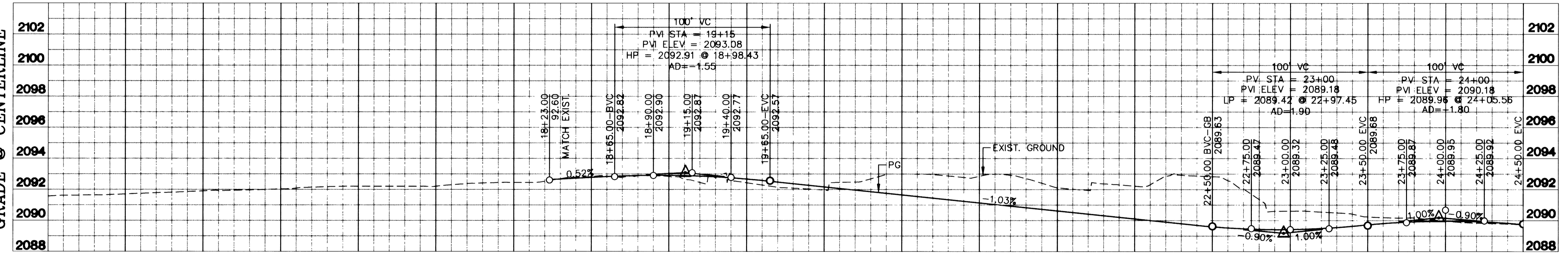
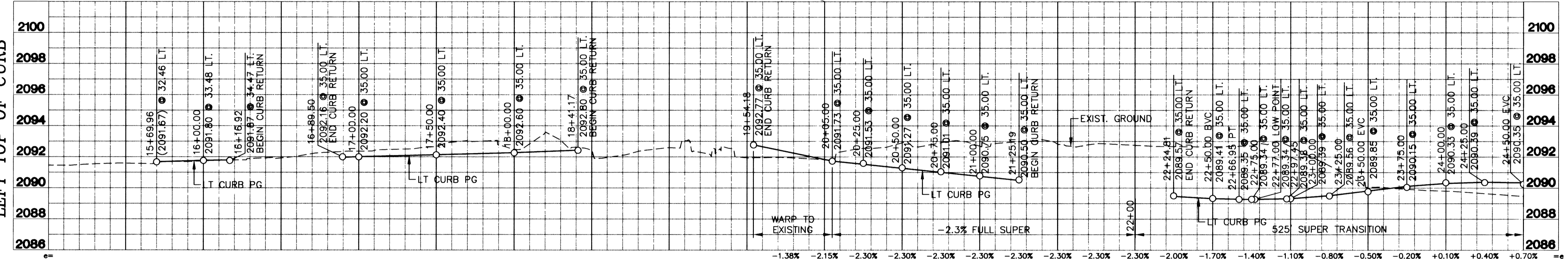

CONSTRUCTION NOTES

- 1 CONSTRUCT "L" TYPE CURB AND GUTTER PER C.C.A. STD DWG No. 216
- 2 CONSTRUCT "A" TYPE MEDIAN CURB PER C.C.A. STD DWG No. 219
- 3 CONSTRUCT SIDEWALK RAMP (CASE 1) PER C.C.A. STD DWG No. 235
- 4 CONSTRUCT 8' CROSS GUTTER PER C.C.A. STD DWG No. 228

GENERAL NOTES

- 1. CONTRACTOR SHALL VERIFY ALL EXISTING UTILITY LOCATIONS AND ELEVATIONS PRIOR TO ANY CONSTRUCTION.
- 2. DIMENSIONS ARE TO BACK OF CURB UNLESS OTHERWISE NOTED

BASIS OF BEARING

BEING THE NORTH LINE OF THE NORTHEAST QUARTER (NE 1/4) OF THE NORTHEAST QUARTER OF SECTION 8, TOWNSHIP 21 SOUTH, RANGE 61 EAST, M.D.M., SAID LINE ALSO BEING THE CENTERLINE OF SAHARA AVENUE. BEARING: SOUTH 89°59'39" WEST.

BENCHMARK

CLARK COUNTY BENCHMARK NO. 25 RIVET AND SQUARE ALUMINUM PLATE IN TOP OF CURB, NORTHEAST CORNER OF SAHARA AVENUE AND RANCHO DRIVE NEAR THE PC OF SAHARA AVENUE. ELEVATION: 2075.74 ft. (632.686 meters) REFERENCE No. 7C11 45WS DATUM: NAVD 88

SAFETY ALERT
 Call Before You Overhead
 Call before you Dig
 1-702-593-6111 1-800-227-2600

STATION CASINOS
 1503 W. SUNSET ROAD #8014
 HENDERSON, NEVADA 89014
 (702) 898-4278 Fax: (702) 898-4283

TEDDY DRIVE PLAN AND PROFILE 15+00 THRU 24+50

TEDDY DRIVE ROADWAY IMPROVEMENTS

DRAWN BY: TEA 3/01
 DESIGNED BY: COC 3/01
 CHECKED BY: BRS 3/01
 PROJECT NO: 09204500B SCALE: AS NOTED

Kimley-Horn and Associates, Inc.
 Engineering, Planning, and Environmental Consultants
 1050 East Flamingo Road
 Suite 5-210
 Las Vegas, Nevada 89119
 Tel. No. (702) 735-3999
 Fax No. (702) 735-3999

LAYNE BRANDHAGEN
 CIVIL ENGINEER
 No. 9748

SHEET C-1
 8 OF 21 SHEETS
 DRAWING NO. 107-V 3414