

TORREY PINES DR.

LAYOUT PLAN POOL AREA
SCALE: 1/8" = 1'-0"

NOTE: MIN. SLOPE TO DECK DRAINS - 1/8" PER FOOT

NOTE: SEE SHEET S-5 FOR B.M. ELEVATION

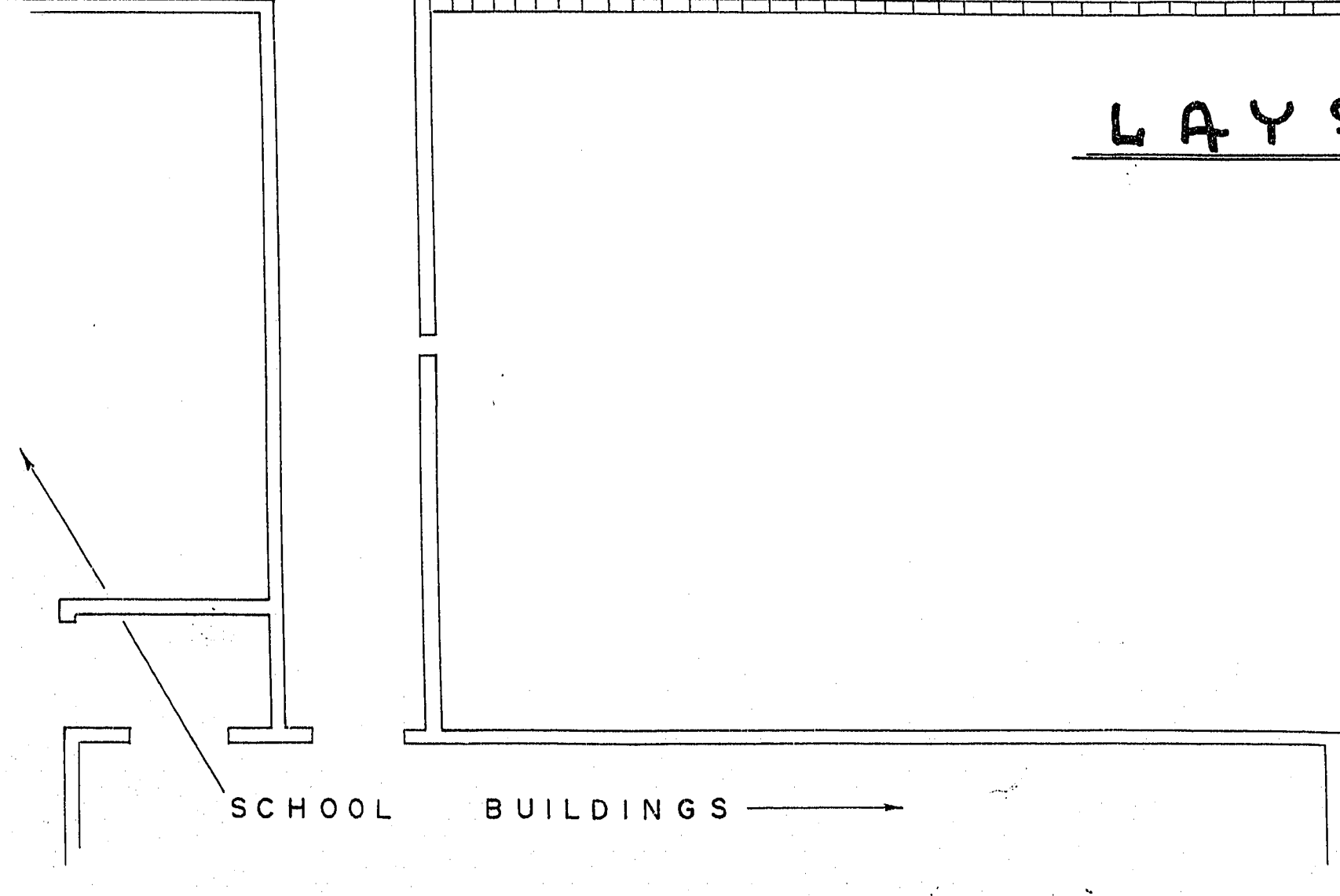

APPROVAL			
RT	DIV	DATE	INITIALS
1	D.P.	12/13/68	[Signature]
1	FIELD	12/13/68	[Signature]
2	R/W	12/13/68	[Signature]
3	SERV.		
	SUBD.		
	TRAF.		
	UTIL.		

REVISION NO.	DESCRIPTION	BY	DATE	APPROVAL
1	ADDED PAIR OF CYCLONE GATES SEE DETAIL SHEET A-16-3	H.H.W.	6-16-69	
2	ADDED PIPE RAILS TO POOL ENTRY	H.H.W.	6/12/69	
3	CHANGED DIM. OF POOL	J.L.C.	1-21-69	[Signature]
4	ADD DECK DRAIN SLOPE	J.H.E.	12-26-68	[Signature]

REVISIONS

LAYOUT PLAN - POOL AREA

CITY OF LAS VEGAS NEVADA
DEPARTMENT OF PUBLIC WORKS
SERVICES DIVISION

SWIMMING POOL & FILTER BUILDING FOR
GARSDALE SCHOOL
400 TORREY PINES DRIVE, LAS VEGAS, NEVADA

W.O. NO. 3000	F.B.K. NO.	DATE	DRAWING NO.
SC. (H)	SC. (V)		674-14
DES. HARRY H. WHITELEY - A.I.A.			FILE NO.
DR. L. HARPER			12-11-68
APPROVED BY DIRECTOR OF PUBLIC WORKS			
[Signature]			12/13/68

SHEET A-4 OF 26

CONTRACT DRAWING
DEC 13 1968